

ASSEMBLY NUMBER	PT NO. REF	DETAILS		DIMENSIONS									
		SHELL	COUPLING	A		C	G	J	L	Q DIA	V THREAD (PLATED) (MODIFIED)		Z
				±.005		+.010 -.025		±.010		+.000 -.027	SIZE CLASS 2A	MODIFIED MAJOR DIA.	±.035
71-150475	06A-6-	10-150906-63	10-123014-53	.475		.328	.218	.353	.828	.609	.3125-32UNEF	.296-.292	.525
71-150476	-8-	-83	-73							.734	.4375-28UNEF	.421-.417	
71-150477	-10-	-103	-93							.844	.5625-24UNEF	.542-.538	
71-150478	-12-	-123	-123							1.016	.6875-24UNEF	.667-.663	
71-150479	-14-	-143	-143							1.141	.8125-20UNEF	.791-.787	
71-150480	-16-	-163	-163							1.266	.9375-20UNEF	.916-.912	
71-150481	-18-	-183	-183							1.375	1.0625-18 UNEF	1.034-1.030	
71-150482	-20-	-203	-203	.569			.312	.415	.984	1.516	1.1875-18 UNEF	1.158-1.154	.619
71-150483	-22-	-223	-223	.569			.312	.415	.984	1.641	1.3125-18 UNEF	1.283-1.279	.619
71-150484	-24-	-243	-243	.631			.312	.415	1.046	1.761	1.4375-18UNEF	1.408-1.404	.619
71-150485/99		NOT AVAILABLE											

35508-189	WAS	DATE	MAN	APPD
A2 55525-148	REDRAWN, SAME SIZE, WAS 3 SHEETS, PROVIDED MANUFACTURING DATA	1-31-74	SHEPLER	
B	(CL II) SEE CHANGE NOTICE ECN A4909	6/30/08	H.BROOKER	

ACCESSORIES  
(NOT PART OF STANDARD ASSY)

SEE DRAWING  
10-150000

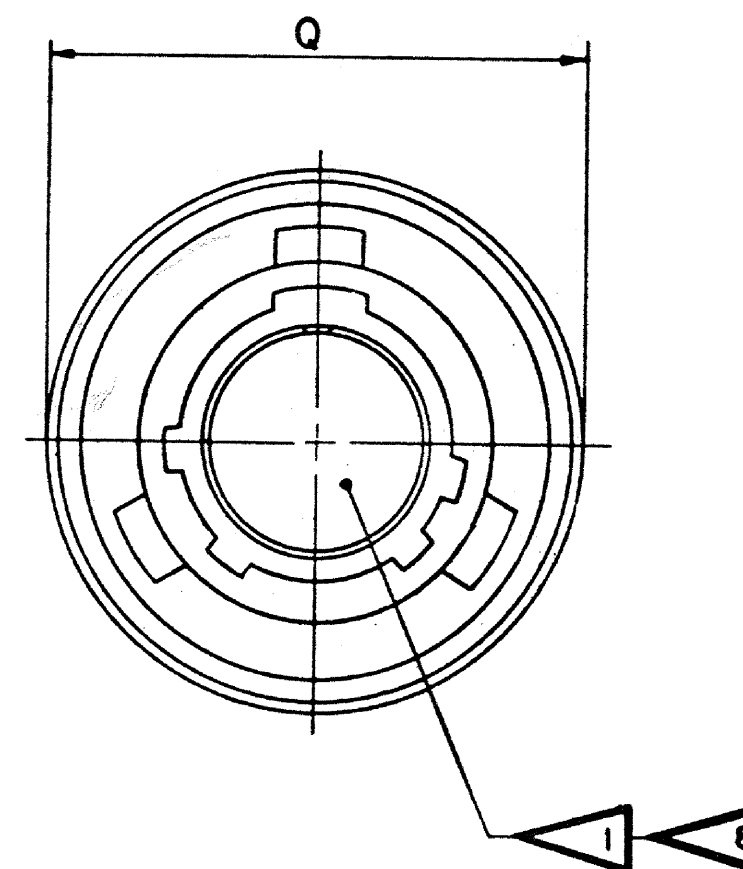
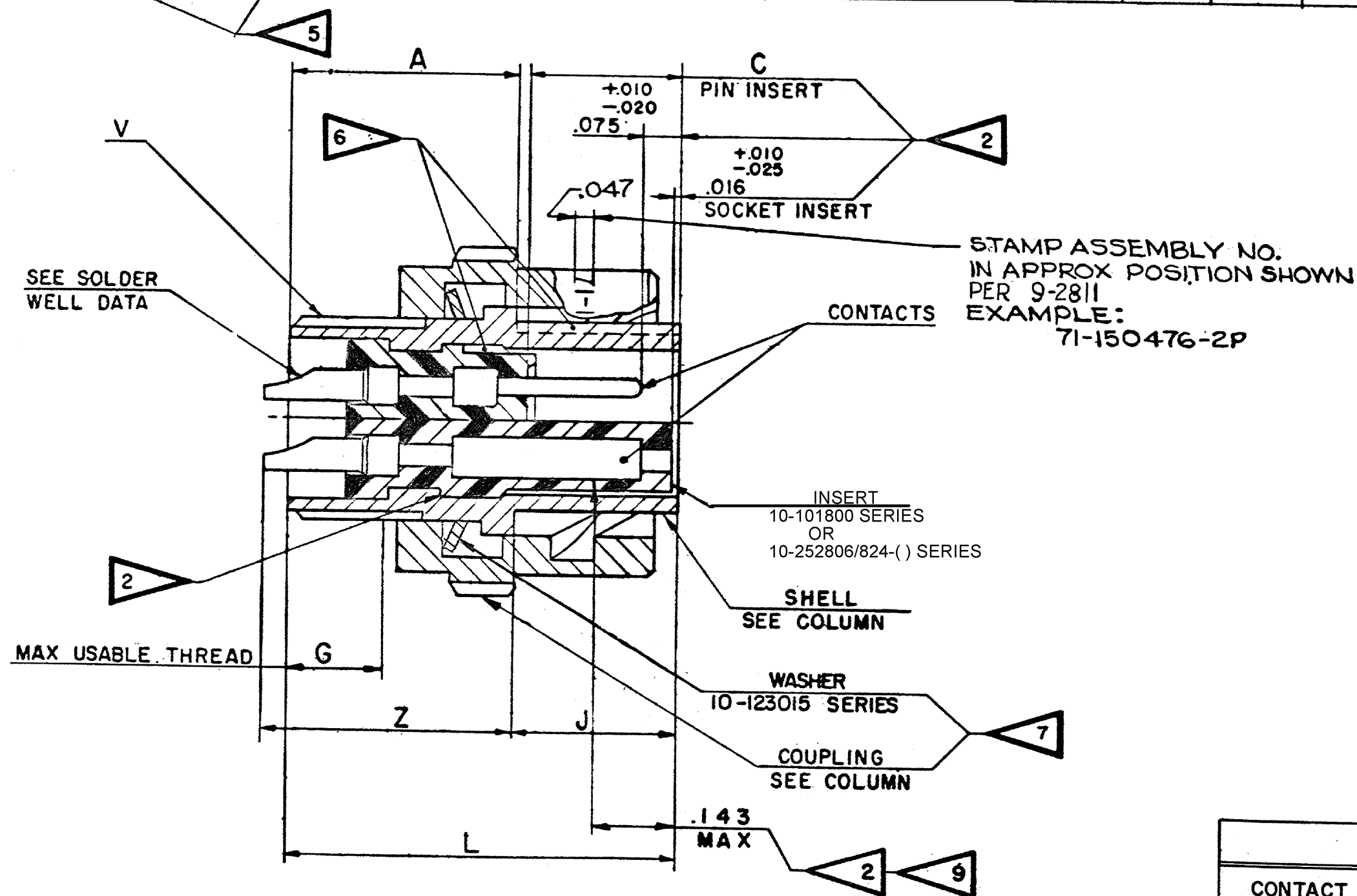

71-150475 THRU  
71-150499

NOTES: REF SYMBOL  $\triangle$

1. FOR CONTACT ARRANGEMENTS, SEE DRAWINGS L-15206( ) THRU L-15250( ).
2. DIMENSIONS MUST BE MAINTAINED WHEN INSERTS ARE PRESSED FIRMLY AGAINST INDICATED SHOULDER.
3. FOR MATING RECEPTACLE, SEE 71-146306 THRU 71-146350. & OTHERS.
4. FOR COMPONENT PART NUMBERS OF DESIRED ARRANGEMENT, SEE APPLICABLE PARTS LIST.
5. TO COMPLETE ASSY NO. AND PT NO. REF, ADD APPLICABLE INSERT ARRANGEMENT SUFFIX TO BASE NUMBERS LISTED ABOVE PER 9-2437-1.
6. VERTICAL CENTERLINES OF INSERT ARRANGEMENT & THE MAIN SHELL POLARIZING KEY TO BE WITHIN .005 OF INDICATED ROTATION PER 9-2437-1.
7. COUPLING SLOTS & WASHER TO BE LUBRICATED PER 9-3502.
8. INSERTS AND CONTACTS MUST NOT BE REMOVED.
9. DISTANCE BETWEEN END OF SHELL AND THE POINT AT WHICH A GAGE PIN, HAVING THE SAME BASIC DIAMETER AS THE MATING CONTACT AND A SQUARE FACE, ENGAGES SOCKET CONTACT SPRING.
10. UNITS ILLUSTRATED MEET THE MATERIAL & FINISH REQUIREMENTS OF MIL-C-26482.

SOLDER WELL DATA			
CONTACT SIZE	20	16	
WELL DIA	.046 <sup>+.004</sup> <sub>-.000</sub>	.078 <sup>+.004</sup> <sub>-.002</sub>	
WELL DEPTH	<sup>+.031</sup> <sub>-.000</sub>	.125	.188
UNLESS OTHERWISE SPECIFIED:			
LINEAR DIMENSIONS ARE IN INCHES. TOLERANCES: 3 PLACES ±.010; 2 PLACES ±.03; 1 PLACE ±.1; ANGLES ±2°. OTHER STANDARDS PER SCINTILLA SPEC 9-3800 AND MIL-STD 8.			
MATERIAL SPEC	PROCESS SPEC	DRAWN:	DATE:
	TEST	R. MASON	10-15-64
	9-3353-2	CHECKED:	DATE:
	ASSY	Keller	2-15-74
	9-3443-1	MATERIAL:	
	9-2437-1	STANDARDS:	
		DRAFTING:	
		ENGINEERING:	
		DEVELOPMENT:	
	9-3502		
	9-2811		

THE Bendix CORPORATION		SCINTILLA DIVISION SIDNEY, NEW YORK, U.S.A.	
TITLE: CONNECTOR, ELECTRICAL PLUG, TYPE PTCB ( ) MC, OLIVE DRAB,			
CODE IDENT NO.	SIZE	71-150475 THRU 71-150499	
77820	C		
SCALE NONE	WT SEE PARTS LIST	REF 72-150475/99	SHEET

THIS DOCUMENT CONTAINS INFORMATION OWNED BY THE BENDIX CORPORATION OR DEVELOPED AT ITS OWN PRIVATE EXPENSE AND MAY NOT BE USED, DUPLICATED OR DISCLOSED IN WHOLE OR IN PART FOR DESIGN, MANUFACTURE, OR PROCUREMENT WITHOUT THE WRITTEN PERMISSION OF THE BENDIX CORPORATION, ELECTRICAL COMPONENTS DIVISION. BY RETENTION OF THIS DOCUMENT, THE HOLDER AGREES THAT IT SHALL NOT BE USED IN ANY MANNER PROHIBITED HEREIN.

# Mouser Electronics

Authorized Distributor

Click to View Pricing, Inventory, Delivery & Lifecycle Information:

[Amphenol:](#)

[71-150477-06S](#)