

**SECTION A-A**  
End View of Assembly

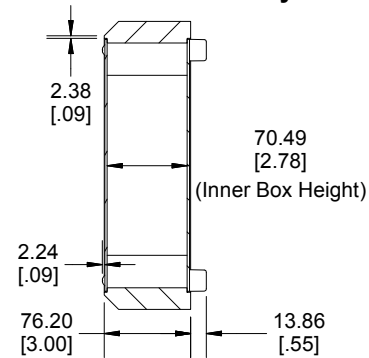

**SECTION A-A**  
Without Optional Bottom Panel

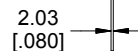
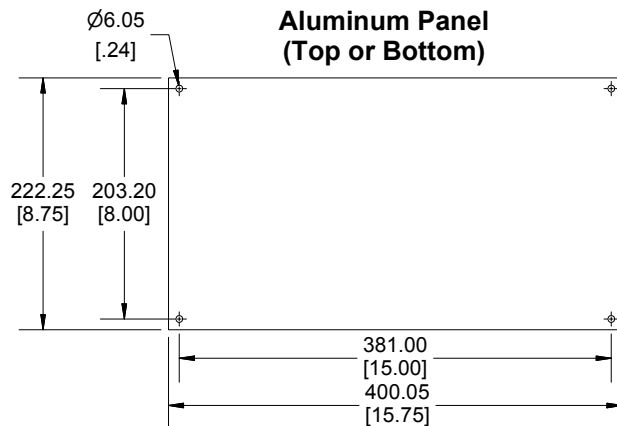
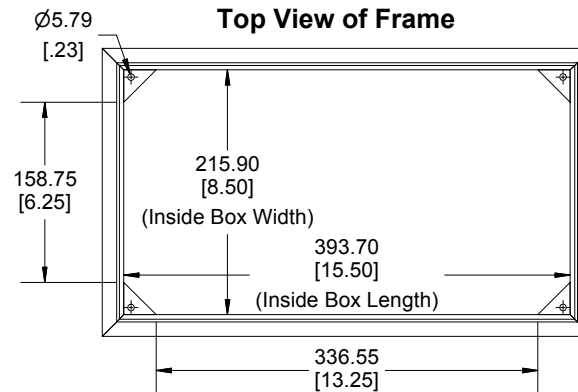
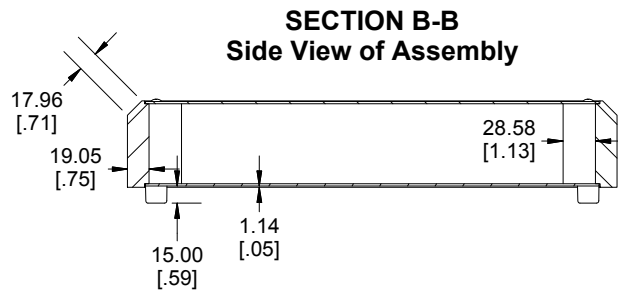
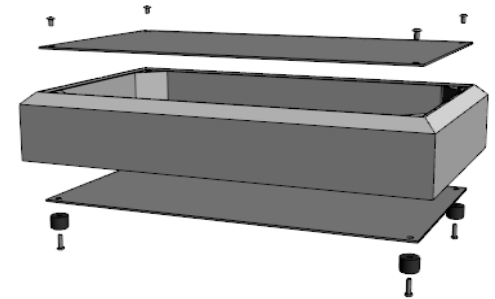
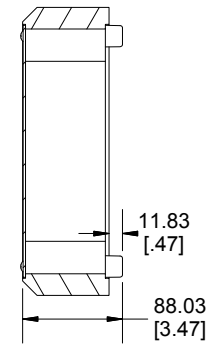

Enclosures can be Factory Modified ( Milling, Drilling, Printing etc.)  
Contact Factory [mjm@hammondmfg.com](mailto:mjm@hammondmfg.com) for quotes  
Solid models of this enclosure available in STEP or IGES.

**NOTE**

Chassis Includes Solid Walnut Frame, one (1) Aluminum Panel, Rubber Feet and Required Hardware  
Aluminum Panels are Made of 0.080" Aluminum.

**Screws should not be torqued past 4.43 lbf.in (50 cN.m)**

**PART NUMBERS**

**17"x10" Enclosure (Natural Finish)**

|                                   |              |
|-----------------------------------|--------------|
| Chassis with Natural Finish Panel | HWCHAS1710AL |
|-----------------------------------|--------------|

|                      |            |
|----------------------|------------|
| Natural Finish Panel | HW1710ALPL |
|----------------------|------------|

**17"x10" Enclosure (Satin Black)**

|                                |              |
|--------------------------------|--------------|
| Chassis with Satin Black Panel | HWCHAS1710BK |
|--------------------------------|--------------|

|                   |            |
|-------------------|------------|
| Satin Black Panel | HW1710BKPL |
|-------------------|------------|



Dimensions:  
mm  
[inches]

# Mouser Electronics

Authorized Distributor

Click to View Pricing, Inventory, Delivery & Lifecycle Information:

[Hammond:](#)

[HWCHAS1710BK](#)