

Plug 17PP111

KOBI CONN

Plug

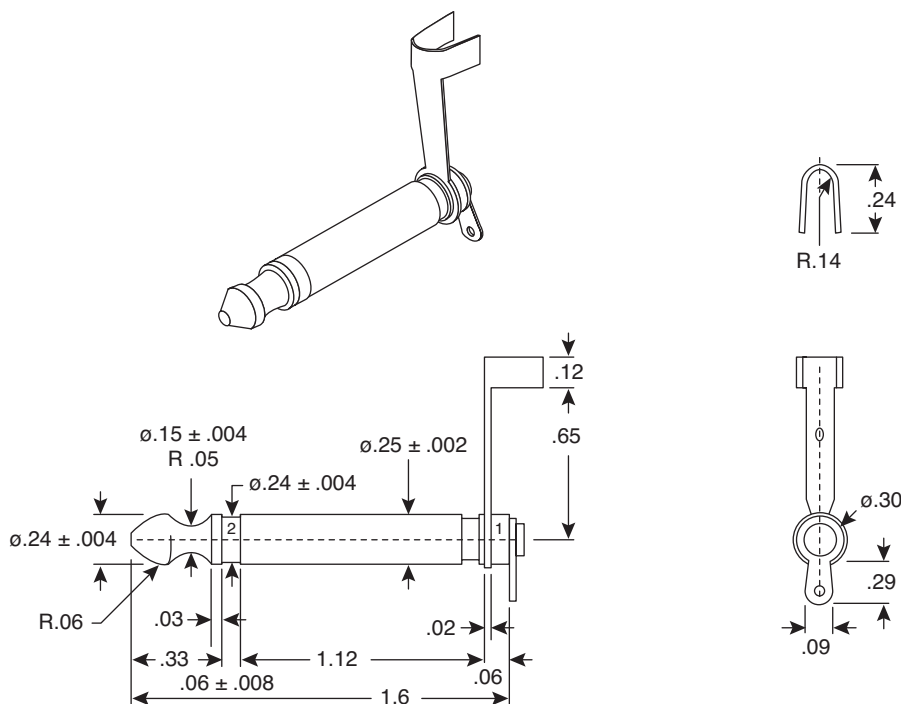

Dimensions: In.

SPECIFICATIONS	
Type:	1/4" mono, high rel. 2 conductor
Body:	custom molding
Solder terminal:	brass
Tube:	polyetherene
Insulator 1:	fiber
Insulator 2:	ebonite
Contacts:	nickle plated brass

Application Note:

Electrical conductivity of this plug could be effected if the molding process is not precisely controlled and engineered correctly. Factors such as temperature, pressure, and material used in the molding process can have an effect on the item being molded. Mouser has no control over these factors or the molding process and does not know enough about the various molding processes to recommend one for use. The user must determine the suitability of this product for his/her molding process.

Date Last Revised: 6/21/12

Available from Mouser Electronics
1-800-346-6873
www.mouser.com

KC-300049

Specifications are subject to change without notice. No liability or warranty implied by this information. Environmental compliance based on producer documentation.

17PP111

Mouser Electronics

Authorized Distributor

Click to View Pricing, Inventory, Delivery & Lifecycle Information:

[Kobiconn:](#)

[17PP111](#)