

Star Progetti Helios TOP15 Quartz Infrared Lamp

For use with all Infresco® Controllers

IP Rating	: IP65
Supply Voltage	: 220/240vAC
Supply Frequency	: 50/60Hz
Power Rating	: 1500 Watts

For full data-sheet – see following pages...



INFRARED ELECTRIC HEATER

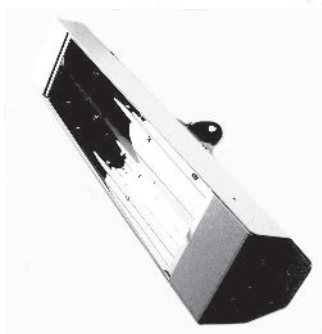
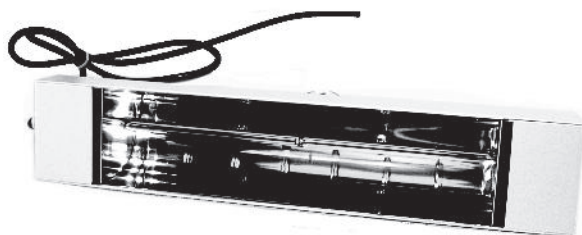

Heliosa®

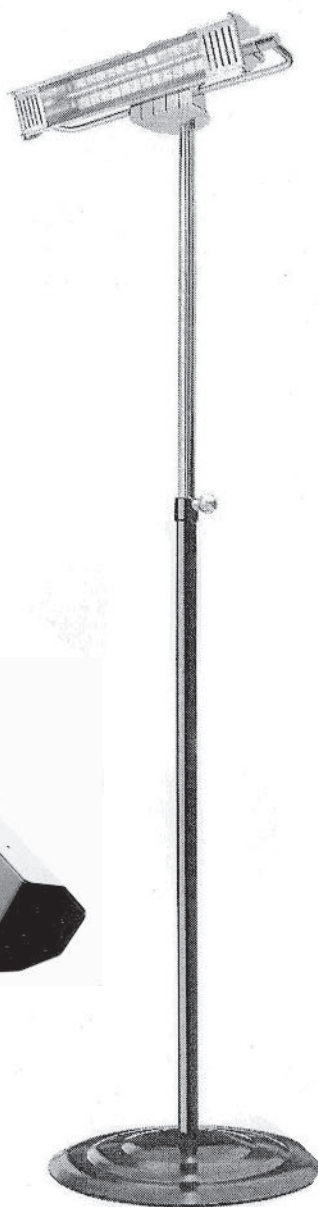

Internal Wiring Diagram

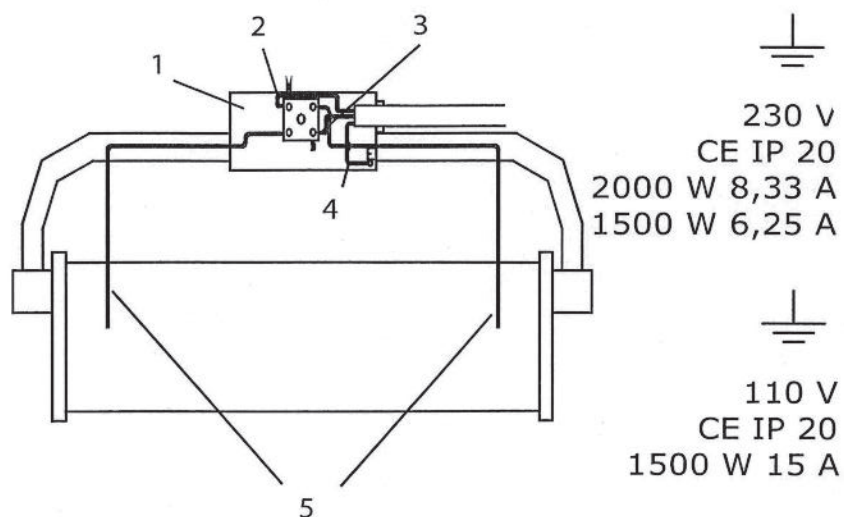

EN

- 1 = HEATER BASE COVER
- 2 = BROWN WIRE
- 3 = BLUE WIRE
- 4 = YELLOW WIRE/GREEN EARTH
- 5 = LAMP CONDUCTOR

Connection Diagram

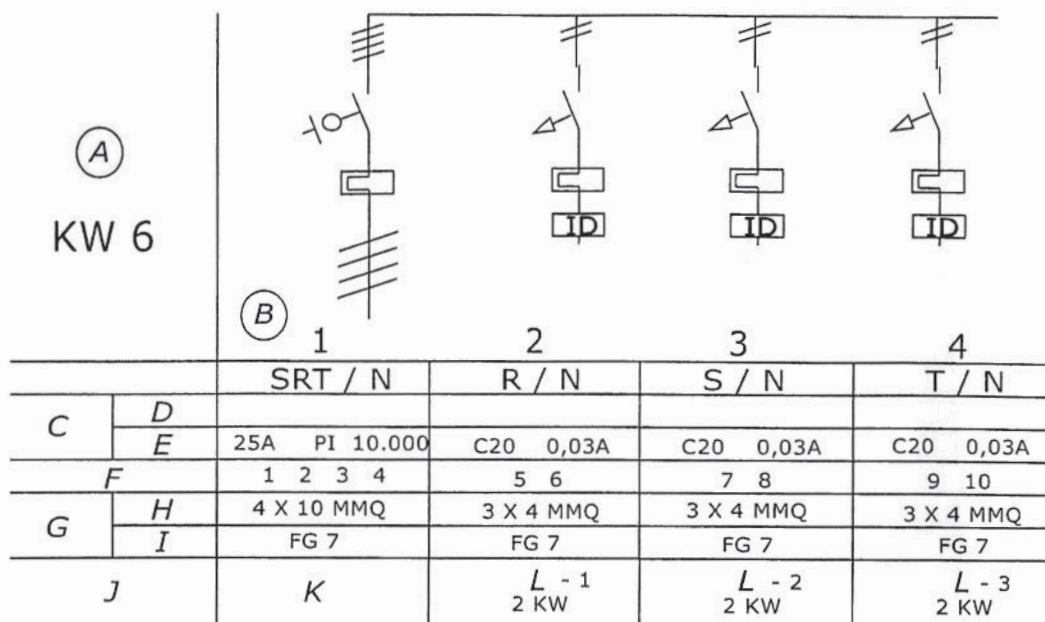

EN

- A** POWER; **B** CONTACTOR LINE; **C** CONNECTOR SWITCH; **D** TYPE ;
- E** CAPACITY; **F** NUMBER TERMINALS; **G** POWER LINE; **H** SIZE; **I** WIRE TYPE;
- J** USER; **K** MAIN SWITCH; **L** LAMP;

IMPORTANT!

1. The *Heliosa*® must be earthed.
2. Before opening the base, make sure that the appliance has been disconnected from the power supply.
3. Do not touch the halogen lamp with your hands. The guarantee will be rendered null and void if the lamp is touched. Only the terminal guards may be touched. If you accidentally touch the lamp surface, wipe it over immediately with a cloth moistened with alcohol.
4. Always position the appliance with the lamp horizontal.

POSITIONING HELIOSA® *Never install the heater in a vertical position.*

1. In compliance with the heating system requirements, fix *Heliosa*® by means of the holes in the rear of the connection box. The installation height is usually between 2.5 and 3.0 meters.
2. Connect *Heliosa*® to a single-phase 230 V / 110 V power supply (according to the country).
3. Adjust the *Heliosa*® reflector in the direction of the beam required (usually at an angle of..1.5 degrees in relation to the horizontal plane).
4. NEVER install *Heliosa*® on an inflammable surface. Never direct the heater towards inflammable surfaces.
5. Install *Heliosa*® at a free distance (in a visual line) of no less than 2 m from objects made of cardboard, fabric, etc. or windows. In workshops or garages where paints or fuels are stored, install *Heliosa*® at a distance of no less than 4 m from inflammable products.
6. Install *Heliosa*® at a safe distance of 3 mt from people.
7. To prevent damage to the lamp, NEVER use *Heliosa*® in dusty closed rooms.

CONNECTING TO THE POWER SUPPLY

1. Make sure that the power supply corresponds to the power requirements of the appliance.
2. Use a 3-wire power cable with heat-resistant PVC sheath (usually - 3 x 1.5 mm²).

BATHROOMS

When installing *Heliosa*® in bathrooms, make sure that it is positioned out of reach of persons using the bathtub or the shower.

WALL INSTALLATION

1. Rotate the rear plate by 90°, then secure to the wall.
2. Gently rotate the appliance until it is positioned horizontally in relation to the wall.
3. Ensure that the appliance is installed at a distance of no less than 200 mm from the ceiling.

INSTALLATION REQUIREMENTS

1. Switch each single appliance on then off; do not use the main switch to test the appliances, as voltage surges could burn out the halogen lamps.
2. *Heliosa*® heaters are designed for indoor installation. The appliances may be installed outdoors provided that they are protected against the elements.
3. The Manufacturer declines all responsibility for failure to observe appliance use instructions.
4. Always install the appliance in a perfectly horizontal position.

SWITCH NOMINAL POWER RATING

Always bear in mind the high current surge of the appliance when it is switched on when choosing switches, disconnection devices, relays, contactors and so on.

CEILING INSTALLATION

When installing the heater on the ceiling, ensure that it is perfectly horizontal.

ATTENTION

For a correct positioning of the reflector, it is necessary to hold firmly the side shells and tilt the reflector. This operation must be done when the reflector is off (page. 4 fig. C).

Heliosa® mod. a parete / Heliosa® wall model

Installation to wall

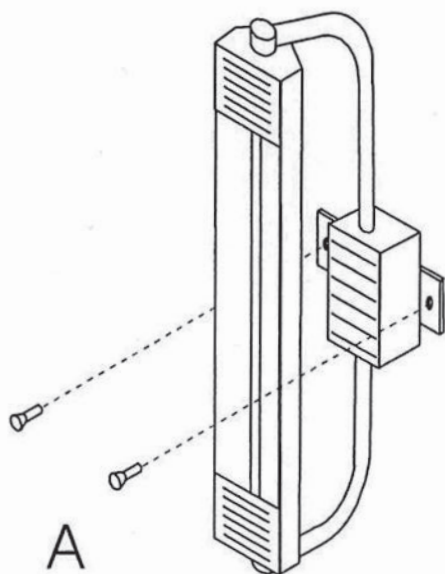

-Turn the back plate by 90° and fix it on the wall

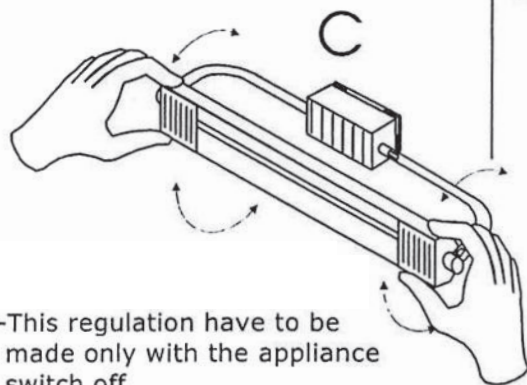

-This regulation have to be made only with the appliance switch off

Examples for fixing to wall and to ceiling

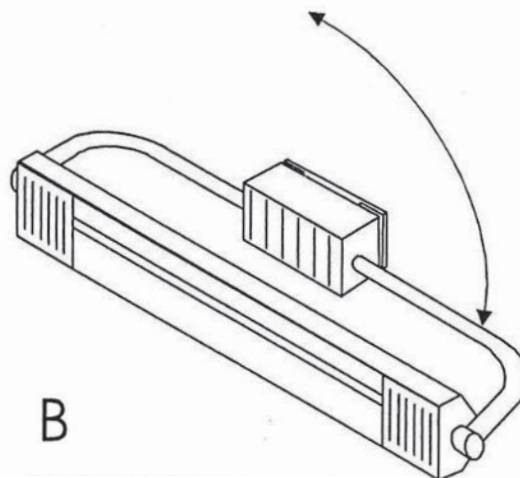

- Turn slowly Heliosa to assure it's installed in perfect horizontal position from the wall.

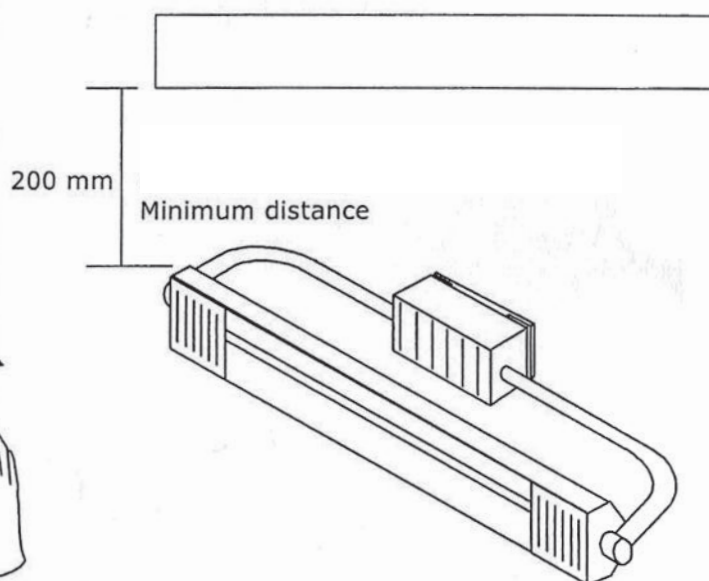

Heliosa lamps are supplied with

Infresco®

United Automation Ltd
Wight Moss Way
Southport, PR8 4HQ.
www.infresco.co.uk
info@infresco.co.uk

Heliosa® is equipped with  **HeLeN PHILIPS** lamps



STAR PROGETTI
TECNOLOGIE APPLICATE SRL
Via Pasubio 4/D
20067 TRIBIANO (MI) - Italia
TEL. 0039 02-90.63.92.61 r.a.
FAX 0039 02-90.63.92.59
E-mail: info@starprogetti.com
www.starprogetti.com

