

# KSA & KSL Series

## Sealed Tact Switch



### Specifications

Contact Arrangement	SPST, N.O.	
Sealing	IP60	
Terminals	PC pins, ground pins	
Electrical	Silver	Gold
Maximum Power	1 VA	0.2 VA
Min. / Max. Voltage	1 - 32VDC	
Min. / Max. Current	1 - 50 mA	1 - 10 mA
Dielectric Strength	250 Vrms	
Contact Resistance	≤ 100 mΩ	
Insulation Resistance	(100 V): ≥ 10 <sup>9</sup> Ω	
Bounce Time	≤ 1 ms	
Environmental		
Operating Temperature	-40°C to 85°C	-40°C to 85°C
Storage Temperature	-40°C to 85°C	-55°C to 85°C
Process		
Packaging	Delivered in boxes of 500 pieces for manual insertion (250 pieces for KSL,KSLV, KSAV).	
Soldering	Wave soldering compatible with lead free soldering profile	

### Description

C&K's KSA series sealed tact switches feature top or side actuation and cambered terminals for secure self-retention. Designed for both automated and manual insertion processes, these switches offer high reliability and ease of integration. Their robust construction and versatile mounting options make them ideal for use in telecommunication networks, industrial systems, and automation applications.

### Features & Benefits

- Designed for automatic or manual insertion
- Cambered terminals to ensure self retention
- Top or side actuated
- Large choice of caps
- RoHS compliant and compatible

### Applications

- Automotive
- Industrial
- Telecommunication networks

### Mechanical Characteristics

Part #	Actuation Force (N)	Operating Life (operations)	Travel (mm)
KSA0M211	1.4 ± 0.4	100,000	0.5 ± 0.2
KSA0M411	3 ± 0.75	100,000	0.6 ± 0.2
KSA0M511	5 ± 1.5	100,000	0.7 ± 0.2
KSL0M211	1.4 ± 0.4	100,000	0.5 ± 0.2
KSL0M411	3 ± 0.75	100,000	0.6 ± 0.2
KSL0M511	5.4 ± 1.65	100,000	0.7 ± 0.2

#### Notes

1. Other versions in terms of force, termination length and corrosion protection available. Please contact your sales representative. This data sheet does not provide enough information for applications which require a certain level of quality or safety such as automotive, medical systems, safety equipment. Please contact your sales representative to get contractual specification package.

# KSA & KSL Series

## Sealed Tact Switch



### Ordering Number

Our easy build-a-switch concept allows you to mix and match options to create the switch you need. To order, select desired option from each category and place it in the appropriate box. However, please note that all the combinations of these options are not feasible. For any part number different from those listed above, please consult your local representative.

### Switch

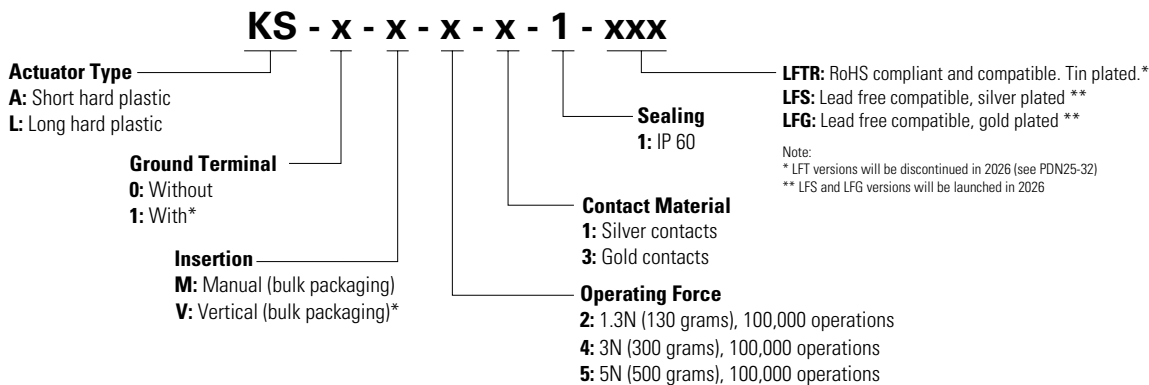

### Notes

1. "1" Ground terminal not compatible with "V" insertion

### Contact Material

Option Code	Contact Material
1	Silver Contacts
3	Gold Contacts

### Sealing

Option Code	Sealing
1	Sealing level IP60

### Buttons

## BTN K0x - xx

### Button Style

**K01:** 10 mm square snap-on  
**K02:** Ø8 mm round snap-on  
**K03:** 8.5 x 3.8 mm single floating

### Button Color

**10:** Dark gray   **60:** Blue  
**20:** Light gray   **70:** Gray-blue  
**30:** Yellow   **80:** Ivory  
**40:** Red   **90:** Black  
**50:** Green

### Buttons

Button Type	KSA	KSL	KSAV	KSLV
K01	x			
K02	x			
K03	x	x	x	x

### Notes:

Buttons must be ordered separately and will be supplied in bulk.

# KSA & KSL Series

Sealed Tact Switch



Actuator type  
KSA & KSL

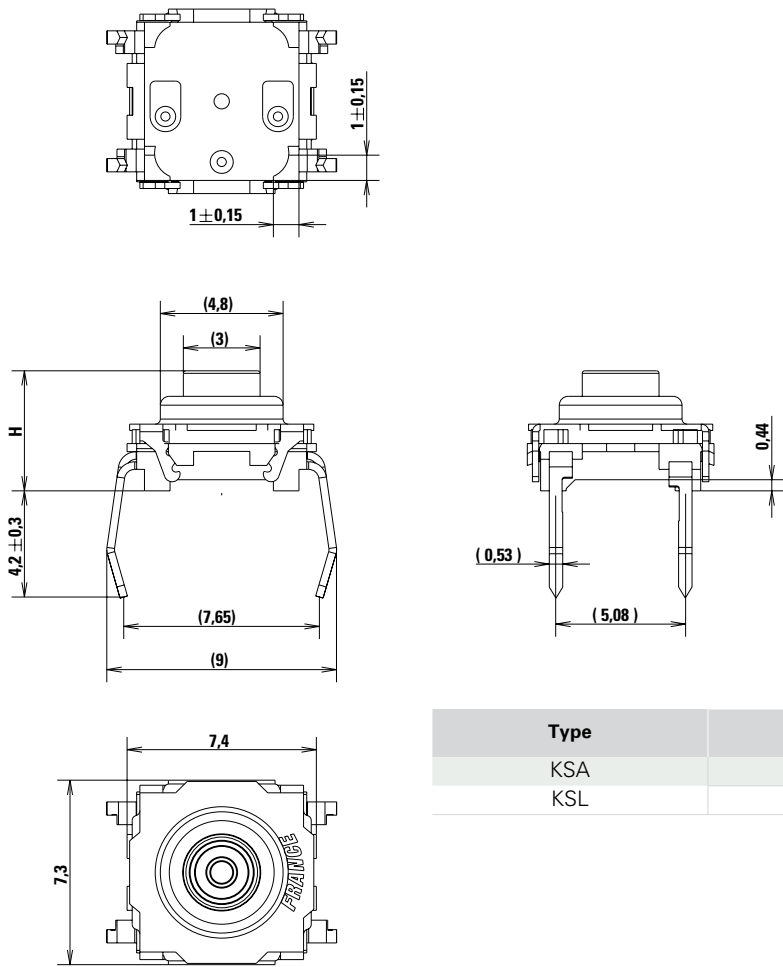

Type	H mm
KSA	$4.75 \pm 0.3$
KSL	$9.9 \pm 0.3$

Ground Terminal

0 Without

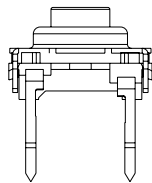

1\* With

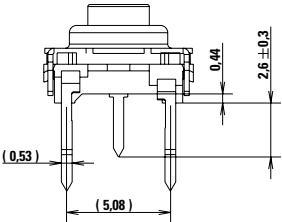

Notes  
1. Not compatible with "V" insertion

# KSA & KSL Series

## Sealed Tact Switch



### Insertion

#### M Manual (Bulk Packaging)

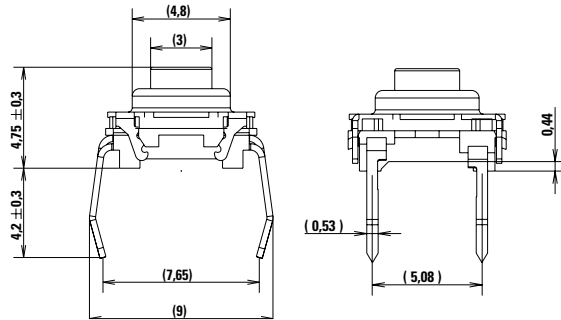

#### PCB Layout

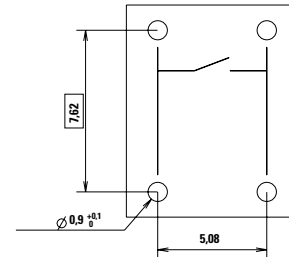

#### V Vertical (Bulk Packaging)

##### KSA

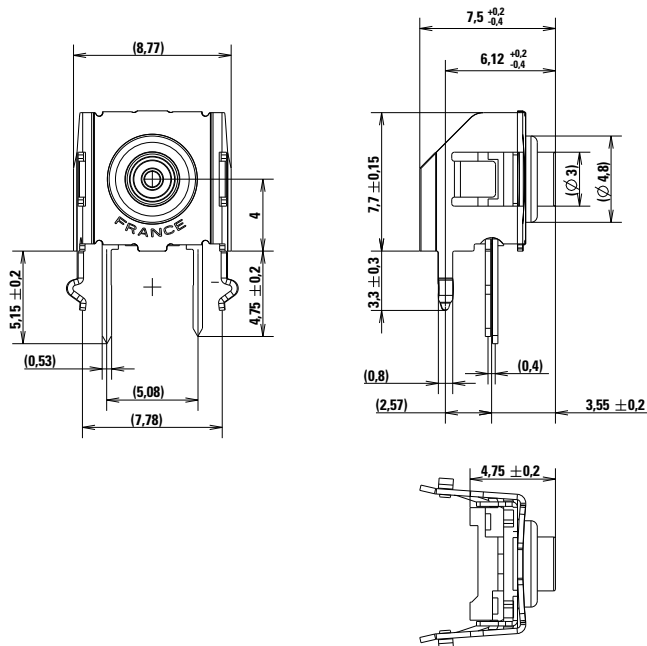

##### KSL

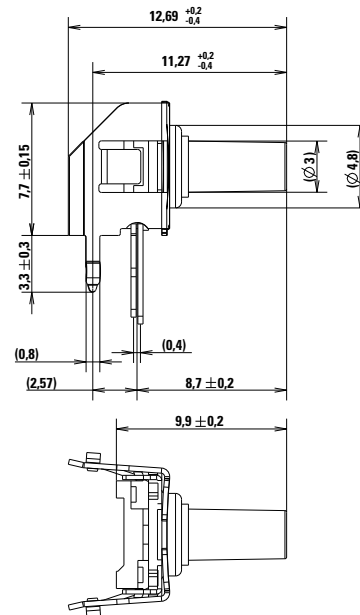

#### PCB Layout

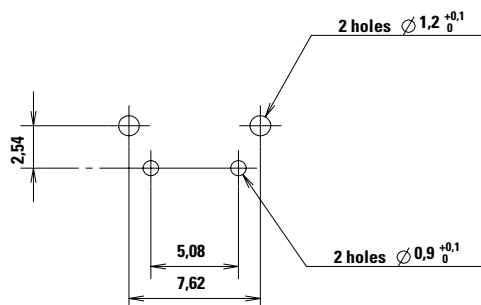

# KSA & KSL Series

## Sealed Tact Switch



### Buttons Dimensions (mm)

#### K01

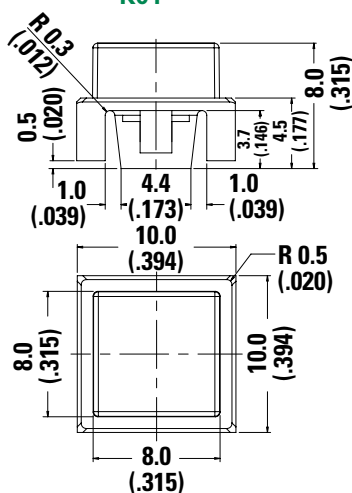
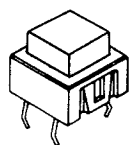

#### K02

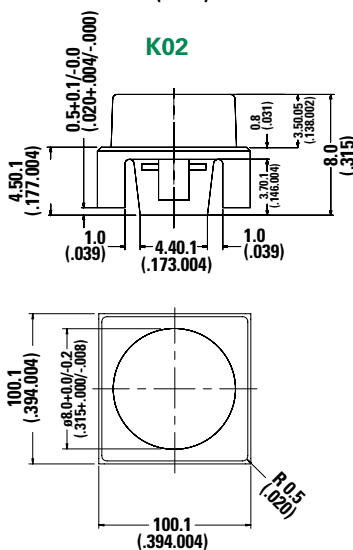
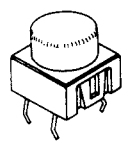

#### K03

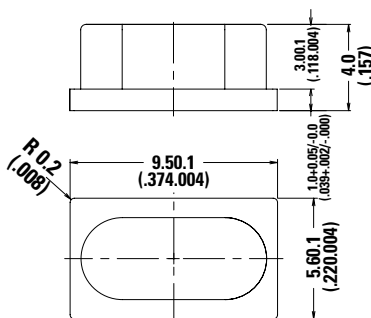
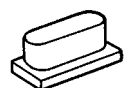

### Liability Limitation

This datasheet does not provide enough information for applications that require a certain level of quality or safety such as automotive, medical systems, or safety equipment. Please contact customer service for the contractual specification package.

**Disclaimer Notice** - Information furnished is believed to be accurate and reliable. However, users should independently evaluate the suitability of and test each product selected for their own applications. Littelfuse products are not designed for, and may not be used in, all applications. Read complete Disclaimer Notice at <http://www.littelfuse.com/disclaimer-electronics>.