

TF

D-Sub connectors - Stamped and Formed Contacts

PRESS FIT STRAIGHT PCB TERMINATION

UL File: E149426

CHARACTERISTICS

| Materials and Platings | |
|------------------------|---|
| Shells | Steel, tin plated |
| Insulator | Glass-filled thermoplastic, UL 94V-0 |
| Contacts | Brass, selected gold in mating area; 2.54µm (100µ") min. tin on termination area over 1.27µm (50µ") min. nickel |
| Rear inserts | Brass, 2.54µm (100µ") min. nickel plated |
| Boardlocks | Brass, 2.54µm (100µ") min. tin over 1.27µm (50µ") min. nickel plated |
| Screwlocks | Brass, 2.54µm (100µ") min. nickel plated |

| Electrical Data | |
|------------------------------|----------------------------------|
| Current rating | 3A |
| Voltage rating | 300V AC |
| Withstanding voltage | 1000V AC/rms 60Hz for one minute |
| Insulation resistance | 1000MΩ |
| Contact resistance | 25mΩ max |

| Climatic Data | |
|------------------------------|-----------------|
| Operating temperature | -55°C to +125°C |
| Salt spray | 24 hours |

| Mechanical Data | |
|---|---|
| Single contact insertion force | ≤ 3.60 N |
| Single contact withdrawal force | ≥ 0.2 N |
| Single contact insertion on board | ≤ 100 N |
| Single contact withdrawal from board | ≥ 20 N |
| Standard plating thickness | Gold flash 0.4µm (15µ") gold 0.76µm (30µ") gold |

| | Terminal Specification | Boardlock Specification |
|----------------------------------|---------------------------------------|---|
| Finished Hole Cu Sn | 1 (+0.09 -0.06) > 25 µm < 15 µm | 3.1 +/- 0.05 mm Min 25 µm 5-15 µm |

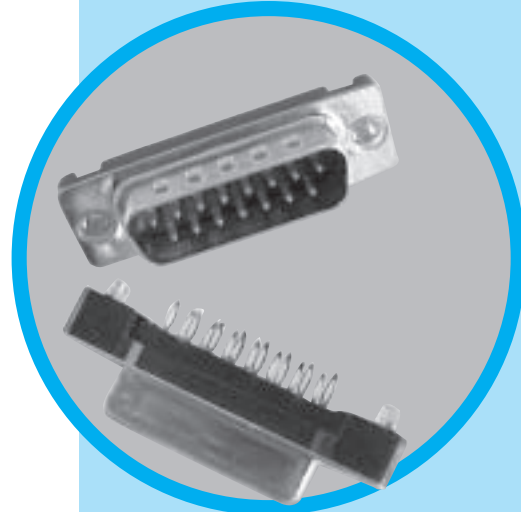

DESCRIPTION

The Amphenol "TF" series features eye of needle formed contacts, and insulator with closed entry contacts cavities.

This series gives you Amphenol's high standards of quality and reliability to meet all your technical requirements.

*Solderless
straight PCB
mount
connectors*

APPLICATIONS

- Industrial
- Telecom
- Any backplanes connections



Amphenol

TF / E4

Socket version

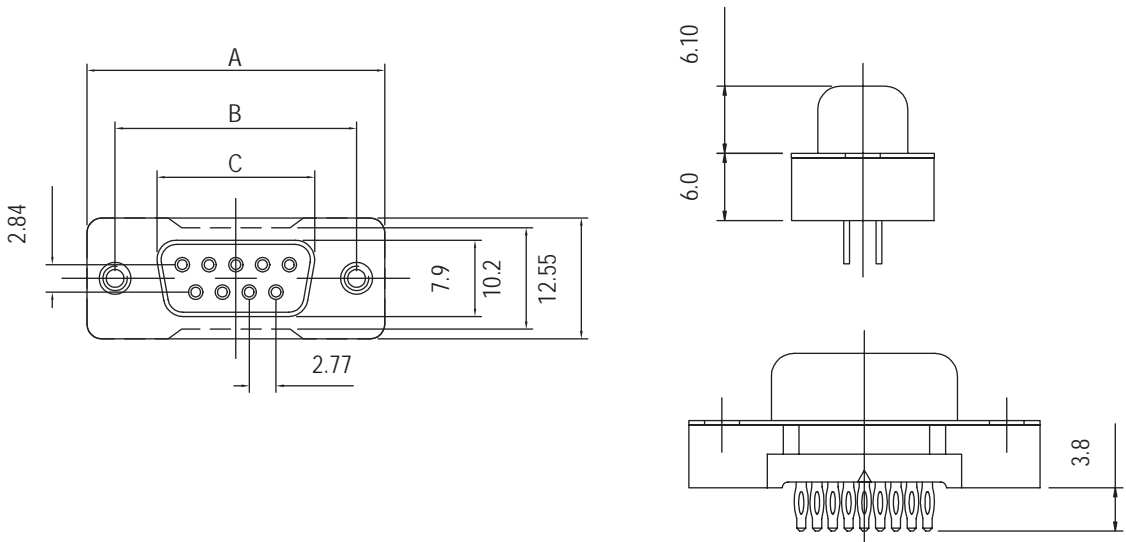

Plug version

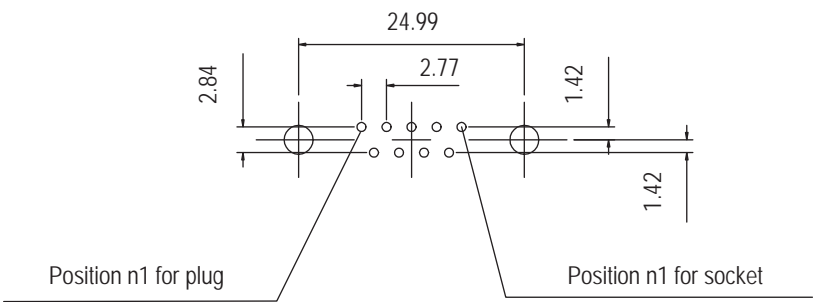
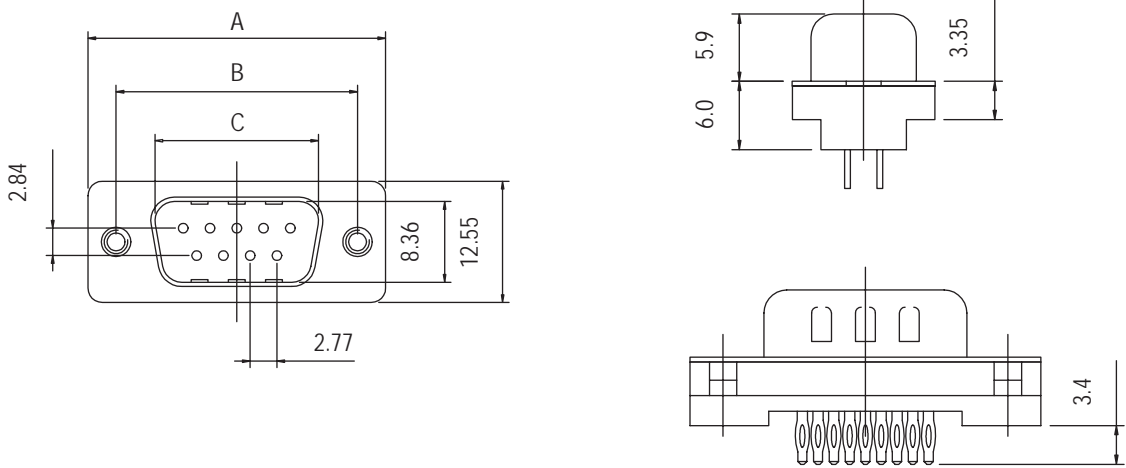

For PCB holes diameters, see on page 1 (finished holes)

| Nb OF CONTACTS | DIMENSIONS mm (inch) | | | |
|----------------|----------------------|---------------|---------------|---------------|
| | A | B | C plug | C socket |
| 9 | 30.81 (1.185) | 24.99 (0.984) | 16.92 (0.666) | 16.33 (0.643) |
| 15 | 39.14 (1.54) | 33.32 (1.312) | 25.50 (1.004) | 24.66 (0.97) |
| 25 | 53.04 (2.088) | 47.04 (1.852) | 28.96 (1.534) | 38.38 (1.511) |
| 37 | 69.32 (2.729) | 63.50 (2.5) | 55.42 (2.182) | 54.84 (2.16) |

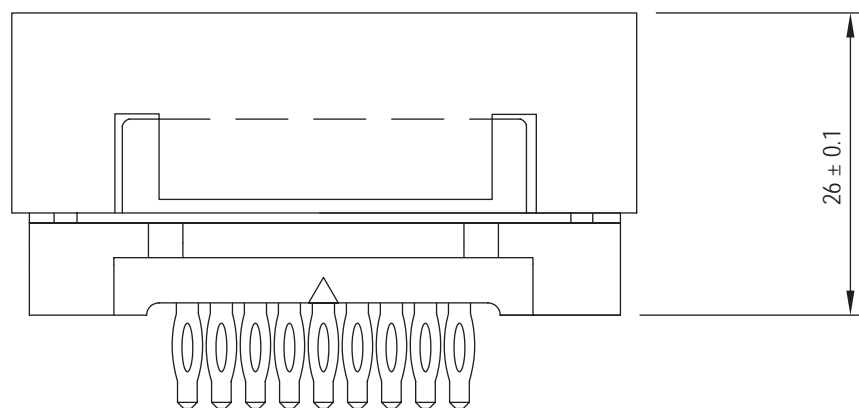

Female

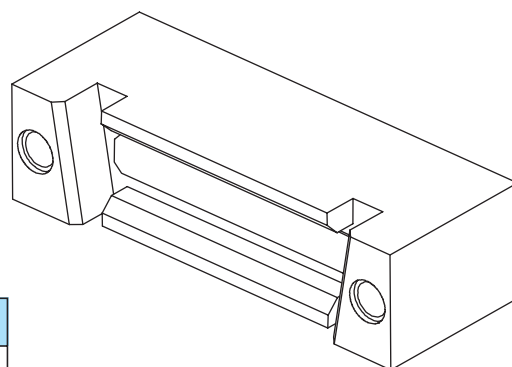

| Size of connectors | Tooling PN |
|--------------------|------------|
| 9 | 981 MC |
| 15 | 982 MC |
| 25 | 983 MC |
| 37 | 984 MC |

Male

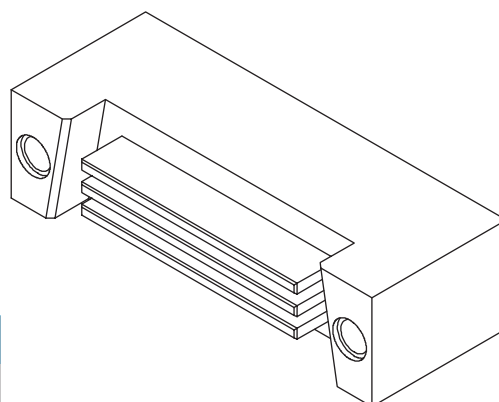

| Size of connectors | Tooling PN |
|--------------------|------------|
| 9 | 985 MC |
| 15 | 986 MC |
| 25 | 987 MC |
| 37 | 988 MC |

Board mounting option

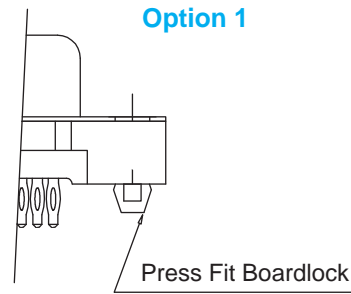
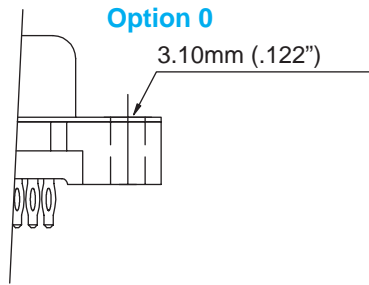

Flange mounting option

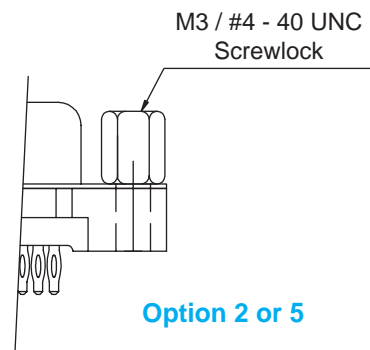
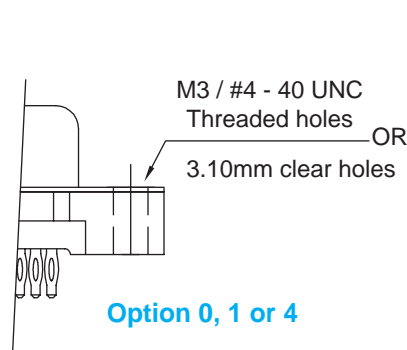

How to order

L 17TF ...

RoHS Compliant

Series

Number of contacts : 09-15-25-37

Contact type:
1 = pin
0 = socket

Contact plating
0 = gold flash
1 = 0.4 μm (15 μ)
2 = 0.76 μm (30 μ)

Flange mounting option :
0 = 3.10mm clear hole
1 = #4-40 threaded hole
2 = #4-40 threaded hole with #4-40 UNC screwlock installed
4 = M3 threaded hole
5 = M3 threaded hole with M3 screwlock installed

Board mounting option
0 = without boardlock
1 = with boardlock

Front shell plating
1 = tin over nickel

Do not hesitate to contact us for further information

Amphenol

Amphenol IT & Communication Products

Block A3/A4, The 4th Industrial District of
Industrial Headquarters, Dong Keng Road
Gong Ming Town, Shen Zhen China
Fax: +86(0)755 2754 9955

Technical Support

Tel: +86(0)755 2717 7945
Info-dsub@amphenol.com.cn
<http://www.dsubconnector.com>