

PE000DM6E Product Details



PE000DM6E

TE Internal Number: 4-1609154-5



Active

EMI/RFI Filters and Accessories



Always EU RoHS/ELV Compliant (Statement of Compliance)

Product Highlights:

- Filter - EMI/RFI
- Filter Type = Power Entry (Filtered/Unfiltered)
- Used With P Series
- P (3-10 Amp) Series
- Medium Performance Application

Documentation & Additional Information

Product Drawings:

- [CATALOG MEDIUM P SERIES](#) (PDF, English)

Catalog Pages/Data Sheets:

- [5-1773464-0_CORCOM_MEDIUM_P_SERIES_FILTERS](#) (PDF, English)

Product Specifications:

- None Available

Application Specifications:

- None Available

Instruction Sheets:

- None Available

CAD Files: ([CAD Format & Compression Information](#))

- [2D Drawing](#) (DXF, Version A)
- [3D Model](#) (IGES, Version A)
- [3D Model](#) (STEP, Version A)

Additional Information:

- [Product Line Information](#)

Related Products:

- [Tooling](#)

Product Features (Please use the Product Drawing for all design activity)

Product Type Features:

- [Product Type](#) = Filter - EMI/RFI
- [Filter Type](#) = Power Entry (Filtered/Unfiltered)
- [Series](#) = P (3-10 Amp)
- [Filtered](#) = Yes
- Type of Connector = IEC 60320-1 C-14

Mechanical Attachment:

- Shield Style = Complete Can

Electrical Characteristics:

- [Input Voltage Select](#) = Single AC Voltage
- [Current Rating \(A\)](#) = 6
- [Voltage Selection](#) = Single
- [Voltage ≤ \(VAC\)](#) = 250

Termination Features:

- [Terminal Input - Output Combination](#) = IEC - .187" Faston

Body Features:

- [Used With](#) = P Series
- [Mount Style](#) = Mounting Ears (Horizontal)
- Switch Type = No Switch

Configuration Features:

- [Fuse Options](#) = Dual
- [Fuse Holder Type](#) = Selectable

Industry Standards:

- [RoHS/ELV Compliance](#) = RoHS compliant, ELV compliant
- [Lead Free Solder Processes](#) = Not relevant for lead free process
- RoHS/ELV Compliance History = Always was RoHS compliant

Operation/Application:

- [Application](#) = Medium Performance

Other:

- Brand = Corcom

THIS DRAWING IS UNPUBLISHED.

RELEASED FOR PUBLICATION

20

© COPYRIGHT 20

BY -

ALL RIGHTS RESERVED.

LOC

DIST

REVISIONS

P

LTR

DESCRIPTION

DATE

DWN

APVD

X53

-

A

ECO-10-017557

10JAN2012

EC

EC

MINIMUM INSERTION LOSS, 50Ω LINE AND LOAD IMPEDANCES

LINE TO GROUND (COMMON MODE)

LINE TO LINE (DIFFERENTIAL MODE)

CURRENT RATING

FREQUENCY, MHz

3 AMP

6 AMP

10 AMP

.15

.5

1

3

10

30

CURRENT RATING

FREQUENCY, MHz

3 AMP

6 AMP

10 AMP

.15

.5

1

3

10

30

SCHEMATIC

PANEL CUT-OUT

1.575

PE VERSIONS

1.120^{+.008}_{-.000}

2.201^{+.008}_{-.000} *

2.496

PM VERSIONS

R.06

Ø.135

FOR PS VERSIONS THE SHORT EDGES MUST HAVE R.02 ON INSERTION SIDE.

* FOR PANEL THICKNESS 0.031-0.079 USE 2.201

FOR PANEL THICKNESS 0.083-0.114 USE 2.213.

ALLOW .15 FOR SWITCHED VERSIONS

2.71

2.43

2.73

Ø.13

Ø.23

2.88

PM SHOWN WITH SWITCH

2.71

2.43

2.73

PE

2.75

PS

1.22

2.29

PS SNAP-IN MOUNTING

2.73

2.45

2.75

PS

1.95

Ø.13

Ø.23

PE SHOWN WITHOUT SWITCH

2.71

2.43

2.73

PE

2.71

2.43

2.73

PM

2.71

2.43

2.73

PS

PART NUMBER SYSTEM

P

S

0

S

0

S

M

6

E

MOUNTING STYLE

S = SEE ABOVE

E = SEE ABOVE

M = SEE ABOVE

SWITCH OPTIONS

0 = NONE

S = DOUBLE POLE, SINGLE THROW

CURRENT

3 = 3 AMP

6 = 6 AMP

X = 10 AMP

FUSE LOCATIONS

D = DUAL FUSING

S = SINGLE FUSING

INCLUDES CONVERSION CLIP

PS0S0SM6E EXAMPLE:

SNAP-IN MOUNTING

WITH SWITCH

SINGLE FUSING

6 AMP

0'S ARE ZEROS.

HIPOT RATING (ONE MINUTE)

LINE TO GROUND: 1500 VAC

LINE TO LINE: 1450 VDC

OPERATING FREQUENCY: 50/60 Hz

RATED VOLTAGE: 120/250 VAC

FUSING: ACCEPTS 3AG Ø 1/4" X 1-1/4" OR METRIC Ø 5 mm X 20 mm

OPERATING AMBIENT TEMP: -10°C TO 40°C

STORAGE TEMPERATURE: -40°C TO 85°C

MAX LEAKAGE CURRENT .25mA @ 120V 60Hz

PER LINE TO GROUND: .50mA @ 250V 60Hz

HUMIDITY: 21 DAYS, 40°C @ 95%RH

CURRENT OVERLOAD: 6X RATED FOR 8 SEC

SWITCH: 10K CYCLES @ 51 AMP INRUSH

TERMINALS: 0.187" X .032 FASTON TABS

SAFETY AGENCIES: UL RECOGNIZED, CSA CERTIFIED, VDE APPROVED.

THIS DRAWING IS A CONTROLLED DOCUMENT.

DWN EC 20DEC2011

CHK - 20DEC2011

APVD EC 20DEC2011

PRODUCT SPEC -

APPLICATION SPEC -

WEIGHT -

CUSTOMER DRAWING

DIMENSIONS: INCHES

TOLERANCES UNLESS OTHERWISE SPECIFIED:

0 PLC ±.2

1 PLC ±.1

2 PLC ±.02

3 PLC ±.005

4 PLC ±.0005

ANGLES ±1

MATERIAL -

FINISH -

NAME

MEDIUM P SERIES

SWITCHED, FUSED,

2-STAGE FILTERED INLET

SIZE

CAGE CODE

DRAWING NO

RESTRICTED TO

A300779

©-MEDIUM-P-SERIES

SCALE 1:2

SHEET 1 OF 1

REV A



Introducing Corcom Medium Performance P Series Power Entry Modules

TE Connectivity has expanded the Corcom P Series power entry modules to include a new medium performance filter option. The medium P Series modules features better performance than the standard filter option in a smaller size than the high performance filter. Filters are available in 3, 6 or 10A ratings. Modules are available in either snap-in or flange mount versions with a choice of horizontal or vertical mounting ears. The medium performance P Series modules are available with either single or dual fuses and may be configured with an optional DPST switch. The medium performance P Series modules are suitable for applications with increased attenuation requirements in higher frequencies where a smaller size is desirable.





KEY FEATURES

- Dual stage electrical setup
- High attenuation at higher frequencies
- Compact design
- Snap-in or flange mounting
- Standard IEC 60321-1 C14 power inlet
- Optional DPST switch
- Single or dual North American or Metric fusing capabilities
- UL Recognized, CSA Certified and VDE Approved

APPLICATIONS

- Switch mode power supplies
- Vending & service machines
- Computing & accessories
- Home appliances
- Gaming equipment
- Fitness equipment
- Measuring & test equipment
- Instrumentation

STANDARDS AND SPECIFICATIONS

- UL Recognized
- CSA Certified
- VDE Approved



ELECTRICAL SPECIFICATIONS

Maximum leakage current each Line to Ground:	@120 VAC 60 Hz:	.25 mA
	@ 250 VAC 50 Hz:	.50 mA
Hipot rating (one minute):	Line to Ground:	2250 VDC
	Line to Line:	1450 VDC
Rated Voltage (max.):		250 VAC
Operating Frequency:		50/60 Hz
Rated Current:		3 to 10A
Fuseholder:		Accepts one or two fuses .25 x 1.25" (not included) or 5 x 20mm (not included)
Switch:		DPST 10,000 operations at 51A max. inrush

ELECTRICAL SCHEMATICS

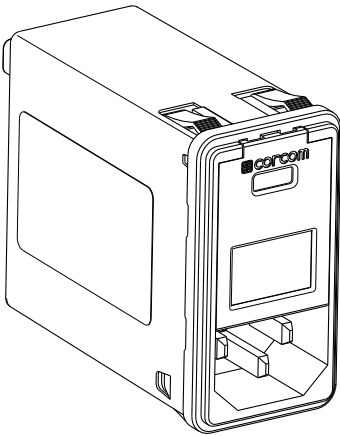
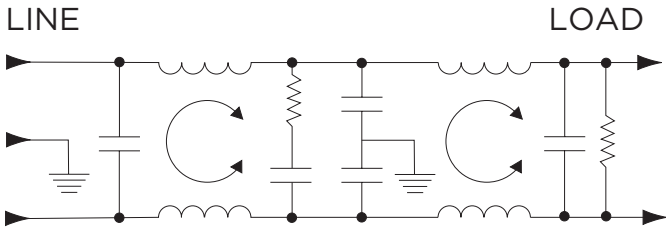

ORDERING INFORMATION

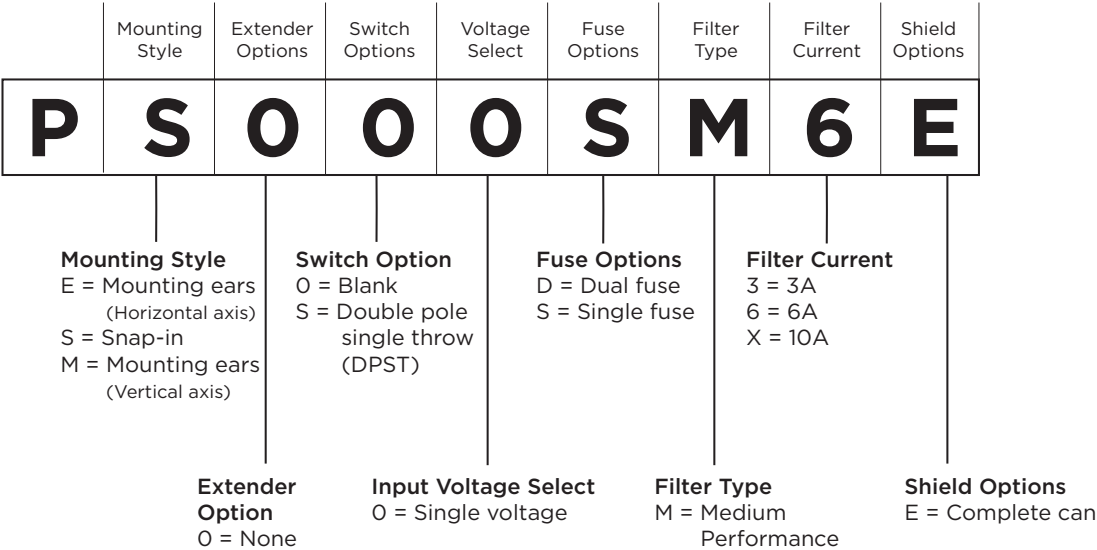

PRODUCT OFFERING

E Style Mounting Ears		M Style Mounting Ears		Snap-In	
4-1609154-1:	PEO0SM3E	4-1609155-3:	PM00SM3E	4-1609152-7:	PS00SM3E
4-1609154-2:	PEO0SM6E	4-1609155-4:	PM00SM6E	4-1609152-8:	PS00SM6E
4-1609154-3:	PEO0SMXE	4-1609155-5:	PM00SMXE	4-1609152-9:	PS00SMXE
4-1609154-4:	PEO0DM3E	4-1609155-6:	PM00DM3E	4-1609153-0:	PS00DM3E
4-1609154-5:	PEO0DM6E	4-1609155-7:	PM00DM6E	4-1609153-1:	PS00DM6E
4-1609154-6:	PEO0DMXE	4-1609155-8:	PM00DMXE	4-1609153-2:	PS00DMXE
4-1609154-7:	PEOSM3E	4-1609155-9:	PMOSM3E	4-1609153-3:	PSOSM3E
4-1609154-8:	PEOSM6E	4-1609156-0:	PMOSM6E	4-1609153-7:	PSOSM6E
4-1609154-9:	PEOSMXE	4-1609156-1:	PMOSMXE	4-1609153-5:	PSOSMXE
4-1609155-0:	PEOSDM3E	4-1609156-2:	PMOSDM3E	4-1609153-6:	PSOSDM3E
4-1609155-1:	PEOSDM6E	4-1609156-3:	PMOSDM6E	4-1609153-9:	PSOSDM6E
4-1609155-2:	PEOSDMXE	4-1609156-4:	PMOSDMXE	4-1609154-0:	PSOSDMXE

PERFORMANCE DATA

Typical Insertion Loss - Measured in closed 50 Ohm system

Common Mode / Asymmetrical (L-G)
Differential Mode / Symmetrical (L-L)

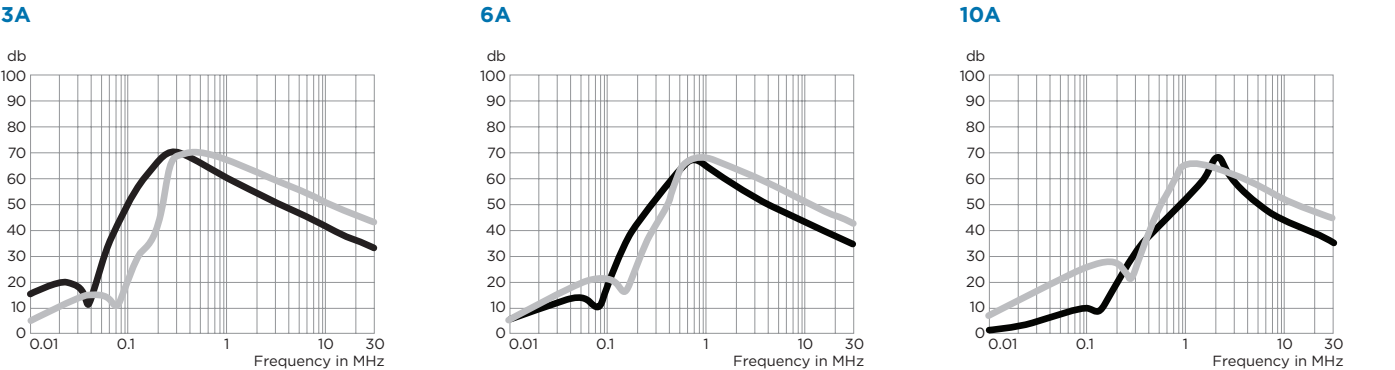

Minimum Insertion Loss - Measured in closed 50 Ohm system

Common Mode / Asymmetrical (Line to Ground)

Current Rating	Frequency – MHz					
	.15	.5	1	5	10	30
3A	50	60	60	45	40	30
6A	34	58	58	42	37	30
10A	6	35	45	45	38	30

Differential Mode / Asymmetrical (Line to Line)

Current Rating	Frequency – MHz					
	.15	.5	1	5	10	30
3A	25	60	60	50	45	40
6A	9	50	62	51	46	40
10A	10	20	59	52	48	40

QUESTIONS TO ASK WHEN DESIGNING IN A CORCOM FILTER

- “Are you experiencing unwanted conducted radio frequency interference (RFI¹) ?”
- “How are you addressing your CE or FCC conducted RFI issues ?”
- “How are you ensuring compliance with safety agency standards ?”

CORCOM ADVANTAGE:

- Broad standard catalog product offering
- Superior Corcom brand equity & print position
- Product samples available
- Customized and value-added solutions available
- Complimentary screen room services available to assist customers with product selections
- Easy website to navigate – corcom.com

¹ Radio Frequency Interference is also commonly referred to as “electronic noise”

CASE STYLES

Front View

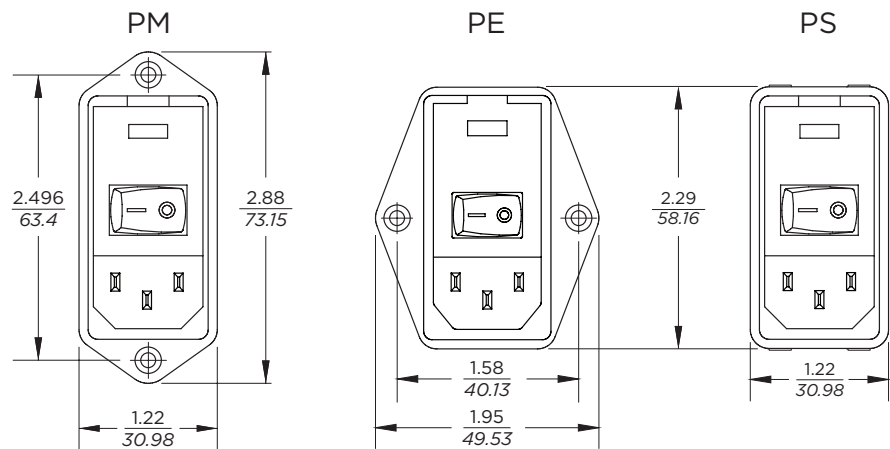

Side View

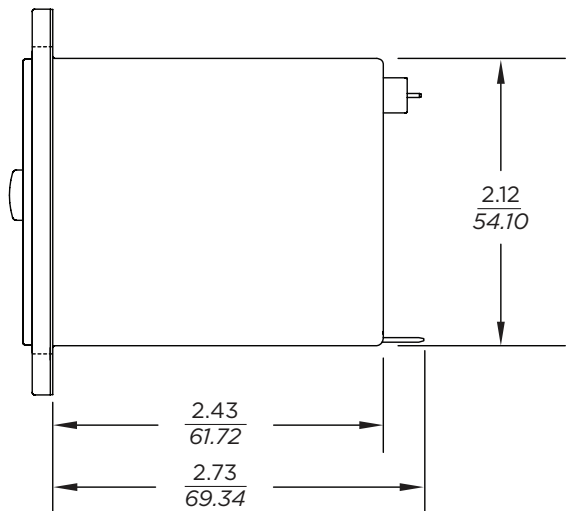

Typical Dimensions:

Line Inlet (1):	IEC 60320-1 C14
Mounting Holes (2):	.135 [3.43] Dia. with .23 [5.9] Dia. x 90° countersink for #4 flathead screw (PM, PE only)
Terminals (2):	.187 [4.8] quick connect tabs

FOR MORE INFORMATION

corcom.com

TE Technical Support Center

Internet:	te.com/help
USA:	+1 (800) 522-6752
Canada:	+1 (905) 475-6222
Mexico	+52 (0) 55-1106-0800
Latin/S. America:	+54 (0) 11-4733-2200
Germany:	+49 (0) 6251-133-1999
UK:	+44 (0) 800-267666
France:	+33 (0) 1-3420-8686
Netherlands:	+31 (0) 73-6246-999
China:	+86 (0) 400-820-6015

Part numbers in this brochure are RoHS Compliant*, unless marked otherwise.

*as defined www.te.com/leadfree

te.com

© 2012 Tyco Electronics Corporation, a TE Connectivity Ltd. company. All Rights Reserved.

5-1773464-0 CIS JG 07/2012

Corcom, TE Connectivity, TE connectivity (logo) and TE (logo) are trademarks. Other logos, product and/or company names might be trademarks of their respective owners.

While TE has made every reasonable effort to ensure the accuracy of the information in this brochure, TE does not guarantee that it is error-free, nor does TE make any other representation, warranty or guarantee that the information is accurate, correct, reliable or current. TE reserves the right to make any adjustments to the information contained herein at any time without notice. TE expressly disclaims all implied warranties regarding the information contained herein, including, but not limited to, any implied warranties of merchantability or fitness for a particular purpose. The dimensions in this catalog are for reference purposes only and are subject to change without notice. Specifications are subject to change without notice. Consult TE for the latest dimensions and design specifications.

