

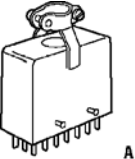

Series 3300 Connectors

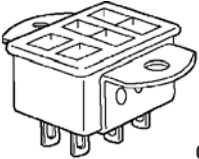

A



C

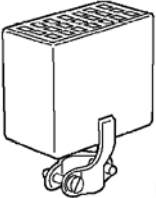

B

Series 3300 connectors are interchangeable with Series 300 types and are designed for panel and cable mounting. **Specifications. Current Rating (Individual Contacts):** 10 amps. **Voltage Rating, rms:** 750 volts, 250 volts (UL). **Plug Contact Material:** Brass, tin plated. **Socket Contact:** Phosphor bronze, tin plated. **Pre-Grounding Contact Material:** Heavy duty plated brass. **Base Insulating Material:** High-grade phenolic, black. **Backshell:** Thermoplastic. **Finishes:** Cable clamp, screws, latch and keeper; Angle Bracket — steel, bright nickel electroplate; Deep Bracket — steel, baked black wrinkle enamel finish over zinc chromate plating.

Plugs (Cable Clamp Top) — Fig. A

Stock No.	Mfr.'s Type	No. of Contacts	EACH			
			1-24	25-49	50-99	100-249
607-0402	P-3302-CCT	2	2.32	1.94	1.73	1.55
607-0403	P-3303-CCT	3	2.30	1.85	1.65	1.48
607-0404	P-3304-CCT	4	2.20	1.78	1.59	1.43
607-0406	P-3306-CCT	6	2.89	2.41	2.15	1.93
607-0407	P-3306-8-CCT*	6	3.31	2.76	2.46	2.21
607-0408	P-3308-CCT	8	3.46	2.89	2.57	2.31
607-0412	P-3312-CCT	12	4.18	3.41	3.04	2.74

Sockets (Cable Clamp Top) — Fig. B

Stock No.	Mfr.'s Type	No. of Contacts	EACH			
			1-24	25-49	50-99	100-249
607-0552	S-3302-CCT	2	2.74	2.28	2.02	1.83
607-0553	S-3303-CCT	3	2.42	1.96	1.74	1.57
607-0554	S-3304-CCT	4	2.87	2.32	2.06	1.85
607-0556	S-3306-CCT	6	3.17	2.65	2.37	2.13
607-0557	S-3306-8-CCT*	6	3.18	2.78	2.48	2.23
607-0558	S-3308-CCT	8	3.61	2.94	2.62	2.36
607-0562	S-3312-CCT	12	4.74	4.14	3.69	3.32

Sockets with Angle Brackets — Fig. C

Stock No.	Mfr.'s Type	No. of Contacts	EACH			
			1-24	25-49	50-99	100-249
607-0632	S-3302-AB	2	1.80	1.47	1.24	1.12
607-0633	S-3303-AB	3	1.69	1.37	1.18	1.05
607-0634	S-3304-AB	4	1.69	1.36	1.23	1.10
607-0636	S-3306-AB	6	2.17	1.82	1.61	1.46
607-0637	S-3306-8-AB*	6	2.10	1.75	1.56	1.40
607-0638	S-3308-AB	8	2.18	1.82	1.62	1.46
607-0642	S-3312-AB	12	2.80	2.45	2.18	1.97

*Polarized.

Series 5400 15 Amp

Cable clamp top connectors are designed for use in panel and cable mounting applications. They are interchangeable with Series 2400 or 400 type connectors. **Current Rating (Individual Contacts):** 15 amps. **Voltage Rating:** 1750 volts; 250 volts (UL rated at 250 V, AC or DC max. between adjacent contacts). **Plug Contact Material:** Brass, tin plated. **Socket Contact:** Phosphor bronze, tin plated. **Pre-Grounding Contact Rating:** Up to 30 amps at rated voltages. **Pre-Grounding Contact Material:** Heavy-duty plated brass. **Base Insulating Material:** High-grade phenolic, black. **Backshell:** Thermoplastic. **Includes:** Steel, bright nickel electroplated cable clamp and screws. UL recognized, File No. E34763. CSA certified, File No. 22156.

Plugs — Fig. A

Stock No.	Mfr.'s Type	No. of Contacts	Dimensions (In.)		EACH			
			D	T	1-24	25-49	50-99	100-249
607-0754	P-5404-CCT	4	0.44	0.1.23	4.44	3.90	3.47	3.12
607-0756	P-5406-CCT	6	0.44	0.1.67	5.78	5.05	4.50	4.06
607-0758	P-5408-CCT	8	0.56	0.2.11	6.56	5.85	5.21	4.69
607-0762	P-5412-CCT	12	0.63	0.2.98	7.17	6.40	5.70	5.12

Sockets — Fig. B

Stock No.	Mfr.'s Type	No. of Contacts	Dimensions (In.)		EACH			
			D	T	1-24	25-49	50-99	100-249
607-0854	S-5404-CCT	4	0.44	0.1.23	5.43	4.83	4.31	3.87
607-0856	S-5406-CCT	6	0.44	0.1.67	6.56	5.21	4.69	4.25
607-0858	S-5408-CCT	8	0.56	0.2.11	6.66	5.94	5.30	4.76
607-0862	S-5412-CCT	12	0.63	0.2.98	9.83	8.78	7.82	7.04

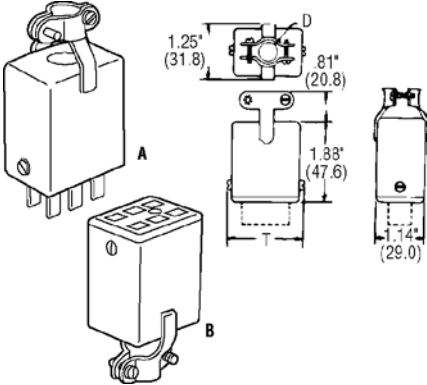

Series 70000 Single Row Barrier Terminal Strips

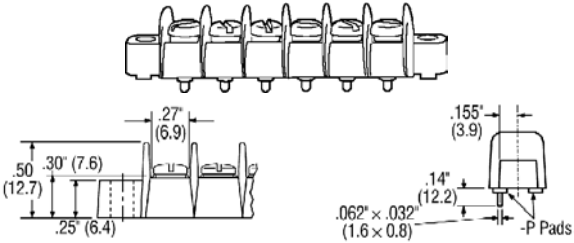

The Series 70 PCB terminal strip is one of the most widely used terminal block products today. The 0.325" terminal pitch and the #6-32 screw offers the user excellent density and durability characteristics. **Specifications. Terminal Centers:** 3/8". **Current Rating (UL):** 20 amps. **Voltage Rating (rms):** UL recognized, Class B — 300; Class C — 150. **CSA Certified:** 300 V @ 20 amps. **Withstand Volts (rms):** 8500. **Insulator Material:** Thermoplastic. **UL Flame Retardant Rating:** 94V-0, black. **W x H:** 1/2" x 1/2". **Max. AWG:** 14. **Terminal Screws:** #6-32 pan head screw or #6-32 wire clamp screw. Steel, zinc chromate plated.

Stock No.	Mfr.'s Type	No. of Circuits	EACH			
			1-24	25-49	50-99	100-249
607-0864	70502	2	.61	.50	.44	.39
607-0866	70503	3	.77	.61	.56	.49
607-0868	70504	4	1.02	.81	.74	.64
607-0869	70506	6	1.23	.97	.89	.77
607-0870	70508	8	1.66	1.32	1.21	1.05
607-0872	70510	10	1.61	1.27	1.17	1.01
607-0874	70512	12	2.31	1.87	1.71	1.48

Series 72000 Single Row Terminal Strips

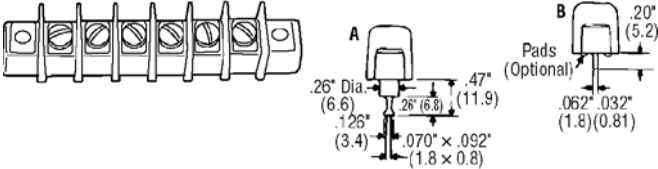

Single row types have the terminals imbedded into the walls of the insulator on both sides. This provides a pull-out strength over twice as great as competitive designs. High barrier construction offer lower overall height. **Specifications. Terminal Centers:** 3/8". **Current Rating (UL):** 20 amps. **Voltage Rating, rms:** UL recognized, Class B — 250; Class — 150. **CSA Certified:** 300 @ 20 amps. **Withstand Volts, rms:** 10500. **Insulator Material:** Thermoplastic, glass-filled. UL temp. index, 95°C. **UL Flame Retardant Rating:** 94V-0. Black. **W x H:** 3/8" x 2 1/32". **Max. AWG:** 14. **Terminal Screws:** No. 6-32 x 1/4" binding head screws. Steel, cadmium plated. PC bottom terminals are brass, bright electro-tinned.

Insulated Solder Turret — Fig. A

Stock No.	Mfr.'s Type	No. of Circuits	EACH			
			1-24	25-49	50-99	100-249
607-0922	72202	2	.79	.69	.58	.52
607-0923	72203	3	1.10	.91	.77	.69
607-0924	72204	4	1.52	1.24	1.06	.96
607-0926	72206	6	2.05	1.69	1.43	1.28
607-0928	72208	8	2.54	2.13	1.89	1.72
607-0930	72210	10	4.18	3.49	3.10	2.80
607-0932	72212	12	3.46	2.92	2.60	2.34

PC Bottom Terminal Type (0.20" L x 0.062" x 0.032") — Fig. B

Stock No.	Mfr.'s Type	No. of Circuits	EACH			
			1-24	25-49	50-99	100-249
607-0952	72502	2	.70	.62	.50	.45
607-0954	72504	4	1.17	.96	.81	.73
607-0956	72506	6	1.61	1.32	1.11	1.01
607-0958	72508	8	1.96	1.61	1.43	1.29
607-0960	72510	10	3.28	2.73	2.43	2.19
607-0962	72512	12	2.90	2.44	2.17	1.95