

PRODUCT NO  
SEE TABLE

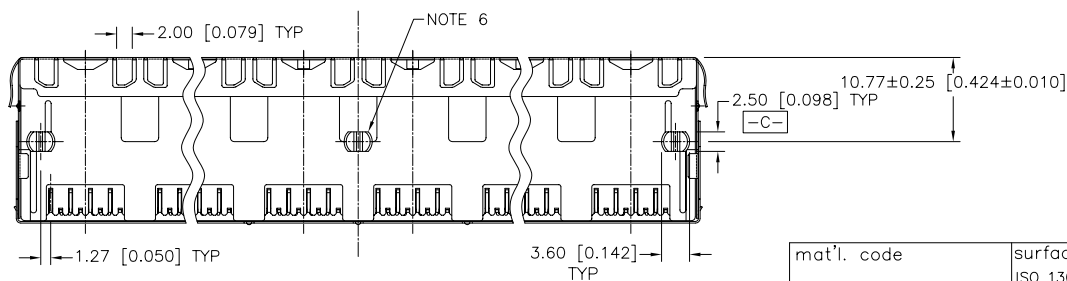
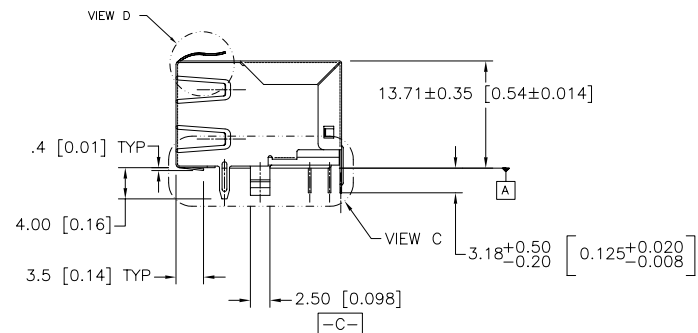
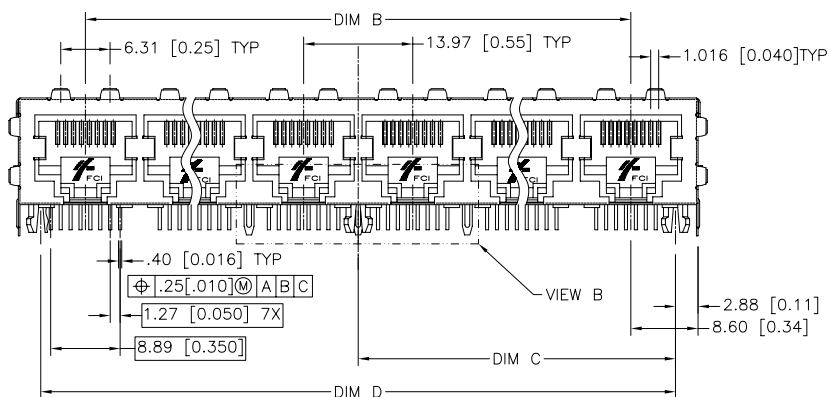
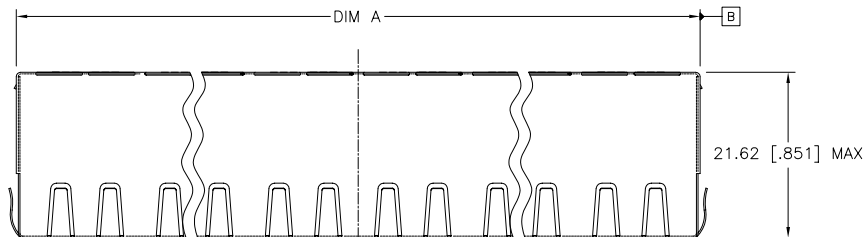

mat'l. code				surface ISO 1302 ✓		tolerance ISO 406 ISO 1101	projection INCH/MM	product family MODJACK	
ltr	ecn no	dr	date	tolerances unless otherwise specified				title	
A	V91919	BKB	9/3/99	angles		.XX±.01/.3	INCH/MM	NETJACK II, RJ45 THRU HOLE	
B	V92061	LP	10/20/99	linear		.XXX±.005/.13		SNAP PEG ASSEMBLY	
C	V0016	BKB	2/23/00	0°±2'		.XXXX±.0020/.051	scale 1:1	dwg no	
D	V12718	LP	1/22/02	dr	B. HANN	8/3/99	FCI	sheet 1 of 5 size	
E	M05-0074	MHT	4/23/05	enfr	B. BRUBAKER	8/3/99		98538 A3	
F	M06-0288	AGS	7/28/06	chr	B. BRUBAKER	8/3/99		type Product Customer Drawing	
sheet index				revision	F	F	F	F	F
				sheet	1	2	3	4	5

form: A3

PDM: Rev:F

STATUS Released

Printed: Jul 31, 2008



FCIconnect.com

Copyright FCI

PRODUCT NO

SEE TABLE

13.97 [0.550]

13.97 [0.550]

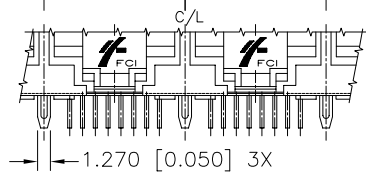
 $\Phi .30[.012] \textcircled{M} A B C$ 

FOR PORT NO. 4,6,8

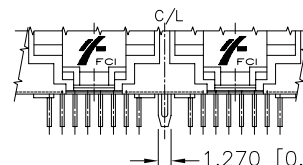
 $\Phi .30[.012] \textcircled{M} A B C$ 

FOR 2-PORT

VIEW B

(CENTER PEG OMITTED FOR CLARITY)

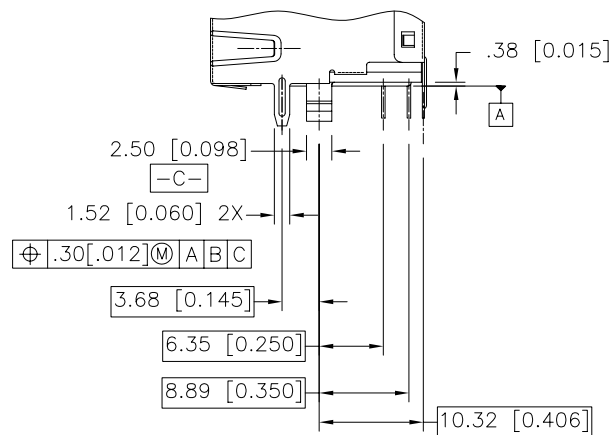

VIEW C

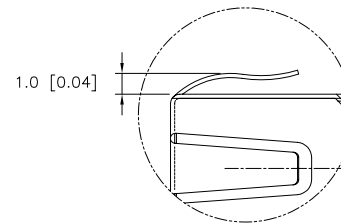

VIEW D

SCALE: 2/1

TYP FOR ALL GROUND SPRINGS

mat'l. code				surface	tolerance	projection	product family
				ISO 1302	ISO 406		MODJACK
				ISO 1101	ISO 1101		
ltr	ecr	no	dr	date	tolerances unless otherwise specified	INCH/MM	title
F					angles linear .XX±.01/.3		NETJACK II, RJ45 THRU HOLE
					0'±2'	scale 1:1	SNAP PEG ASSEMBLY
					.XXX±.005/.13		dwg no
					.XXXX±.0020/.051		sheet 2 of 5 size
				dr	B. HANN 8/3/99		98538 A3
				enr	B. BRUBAKER 8/3/99		
				chr	B. BRUBAKER 8/3/99		
				app	B. BRUBAKER 8/3/99		
sheet	revision						type
index	sheet						Product Customer Drawing

form: A3

PRODUCT NO.	NO. OF PORTS	DIM A $\begin{smallmatrix} +.60[.024] \\ -.00[.000] \end{smallmatrix}$	DIM B	DIM C $\begin{smallmatrix} \pm.10 \\ [\pm.004] \end{smallmatrix}$	DIM D $\begin{smallmatrix} \pm.15 \\ [\pm.006] \end{smallmatrix}$	DIM E $\begin{smallmatrix} \pm.13 \\ [\pm.005] \end{smallmatrix}$
98538-52YXXX	2	31.68 [1.247]	13.97 [0.550]	12.70 [0.500]	25.40 [1.000]	32.11 [1.264]
98538-52YXXXLF						
98538-54YXXX	4	59.62 [2.347]	41.91 [1.650]	26.67 [1.050]	53.34 [2.100]	60.05 [2.364]
98538-54YXXXLF						
98538-56YXXX	6	87.56 [3.447]	69.85 [2.750]	40.64 [1.600]	81.28 [3.200]	87.99 [3.464]
98538-56YXXXLF						
98538-58YXXX	8	115.50 [4.547]	97.79 [3.850]	54.61 [2.150]	109.22 [4.300]	115.93 [4.564]
98538-58YXXXLF						

NETJACK MAGNETICS  
OPTIONS CODE-XXX  
SEE GES-12-020

SPRING OPTION Y	DESCRIPTION (SEE SHEET 5 FOR OPTIONAL VIEWS)
1	SPRING ON TOP,BOTTOM AND BOTH SIDES
2	NO SPRINGS
3	SPRINGS ON TOP AND BOTTOM
4	SPRINGS ON TOP,BOTTOM AND 1 PER SIDE (STAGGERED)
5	SAME AS OPTION 4 EXCEPT OPPOSITE STAGGER

#### NOTES:

- HOUSING MAT'L: HIGH TEMP. THERMOPLASTIC, COLOR BLACK, UL94V-0.
- CONTACT MAT'L: COPPER ALLOY  
MATING AREA PLATING: Au OVER Ni., (SEE TABLE).  
SOLDER AREA PLATING: 2.54uM/100u" MIN TIN LEAD OVER Ni.  
LEAD FREE OPTION:  
SOLDER AREA PLATING: 2.54uM/100u" MIN PURE TIN OVER Ni.
- SHIELDING MAT'L: TIN PLATED COPPER ALLOY.
- ALL DIMENSIONS IN MILLIMETERS AND INCHES.
- SEE SHEET 5 FOR GROUND TAB CONFIGURATION.
- CENTER PEG FOR 8 PORT ONLY.
- LF SUFFIX AT THE END OF PART NUMBER IS LEAD FREE.
- THE HOUSING WILL WITHSTAND EXPOSURE TO 260°C PEAK TEMPERATURE FOR 15 SECONDS IN A WAVE SOLDER APPLICATION WITH A 1.5mm MINIMUM THICK CIRCUIT BOARD. SEE APPLICATION NOTES/PROCEDURES IF THEY ARE AVAILABLE.
- THIS PRODUCT MEETS EUROPEAN UNION DIRECTIVES AND OTHER COUNTRY REGULATION AS DESCRIBED IN GS-22-008.

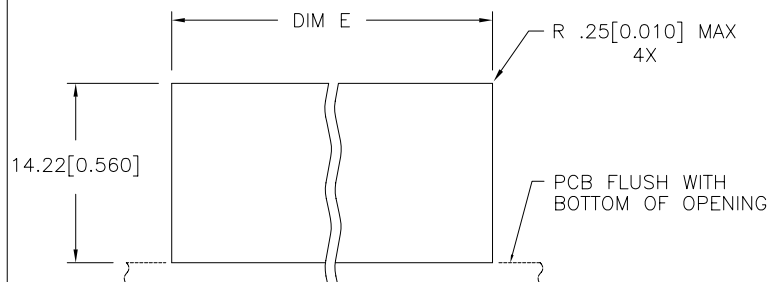

RECOMMENDED PANEL OPENING

mat'l. code				surface ISO 1302 ✓	tolerance ISO 406 ISO 1101	projection 	product family MODJACK
ltr	ecn	no	dr	date	tolerances unless otherwise specified	INCH/MM scale 1:1 	title
F					angles linear .XX±.01/.3		NETJACK II, RJ45 THRU HOLE
					0'±2'		SNAP PEG ASSEMBLY
					linear .xxx±.005/.13 .xxxx±.0020/.051		dwg no
				dr	B. HANN 8/3/99		sheet 3 of 5 size
				enr	B. BRUBAKER 8/3/99		98538 A3
				chr	B. BRUBAKER 8/3/99		type
				app	B. BRUBAKER 8/3/99		Product Customer Drawing
sheet index	revision sheet						

form: A3

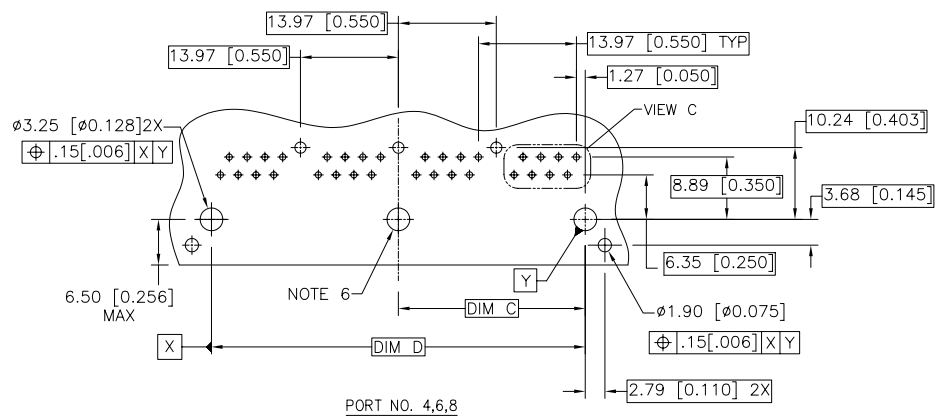

Figure 1: Schematic diagram of the experimental setup. The diagram shows a cross-section of a specimen with a central vertical line. On the left, there are two rows of points labeled POS 1 and POS 2. On the right, there are two rows of points labeled POS 7 and POS 8. A vertical line is labeled 1.27 [0.050] 7X. A horizontal line is labeled 0.89 [0.035] 8X. A circular feature is labeled 0.15 [0.006] X Y.

VIEW C  
SCALE 2/1  
TYPICAL FOOTPRINT

[illegible]

PRODUCT NO

SEE TABLE

# SPRING TAB CONFIGURATION OPTION Y

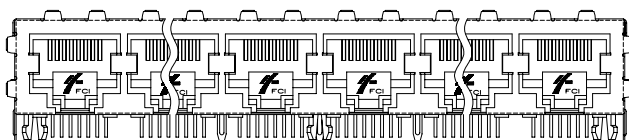

SPRING OPTION 1

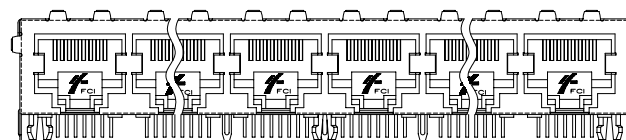

SPRING OPTION 4

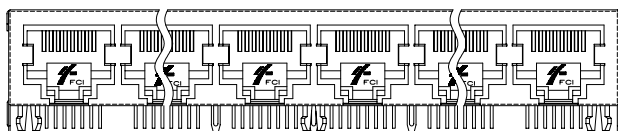

SPRING OPTION 2

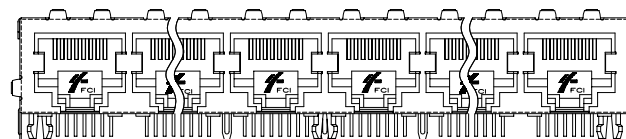

SPRING OPTION 5

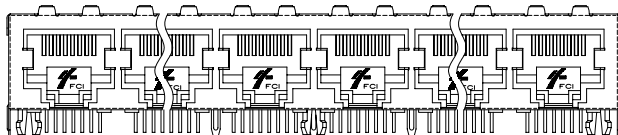

SPRING OPTION 3

mat'l. code				surface ISO 1302 ✓	tolerance ISO 406 ISO 1101	projection 	product family MODJACK
ltr	ec	no	dr	date	tolerances unless otherwise specified	INCH/MM scale 1:1 	title
F					angles linear		NETJACK II, RJ45 THRU HOLE SNAP PEG ASSEMBLY
					0°±2'		dwg no
							sheet 5 of 5 size
					dr B. HANN 8/3/99		98538 A3
					enr B. BRUBAKER 8/3/99		
					chr B. BRUBAKER 8/3/99		
					app B. BRUBAKER 8/3/99		
sheet index	revision sheet						type Product Customer Drawing

form: A3