

# Top View of Assembly

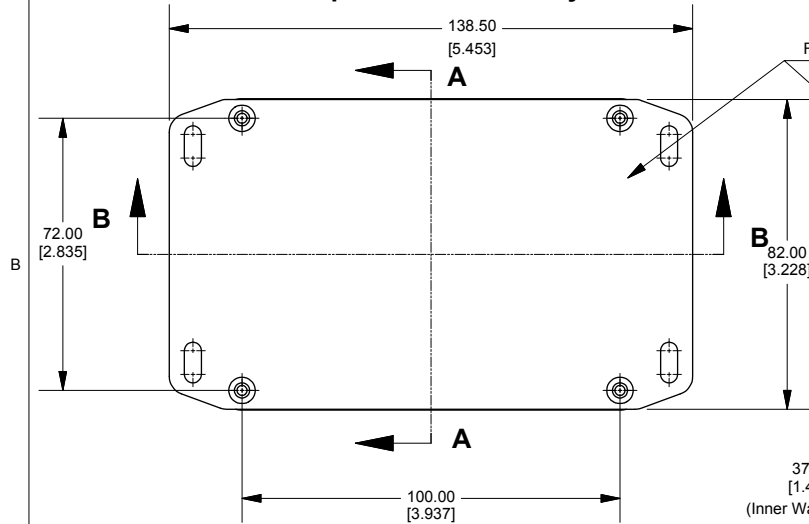

# SECTION A-A End View of Assembly

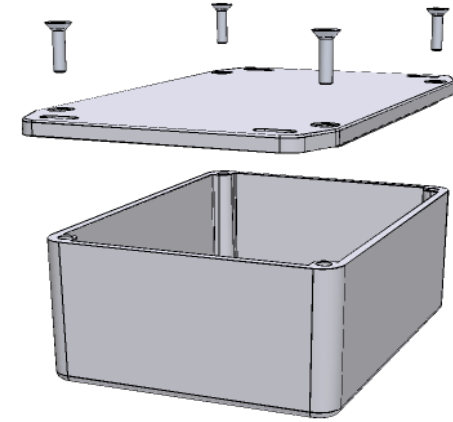
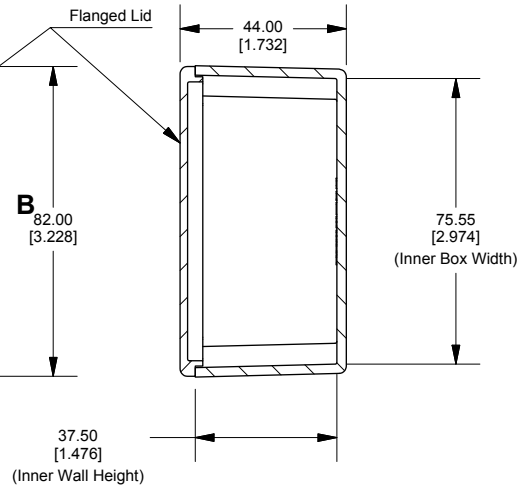

# SECTION B-B Side View of Assembly

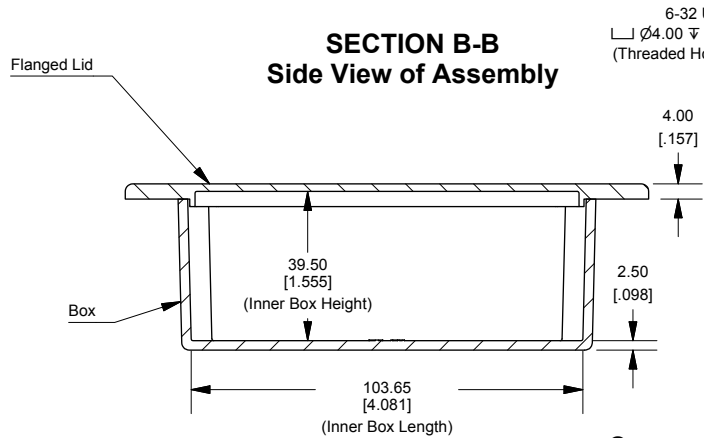

# Top View Looking Inside Box

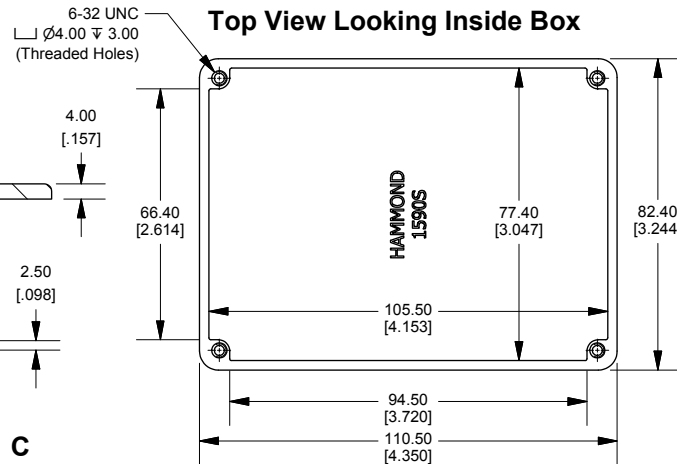

# SECTION C-C

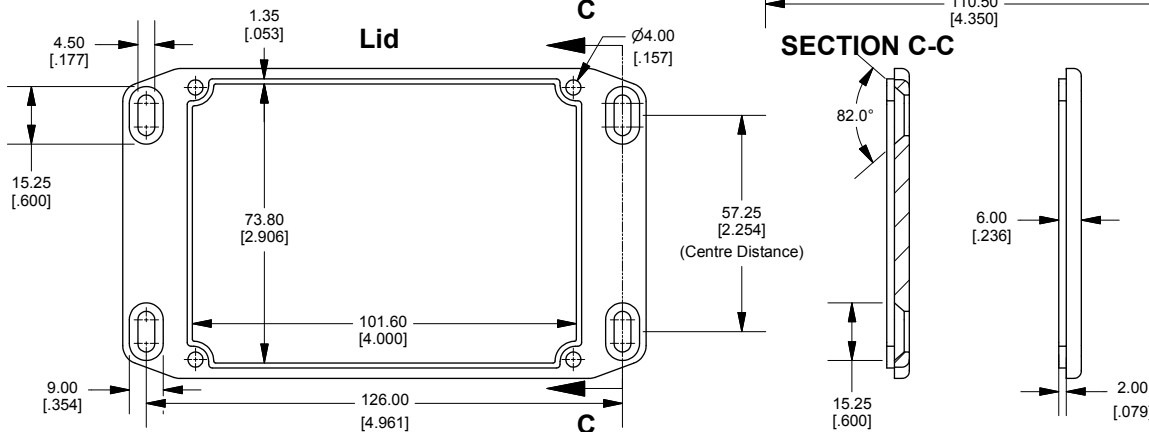

Enclosures can be Factory Modified ( Milling, Drilling, Printing etc.)  
Contact Factory [mjm@hammondmfg.com](mailto:mjm@hammondmfg.com) for quotes  
Solid models of this enclosure available in STEP or IGES.

## NOTE

Purchased assembly includes box, lid and 4 cover screws.  
Box and lid are made from Diecast Aluminum Alloy.  
Silicone Gasket supplied with liquid resistant enclosure.

## PART NUMBERS

### 1590SFL Enclosure

Natural Finish Enclosure

1590SFL

Black Textured Enclosure

1590SFLBK

1590SFL Liquid Resistant Enclosure (Silicone Gasket)

Natural Finish Enclosure

1590WSFL

Black Textured Enclosure

1590WSFLBK

## ACCESSORIES

Recommended Torque: 75 ozf.in / 55 cN.m

### Liquid Resistant Cover Screws

Stainless Steel Cover Screws (Pkg 100)

[6-32 x 1/2" With O-Ring]

1590WMS100

Black Stainless Steel Cover Screws (Pkg 100)

[6-32 x 1/2" With O-Ring]

1590WMS100BK

### Standard Cover Screws

Plated Cover Screws (Pkg 100)

[6-32 x 1/2"]

1590MS100

Black Cover Screws (Pkg 100)

[6-32 x 1/2"]

1590MS100BK

Dimensions:  
mm  
[inches]

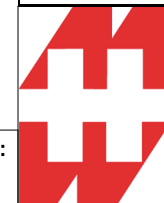

HAMMOND  
MANUFACTURING™

1590SFL

[www.hammondmfg.com](http://www.hammondmfg.com)