

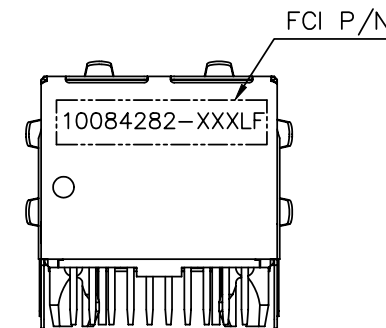

PART NO.
10084282-XXXLF

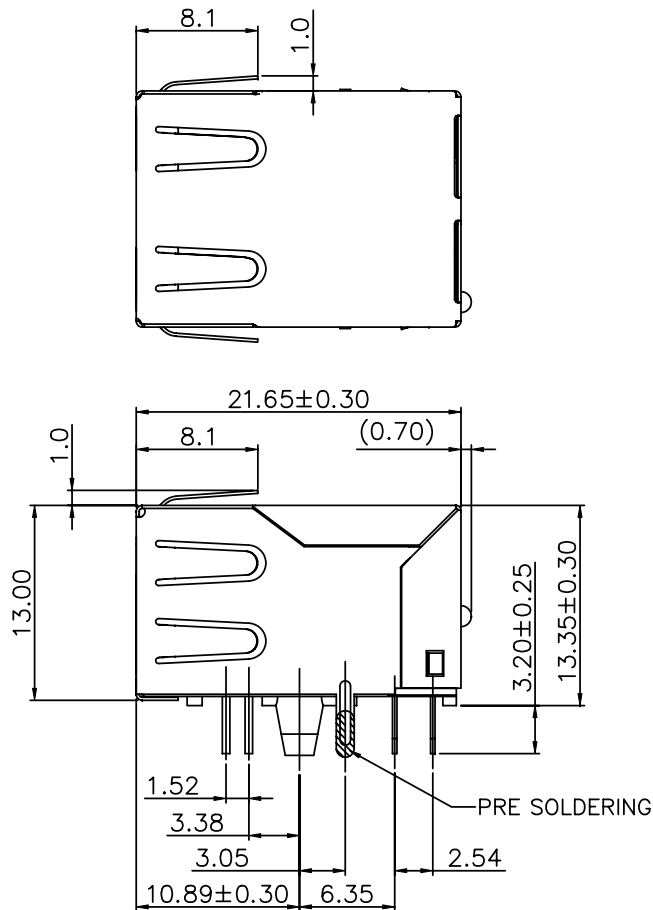
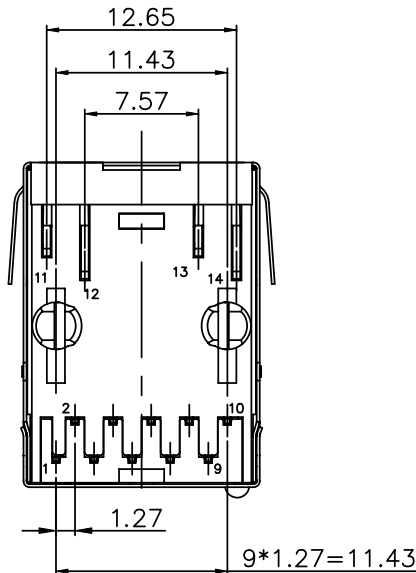
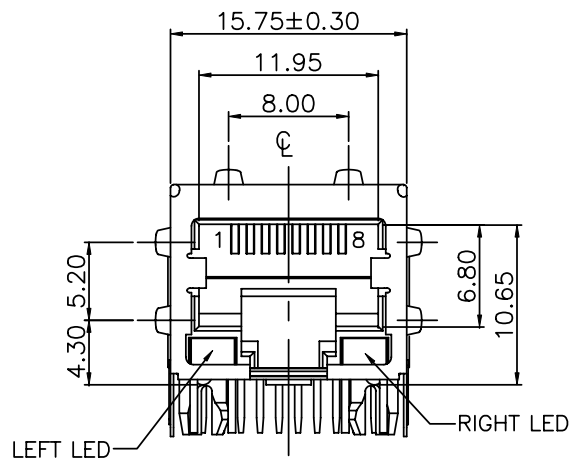

mat'l. code				tolerances unless otherwise specified		CUSTOMER COPY		FCI	
ltr	ecn no	dr	date	linear	.X ± 0.30	projection		www.fciconnect.com	
A	T07-1167	WL	11/23/07		.XX ± 0.20				
					.XXX ± 0.10				
				angles	0° ± 2°	MM		title RJ45 1x1 W/LED/SPRING TAB DOWN, TRANSFORMER 10/100/1000	
				dr	WENDY CHEN 11/20/07				
				enr	WENDY CHEN 11/20/07				
				chr	WENDY CHEN 11/20/07	scale	A4	product family JACK SERIES size dwg no 10084282	
				appd	ALEX LIANG 11/20/07				
sheet	revision	A	A	A					
index	sheet	1	2	3				code TWN sheet 1 of 3	

NOTES:

1. MATERIALS :

SHELL : STAINLESS STEEL, T=0.20mm
HOUSING: HIGH THERMOPLASTIC, UL 94V-0
RJ CONTACT : COPPER ALLOY, T=0.25mm
MODULE: HIGH THERMOPLASTIC UL94-V0.
INPUT PIN: COPPER ALLOY

2. FINISH :

RJ CONTACT : SELECTED GOLD PLATING ON CONTACT AREA
INPUT PIN: TIN COATED COPPER ALLOY
SHELL : PRE-SOLDERING ON SHELL GROUNDING LEG

3. MECHANICAL CHARACTERISTICS :

INSERTION FORCE : 22N MAX.
REMOVAL FORCE(WITHOUT PLUG LOCK) : 22N MAX.
DURABILITY : 1000 TIMES

4. OPERATING TEMPERATURE : 0°C ~ 70°C

5. PRODUCT PERFORMANCE PER SPEC. : GS-12-517.

6. PACKING SPEC. : GS-14-1241.

7. THIS PRODUCT MEETS THE EUROPEAN UNION DIRECTIVE AS DESCRIBED IN GS-22-008.

8. THE HOUSING WILL WITHSTAND EXPOSURE TO 265°C PEAK TEMPERATURE FOR 5 SECONDS IN A WAVE SOLDER APPLICATION WITH A CIRCUIT BOARD.

9. PART NUMBER DESCRIPTION:

10084282-X X X LF

LED COLOR CODE:

0: RIGHT LED COLOR: YELLOW
LEFT LED COLOR: GREEN

TRANSFORMER SPEED :

0: 10/100/1000 BASE-T
LED POLARITY: NORMAL
WITHOUT RESISTOR

RJ CONTACT AREA PLATING:

1 : 15u" GOLD

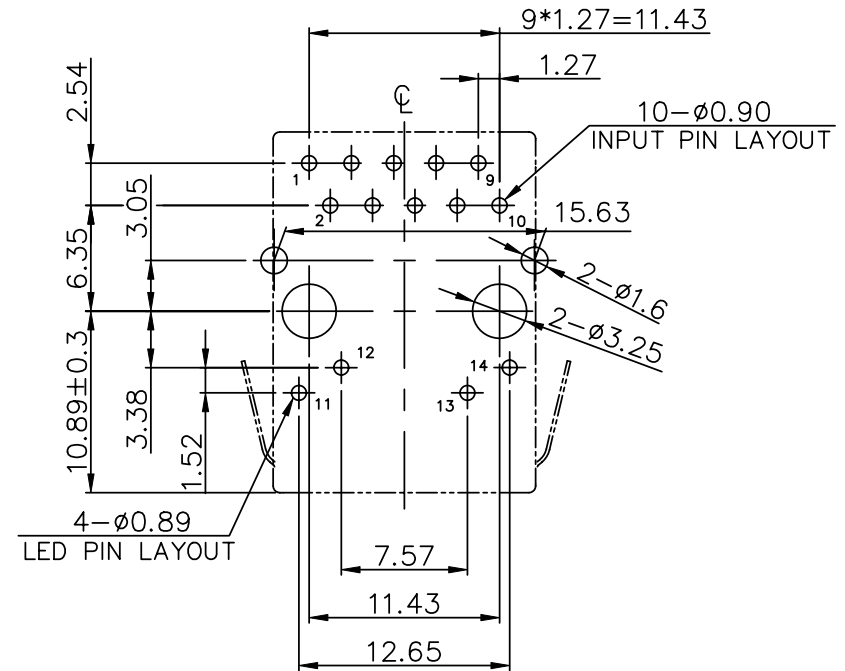

RECOMMENDED PCB LAYOUT (COMPONENT SIDE)
ALL DIMENSION TOLERANCE ARE ±0.05mm

mat'l. code				tolerances unless otherwise specified		CUSTOMER COPY		FCI	
ltr	ecn no	dr	date	linear	.X ± 0.30	projection	MM	www.fciconnect.com	
A					.XX ± 0.20			title	
					.XXX ± 0.10			RJ45 1x1 W/LED/SPRING	
				angles	0° ±2°			TAB DOWN, TRANSFORMER 10/100/1000	
				dr	WENDY CHEN 11/20/07	scale	A4	product family JACK SERIES	
				enr	WENDY CHEN 11/20/07			code	
				chr	WENDY CHEN 11/20/07			size dwg no	
				appd	ALEX LIANG 11/20/07			10084282	
sheet index	revision sheet							cage code	
								22526	

Tous droits strictement reserves. Reproduction ou communication a des tiers
Interdit sous quelque forme que ce soit sans autorisation écrite du propriétaire.
Propriete de c FCI. Droits de reproduction FCI.

All rights strictly reserved. Reproduction or issue to third parties in any
form whatever is not permitted without written authority from the proprietor.
Property of FCI. Copyright FCI.



ELECTRIC SCHEME

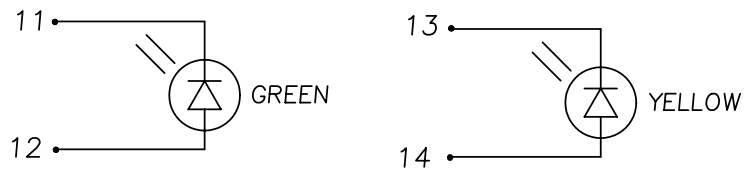
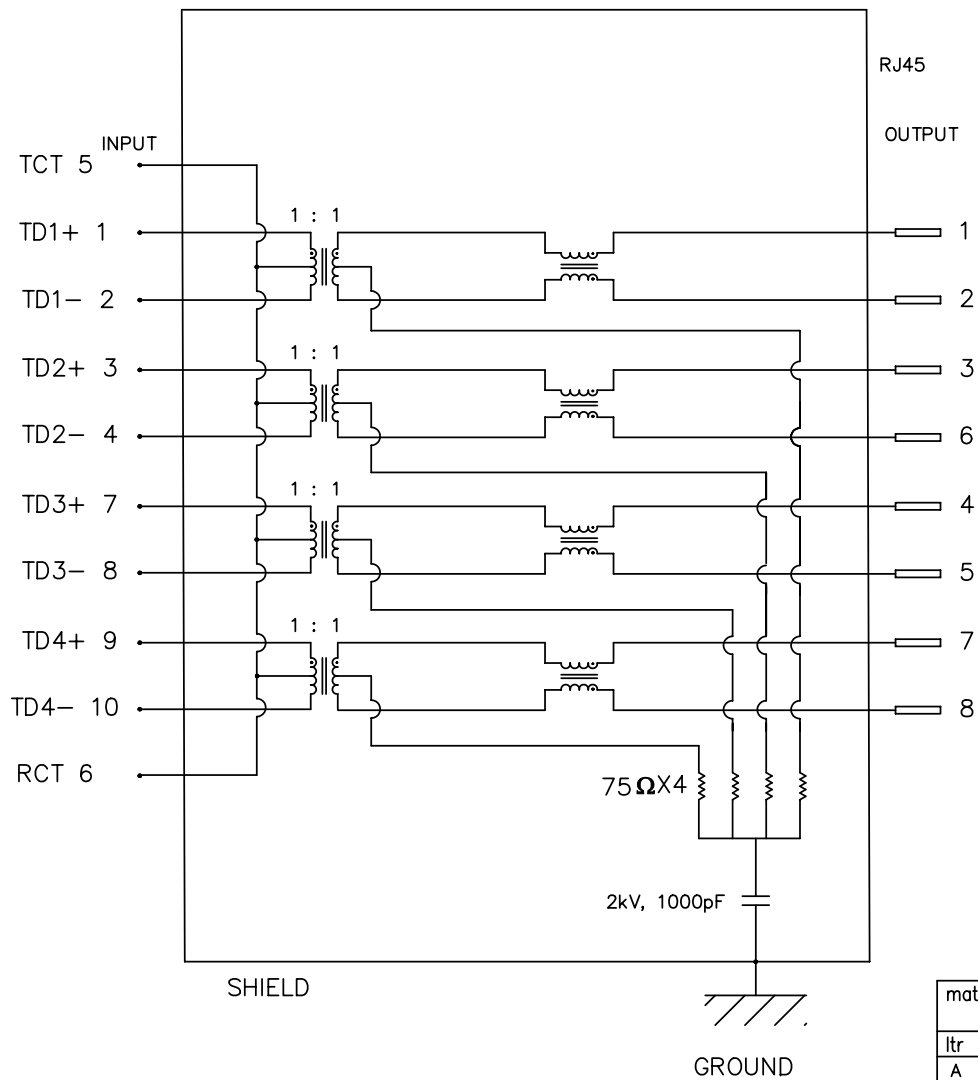

- Transmitter & Receiver Filter:
- 1. Insertion Loss (dB MAX)
1~125MHz -1.2
 - 2. Return Loss at 100Ω (dB MIN)
1~30MHz -18
30~60MHz -16
60~80MHz -12
80~100MHz -10
 - 3. Common Mode Rejection@ 1~100 MHz: -30dB MIN
 - 4. Cross Talk@1~100 MHz: -25dB MIN
 - 5. Inductance@100KHz/ 0.1V, 8mA DC BIAS: 350uH MIN
 - 6. HiPot Test: 1500Vrms(or 2250VDC), 60sec
 - 7. LED: Forward Voltage (V)@ 20mA
Typica :2.2 / MAX :2.6

mat'l. code				tolerances unless otherwise specified		CUSTOMER COPY		FCI	
ltr	ecn no	dr	date	linear	.X ± 0.30	projection		title RJ45 1x1 W/LED/SPRING TAB DOWN,TRANSFORMER 10/100/1000	
A					.XX ± 0.20				
					.XXX ± 0.10				
				angles	0° ±2°	MM		product family JACK SERIES size dwg no 10084282	
				dr	WENDY CHEN 11/20/07				
				enr	WENDY CHEN 11/20/07				
				chr	WENDY CHEN 11/20/07	scale	A4	code TWN sheet 3 of	
				appd	ALEX LIANG 11/20/07				
sheet index	revision sheet							cage code 29526	