

Top View of Assembly

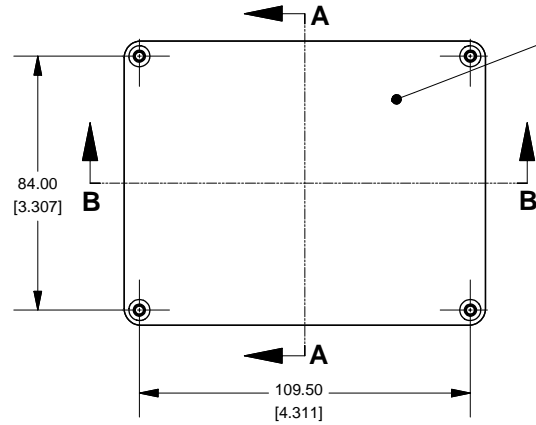

**SECTION A-A
End View of Assembly**

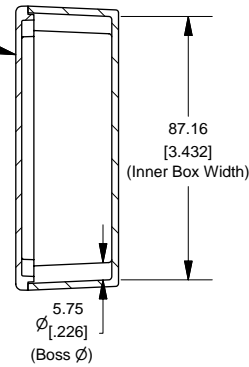

Series 1590BB

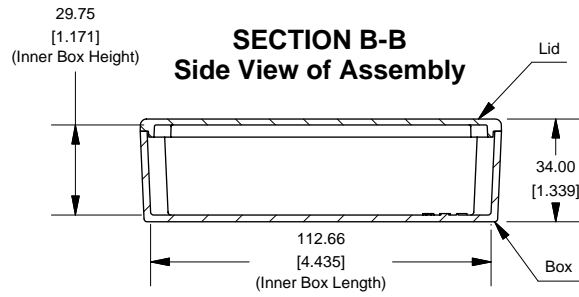
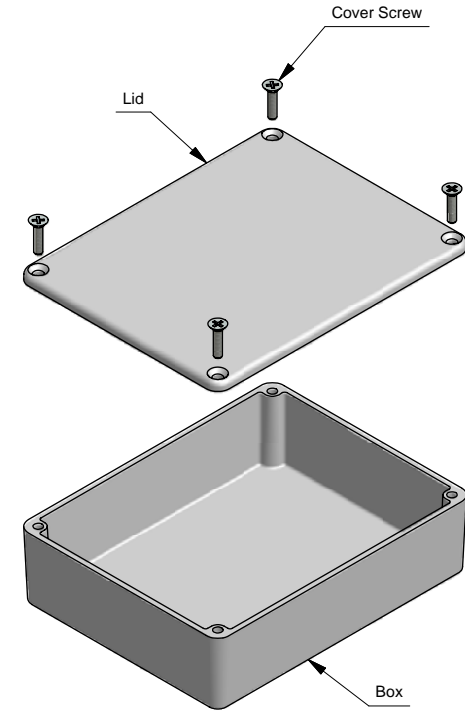

Top View Looking Inside Box

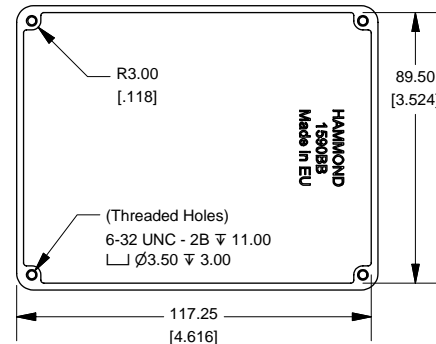

Lid

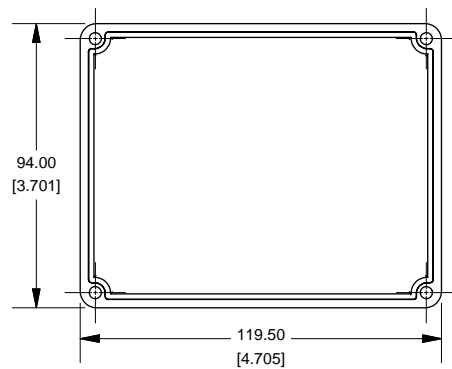

NOTE

Purchased assembly includes box, lid and 4 cover screws.
Box and lid are made from Diecast Aluminum Alloy (alloy type 360.1).

PART NUMBERS

| 1590BB Enclosure | |
|--|------------|
| Unfinished | 1590BB |
| Black Textured Powder Paint | 1590BBBK |
| 1590BB Liquid Resistant Enclosure (Silicon Factory Installed Gasket) | |
| Unfinished | 1590WBB |
| Black Textured Powder Paint | 1590WBBBK |
| ACCESSORIES | |
| Unfinished | |
| Cover Screws (Pkg 100) | 1590MS100 |
| [6-32 x 1/2" Nickel Plated Screws] | |
| Black Textured Powder Paint | 1590MS50BK |
| Cover Screws (Pkg 50) | |
| [6-32 x 1/2" Stainless Steel Black Screws] | |



www.hammondmfg.com