

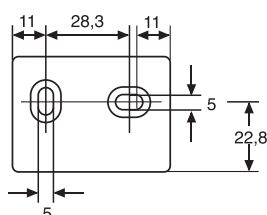

- World-wide applicable
- Reception and processing of the GPS-time signal (UTC)
- Output signal is a DCF-time-telegram which corresponds to a user-defined Time zone. The adjustments can be done by dipswitches:
=> summertime (active/deactive)
=> time shift relative GMT (GMT -15 to GMT +15)
- The initial state of the dip-switches results in an output signal identical to the DCF time-signal of the FU 20.00 pro (summertime active / GMT +1)
- One FU 3x.00 *pro* receiver can connect to 10 time switches
- Time and date are automatically transferred to the time switch
- Control LED
- Compact housing
- Simple mounting, wall fixed rotatable
- Connection wire specifications: 3-wire, no shield, variable core cross-section
- max. length of wire between receiver and time switches 200 m

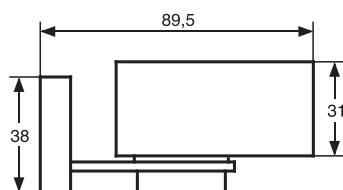
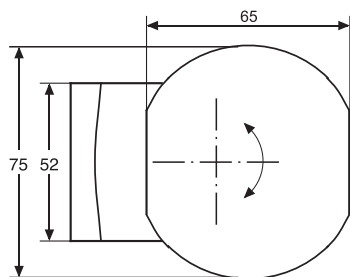

Radio Receiver GPS-Time FU 3x.00 *pro* for wall mounting

Technical data

Power Supply	12–30 VDC external power supply
Power consumption	Ø 30 mA at 12 V / 15 mA at 30 V
Output signal	DCF time telegram (no weather data) Polarity output signal LOW active via Open Collector: U _{max} 50 VDC I _{max} 80 mA Max. output power 200 mW Output voltage LOW 2.5 VDC
Operation indicator	flashing LED on receiving
Consequence of an interference with reception	time switches use their quartz as time base
Antenna	GPS receiver
Permitted ambient temperature	–30°...+55°C
Housing	self-extinguishing thermoplastic
Mounting	Fastening angle for wall mounting (receiver is rotatable)
Type of protection	IP 54 (DIN EN 60529)
Recommended cable	3-wire Shielded / Section 0.33 up to 2.5 m²

Connection diagram

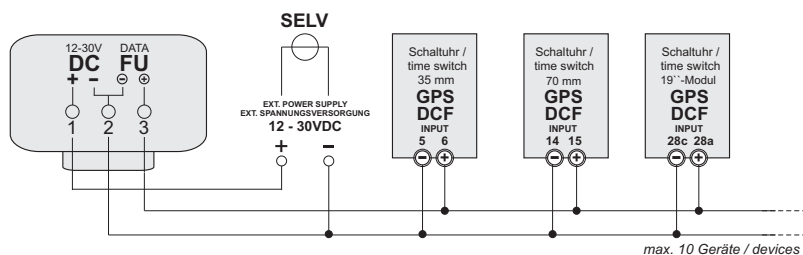

Order number	Version
FU 30.00 <i>pro</i>	without power supply
FU 35.00 <i>pro</i>	power supply for DIN-rail mounting included / 17,5 mm width and 12 VDC output (NT 08.12 <i>pro</i>)

▮ Housing colour