

(2.54 mm) .100"

SL, SDL SERIES

LOW PROFILE MACHINED SOCKET STRIPS

FEATURES

- Achieve low profile without sacrificing insertion depth!
- Choice of four precision screw machined lead styles.
- Exceptionally low profile, down to (2.11 mm) .083" off of board.
- Mates with BBL or BDL for board stacking spaces down to (3.89 mm) .153"

SPECIFICATIONS

For complete specifications see www.samtec.com?SL or www.samtec.com?SDL

Insulator Material:

Black Glass Filled Polyester (SDL)

Black Liquid Crystal Polymer (SL)

Contact/Shell Materials:

BeCu/Brass

Plating:

Au or Sn over

50 μ " (1.27 μ m) Ni

Operating Temp Range:

-55 °C to +125 °C with Gold

-55 °C to +105 °C with Tin

RoHS Compliant:

Yes

Lead-Free Solderable:

SL: Yes

SDL: No, Lead Wave only

RECOGNITIONS

For complete scope of recognitions see www.samtec.com/quality



FILE NO. E111594

Mates with:

TS, TD, HTS, BBS, BBD, BBL, BDL, BHS

TYPE STRIP

1

NO. PINS PER ROW

PLATING OPTION

LEAD STYLE

SL

= Single Row Low Profile Socket Strip

SDL

= Double Row Low Profile Socket Strip

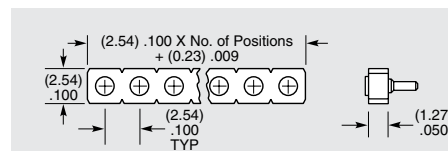

01 thru 32

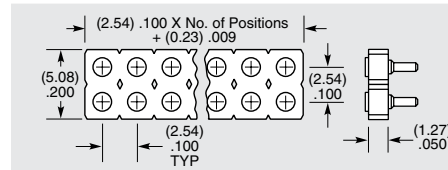

01 thru 36

-G

= 30 μ " (0.76 μ m) Gold contact,
10 μ " (0.25 μ m) Gold shell

-T

= 30 μ " (0.76 μ m) Gold contact,
Tin shell

-TT

= Tin contact and shell
(LIF not available)

Low Insertion Force (LIF) Available

-10

= Low Profile (Hollow Leg)

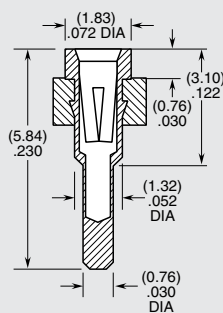

Contact Length = (2.11 mm) .083"
Lead DIA Accepted = (0.38 mm) .015" to (0.51 mm) .020"
Insertion Depth = (2.67 mm) .105" to (4.32 mm) .170"
Style 10 Component Part No. = SC-3P1

-11

= Low Profile (Standard Mount)
For LIF specify -31

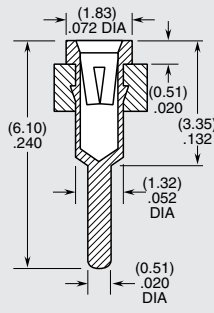

Contact Length = (1.58 mm) .062"
Lead DIA Accepted = (0.41 mm) .016" to (0.53 mm) .021"
Insertion Depth = (2.03 mm) .080" to (2.67 mm) .105"
Style 11 Component Part No. = SC-4P1
Style 31 Component Part No. = EZ-4P1

-12

= Micro-Socket (Hollow Leg)

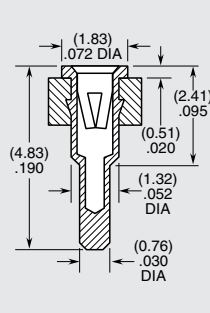

Contact Length = (1.58 mm) .062"
Lead DIA Accepted = (0.41 mm) .016" to (0.51 mm) .020"
Insertion Depth = (1.65 mm) .065" to (3.81 mm) .150"
Style 12 Component Part No. = SC-5P1

-19

= Micro-Socket (Hollow Leg)
For LIF specify -39

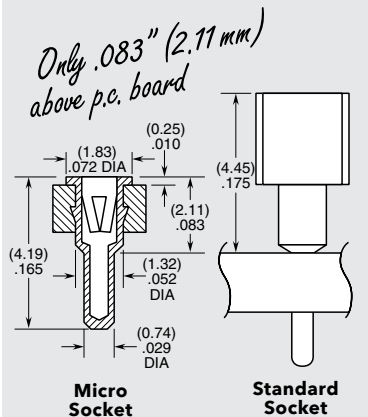

Contact Length = (1.58 mm) .062"
Lead DIA Accepted = (0.41 mm) .016" to (0.51 mm) .020"
Insertion Depth = (1.65 mm) .065" to (3.56 mm) .140"
Style 19 Component Part No. = SC-8P1
Style 39 Component Part No. = EZ-8P1

Micro Socket

Standard Socket

(Reference only.
Not available with SL & SDL)

Note:
Some lengths, styles and options are non-standard, non-returnable.