

.100" WIRE HOUSING & CRIMP CONTACT

**.100" [2.54] CENTERLINE
SINGLE AND DUAL ROW
MTE / MTF SERIES**

INTRODUCTION:

Adam Tech MTE & MTF series wire housings and crimp contacts provide a fast reliable connection of wires to a PCB. Our compact housing is available in single or dual rows and securely locks our precision stamped contact within each cell for a high reliability connection system.

FEATURES:

Quickly and easily attaches wires to PCB
Precision stamped contacts provide high normal force
Single & dual rows available
Positive contact to housing retention

MATING CONNECTORS:

Mates with Adam Tech PH series and all .025" sq. pin headers on .100" centerlines

SPECIFICATIONS:

Material:

Insulator: PBT, glass reinforced, rated UL94V-2
Insulator Color: Black
Contacts: Phosphor bronze

Contact Plating:

Gold Flash (30u" optional) over Nickel underplate, Tin over copper underplate on crimp area

Electrical:

Operating voltage: 250V AC max.
Current rating: 3 Amps max.
Contact Resistance: 20 mΩ max.
Insulation resistance: 5000 MΩ min.
Dielectric withstanding voltage: 1000V AC for 1 minute

Mechanical:

Recommended wire size: 22 to 28 Awg with .059" O.D. insulation max.

Temperature Rating:

Operating temperature: -65°C to +105°C

PACKAGING:

Anti-ESD plastic bags

APPROVALS AND CERTIFICATIONS:

UL Recognized File No. E224053
CSA Certified File No. LR1578596



ORDERING INFORMATION

HOUSING

MTE

10

SERIES INDICATOR

MTE = Single row housing
MTF = Dual row housing

POSITIONS

Single row MTE 02-40
Positions
Dual Row MTF 04-80
Positions

CRIMP CONTACT

MTE-C

R

SERIES INDICATOR

MTE-C = Crimp contact

PACKAGING

B = 1000 piece loose cut
R = 6000 pieces on reel



MTE - SINGLE ROW

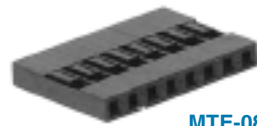
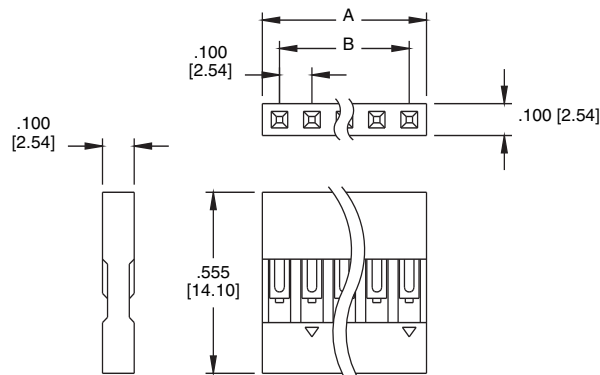

MTE-08

MTF - DUAL ROW

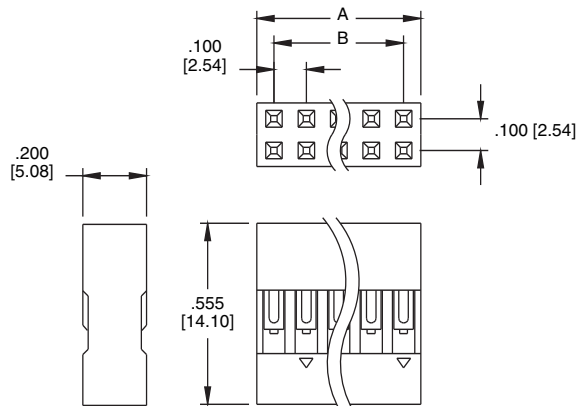

MTF-14

MTE-C CRIMP CONTACT

