

REVISIONS			
REV	ECN, ERN NO.	DATE	APPRD.
F	PRODUCT DRAWING (EAR 14159)	JAN31/13	K.L.

ADDITIONAL MOUNTING OPTIONS AVAILABLE
FOR PIN OR SOCKET CONNECTOR

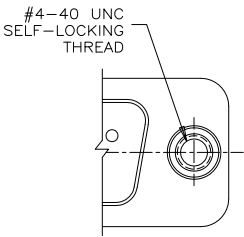

PARTIAL FRONT VIEW

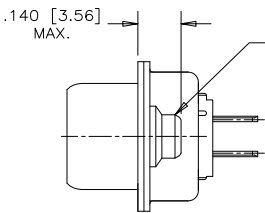

END VIEW

VIEW FOR E09, A15 & B25
SIZE. FOR C37 SIZE VIEW
SEE MOUNTING CODE 4, SHEET 1.

MOUNTING CODE 3

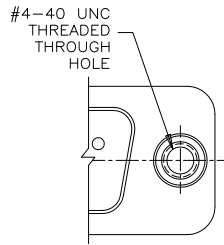

PARTIAL FRONT VIEW

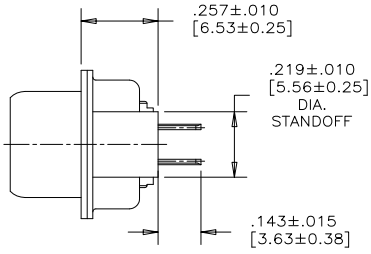

END VIEW

MOUNTING CODE 5

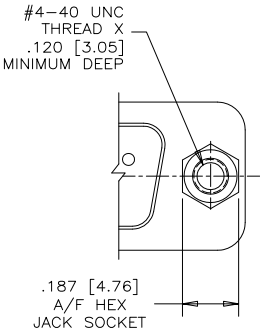

PARTIAL FRONT VIEW

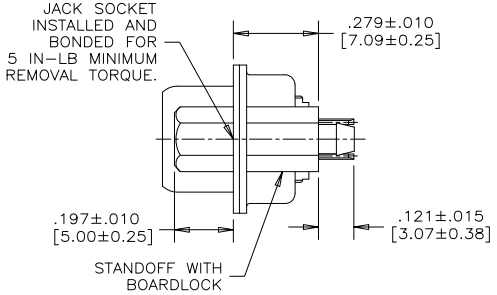

END VIEW

MOUNTING CODE 9

MOUNTING CODE A - #4-40 UNC
MOUNTING CODE J - M3 x 0.5
THREAD DEPTH .220 [5.59] MIN.

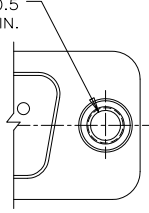

PARTIAL FRONT VIEW

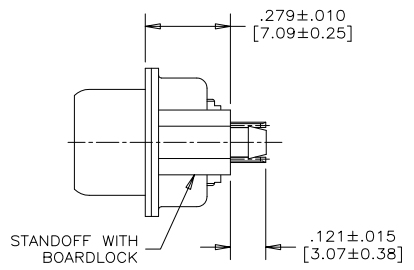

END VIEW

MOUNTING CODES A & J



THIS DOCUMENT CONTAINS PROPRIETARY INFORMATION AND SUCH INFORMATION
MAY NOT BE DISCLOSED TO OTHERS FOR ANY PURPOSE OR USED FOR MANUFACTURING
PURPOSES WITHOUT WRITTEN PERMISSION FROM AMPHENOL CANADA CORP.

DRAWN <i>K. LAMBIE</i>		DATE <i>MAY13/05</i>		Amphenol Canada Corp.					
DESIGNED									
CHECKED									
I. E. APPRD.				TITLE FCE17 SERIES FILTERED D-SUB CONNECTOR, PIN & SOCKET, VERTICAL MOUNT PCB TAIL, VARIOUS MOUNTING OPTIONS, RoHS COMPLIANT					
Q. A. APPRD.									
DWG. APPRD.									
ENG. REL. NO.									
REF. <i>EAR #12744</i>				DWG C		DRAWING NO. P-FCE17-XXXXE-XX0X		REV. F	
DIMENSIONS ARE IN INCHES <i>(mm)</i>		CODE ID. NO. 03554							
SCALE <i>3/1</i>		WT. -----		SURF. -----		SHEET <i>2</i> OF <i>3</i>			

REV.
F

REVISIONS			
REV	ECN, ERN NO.	DATE	APPRD.
F	PRODUCT DRAWING (EAR 14159)	JAN31/13	K.L.

MATING FACE VIEWS
SHOWING CONTACT POSITION NUMBERS

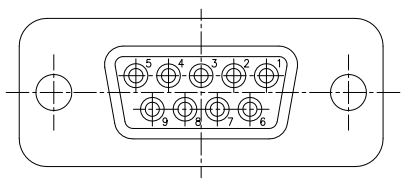

9 SIZE
SOCKET

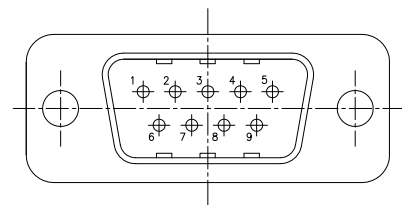

9 SIZE
PIN

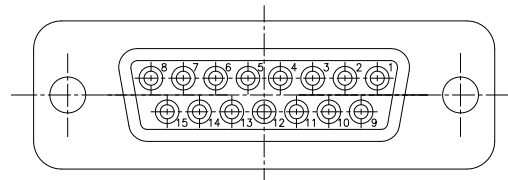

15 SIZE
SOCKET

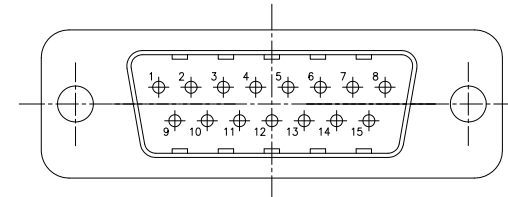

15 SIZE
PIN

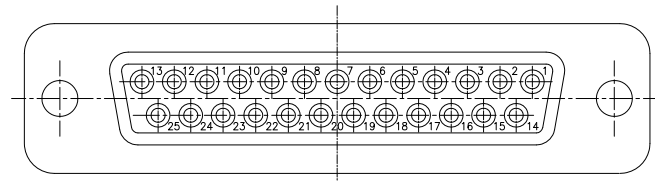

25 SIZE
SOCKET

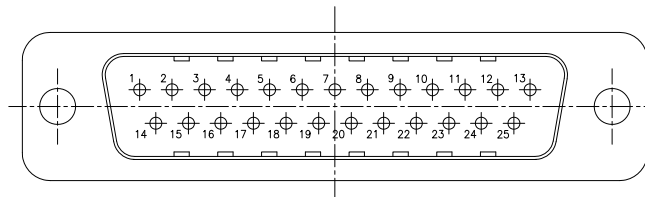

25 SIZE
PIN

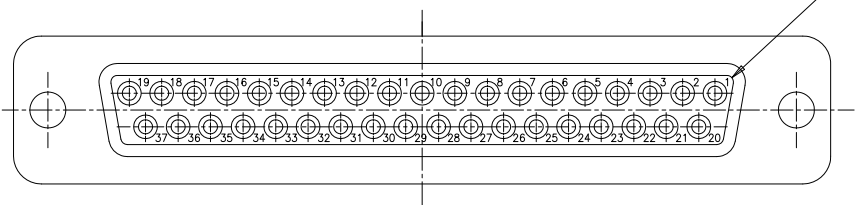

37 SIZE
SOCKET

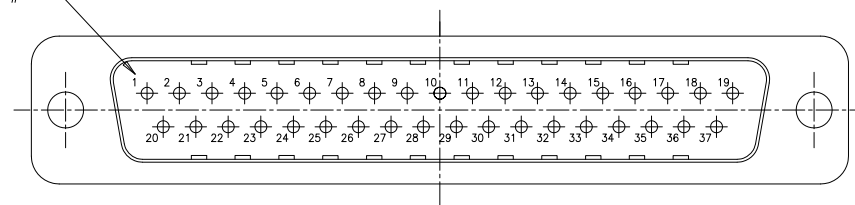

37 SIZE
PIN



DRAWN K. LAMBIE	DATE MAY13/05
DESIGNED	
CHECKED	
I. E. APPRD.	
Q. A. APPRD.	
DWG. APPRD.	
ENG. REL. NO.	
REF. EAR #12744	
DIMENSIONS ARE IN INCHES [mm]	CODE ID. NO. 03554

Amphenol Canada Corp.

TITLE
FCE17 SERIES FILTERED D-SUB CONNECTOR,
PIN & SOCKET, VERTICAL MOUNT PCB TAIL,
VARIOUS MOUNTING OPTIONS, RoHS COMPLIANT

DWG C	DRAWING NO. P-FCE17-XXXXE-XX0X	REV. F
SCALE 3/1	WT. -----	SURF. -----
SHEET 3 OF 3		

THIS DOCUMENT CONTAINS PROPRIETARY INFORMATION AND SUCH INFORMATION
MAY NOT BE DISCLOSED TO OTHERS FOR ANY PURPOSE OR USED FOR MANUFACTURING
PURPOSES WITHOUT WRITTEN PERMISSION FROM AMPHENOL CANADA CORP.