

Cleaning:

- > Clean this light fitting only with a soft dry cloth, do not use any chemical or abrasive cleaners.

Lamp replacement:

- > Switch off the electricity at the mains and allow the fitting to cool.
- > Unscrew the decorative ring and glass lens and remove the circlip which retains the lamp.
- > Turn the lamp anti-clockwise and withdraw from the lampholder..
- > Fit a new lamp, ensuring that the lamp is properly engaged in the lampholder. Only fit a lamp of the same type and size.
- > Secure the lamp in the fitting using the circlip and replace the decorative ring and lens.
- > Restore the power and switch on.

Energy Efficiency

The following suggestions will help you protect the environment and save money on your electricity bills:

- > Always switch lights off when not in use.
- > You can often use a lower Wattage bulb than the maximum stated, e.g. if the maximum stated is 50W, try using 35W.
- > This product is suitable for use with Low Energy bulbs. Please use a Low Energy equivalent wherever possible.
- > Use of a suitable dimmer switch can reduce electricity usage and extend life of 'normal' bulbs. Selected dimmable Low Energy bulbs are also now available.

Replacement lamp type:

Wattage: 50 W
Supply Voltage: 12 V
Type: 50mm MR16 Dichroic reflector lamp.

Eventually, you may want to replace this light fitting:

When your light fitting comes to the end of its life or you choose to update or upgrade it by replacing it, please do not dispose of it with your normal household waste, please recycle where facilities exist. When you need to dispose of this fitting, check with your retailer or local authority for suitable options. New regulations require the recycling of Waste from Electrical and Electronic Equipment (European "WEEE Directive" effective August 2005—UK WEEE Regulations effective 2nd January 2007).

Environment Agency Registered Producer: WEE/GA0248QZ



If you experience problems:

If your light is defective or develops a fault, please return it to the place where you bought it. You can call our Helpline for advice. The Helpline will gladly give advice on any aspect of any Eterna Lighting product but may not be able to give specific instructions regarding individual installations. If in doubt, consult a qualified electrician.

Help line:

Tel: 01933 673 144 Fax: 01933 678 083 Email: sales@eterna-lighting.co.uk
For answers to frequently asked questions (FAQs) and other information visit our web-site
www.eterna-lighting.co.uk



IMPORTANT !

Safety and Installation instructions

Low Voltage Shower Light

Model(s)

ELVWH, ELVBSC, ELVBS, ELVBCR, ELVBSB

Pack contents:

Shower light	1
Terminal bracket	1
Terminal block and lampholder	1
Spring clips	2

**PLEASE READ THESE INSTRUCTIONS BEFORE
INSTALLING YOUR NEW FITTING**

- -

PLEASE RETAIN FOR FUTURE REFERENCE

Read this first:

- > Check the pack and make sure you have all of the parts listed on the front of this booklet. If not, contact the outlet from where you bought this fitting who will be able to help you.
- > This product contains glass, care must be taken when assembling, fitting or handling to prevent personal injury or damage to the product.
- > This light fitting must be installed by a competent person in accordance with the Building Regulations making reference to the current edition of the IEE Wiring Regulations (BS7671). The Building Regulations may be obtained from HMSO or viewed and downloaded from www.communities.gov.uk following the link for Building Regulations.
- > If in any doubt, consult a qualified electrician.
- > This product is designed and constructed according to the principles of the appropriate British Standard and is intended for normal domestic service. Use of this fitting in any other environment, for example where prolonged periods of use may be expected and/or higher than normal ambient temperatures, may result in a foreshortened working life.
- > Switch off the mains before commencing installation and remove the appropriate circuit fuse.
- > When working at heights, please use a suitable platform.
- > Suitable for indoor use only.
- > This product is suitable for installation on surfaces with normal flammability (indicated by the "F" in a triangle) e.g. wood, plasterboard, masonry. It is not suitable for use on highly flammable surfaces (e.g. polystyrene, textiles).
- > If installing / mounting a light fitting to a plastic ceiling, you must seek advice from the ceiling manufacturer regarding the type and specification of light fittings that may be used. Light fittings that generate and retain heat such as halogen downlights or flush fittings with incandescent lamps, may damage or discolour a plastic ceiling.
- > Before making fixing hole(s), check that there are no obstructions hidden beneath the mounting surface such as pipes or cables.
- > Do not cover the fitting with any insulating materials.
- > Do not install inside a fire hood.
- > The fitting must be positioned so that there is at least 0.5m (500mm) between the bulb and any illuminated surface. Spotlights should be positioned well away from curtains and beds to ensure this distance is maintained.
- > Do not attach to surfaces which are damp, freshly painted or otherwise electrically conductive (e.g. metallic surfaces).
- > If the location of your new fitting requires the provision of a new electrical supply, the supply must conform with the requirements of the Building Regulations making reference to the current edition of the IEE Wiring Regulations (BS7671).
- > This product is designed for permanent connection to fixed wiring: this should be either a suitable lighting circuit (protected with a 5 or 6 Amp MCB or fuse) or a fused spur (with a 3 Amp fuse) via a fused connection unit. We recommend that the supply incorporates a switch for ease of operation.
- > Make connections to the electrical supply in accordance with the following code:
Live - Brown or Red
Neutral - Blue or Black
Earth - Green and Yellow
- > Additional red wires may be present in your ceiling that are connected to the ring live circuit. Do not connect your fitting to these wires. Join these wires together in a separate terminal block (not supplied) and place in the ceiling away from the fitting. Where more than a single set of L, N and E wires exist these must be transferred to a separate approved junction box or terminal block (not supplied) which must be insulated and placed within the ceiling.
- > When making connections, ensure that the terminals are tightened securely and that no strands of wire protrude. Check that the terminals are tightened onto the bared conductors and not onto any insulation. Wrap loose terminal blocks well with insulating tape.
- > This fitting is double insulated, do not connect any part to earth.

- > **IMPORTANT**— Always switch off at the mains before changing the lamp.
- > You are advised at every stage of your installation to double-check any electrical connections you have made. After you have completed your installation there are electrical tests that should be carried out: these tests are specified in the Wiring Regulations (BS7671) referred to in the Building Regulations. If in doubt, consult a qualified electrician.

Installation:

- 1) Attach the terminal block to the small bracket using the screw supplied—see figure 1 opposite.
- 2) Attach the bracket and block to the light fitting and secure using the screw supplied—see figure 2 opposite.
- 3) Squeeze the coils of the spring clips together, insert into the "H" slot on either side of the fitting and release—see fig.4.
- 4) Fit the lamp and secure in place using the circlip—see back page for details.
- 5) Choose the location for your downlight and make the fixing hole—see figure 3 opposite for dimensions. After marking the hole, check against your light fitting before cutting.
- 6) Place the transformer in the ceiling void or other suitable location and connect to the mains. Ensure that you comply with all of the requirements listed in the manufacturers instructions for installation of your transformer.
- 7) Connect the transformer output cable to the connector block on the bracket at the back of the fitting. Ensure that the connections are secure and that there are no bare wires protruding from the terminals. Ensure that cables are securely gripped by the cord restraints inside the connector block.
- 8) Lift the spring clips on each side of the fitting so that they point upwards.
- 9) Push the downlight into the hole cut out in your ceiling until properly flush. The strength of the springs will retain the fitting.
- 10) Restore the power and switch on.

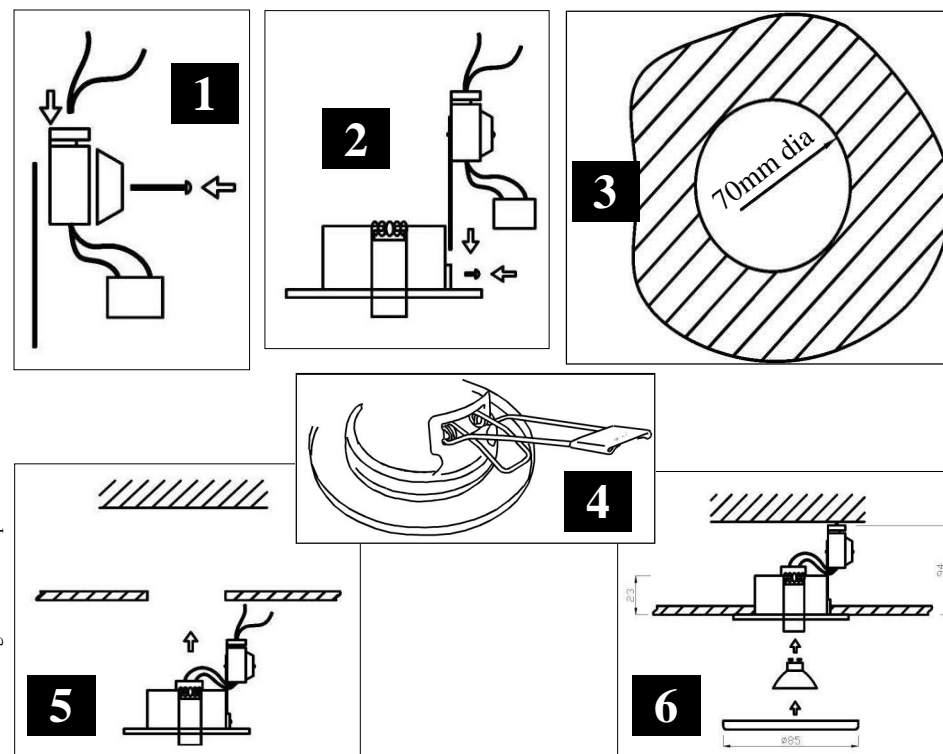

ELV Shower Light 080328PA.pub

Safety markings:

