

10	9	8	
MAT'L NO.	ENG NO.	STUD SIZE	Ø"S" ±.010 (0.25)
191640069	SC-241-06	6	.146 (3.71)
191640070	SC-241-08	8	.173 (4.39)
191640071	SC-241-10	10	.198 (5.03)

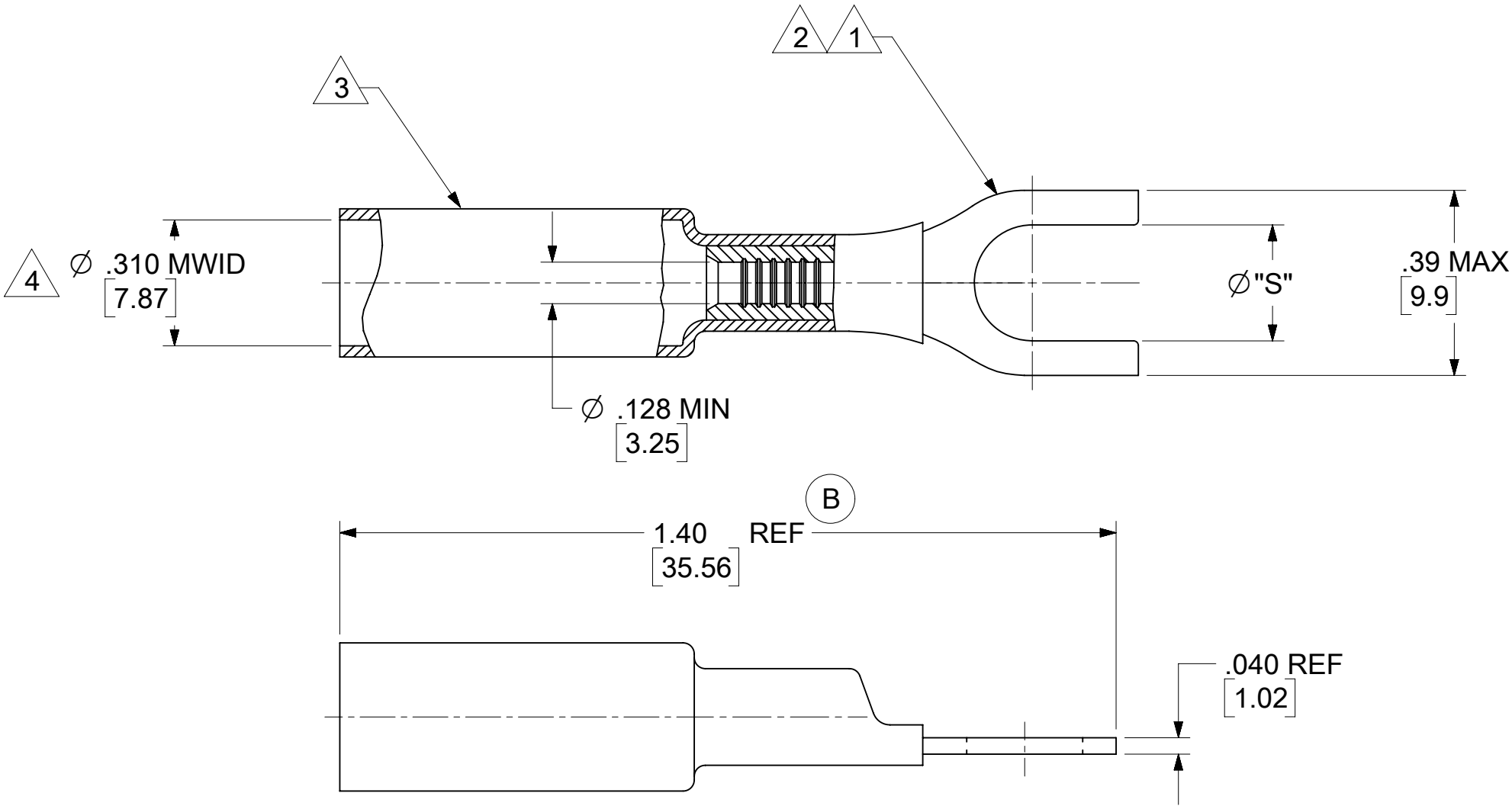

NOTE(S):

- 1 TERMINAL MATERIAL: COPPER ALLOY
- 2 FINISH: ELCTRO TIN PLATE
- 3 INSULATION MATERIAL: HEAT SHRINKABLE TUBING WITH HOTMELT ADHESIVE INNER LINER.
- COLOR: YELLOW
- 4 MWID = MAXIMUM WIRE INSULATION DIAMETER.
- 5. PARTS ARE RoHS COMPLIANT.

FUNCTIONAL SYMBOLS F/A = 0 F/C = 0 F/D = 0 DIVISIONAL SYMBOLS	THIS DRAWING CONTAINS INFORMATION THAT IS PROPRIETARY TO MOLEX ELECTRONIC TECHNOLOGIES, LLC AND SHOULD NOT BE USED WITHOUT WRITTEN PERMISSION											
	DIMENSION UNITS		SCALE		CURRENT REV DESC: DIM WAS MAX			<div>molex</div>				
	INCH/MM		NTS									
	GENERAL TOLERANCES (UNLESS SPECIFIED)											
		MM		INCH		EC NO: 803695 DRWN: DEANNM1 CHK'D: ETHRODAHL APPR: ETHRODAHL 2024/11/05 2024/11/11 2024/11/11						
	4 PLACES		±	±								
	3 PLACES		±	±								
	2 PLACES		±	±								
	1 PLACE		±	±								
	0 PLACES		±	±	INITIAL REVISION: DRWN: APPR:			DOCUMENT NUMBER		DOC TYPE	DOC PART	REVISION
ANGULAR TOL		±	°	SD-19164-048				PSD	001	B		
DRAFT WHERE APPLICABLE MUST REMAIN WITHIN DIMENSIONS				THIRD ANGLE PROJECTION		DRAWING	SERIES	MATERIAL NUMBER		CUSTOMER		SHEET NUMBER
						B-SIZE	19164			GENERAL MARKET		1 OF 1