

SPECIFICATIONS

Mechanical

Operating Force: 0.40Kg max.

Travel: 2.4 ± 0.1 mm

Durability: 1000 Cycles min.

Electrical

Rating: 200mA max., 60V AC/50V DC max.

Contact Resistance: initial $30m\Omega$ max., final $50m\Omega$ max.

Insulation Resistance: $1000M\Omega$ min.

Bounce: 5ms max.

LED Operating Voltage: Forward 4.5V max., Reverse 5V max.

Physical

Operating Temperature: -40°C to $+85^{\circ}\text{C}$ at 85% RH max.

Package: 49PCS/Tray, 30 Trays/Package

Push Switch

1B3M501 Series

T/H Type

Blue LED Built-in

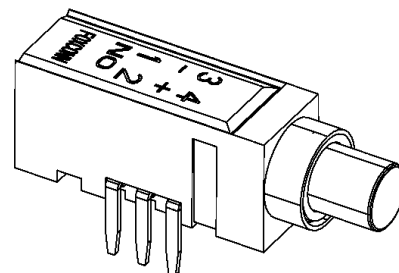

DRAWING

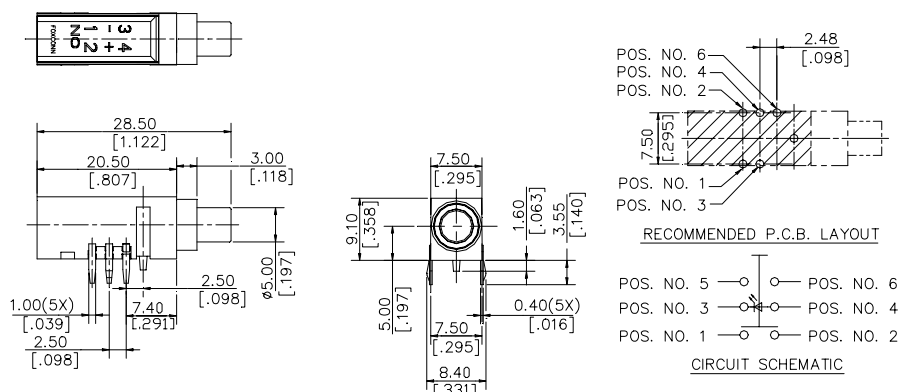

ORDERING INFORMATION

PRODUCT NO.: 1B3M501-003

Switch ————
 Push Type ————
 Momentary ————
 Product Series ————

003: Blue LED,Cut Pos. No. 5,W/O Cap