

THIS DRAWING IS UNPUBLISHED.

RELEASED FOR PUBLICATION

AUG ,2006.

© COPYRIGHT 2011 BY TYCO ELECTRONICS CORPORATION.

ALL RIGHTS RESERVED.

LOC  
DW

DIST

REVISONS

P

LTR

DESCRIPTION

DATE

DWN

APVD

F1

REVISED, ECR-14-013646

30MAR15

SC

HL

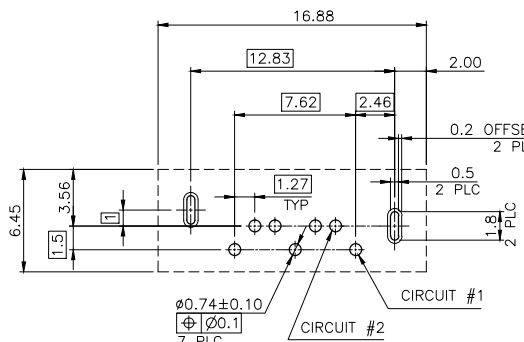
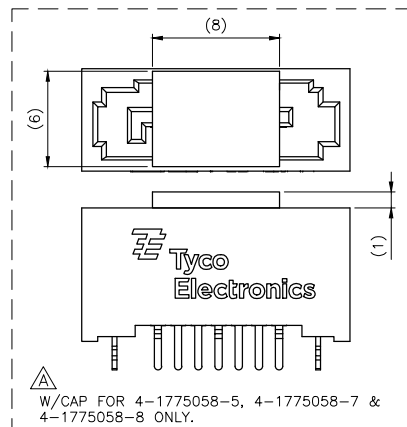
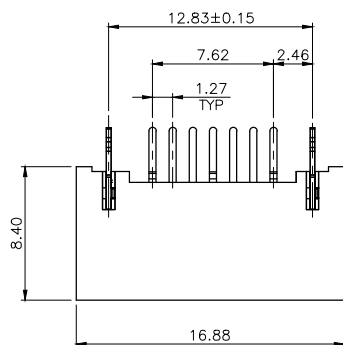

TOLERANCE:  $\pm 0.05$ , THICKNESS: (ESTABLISHED BY CUSTOMER)  
RECOMMENDED PCB LAYOUT  
(TOP VIEW)

△ SUBSTANCE RESTRICTIONS FOR LOW HALOGEN (BY WEIGHT):

- BROMINE (Br)  $\leq 900$  PPM (0.09%)
- CHLORINE (Cl)  $\leq 900$  PPM (0.09%)
- TOTAL CONCENTRATION OF CHLORINE (Cl) + BROMINE (Br)  $\leq 1500$  PPM (0.15%)

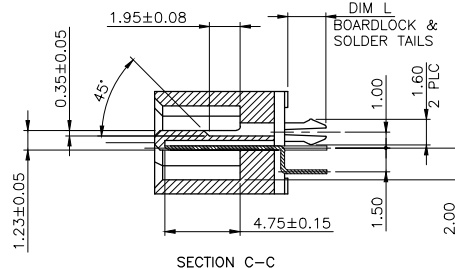
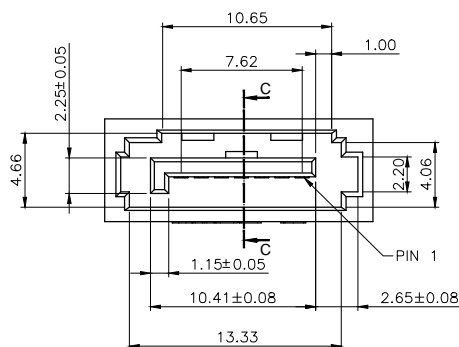

## NOTES:

- MATERIAL:  
HOUSING: PA6T UL94 V-0, COLOR: (SEE TABLE)  
LCP UL94 V-0, BLACK COLOR.  
CAP: LCP UL94 V-0, BLACK COLOR.  
CONTACT: BRASS.  
PEG: BRASS.
- FINISH:  
CONTACT: GOLD (SEE TABLE) PLATING ON CONTACT AREA 100μ" MIN. MATTE-TIN PLATING ON SOLDERTAILS 50μ" MIN. NICKEL UNDERPLATING OVER ALL.  
PEG: 100μ" MIN. TIN PLATING ON SOLDERTAILS 50μ" MIN. NICKEL UNDERPLATING OVER ALL.
- WAVE SOLDER CAPABLE TO 265°C AS PER TE CONNECTIVITY SPEC. 109-202, CONDITION B.
- TAPE AND REEL PACKAGING.
- NO DATECODE ON THE PRODUCT.

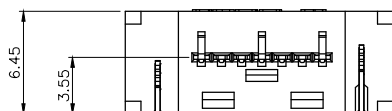
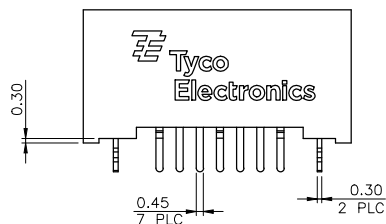

△△△△

△△

△△

1.80	BLACK	15μ"	<del>4-1775058-8</del>
	DARKEST BLUE (661C)	15μ"	4-1775058-7
	WHITE (COOL GRAY 1C)	15μ"	4-1775058-6
	ORANGE (157C)	15μ"	4-1775058-5
2.05	DARK BLUE (293C)	G/F	<del>4-1775058-4</del>
	WHITE (COOL GRAY 1C)	G/F	<del>4-1775058-3</del>
	BLACK	G/F	<del>4-1775058-2</del>
DIM L	HOUSING COLOR	MIN. GOLD THICKNESS	PART NUMBER

2.40

DIM L	HOUSING COLOR	MIN. GOLD THICKNESS	PART NUMBER
-------	---------------	---------------------	-------------



TE Connectivity

SERIAL ATA CONNECTOR, 7 PIN,  
VERTICAL HEADER, B TYPE.

SIZE

CAGE CODE

DRAWING NO

RESTRICTED TO

A3

00779

C=1775058

—

CUSTOMER DRAWING

SCALE —

SHEET

1 of 3

REV F1

THIS DRAWING IS UNPUBLISHED.

RELEASED FOR PUBLICATION

AUG ,2006.



COPYRIGHT 2011

BY TYCO ELECTRONICS CORPORATION.

ALL RIGHTS RESERVED.

LOC  
DW

DIST

REVISIONS

P	LTR	DESCRIPTION	DATE	DWN	APVD
		SEE SHEET 1.			

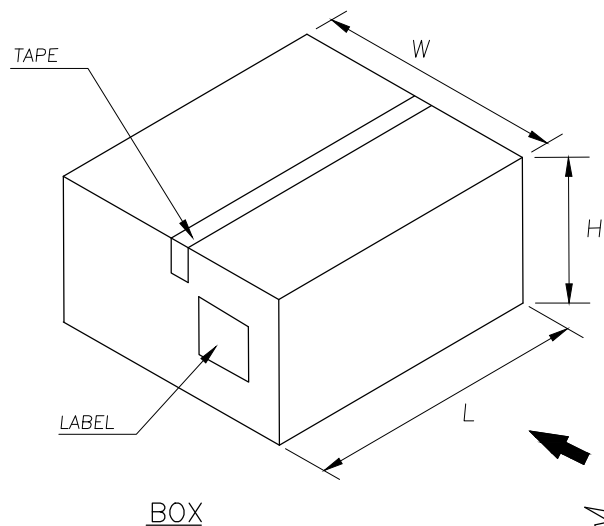

INNER CARTON

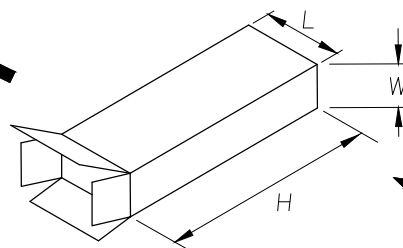

SHEAF

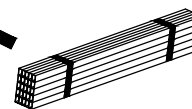

TUBE

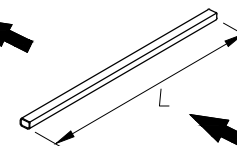

CONNECTOR

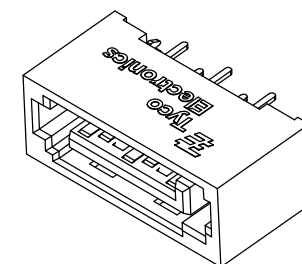

NOTE:

1. DIMENSION:  
TUBE: L= 473, W= 13.4, H= 8.1  
INNER CARTON: L= 485, W= 72, H= 86  
CARTON: L= 500, W= 187, H= 169
2. QUANTITY:  
26 PCS/TUBE  
45 TUBES/SHEAF  
1 SHEAFS/INNER CARTON  
4 INNER CARTONS/CARTON  
4680 PCS/BOX
3. WEIGHT:  
N/W: 4.68 KG  
G/W: 6.68 KG

THIS DRAWING IS A CONTROLLED DOCUMENT.

DWN

CHK

APVD

PRODUCT SPEC

APPLICATION SPEC

WEIGHT

—

CUSTOMER DRAWING



TE Connectivity

NAME

SERIAL ATA CONNECTOR, 7 PIN,  
VERTICAL HEADER, B TYPE.

SIZE

CAGE CODE

DRAWING NO

A300779C=1775058

RESTRICTED TO

SCALE

SHEET

2 OF 3

REV

F1

DIMENSIONS:

MM

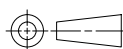

TOLERANCES UNLESS

OTHERWISE SPECIFIED:

0 PLC	± -
1 PLC	± -
2 PLC	± -
3 PLC	± -
4 PLC	± -
ANGLES	± -

MATERIAL

FINISH

THIS DRAWING IS UNPUBLISHED.

RELEASED FOR PUBLICATION

AUG 2006

©

COPYRIGHT 2011

BY TYCO ELECTRONICS CORPORATION.

ALL RIGHTS RESERVED.

LOC  
DW

DIST

REVISIONS

P

LTR

DESCRIPTION

DATE

DWN

APVD

SEE SHEET 1.

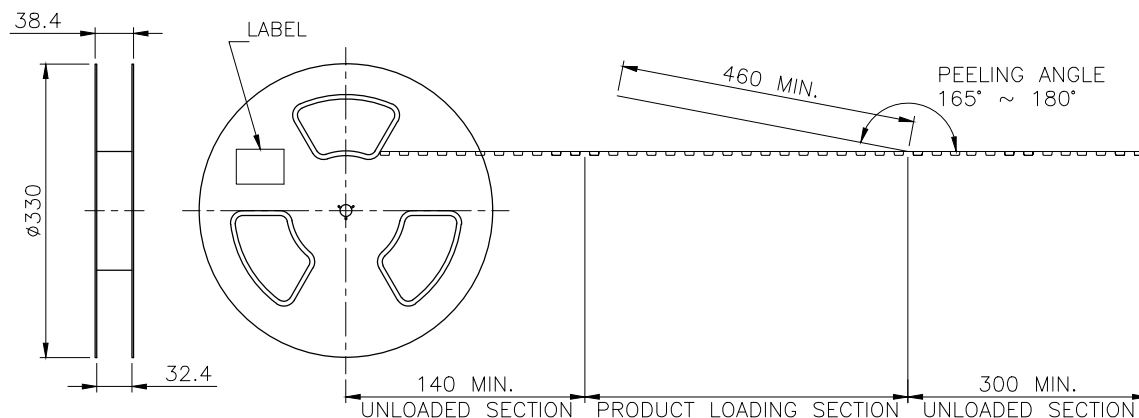

## NOTES:

1. MATERIAL:  
BOX: FIBREBOARD, CORRUGATED, DOUBLE WALL.  
COVER TAPE: PET, TRANSPARENT COLOR.  
CARRIER TAPE: POLYSTYRENES, TRANSPARENT COLOR.  
REEL: HIPS, BLUE COLOR.  
BAG: POLYETHYLENES, TRANSPARENT COLOR.
2. EACH BAG SHALL BE INCLUDED DESICCANT.
3. PEELING STRENGTH: 0.1 ~ 1.3 N (10 ~ 130 GRAMS).
4. PEELING SPEED: 300 mm/min.

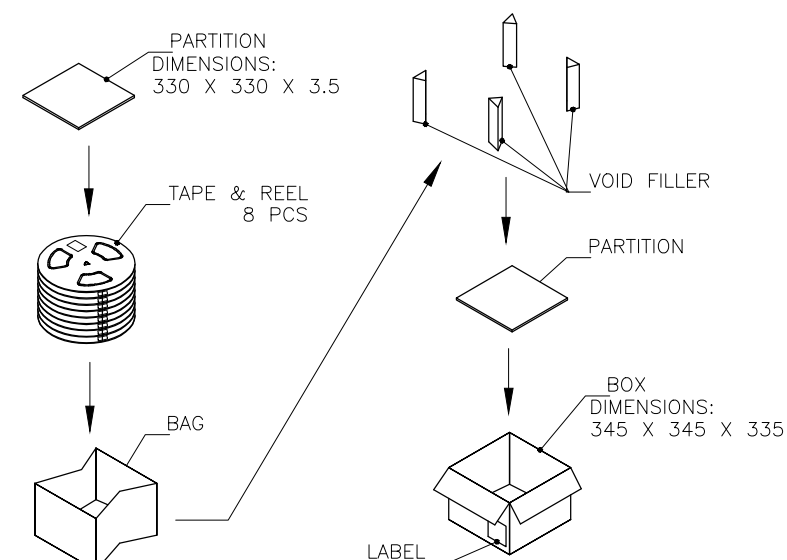
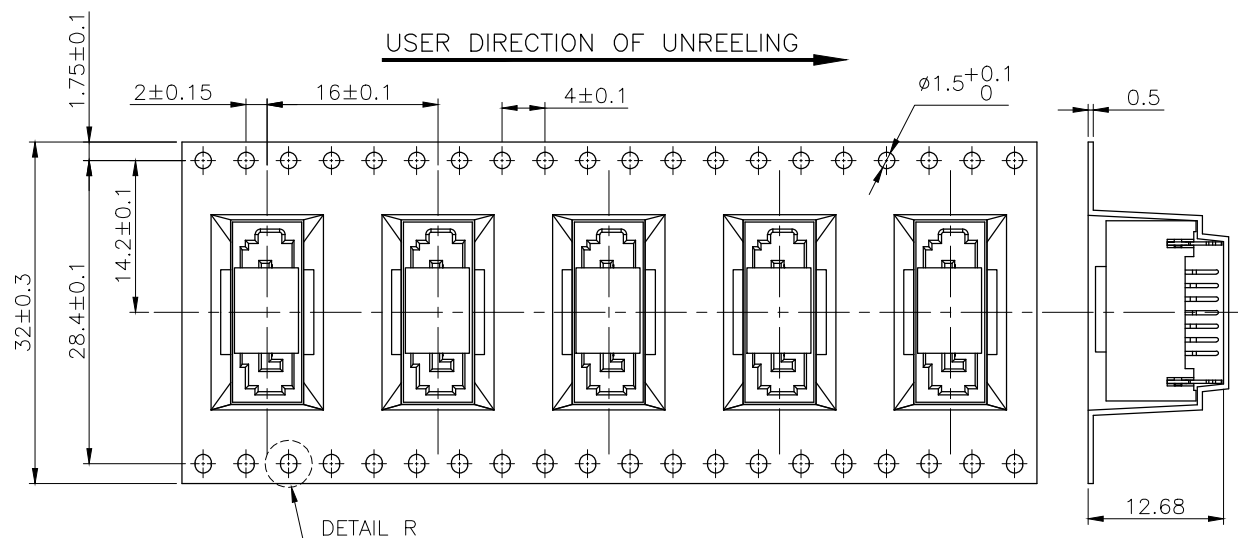

2400	8	300	4-1775058-8
			4-1775058-7
			4-1775058-5
PCS/BOX	REELS/BOX	PCS/TAPE	PART NUMBER

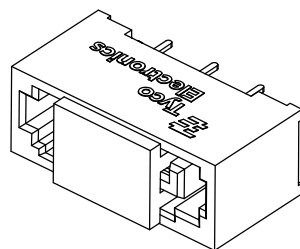
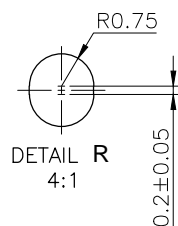

THIS DRAWING IS A CONTROLLED DOCUMENT.

DIMENSIONS:

MM

TOLERANCES UNLESS  
OTHERWISE SPECIFIED:

0 PLC  $\pm$  -  
1 PLC  $\pm$  -  
2 PLC  $\pm$  -  
3 PLC  $\pm$  -  
4 PLC  $\pm$  -  
ANGLES  $\pm$  -

MATERIAL

FINISH

DWN

CHK

APVD

PRODUCT SPEC

APPLICATION SPEC

WEIGHT

-

CUSTOMER DRAWING

TE

TE Connectivity

NAME

SERIAL ATA CONNECTOR, 7 PIN,  
VERTICAL HEADER, B TYPE.

SIZE

CAGE CODE

DRAWING NO

A3

00779

C=1775058

RESTRICTED TO

-

SCALE

-

SHEET

3 of 3

REV

F1