

# INSULATED PC SPACERS/SUPPORTS

- One piece design eliminates the need for additional screws and nuts
- Slim design frees up board space

## TENSION-FIT

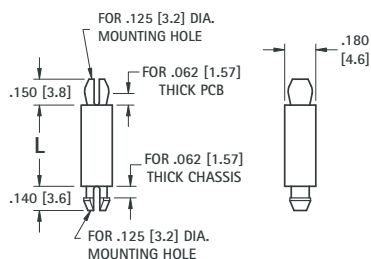
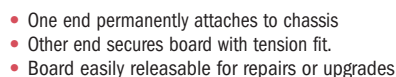

CAT. NO.	L LENGTH
8879	.125 (3.2)
8880	.187 (4.7)
8881	.250 (6.4)
8882	.375 (9.5)
8883	.500 (12.7)
8884	.625 (15.9)
8885	.750 (19.1)
8886	.875 (22.2)
8887	1.000 (25.4)

### EASY LOCK-IN

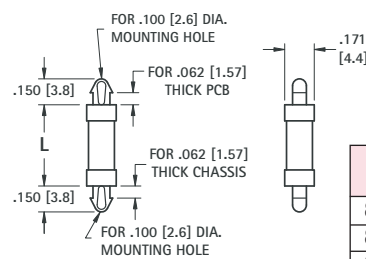
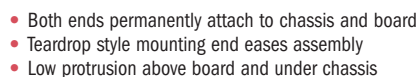

CAT. NO.	L LENGTH
8888	.125 (3.2)
8889	.187 (4.7)
8890	.250 (6.4)
8891	.375 (9.5)
8892	.500 (12.7)
8893	.625 (15.9)

## LOCK-IN

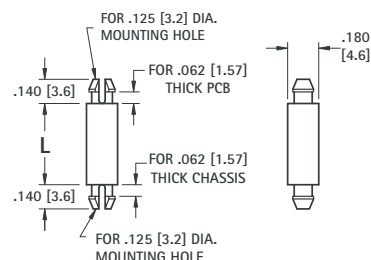
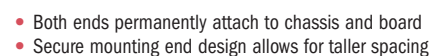

CAT. NO.	L LENGTH
9018	.125 (3.2)
9019	.187 (4.7)
9020	.250 (6.4)
9021	.375 (9.5)
9022	.500 (12.7)
9023	.625 (15.9)
9024	.750 (19.1)
9025	.875 (22.2)
9026	1.000 (25.4)

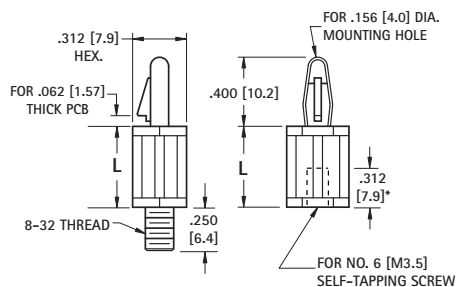
**THREADED**

MALE CAT. NO.	L LENGTH	FEMALE CAT. NO.
9048	.250 (6.4)	9041
9049	.375 (9.5)	9042
9050	.500 (12.7)	9043
9051	.625 (15.9)	9044
9052	.750 (19.1)	9045
9053	.875 (22.2)	9046
9054	1.000 (25.4)	9047

## THRU HOLE SPACERS

- Base has larger surface area. Will not deform under heavy pre-load.

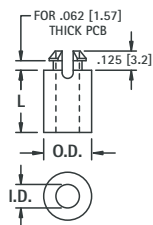

**MATERIAL:** Nylon 6/6,  
UL Rated 94V-0

CAT. NO.	L LENGTH	Outside Diameter	Inside Diameter	Mounting Hole	Screw Size
<b>9027</b>	.125 (3.2)	.260 (6.6)	.125 (3.2)	.187 (4.7)	#4
<b>9028</b>	.187 (4.7)				
<b>9029</b>	.250 (6.4)				
<b>9030</b>	.375 (9.5)				
<b>9031</b>	.500 (12.7)				
<b>9032</b>	.625 (15.9)	.281 (7.1)	.153 (3.9)	.234 (5.9)	#6
<b>9033</b>	.250 (6.4)				
<b>9034</b>	.375 (9.5)				
<b>9035</b>	.500 (12.7)				
<b>9036</b>	.625 (15.9)				
<b>9037</b>	.250 (6.4)	.281 (7.1)	.169 (4.3)	.234 (5.9)	#8
<b>9038</b>	.375 (9.5)				
<b>9039</b>	.500 (12.7)				
<b>9040</b>	.625 (15.9)				

## STACKING SPACERS

- Spacers can be stacked for multiple level PC board applications
- Self-aligning

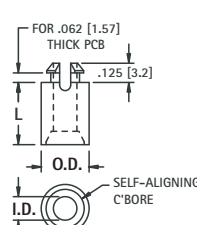

CAT. NO.	L LENGTH	Outside Diameter	Inside Diameter	Mounting Hole	Screw Size
<b>8829</b>	.125 (3.2)	.260 (6.6)	.125 (3.2)	.187 (4.7)	#4
<b>8830</b>	.187 (4.7)				
<b>8831</b>	.250 (6.4)				
<b>8832</b>	.375 (9.5)				
<b>8833</b>	.500 (12.7)				
<b>8834</b>	.625 (15.9)				
<b>8835</b>	.250 (6.4)	.312 (7.9)	.153 (3.9)	.234 (5.9)	#6
<b>8836</b>	.375 (9.5)				
<b>8837</b>	.500 (12.7)				
<b>8838</b>	.625 (15.9)				
<b>8839</b>	.250 (6.4)	.312 (7.9)	.169 (4.3)	.234 (5.9)	#8
<b>8840</b>	.375 (9.5)				
<b>8841</b>	.500 (12.7)				
<b>8842</b>	.625 (15.9)				

# Mouser Electronics

Authorized Distributor

Click to View Pricing, Inventory, Delivery & Lifecycle Information:

[Keystone Electronics:](#)

[8840](#)