

## EVEREADY 1235

**C**

**SUPER HEAVY DUTY**



### Industry Standard Dimensions

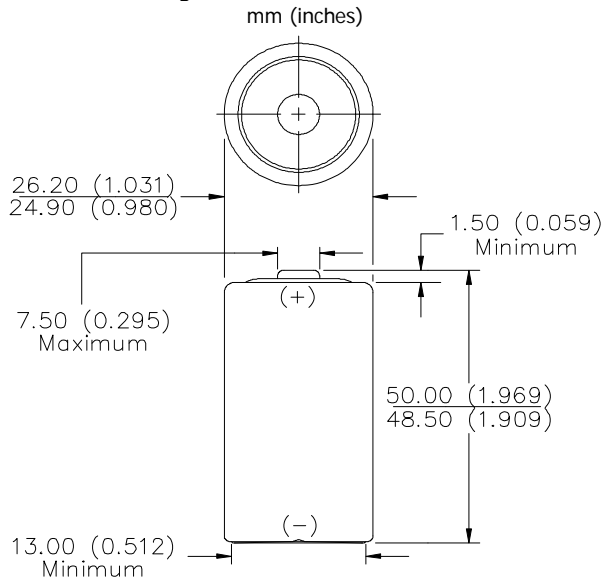

**Chemical System:** Zinc-Manganese Dioxide (Zn/MnO<sub>2</sub>)  
(No Added Mercury or Cadmium)

**Designation:** ANSI-14D, IEC-R14

**Battery Voltage:** 1.5 Volts

**Operating Temp:** -18°C to 55°C (0°F to 130°F)

**Average Weight:** 45.0 grams (1.6 oz.)

**Volume:** 25 cubic centimeters (1.5 cubic inch)

**Average Capacity:** 3800 mAh to 0.8 volts  
(Rated at 25 mA continuous at 21°C)

**Cell:** One No. 35 (size "C")

**Jacket:** Metal

### TYPICAL TEMPERATURE EFFECT 3.9 ohm - 4 hours/day to 0.75 volts

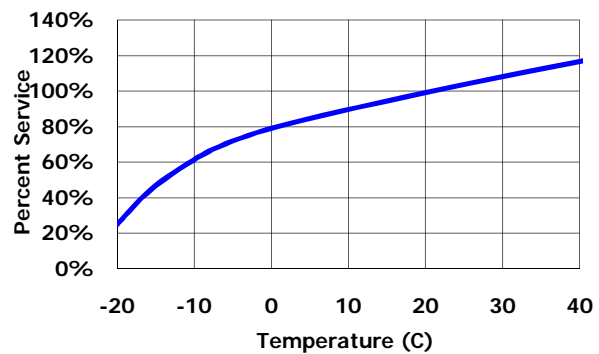

### CONSTANT RESISTANCE PERFORMANCE Typical Service

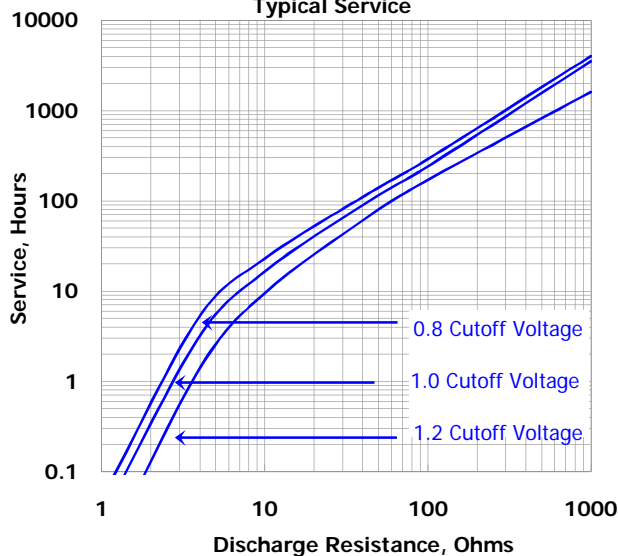

### CONSTANT CURRENT DISCHARGE Typical Service

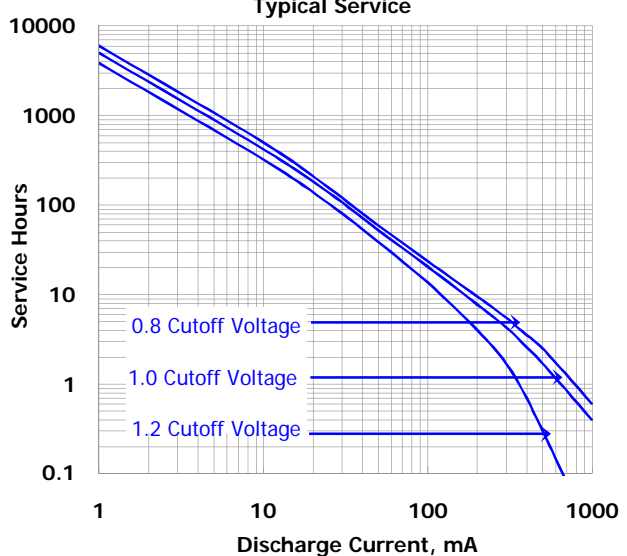

### Important Notice

This data sheet contains information specific to batteries manufactured at the time of its publication.

**Contents herein do not constitute a warranty.**

Copyright © Eveready Battery Co. - All rights reserved

# EVEREADY 1235

## Industry Standard Tests (21° C)

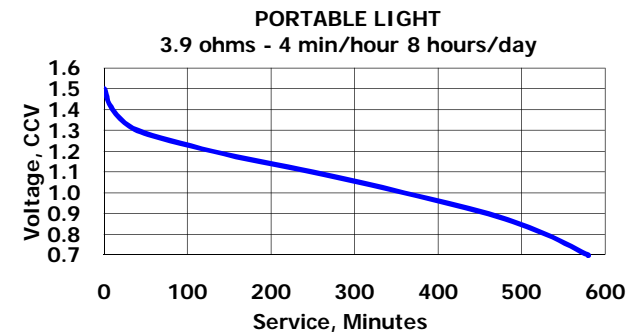
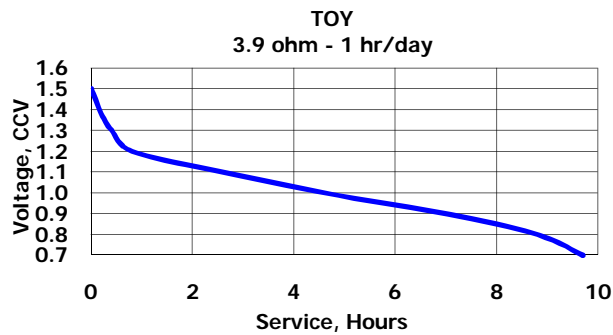
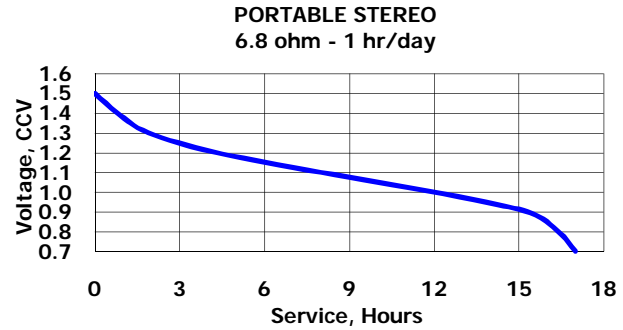
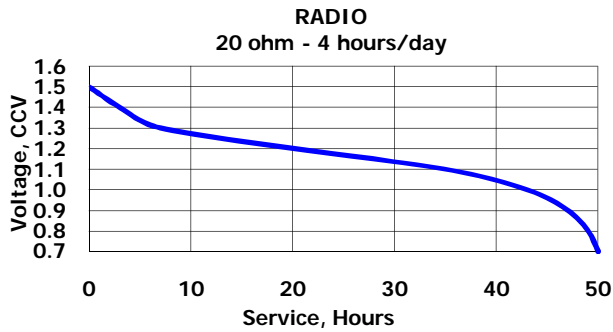

### Important Notice

This data sheet contains information specific to batteries manufactured at the time of its publication.

**Contents herein do not constitute a warranty.**

Copyright © Eveready Battery Co. - All rights reserved

# Mouser Electronics

Authorized Distributor

Click to View Pricing, Inventory, Delivery & Lifecycle Information:

[Energizer:](#)

[12354](#)