

DESIGNED & DIMENSIONED  
IN MILLIMETERS[INCHES]

SEAF8-XX-05.0-X-XX-X-K

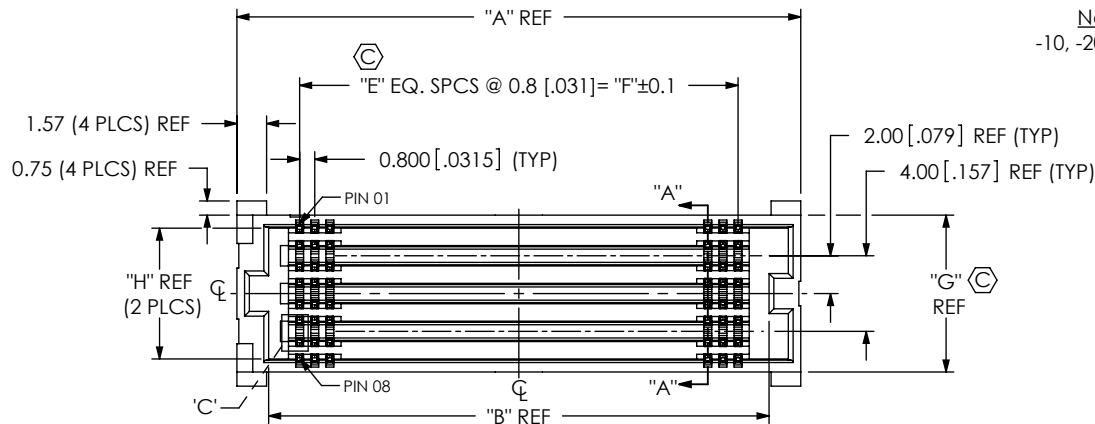

No OF POSITIONS  
-10, -20, -30, -40, -50, \*\*\*-60  
(PER ROW)

LEAD STYLE  
-05.0= 5mm

PLATING SPECIFICATION  
-S: .000030" SELECTIVE GOLD  
IN CONTACT AREA,  
MATTE TIN ON TAIL  
-L: .000010" LIGHT SELECTIVE  
GOLD IN CONTACT AREA,  
MATTE TIN ON TAIL

ROW

-04: 4 ROWS  
-06: 6 ROWS  
-08: 8 ROWS (SEE NOTE 10)  
-10: 10 ROWS (SEE NOTE 10)  
\*\*-12: 12 ROWS

K DOT  
(SEE SHT 3, FIG 2)(SEE NOTE 11)  
DOT APPLICATOR-KAPTON TAPE

SOLDER COMPOSITION  
& STYLE

\*-1: 63.0% TIN / 37.0% LEAD  
CHARGE TAIL  
-2: 95.5% TIN / 3.8% SILVER/  
0.7% COPPER CHARGE TAIL

(\* = NOT TOOLED)  
(\*\* = NOT ENGINEERING APPROVED)  
(\*\*\* = NOT ENGINEERING APPROVED, NOT  
TOOLED FOR -04, -06 & -08 ROWS)

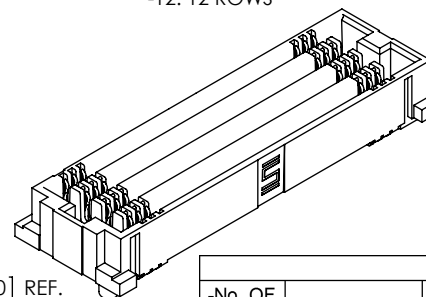
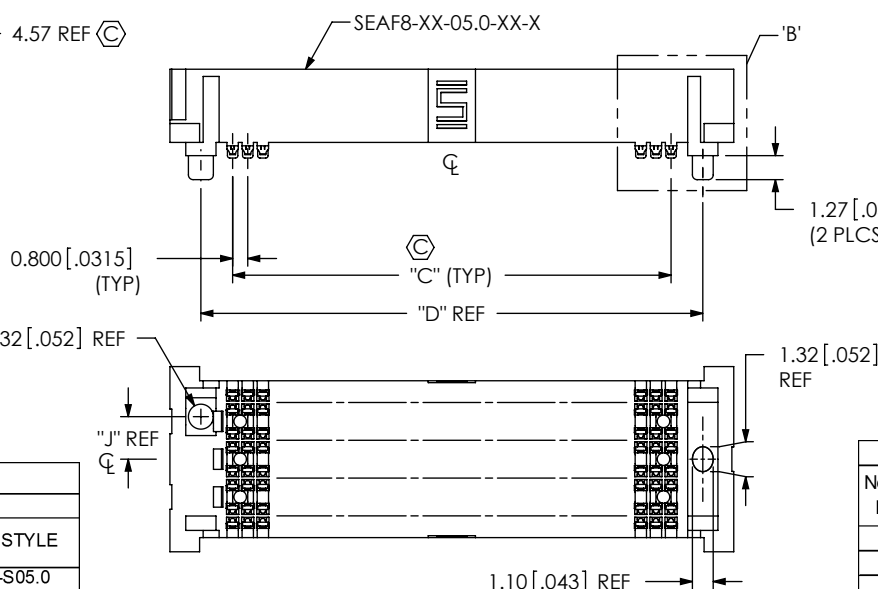
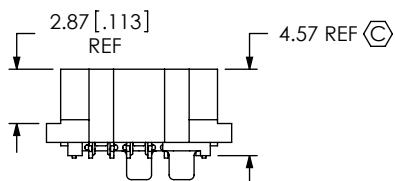

PATENT NUMBER  
7837522,  
ADDITIONAL  
PATENTS  
PENDING

TABLE 3

-No. OF ROWS	"G"	"H"	"J"	"Q"
-04	4.30 [0.169]	2.92 [0.115]	1.25 [0.049]	N/A
-06	6.30 [0.248]	4.92 [0.194]	2.25 [0.089]	N/A
-08	8.30 [0.327]	6.92 [0.272]	2.25 [0.089]	N/A
-10	10.30 [0.406]	8.92 [0.351]	2.25 [0.089]	10.46 [0.412]
** -12	12.30 [0.484]	10.92 [0.430]	2.25 [0.089]	12.46 [0.491]

(\*\* = NOT ENGINEERING APPROVED)

TABLE 2

No. OF POS. PER ROW	"A"	"B"	"C"	"D"	"E"	"F"
-10	13.84 [0.545]	10.48 [0.413]	7.20 [0.283]	10.56 [0.416]	9	7.200 [0.283]
-20	21.84 [0.860]	18.48 [0.728]	15.20 [0.598]	18.56 [0.731]	19	15.200 [0.598]
-30	29.84 [1.175]	26.48 [1.043]	23.20 [0.913]	26.56 [1.046]	29	23.200 [0.913]
-40	37.84 [1.490]	34.48 [1.357]	31.20 [1.228]	34.56 [1.361]	39	31.200 [1.228]
-50	45.84 [1.805]	42.48 [1.672]	39.20 [1.543]	42.56 [1.676]	49	39.200 [1.543]
***-60	53.84 [2.120]	50.48 [1.987]	47.20 [1.858]	50.56 [1.991]	59	47.200 [1.858]

(\*\*\* = NOT ENGINEERING APPROVED, NOT TOOLED FOR -04, -06 & -08 ROWS)

TABLE 1 STACK HEIGHT		
SEAF8 LEAD STYLE	SEAM8 LEAD STYLE	
	-S02.0	-S05.0
-05.0 [0.197]	7.0 [0.276]	10.0 [0.394]

FIG 1

(SEAF8-30-05.0-X-XX-X-K SHOWN)  
(SOME CENTER FEATURES REMOVED FOR CLARITY)

NOTES:

1. Ⓢ REPRESENTS A CRITICAL DIMENSION.
2. MINIMUM PUSH OUT FORCE 1.6N [0.36 LBS.]
3. DIMENSION TO BE MEASURED IN ALL FOUR CORNERS TO THE STAND-OFF.
4. TAPE & REEL WILL BE SUPPLIED WHETHER OR NOT -TR IS SPECIFIED.
5. FOR QUANTITIES UP TO 49 PCS., NO LEADER, TRAILER OR REEL WILL BE SUPPLIED, FOR QUANTITIES OF 50-124 PCS., NO LEADER OR TRAILER WILL BE SUPPLIED, SPLICES MAY BE PRESENT.
6. NOTE DELETED.
7. ATTACH LABEL "SEAX-0001" TO EACH TAPE & REEL PACKAGE.
8. MAXIMUM ROW TO ROW VARIATION 0.08 [.003], MEASURED FIRST AND LAST POSITIONS ONLY, ALL ROWS.
9. CENTER MACHINE LUGS ON -40, -50 & -60 POSITIONS ONLY.
10. 8 & 10 ROWS ARE RELEASED FOR NITROGEN ENVIRONMENT PROCESSING ONLY. NOT RECOMMENDED FOR AIR ONLY PROCESSING.
11. K DOT WILL BE SUPPLIED WHETHER OR NOT -K IS SPECIFIED".

UNLESS OTHERWISE SPECIFIED,  
DIMENSIONS ARE IN MILLIMETERS [INCHES].

TOLERANCES ARE:

DECIMALS ANGLES  
X.X: ±0.3 [.01] 2°  
X.XX: ±0.13 [.005]  
X.XXX: ±0.051 [.0020]

PROPRIETARY NOTE

THIS DOCUMENT CONTAINS CONFIDENTIAL AND  
PROPRIETARY INFORMATION AND ALL DESIGN,  
MANUFACTURING, REPRODUCTION, USE, PATENT RIGHTS  
AND SALES RIGHTS ARE EXPRESSLY RESERVED BY SAMTEC,  
INC. THIS DOCUMENT SHALL NOT BE DISCLOSED, IN WHOLE  
OR PART, TO ANY UNAUTHORIZED PERSON OR ENTITY NOR  
REPRODUCED, TRANSFERRED OR INCORPORATED IN ANY  
OTHER PROJECT IN ANY MANNER WITHOUT THE EXPRESS  
WRITTEN CONSENT OF SAMTEC, INC.

MATERIAL:

INSULATOR: LCP, COLOR BLACK  
CONTACT: COPPER ALLOY

DO NOT SCALE DRAWING

SHEET SCALE: 2:1

DESCRIPTION:  
0.8MM PITCH SOCKET ARRAY ASSY

DWG. NO.

SEAF8-XX-05.0-X-XX-X-K

BY: M MURILLO 01/09/09 SHEET 1 OF 3

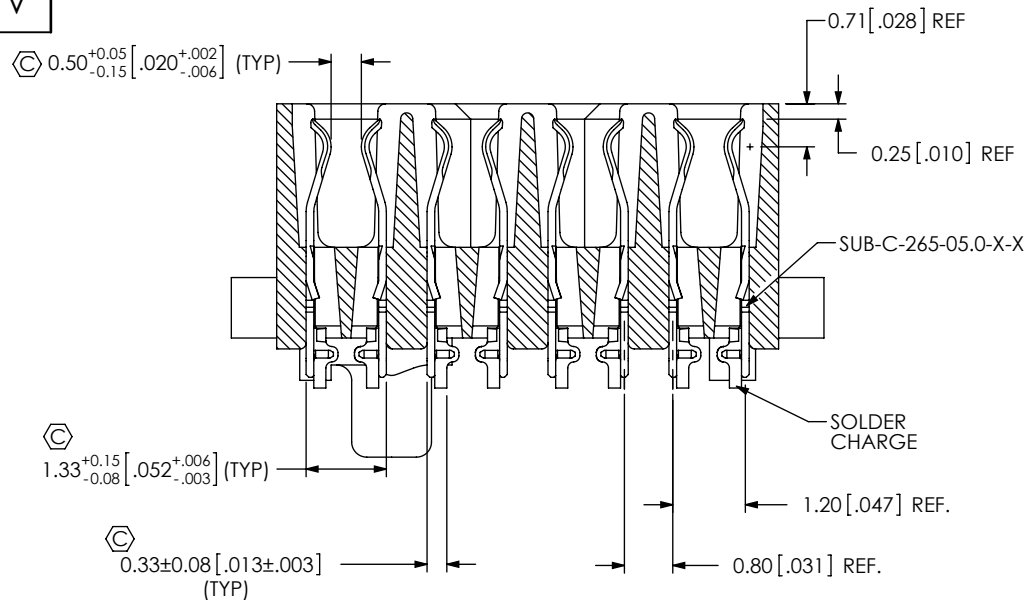

SECTION "A"-"A"  
SCALE 8 : 1  
(VIEW ROTATED 90°CW)

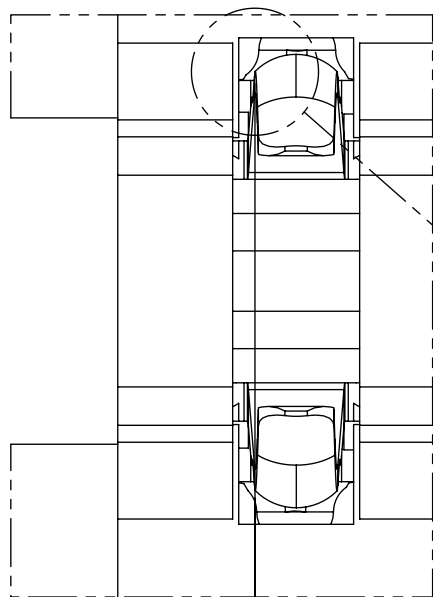
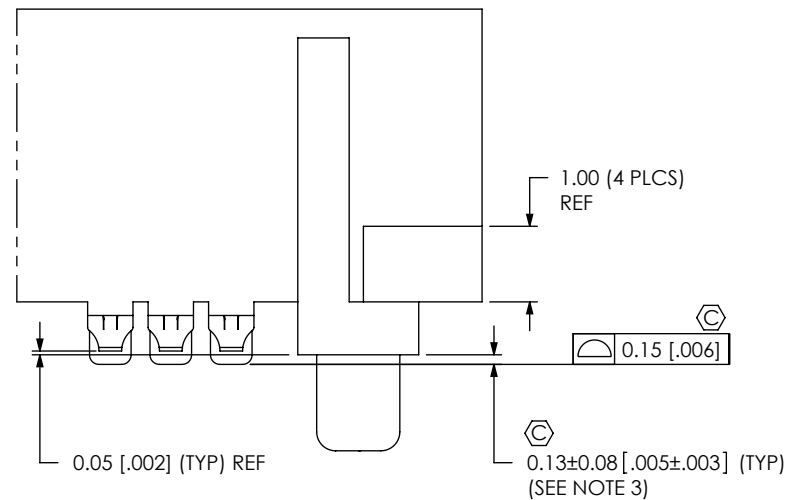

MEASUREMENTS TAKEN  
AT EDGE OF CONTACT

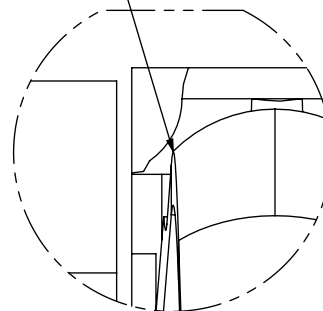

DETAIL 'F'  
SCALE 100 : 1

0.1 MAX  
(MEASURE FROM BEAM EDGES)

DETAIL 'C'  
SCALE 40 : 1

**PROPRIETARY NOTE**  
THIS DOCUMENT CONTAINS CONFIDENTIAL AND PROPRIETARY INFORMATION AND ALL DESIGN, MANUFACTURING, REPRODUCTION, USE, PATENT RIGHTS AND SALES RIGHTS ARE EXPRESSLY RESERVED BY SAMTEC, INC. THIS DOCUMENT SHALL NOT BE DISCLOSED, IN WHOLE OR PART, TO ANY UNAUTHORIZED PERSON OR ENTITY NOR REPRODUCED, TRANSFERRED OR INCORPORATED IN ANY OTHER PROJECT IN ANY MANNER WITHOUT THE EXPRESS WRITTEN CONSENT OF SAMTEC, INC.

DO NOT SCALE DRAWING

SHEET SCALE: 2:1

**samtec**

520 PARK EAST BLVD, NEW ALBANY, IN 47150  
PHONE: 812-944-6733 FAX: 812-948-5047  
e-Mail: info@SAMTEC.com code 55322

DESCRIPTION:  
0.8MM PITCH SOCKET ARRAY ASSY

DWG. NO.  
SEAF8-XX-05.0-X-XX-X-K

BY: M MURILLO 01/09/09 SHEET 2 OF 3

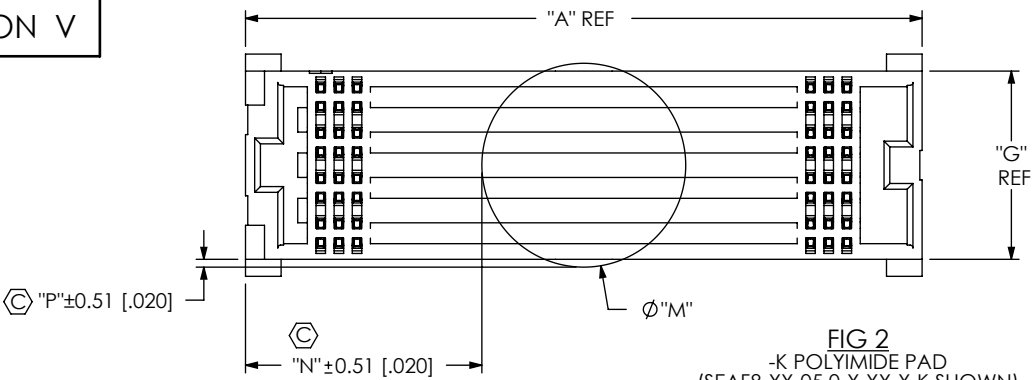

FIG 2  
-K POLYIMIDE PAD  
(SEAF8-XX-05.0-X-XX-X-K SHOWN)  
(SOME CENTER FEATURES REMOVED FOR CLARITY)

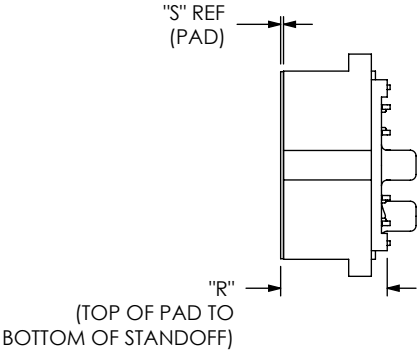

TABLE 4										
-No. OF ROWS	Ø "M"	"N"						"P"	"R"	
		10 POS	20 POS	30 POS	40 POS	50 POS	60 POS			
-04	5.51 [.217]	4.17 [.164]	8.17 [.321]	12.17 [.479]	16.17 [.636]	20.17 [.794]	24.17 [.951]	0.61 [.024]	4.70 [.185]	
-06	7.49 [.295]	3.18 [.125]	7.18 [.282]	11.18 [.440]	15.18 [.597]	19.18 [.755]	23.18 [.912]	0.60 [.023]	4.70 [.185]	
-08	8.99 [.354]	2.43 [.095]	6.43 [.253]	10.43 [.410]	14.43 [.568]	18.43 [.725]	22.43 [.883]	0.35 [.014]	4.70 [.185]	
-10	11.68 [.460]	1.08 [.043]	5.08 [.200]	9.08 [.357]	13.08 [.515]	17.08 [.672]	21.08 [.830]	0.69 [.027]	4.70 [.185]	
** -12	13.99 [.551]	0.08 [.003]	3.92 [.154]	7.93 [.312]	11.93 [.469]	15.93 [.627]	19.93 [.784]	0.85 [.033]	4.83 [.190]	

(\*\* = NOT ENGINEERING APPROVED)

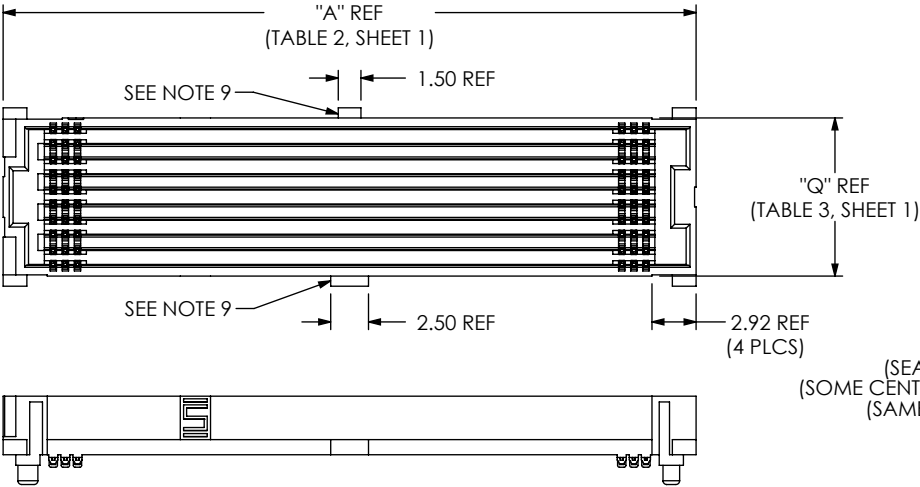

FIG 3  
(SEAF8-50-05.0-X-10-X-K SHOWN)  
(SOME CENTER FEATURES REMOVED FOR CLARITY)  
(SAME AS FIG 1, EXCEPT AS SHOWN)

TABLE 5		
-No. OF ROWS	K-DOT #	"S"
-04	K-DOT-.217-.313-.005	0.13 [.005]
-06	K-DOT-.295-.406-.005	0.13 [.005]
-08	K-DOT-.354-.469-.005	0.13 [.005]
-10	K-DOT-.460-.550-.005	0.13 [.005]
** -12	K-DOT-.551-.625-.010	0.25 [.010]

(\*\* = NOT ENGINEERING APPROVED)

**PROPRIETARY NOTE**  
THIS DOCUMENT CONTAINS CONFIDENTIAL AND PROPRIETARY INFORMATION AND ALL DESIGN, MANUFACTURING, REPRODUCTION, USE, PATENT RIGHTS AND SALES RIGHTS ARE EXPRESSLY RESERVED BY SAMTEC, INC. THIS DOCUMENT SHALL NOT BE DISCLOSED, IN WHOLE OR PART, TO ANY UNAUTHORIZED PERSON OR ENTITY NOR REPRODUCED, TRANSFERRED OR INCORPORATED IN ANY OTHER PROJECT IN ANY MANNER WITHOUT THE EXPRESS WRITTEN CONSENT OF SAMTEC, INC.

DO NOT SCALE DRAWING

SHEET SCALE: 2:1



520 PARK EAST BLVD, NEW ALBANY, IN 47150  
PHONE: 812-944-6733 FAX: 812-948-5047  
e-Mail info@SAMTEC.com code 55322

DESCRIPTION:  
0.8MM PITCH SOCKET ARRAY ASSY

DWG. NO.  
SEAF8-XX-05.0-X-XX-X-K

BY: M MURILLO 01/09/09 SHEET 3 OF 3