

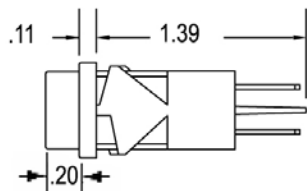

**Panel Mount Indicator, Non-Relampable  
Neon Technology  
Mounting Hole, Ø 0.500"**



All dimensions are in inches



**RoHS  
COMPLIANT**

Recommended panel thickness: 0.030" to 0.090"

**.187 terminals are standard**

Storage temperature  $T_{STG}$  : -25°C - +80°C  
Ambient temperature  $T_A$  : -20°C - +60°C  
Voltage tolerance  $V_{OP}$  : ±10%

Part No.	Lens Color	Voltage	Current mA	Rated Life
<b>Neon 115VAC Series</b>				
WL-1060QC1	Red	105-125VAC	1.5mA	25,000 Hrs
WL-1060QC3	Amber	105-125VAC	1.5mA	25,000 Hrs
WL-1060QC4	White	105-125VAC	1.5mA	25,000 Hrs
WL-1060QC5	Green	105-125VAC	1.5mA	25,000 Hrs
<b>Neon 230VAC Series</b>				
WL-1061QC1	Red	208-250VAC	1.5mA	25,000 Hrs
WL-1061QC3	Amber	208-250VAC	1.5mA	25,000 Hrs
WL-1061QC4	White	208-250VAC	1.5mA	25,000 Hrs
WL-1061QC5	Green	208-250VAC	1.5mA	25,000 Hrs
<b>Neon 480VAC Series</b>				
WL-1062QC1	Red	432-528VAC	1.5mA	25,000 Hrs
WL-1062QC3	Amber	432-528VAC	1.5mA	25,000 Hrs
WL-1062QC4	White	432-528VAC	1.5mA	25,000 Hrs
WL-1062QC5	Green	432-528VAC	1.5mA	25,000 Hrs
<b>Neon 600VAC Series</b>				
WL-1063QC1	Red	540-660VAC	1.5mA	25,000 Hrs
WL-1063QC3	Amber	540-660VAC	1.5mA	25,000 Hrs
WL-1063QC4	White	540-660VAC	1.5mA	25,000 Hrs
WL-1063QC5	Green	540-660VAC	1.5mA	25,000 Hrs

Body Material: Polycarbonate, white  
Lens Material: Polycarbonate  
Bezel Material: Stainless steel  
Note: .250 quick connects available upon request

Certifications: Most Wamco indicators carry Agency approvals. Please contact Wamco for the latest Agency information regarding the specific product series and voltage required.  
Options: Additional options and lens styles available. Please contact Wamco for more information.

Drawn	SC	03/01/10	Panel Mount Indicators Neon and Incandescent	Datasheet: WL-106XQCX Series	Rev: 1
Checked	EB	03/01/10			
Approved	EB	03/02/10			