

NOTES

- ALL DIMENSIONS ARE IN $\frac{\text{INCHES}}{[\text{MILLIMETERS}]}$
- DIMENSIONS APPEARING IN TABLE ARE AS FOLLOWS:
 - AS SUPPLIED
 - AFTER UNRESTRICTED RECOVERY
- COATING (ADHESIVE) IS OPTIONAL. AS SUPPLIED DIMENSIONS APPEARING IN TABLE ARE FOR UNCOATED PARTS. WHEN COATING IS ADDED, ENTRY DIAMETERS WILL BE REDUCED BY .06 MAX.
- MOLDING PORTS ARE OPTIONAL. WHEN -00 MODIFICATION NUMBER IS SPECIFIED MOLDING PORTS WILL BE LOCATED AS SHOWN.

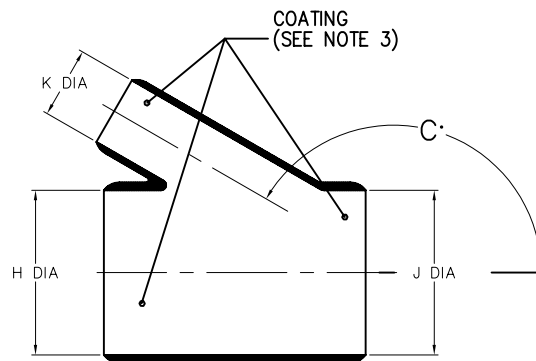

AS SUPPLIED

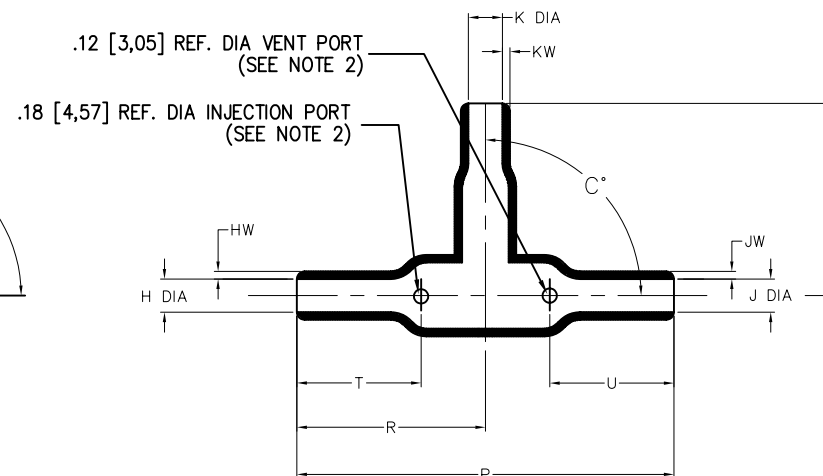

AFTER UNRESTRICTED RECOVERY

TABLE OF DIMENSIONS

PART DESCRIPTION	H & J		K		P	R	S	T	U	HW&JW	KW	C*	
	MIN	MAX	MIN	MAX	±10%	±10%	±10%	±10%	±10%	±20%	±20%	±10%	±5%
	a	b	a	b	b	b	b	b	b	b	b	a	b
322A412	$\frac{.70}{[17,7]}$	$\frac{.35}{[8,9]}$	$\frac{.40}{[10,1]}$	$\frac{.20}{[5,1]}$	$\frac{1.87}{[47,5]}$	$\frac{.93}{[23,6]}$	$\frac{.93}{[23,6]}$	$\frac{.75}{[19,1]}$	$\frac{.78}{[19,8]}$	$\frac{.059}{[1,50]}$	$\frac{.04}{[1,02]}$	165	90

CUSTOMER DRAWING

If this document is printed it becomes uncontrolled. Check for the latest revision

UNLESS OTHERWISE SPECIFIED DIMENSIONS ARE INCHES. METRIC DIMENSIONS ARE IN BRACKETS.		DRAWN UNGUYEN	DATE 04/17/2008		Raychem Molded Parts 305 Constitution Dr Menlo Park, CA 94025	
DECIMAL TOLERANCES .XXX ± 0.005 [0.13 mm] .XX ± 0.01 [0.25 mm] .X ± 0.1 [0.50 mm]		RPN			TITLE TRANSITION, 90 DEGREE, SIDE BREAKOUT, THINWALL	
ANGLE TOLERANCE .X ± 1 DEG.		THIRD ANGLE PROJECTION		SIZE B	CODE IDENT. NO. 06090	DWG. NO. 322A412
© 2008 Tyco Electronics Corporation. All rights reserved.				DO NOT SCALE THIS DRAWING		SHEET 1 OF 2

4		3		2		1	
COMPATIBILITY CHART							
MATERIAL DASH NO.	MATERIAL DESCRIPTION	RT SPEC	COATING SLASH NO.	COATING SPEC	COATING DESCRIPTION		
-3	POLYOLEFIN, SEMI-RIGID	RT-301	/42; /86	S-1017; S-1048	ADHESIVE		
-4	POLYOLEFIN, FLEXIBLE	RT-1304	/164, /86	S-1017; S-1048	ADHESIVE		
-5	ELASTOMER, FLEXIBLE	RT-501	/42,	S-1017	ADHESIVE		
-6	SILICONE	RT-602	N/A				
-12	FLUOROELASTOMER	RT-1312	N/A				
-25	ELASTOMER, FLUID RESISTANT	RT-1325	/86	S-1048	ADHESIVE		
-100	POLYOLEFIN, SEMI-FLEXIBLE ZEROHAL	RT-1323	/86; /180	S-1048; S-1030	ADHESIVE		

ORDERING INFORMATION

322A412-XX-XX/XX

BASE PART NUMBER

MATERIAL DASH NUMBER
(SEE COMPATIBILITY CHART)

MODIFICATION NUMBER

ADHESIVE SLASH NUMBER
(IF NECESSARY, SEE COMPATIBILITY CHART)

CUSTOMER DRAWING

SIZE
B

DWG. NO.
06090

REV
A

DWG. NO.
322A412

DO NOT SCALE THIS DRAWING

SHEET 2 OF 2

If this document is printed it becomes uncontrolled. Check for the latest revision