

# L17T Series Telecommunications Power Fuse

170 VDC ■ Current Limiting ■ 70 – 1200 Amperes



Specifically designed for short circuit protection of Telecommunications circuits, the Littelfuse L17T series fuses provide reliable protection of sensitive DC power distribution systems. Constructed with silver plated elements for low  $I^2t$  and peak let-through, these advanced fuses virtually eliminate equipment damage due to surges and spikes. The L17T series fuse's unique element geometry also provides cooler running temperatures, helping to minimize heat within enclosures.

## SPECIFICATIONS

**Voltage Rating:** 170 VDC

**Interrupting Rating:** 100,000 amperes

**Ampere Range:** 70 – 1200 amperes

**Approvals:** UL Recognized under the Components Program (File No: E71611)  
CSA Recognized under the Component Acceptance Program (File No: LR29862)

## AMPERE RATINGS

70	125	200	300	450	800	1100
90	150	225	350	500	900	1200
100	175	250	400	600	1000	

*Example part number (series & amperage): L17T 200*

## RECOMMENDED FUSE BLOCKS

LTFD 6001 and LTFD1200 series

Refer to the LTFD series in this catalog section for additional information.

## FEATURES

- Low  $I^2t$
- Extremely current limiting
- Low operating temperature
- 170 VDC rating



## ORDERING INFORMATION & CROSS REFERENCE

Catalog Number	Ampere Rating	Competitor A Part Number	Competitor B Part Number
L17T 70	70	TPL-BA	TGL-BA
L17T 90	90	TPL-BC	TGL-BC
L17T 100	100	TPL-BD	TGL-BD
L17T 125	125	TPL-BE	TGL-BE
L17T 150	150	TPL-BF	TGL-BF
L17T 175	175	TPL-BG	TGL-BG
L17T 200	200	TPL-BH	TGL-BH
L17T 225	225	TPL-BK	TGL-BK
L17T 250	250	TPL-BL	TGL-BL
L17T 300	300	TPL-CN	TGL-CN
L17T 350	350	TPL-CO	TGL-CO
L17T 400	400	TPL-CR	TGL-CR
L17T 450	450	TPL-CU	TGL-CU
L17T 500	500	TPL-CV	TGL-CV
L17T 600	600	TPL-CZ	TGL-CZ
L17T 800	800	TPL-CZH	TGL-CZH
L17T 900	900	-	-
L17T 1000	1000	-	-
L17T 1100	1100	-	-
L17T 1200	1200	-	-

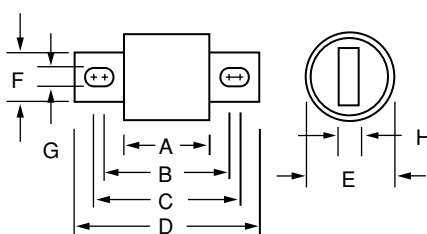

Fig. 3

AMPERE RATING	DIMENSIONS IN INCHES (mm in parentheses)							
	A	B	C	D	E	F	G	H
70 – 250	1-5/32 (29.4)	1-7/8 (47.6)	2-3/16 (55.6)	2-21/32 (67.5)	1 (25.4)	7/8 (22.2)	5/16 (7.9)	3/16 (4.8)
300 – 800	1-1/4 (31.8)	1-15/16 (49.2)	2-9/16 (65.1)	3-1/2 (88.9)	1-1/2 (38.1)	1 (25.4)	13/32 (10.3)	1/4 (6.35)
1000 – 1200	1-11/32 (34.0)	—	—	4-1/16 (103.12)	—	1-1/2 (38.1)	—	1/4 (6.35)

Contact Littelfuse for characteristic curves.