

SUGGESTED MATING TAB

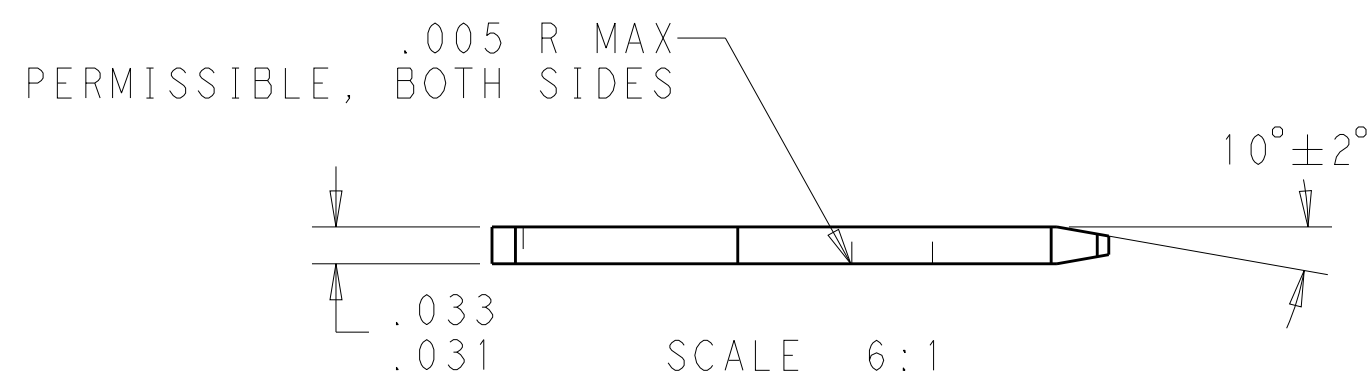

- 1 MATL: 1/2H BRASS OR NICKEL PL STEEL
- 2 NO BURRS PERMISSBLE AT HOLE
- △ MUST BE FLAT WITHIN .003 OVER THIS LENGTH
- 4 TIN PLATING IS REQUIRED ON BRASS WHEN TERMINAL TEMP IS OVER 225° F.
- 5 HOLE MUST BE SYMMETRICAL ABOUT TAB CENTERLINE WITHIN .003
- \* TO BE USED ONLY WHEN SHOULDER IS ELIMINATED.

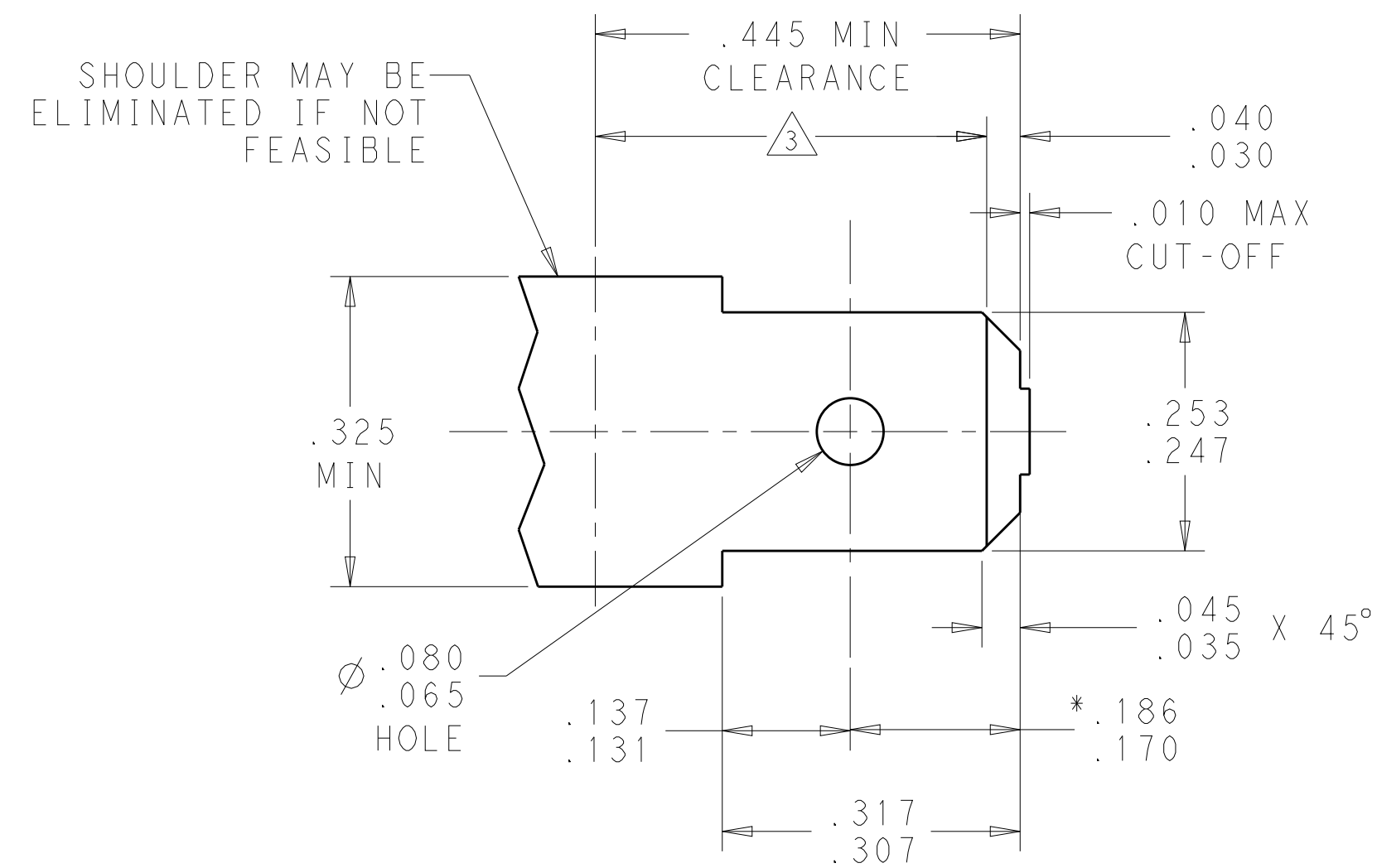
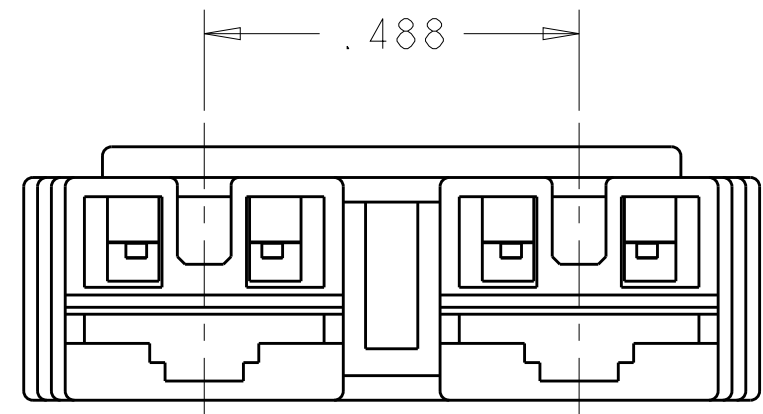
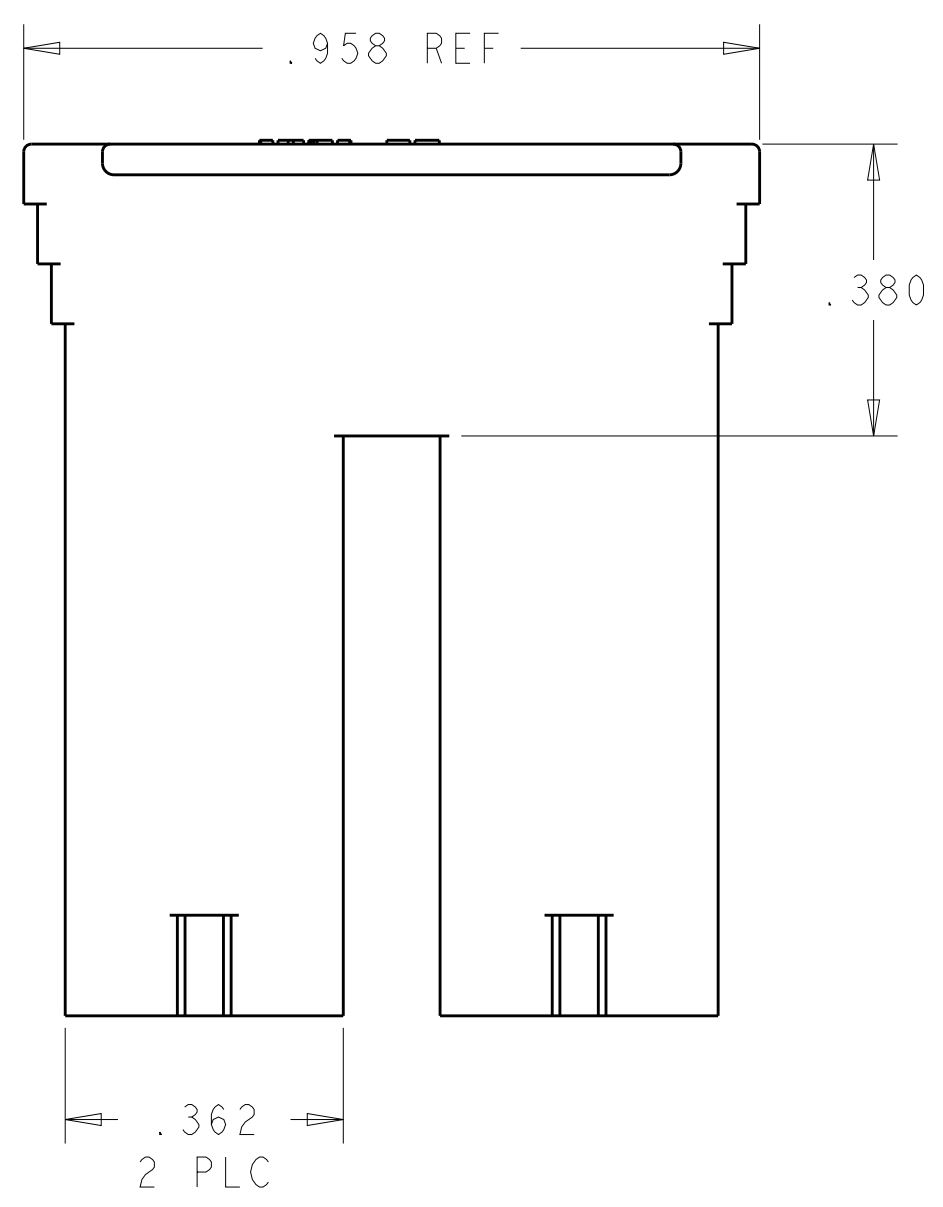
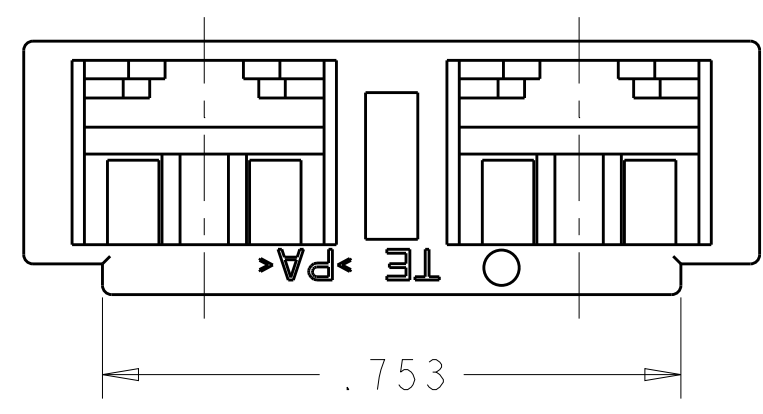
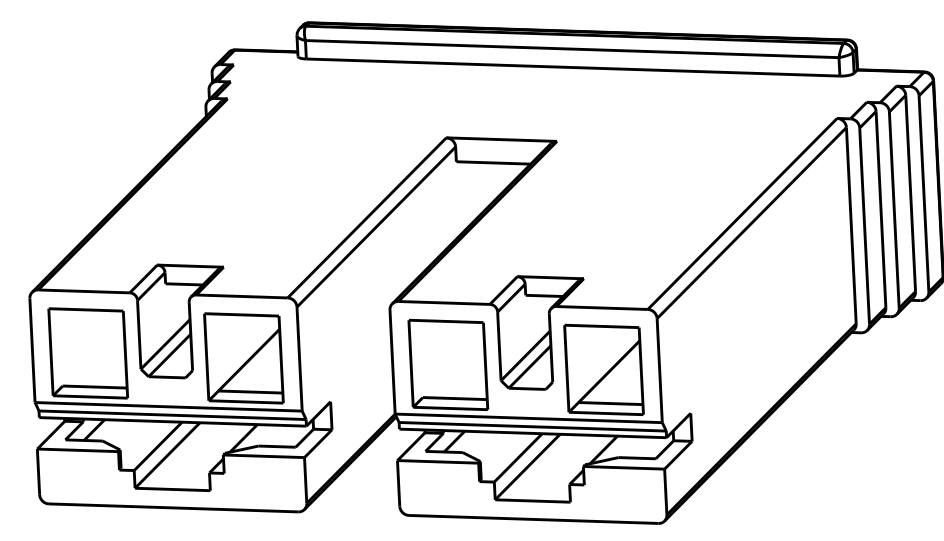

LOC		DIST		REVISIONS			
P	LTR	DESCRIPTION		DATE	DWN	APVD	
	A5	REVISED PER ECO-18-010548		05JUL2018	RS	DS	

- 1 FOR USE WITH MKII POSITIVE LOCK, LOW INSERTION FORCE FASTON RECEPTACLES AND MOST BUDGET FASTON RECEPTACLES.
- △ PRELIMINARY - NOT FOR PRODUCTION

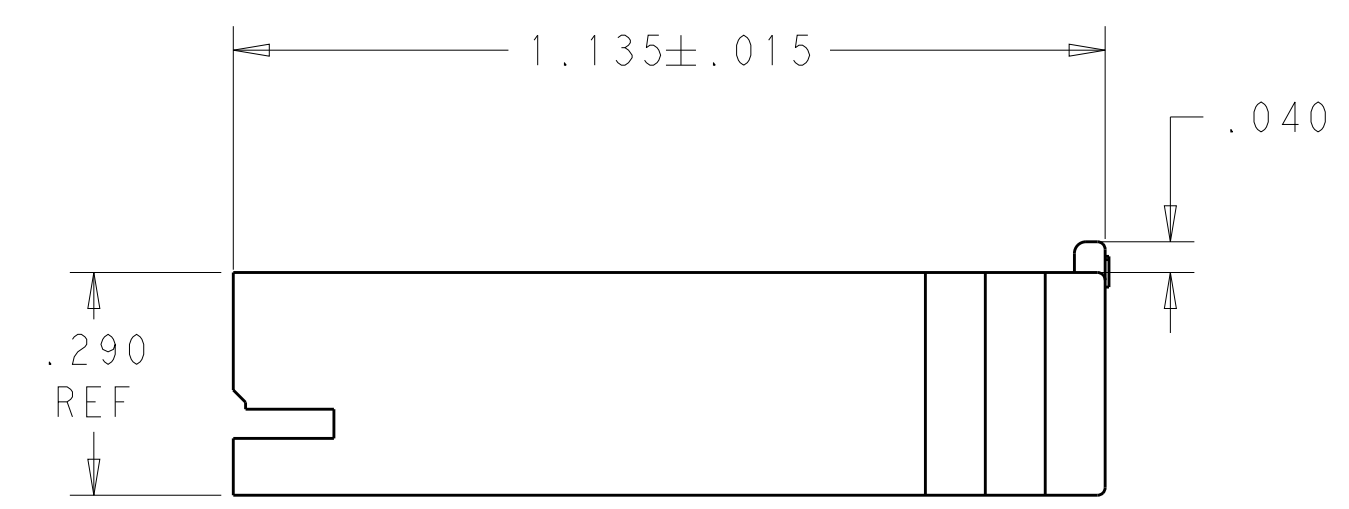

NATURAL	66 Nylon V0 Natural	1969332-3
NATURAL (WHITE)	66/6 NYLON V0	1969332-2
NATURAL (TRANSLUCENT)	6/6 NYLON V2	△ 1969332-1
COLOR	MATERIAL	PART NO.

THIS DRAWING IS A CONTROLLED DOCUMENT.		DWN JR RUTH 21OCT2009	TE Connectivity			
DIMENSIONS: INCHES		CHK GARY PORTA 21OCT2009				
		APVD GARY PORTA 21OCT2009	NAME HOUSING, RECPT, POSITIVE-LOCK AND STANDARD FASTON, .250 SERIES MKII			
		PRODUCT SPEC 108-5127	SIZE CAGE CODE DRAWING NO RESTRICTED TO			
MATERIAL SEE TABLE		APPLICATION SPEC 114-2074	A200779C-1969332			
		WEIGHT -	SCALE 8:1 SHEET 1 OF 1 REV A5			
		Customer Drawing				