

No OF POSITIONS
-02 THRU -25

-TR: TAPE & REEL
(AVAILABLE WITH -02 LEAD STYLE ONLY)
(MUST USE K-DOT-.177-.281-.005)
(SEE FIG 5, SHT 3)

-K: KEYED POLARIZATION
(USE IPL1-XX-S-K)
(SEE FIG 4, SHEET 3)

-RA: RIGHT ANGLE (SEE FIG 3, SHT 3)
(AVAILABLE WITH -01 LEAD STYLE ONLY)

-S: SINGLE (USE IPL1-XX-S)

-STL: LIGHT SELECTIVE TIN/LEAD (USE T-1S64-XX-STL)

IPL1-106-01-XXX-S SHOWN

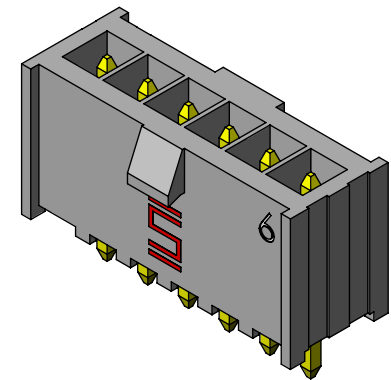
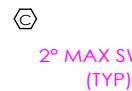



TABLE 1				
LEAD STYLE	OPTION	TERMINAL 1	OAL REF	-TR
-01	NONE	T-1S64-07-XX	.430[10.92]	N/A
-01	-RA	T-1S64-19-XX	.545[13.84]	N/A
-02	NONE	T-1S64-08-XX	.445[11.30]	K-DOT-.177-.281-.005

1.  REPRESENTS A CRITICAL DIMENSION.
2. MINIMUM TERMINAL RETENTION: 1 LB [4.45 N].
3. PARTS TO BE MOLDED TO POSITION.
4. POST MUST BE WITHIN .005[0.13] OF EACH OTHER.
5. ALL PIN TO PIN DIMENSIONS TO BE MEASURED FROM TIP TO TIP.
6. DIMENSION TO BE MEASURED AT BEND.
7. TIP TO BE FLUSH TO .015[0.38] BELOW TOP OF SHROUD.
8. NOTE DELETED.
9. PACKAGE ALL POSITIONS.

PROPRIETARY NOTE

THIS DOCUMENT CONTAINS CONFIDENTIAL AND PROPRIETARY INFORMATION AND ALL DESIGN, MANUFACTURING, REPRODUCTION, USE, PATENT RIGHTS AND SALES RIGHTS ARE EXPRESSLY RESERVED BY SAMTEC, INC. THIS DOCUMENT SHALL NOT BE DISCLOSED, IN WHOLE OR PART, TO ANY UNAUTHORIZED PERSON OR ENTITY NOR REPRODUCED, TRANSFERRED OR INCORPORATED IN ANY OTHER PROJECT IN ANY MANNER WITHOUT THE EXPRESS WRITTEN CONSENT OF SAMTEC, INC.



520 PARK EAST BLVD, NEW ALBANY, IN 47150
PHONE: 812-944-6733 FAX: 812-948-5047
e-Mail info@SAMTEC.com code 55322

MATERIAL: DO NOT SCALE DRAWING SHEET SCALE: 3:1

STANDARD INSULATOR: LCP UL94-V0, COLOR: BLACK
-K INSULATOR: LCP UL94-V0, COLOR: NATURAL
TERMINAL: PHOS BRONZE

DESCRIPTION:	.100[2.54] SINGLE ROW TERMINAL ASSEMBLY
--------------	---

DWG. NO.
IPL1-1XX-XX-XXX-S-XX-X-XX

BY: D PURVIS	05/02/2005	SHEET 1 OF 3
--------------	------------	--------------

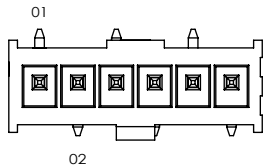

FIG 2
STYLE -02: SURFACE MOUNT
IPL1-106-02-XXX-S SHOWN
[DIFFERENT AS SHOWN, OTHERWISE SAME AS FIG 1]

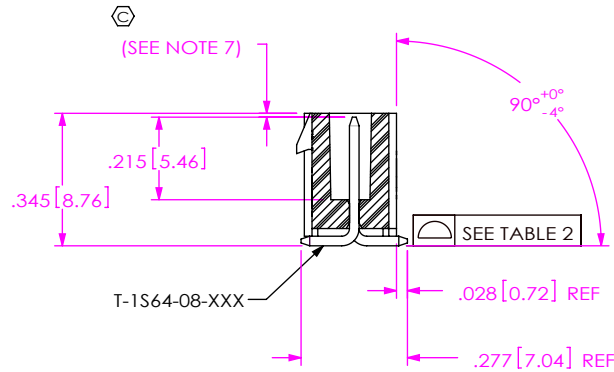
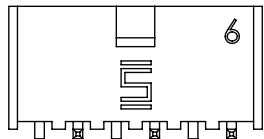
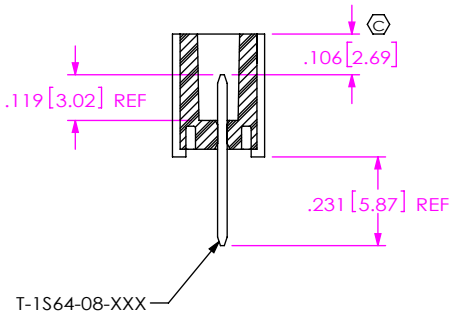
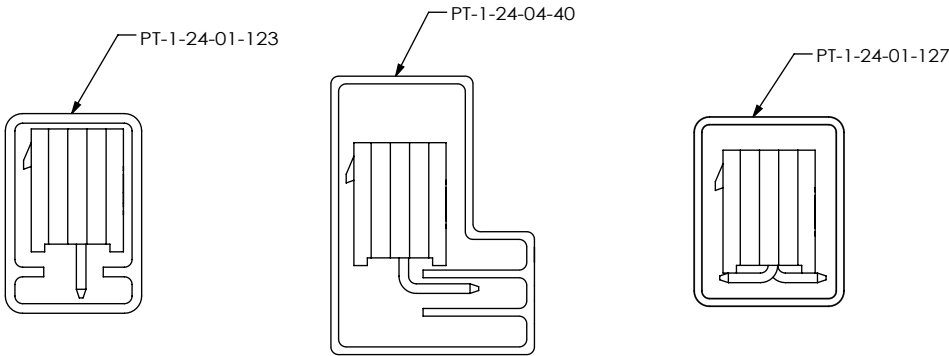

TABLE 2	
No OF POS.	COPLANARITY
-02 THRU -05	.004[0.10]
-06 THRU -10	.005[0.13]

-02: SURFACE MOUNT IN-PROCESS 1



PACKAGING VIEWS
(PARTS TO HAVE POSITION #1 LOADED
IN SAME DIRECTION AS ARROW ON TUBE)



PACKAGING TABLE			
LEAD STYLE	OPTION	PACKAGING TUBE	PLUG
-01	NONE	PT-1-24-01-123	TP-09
-01	-RA	PT-1-24-04-40	TP-07
-02	NONE	PT-1-24-01-127	TP-07

-02: SURFACE MOUNT IN-PROCESS 2

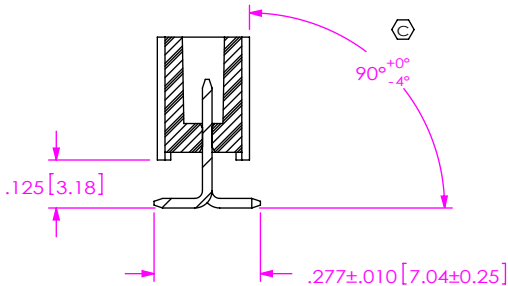

F:\DWG\MISC\MKTG\IPL1-1XX-XX-XXX-S-XX-X-XX-MKT.SLDDRW

PROPRIETARY NOTE
THIS DOCUMENT CONTAINS CONFIDENTIAL AND PROPRIETARY INFORMATION AND ALL DESIGN, MANUFACTURING, REPRODUCTION, USE, PATENT RIGHTS AND SALES RIGHTS ARE EXPRESSLY RESERVED BY SAMTEC, INC. THIS DOCUMENT SHALL NOT BE DISCLOSED, IN WHOLE OR PART, TO ANY UNAUTHORIZED PERSON OR ENTITY NOR REPRODUCED, TRANSFERRED OR INCORPORATED IN ANY OTHER PROJECT IN ANY MANNER WITHOUT THE EXPRESS WRITTEN CONSENT OF SAMTEC, INC.

DO NOT SCALE DRAWING

SHEET SCALE: 2:1



520 PARK EAST BLVD, NEW ALBANY, IN 47150
PHONE: 812-944-6733 FAX: 812-948-5047
e-Mail info@SAMTEC.com code 55322

DESCRIPTION:
.100[2.54] SINGLE ROW TERMINAL ASSEMBLY

DWG. NO.
IPL1-1XX-XX-XXX-S-XX-X-XX

BY: D PURVIS 05/02/2005 SHEET 2 OF 3

-RA: IN-PROCESS 1

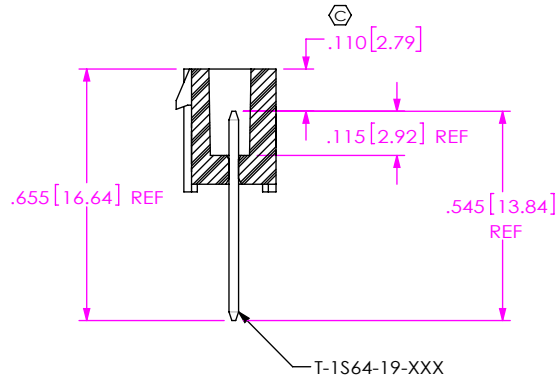

-RA: IN-PROCESS 2

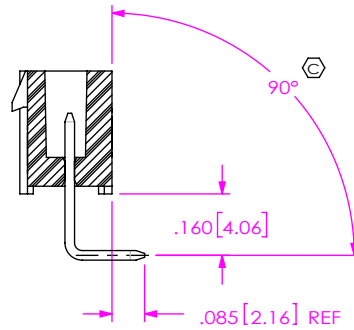

FIG 4

-K: KEYED POLARIZATION
(IPL1-106-01-XXX-S-K SHOWN)
(SAME AS FIG 1 UNLESS OTHERWISE STATED)

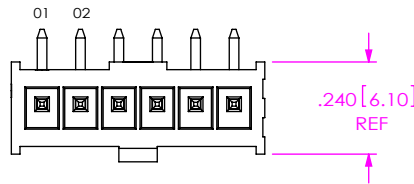
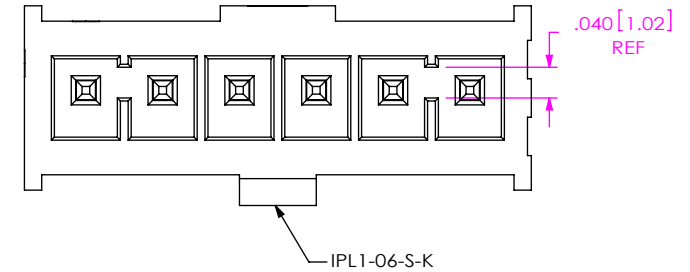
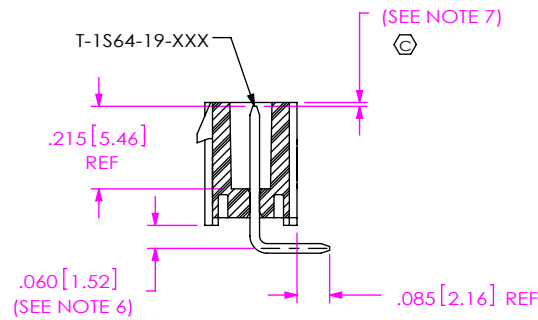
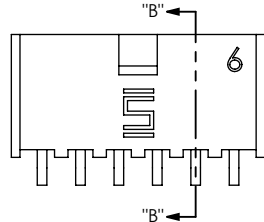

FIG 3

-RA: RIGHT ANGLE
IPL1-106-01-XXX-S-RA SHOWN
[DIFFERENT AS SHOWN, OTHERWISE SAME AS FIG 1]



SECTION "B"-"B"

FIG 5

(IPL1-106-02-XXX-S-TR SHOWN)
(MUST USE K-DOT-177-281-.005)
(SAME AS FIG 2, UNLESS OTHERWISE STATED)

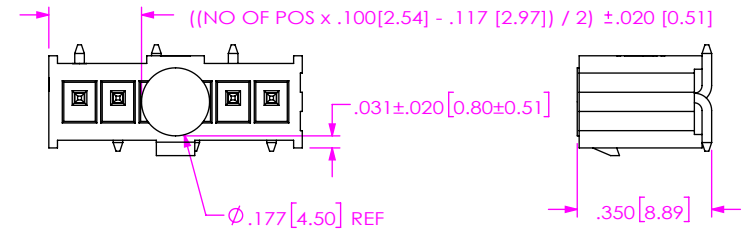

PROPRIETARY NOTE
THIS DOCUMENT CONTAINS CONFIDENTIAL AND PROPRIETARY INFORMATION AND ALL DESIGN, MANUFACTURING, REPRODUCTION, USE, PATENT RIGHTS AND SALES RIGHTS ARE EXPRESSLY RESERVED BY SAMTEC, INC. THIS DOCUMENT SHALL NOT BE DISCLOSED, IN WHOLE OR PART, TO ANY UNAUTHORIZED PERSON OR ENTITY NOR REPRODUCED, TRANSFERRED OR INCORPORATED IN ANY OTHER PROJECT IN ANY MANNER WITHOUT THE EXPRESS WRITTEN CONSENT OF SAMTEC, INC.

DO NOT SCALE DRAWING

SHEET SCALE: 2:1

samtec

520 PARK EAST BLVD, NEW ALBANY, IN 47150
PHONE: 812-944-6733 FAX: 812-948-5047
e-Mail: info@SAMTEC.com code 55322

DESCRIPTION:
.100 [2.54] SINGLE ROW TERMINAL ASSEMBLY

DWG. NO.
IPL1-1XX-XX-XXX-S-XX-X-XX

BY: D PURVIS 05/02/2005 SHEET 3 OF 3