

## Non-Insulated Terminals

### Non-Insulated Ring

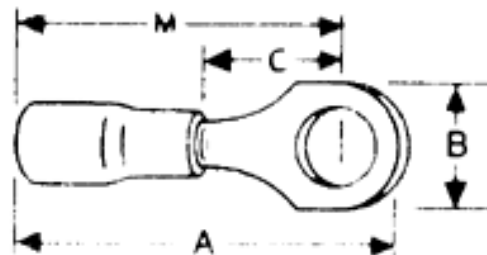

These non-insulated ring terminals are made of electrolytic copper for high conductivity. They can be installed with crimping tools having a single indenter or double indenter (recommended for solid wire). Serrated barrel increases grip on wire. Wire range identification is stamped on the tongue of each terminal.

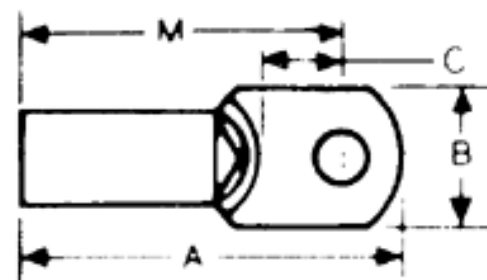

These non-insulated ring terminals are made of electrolytic copper for high conductivity. They can be installed with crimping tools having a single indenter or double indenter (recommended for solid wire). Serrated barrel increases grip on wire. Wire range identification is stamped on the tongue of each terminal.

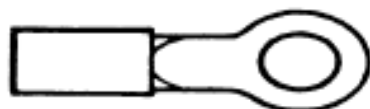

\* Brazed Seam, Lolly-Pop Style Tongue

### Dimension Information In F.P.S (U.S)

Catalog No	Dim A (In.)	Dim B (In.)	Dim C (In.)	Dim M (In.)	Insulation Type	Plating	Stock Thickness (In.)	Tongue Shape	Bolt Hole
<b>G2-38</b>	1.590	0.690	0.400	1.260	Non Insulated	Tin Plated	0.050	Ring Connector	3/8

AN-Aircraft Wire

Note: Not available on Mylar Tape.

**Most standard bulk catalog numbers can be put on Mylar Tape for reel fed applications (i.e. 12050 tool and application dies).**

**Please put the suffix M for Mylar Tape RA2573M. (Bulk number 1000 and 500 packages.)**

## Packaging Information

Catalog#	Unit Quantity	Standard Quantity Package	Bulk Catalog#	Unit Quantity Bulk	Bulk Package Quantity	Weight (lbs.)	Weight UOM
<b>G2-38</b>	10	100	<b>G973</b>	100	1000	3.350	Per 100

## Listed / Certified By



**UL Listed**

(Catalog# G2-38 )  
(File# 9809 )



**CSA Certified**

(Catalog# G2-38 )  
(File# 4503,7222 )

*All materials are subject to change without notice. Copyright © 2000 Thomas and Betts Corporation. All rights reserved.*