

DC Connector, Plug, 5.5x2.5 mm, 2-pole, solder terminal, lockable



Description

- Solder terminal:
for cable mounting
- Low Voltage DC Plug and Socket
- DC Plug: 2-pole, straight

Weblinks

[pdf-datasheet](#), [html-datasheet](#), [General Product Information](#), [RoHS](#), [CHINA-RoHS](#), [REACH](#), [Mating Connectors](#), [e-Shop](#), [SCHURTER-Stock-Check](#), [Distributor-Stock-Check](#)

Technical Data

Diameter	5.5 mm / 2.5 mm
Number of Poles	2-pole
Ratings DC	0.5 A / 12 VDC
Dielectric Strength	500 VDC
Insulation Resistance	> 100 MΩ @ 500 VDC

Allowable Operation Temp.	-20 °C to 70 °C
Terminal	solder terminal nickel-plated lockable
Style	straight
Lifetime	5000 Insertions

Dimensions

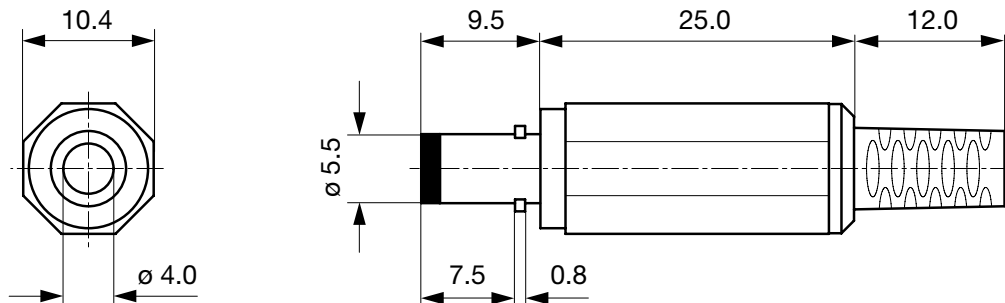

Cable diameter max. 4.0 mm

All Variants

Product group	Diameter [mm]	Number of Poles	Terminal	Order Number
DC Plug/Socket	5.5	2-pole	solder terminal	4840.1211

Availability for all products can be searched real-time: <http://www.schurter.com/en/Stock-Check/Stock-Check-SCHURTER>

Packaging unit 100 Pcs

Mating Outlets/Connectors

Category / Description



[DC Plug/Socket Overview complete](#)

4840, PCB terminals, , Socket, 5.7 mm, 2-pole, DC Plug/Socket

[4840.2212](#)

[DC Plug/Socket further types to 4840 DC-Stecker, verschiedene](#)