

NOTES

MATERIAL - 0.040" THICK ALUMINUM  
- #6 x 1/4" SELF TAPPING SCREWS

\*\* 1411R - FINISHED ASA 61 GREY  
1411RU - UNFINISHED

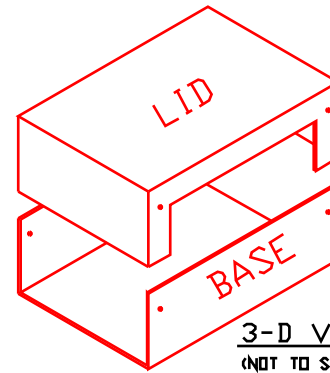

3-D VIEW  
(NOT TO SCALE)

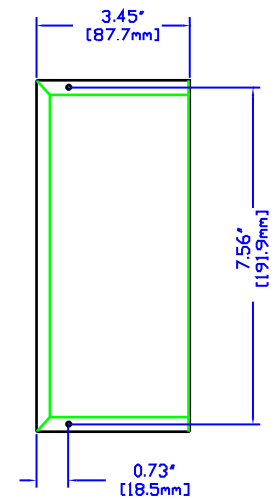
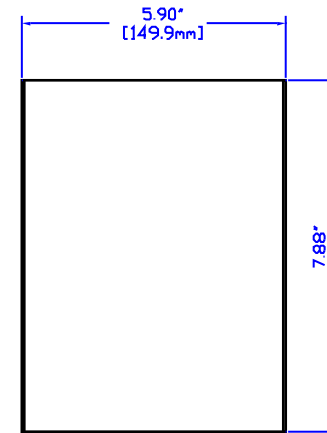
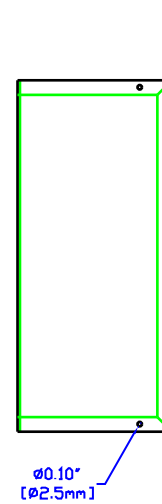
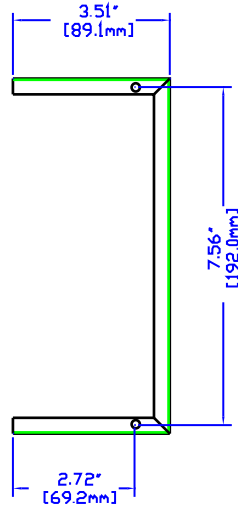
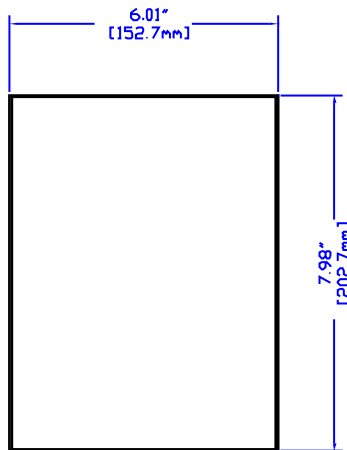
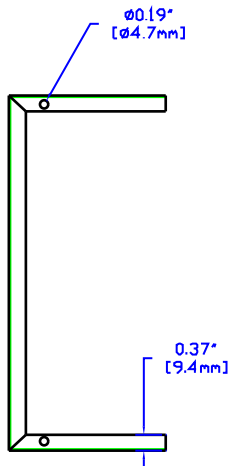

VIEW OF BASE (INSIDE)

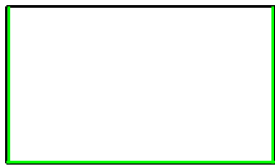

VIEW OF LID (INSIDE)



HAMMOND MANUFACTURING

1411R-Handy Case

website: [www.hammondmfg.com](http://www.hammondmfg.com)