

THA-244 Projection Handle Latch THA-263 Cam

PAT.No.881513
PAT.No.2070392

Pop-Out and Press-In Handle



Characteristic

1. The surfaces of handle and the flange become flat while the handle is at locked position to make the box with better appearance.
2. Crime prevention and safety are obtained since extrusion on the front surface of the box is small.
3. The keyhole is covered by a shutter to have better dustproof.
Also the reversible type key is used to have better operability.

Application

Distribution boards / Distribution panels / Machine tools / Various types of boxes, etc

Specification

1. By inserting and turning the key 45 degree between point A and B, the handle shall be popped-up approximately 18mm. Then the handle can be turned clockwise 90 degree.
2. The handle can be retracted at only A-point by just pressing on it. No key is need.
3. The key No. is all the same for products in stock. 50 Different keys are available for custom made products.
4. The cam, THA-263, is sold separately.

Parts List

No.	Part Name	Material	Finish	Quantity
1	Flange	ZDC	See another list	1
2	Handle		Satellite Chromium	1
3	Joint		Ni	1
4	Latch Piece			1
5	Latch Spring	SUS304	—	1
6	Lock Retainer	BSBM	—	1
7	Spring	SUS304	—	1
8	Nut	ZDC	Zn	1
9	Lock	SUS304/ZDC	/Zn	1
10	Key	BSP	Ni	2
11	Countersunk Screw	S	Zn	1
12	C-Shaped Snap Ring	SUS	—	1
13	Hexagon Bolt	S	Zn	1
14	Spring Washer			1
15	Flat Washer			1
16	Packing	CR	Black	1
17	Square Hole Washer	S	Zn	2

Model No.	Key No.	Finish of Flange	Net Weight (g)	Code No.	
THA-244-1	No.244	Satellite Chromium	370	3159	
THA-244-2		Black Paint		3160	

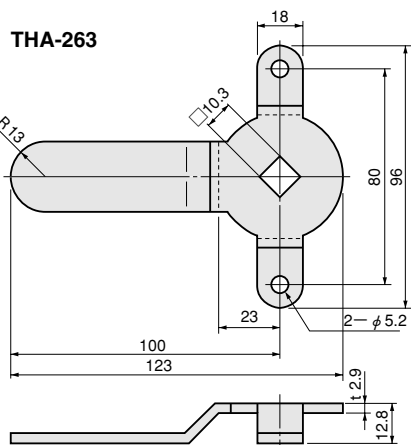

THA-263

Model No.	Material	Finish	Code No.	
THA-263	SPCC	Zn	3722	

