

**Ordering number C11793\_ANNA-40-4-S**

Family	Anna-40-4	FWHM	12 degrees
Type	Lens array	Efficiency	93 %
LED	XP-E	cd/Im	12.700
Color	Clear	Gerber File	Available
Diameter	40 mm		
Height	10.7 mm		
Style	Round		
Optic Material	PMMA		
Holder Material	-		
Fastening	Pin, glue		
Status	Ready		

**Ordering number C11794\_ANNA-40-4-M**

Family	Anna-40-4	FWHM	19 degrees
Type	Lens array	Efficiency	91 %
LED	XP-E	cd/Im	5.200
Color	Clear	Gerber File	Available
Diameter	40 mm		
Height	10.7 mm		
Style	Round		
Optic Material	PMMA		
Holder Material	-		
Fastening	Pin, glue		
Status	Ready		

**Ordering number C11795\_ANNA-40-4-W**

Family	Anna-40-4	FWHM	36 degrees
Type	Lens array	Efficiency	87 %
LED	XP-E	cd/Im	1.600
Color	Clear	Gerber File	Available
Diameter	40 mm		
Height	10.7 mm		
Style	Round		
Optic Material	PMMA		
Holder Material	-		
Fastening	Pin, glue		
Status	Ready		

**NOTE: The typical divergence will be changed by different color, chip size and chip position tolerance. The typical total divergence is the full angle measured where the luminous intensity is half of the peak value.**



# PRODUCT DATASHEET

## Anna-40-4 series

last update 27/3/2012

### GENERAL INFORMATION

- Product series especially designed & optimized for XP-E series of LEDs.
- Special care taken to make light distribution as uniform as possible.
- Lens material optical grade PMMA with high UV and temperature resistance. Allows use of high current and temperature conditions.

Please find more information about used material from below:

[http://ledil.fi/sites/default/files/Documents/Technical/Material/PMMA%20N%20UL94\\_Yellow%20Card.pdf](http://ledil.fi/sites/default/files/Documents/Technical/Material/PMMA%20N%20UL94_Yellow%20Card.pdf)

<http://ledil.fi/sites/default/files/Documents/Technical/Material/PMMA%20N%20PLEXIGLAS-Datasheet.pdf>

D

C

B

A

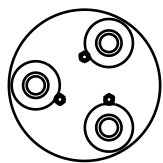
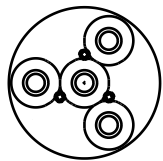
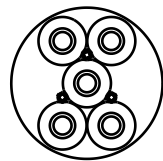
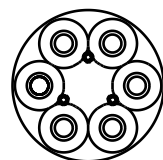
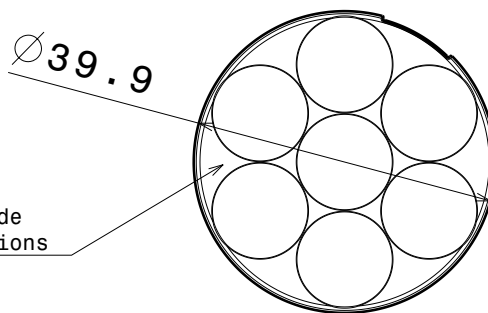
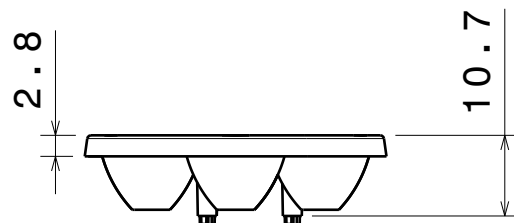
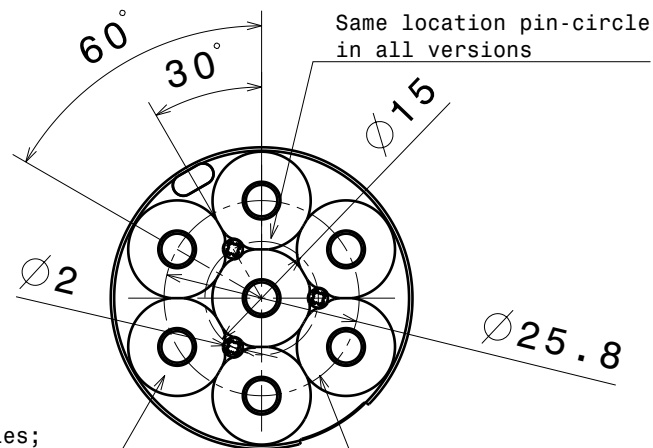
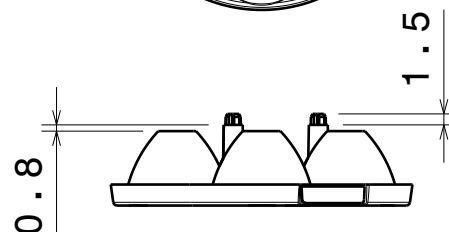
Anna-3Anna-4Anna-5Anna-6Anna-7

Number of cones varies;  
3, 4, 5, 6 and 7pcs  
on bottom side depending  
the version.

Same led-circle  
in all versions

Material: PMMA

Versions:

Anna-3-S  
Anna-3-M  
Anna-3-W  
Anna-4-S  
Anna-4-M  
Anna-4-W  
Anna-5-S  
Anna-5-M  
Anna-5-W  
Anna-6-S  
Anna-6-M  
Anna-6-W  
Anna-7-S  
Anna-7-M  
Anna-7-W

This drawing is our property.  
It can't be reproduced  
or communicated without  
our written agreement.

LEDIL

L  
T  
F  
F

e  
e  
i  
i

N  
n

d  
h

DRAWING TITLE

Datasheet Anna40-series Lens

DRAWN BY

p

DATE

12.10.2010

CHECKED BY

s

n

DATE

12.10.2010

DESIGNED BY

hh

DATE

30.07.2010

SIZE

A4

DRAWING NUMBER

-

REV

1

SCALE

1:1

WEIGHT (g)

SHEET

1/1

D

A