



ALL RIGHTS RESERVED. NO PORTION OF THIS PUBLICATION, WHETHER IN WHOLE OR IN PART CAN BE REPRODUCED WITHOUT THE EXPRESS WRITTEN CONSENT OF SPC TECHNOLOGY.

SPC-F005.DWG

REVISIONS

DOC. NO. SPC-F005 * Effective: 7/8/02 * DCP No: 1398

DCP #	REV	DESCRIPTION	DRAWN	DATE	CHECKD	DATE	APPRVD	DATE
366	A	RELEASED	JWM	3/20/02	HO	3/20/03	JC	3/20/03
1855	B	Drawing Corrected	JWM	9/27/05	JC	9/27/05	JC	9/27/05

Electrical Characteristics

Impedance: 50 Ohm nominal

Working Voltage: 500 Volts, RMS at sea level

Frequency Range: 0~4GHz

Contact Resistance: Outer - 0.2 milliohms max.

Center - 2.1 milliohms max.

Insulation Resistance: 5000 megohms minimum

Dielectric Withstanding Voltage: 1500 volts, RMS at sea level

Corona Level: 375 Volts minimum at 70,000 feet

Environmental Characteristics

Recommended Temp. Range: -55°C to 85°C

Moisture Resistance: MIL-STD 202

Mechanical Characteristics

Durability: 500 Cycles

Force to Engage/Disengage: 3 lbs maximum

Materials

Body: Zinc or brass

Contact: Brass, beryllium copper or phosphor bronze

Spring Washer: Beryllium Copper

Insulator: Delrin or TPX Polymethylpentene

Plating: Body - Nickel

Contact - Nickel/Gold

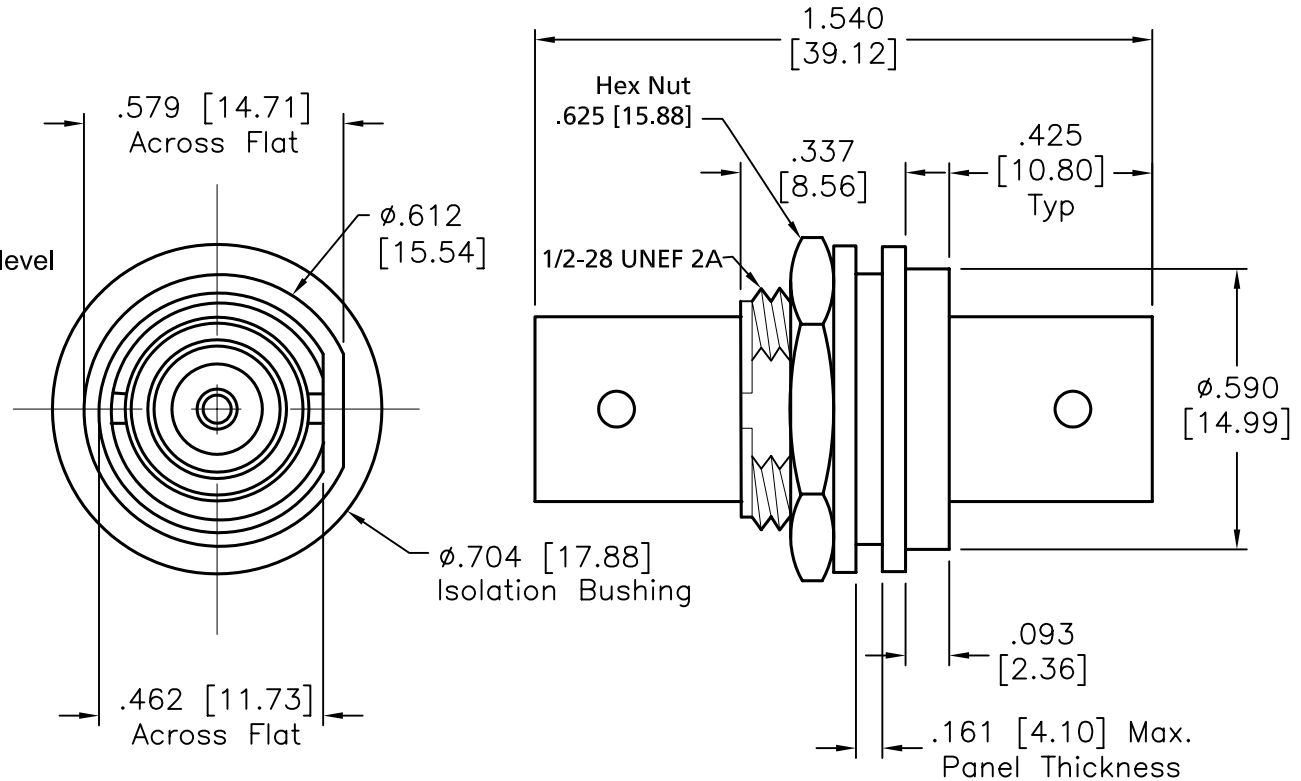

DISCLAIMER:
ALL STATEMENTS AND TECHNICAL INFORMATION CONTAINED HEREIN ARE BASED UPON INFORMATION AND/OR TESTS WE BELIEVE TO BE ACCURATE AND RELIABLE. SINCE CONDITIONS OF USE ARE BEYOND OUR CONTROL, THE USER SHALL DETERMINE THE SUITABILITY OF THE PRODUCT FOR THE INTENDED USE AND ASSUME ALL RISK AND LIABILITY WHATSOEVER IN CONNECTION THEREWITH.

TOLERANCES:

UNLESS OTHERWISE SPECIFIED, DIMENSIONS ARE FOR REFERENCE PURPOSES ONLY.

DRAWN BY:

Jeff McVicker

DATE:

3/20/03

CHECKED BY:

Hisham Odish

DATE:

3/20/03

APPROVED BY:

John Cole

DATE:

3/20/03

DRAWING TITLE:

BNC Jack to Jack Bulkhead Adapter w/Isolation Washers

SIZE

A

DWG. NO.

1578

ELECTRONIC FILE

92N3402.dwg

REV

B

SCALE: NTS

U.O.M.: INCHES [mm]

SHEET: 1 OF 1