

Inch-size One-touch Fittings

Series KQ2

Applicable Tubing: Inch Size
Connection Thread: M, R, Rc

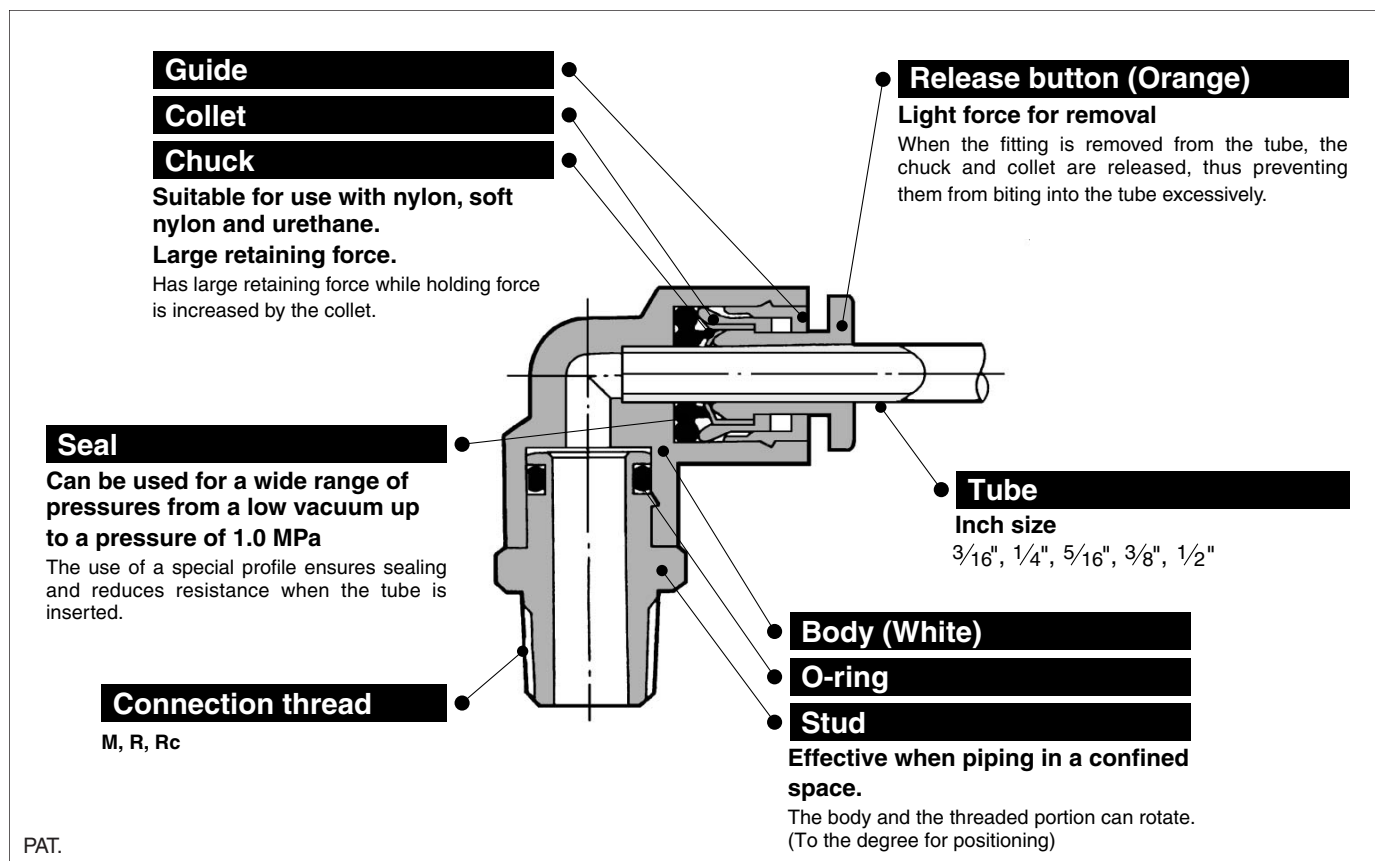

Applicable Tubing

Tubing material	Nylon, Soft nylon, Polyurethane
Tubing O.D. (inch)	ø3/16, ø1/4, ø5/16, ø3/8, ø1/2

Specifications

Fluid	Air/Water ^{Note)}	
Maximum operating pressure	1.0 MPa	
Proof pressure	3.0 MPa	
Ambient and fluid temperature	-5 to 60°C (Water: 0 to 40°C) (No freezing)	
Thread	Mounting section	JIS B 0203 (Taper thread for piping)
	Nut section	JIS B 0211, Class 2 (Metric fine thread)
Thread seal	With seal	

 Note) Applicable for general industrial water. Please consult with SMC if using for other kinds of fluid.
Also, the surge pressure must be under the maximum operating pressure.

Principal Parts Material

Body	C3604BD, PBT, PP
Stud	C3604BD (Thread portion)
Chuck	Stainless steel 304
Guide	Stainless steel 304, C3604BD, POM
Collet	POM
Release button	POM
Seal, O-ring	NBR
Gasket	Stainless steel 304, NBR

Series KQ2

Male Connector: KQ2H

KQ2H01-M5
KQ2H07-M5



<KQ2H05-M5>



<R>



Applicable tubing O.D. (inch)	Connection thread M R	Model	H (Width across flats)	Note) øD	L	A *	M	Min. port size	Weight (g)
1/8	M5 x 0.8	KQ2H01-M5	7	—	16.7	13.6	12.7	2.5	2
	1/8	KQ2H01-01S	10	—	22	18	15.5		9
	1/4	KQ2H01-02S	14	—	19.5	13.5	—		16
3/16	M5 x 0.8	KQ2H05-M5	10.7	—	24	20.5	—	2.5	6
	1/8	KQ2H05-01S	11	—	22	18	—	3.5	11
	1/4	KQ2H05-02S	14	—	21	15	—	—	12
1/4	M5 x 0.8	KQ2H07-M5	11	10.3	18.4	15.3	13.6	2.5	3.3
	1/8	KQ2H07-01S	—	—	22.5	18.5	—	4.6	10
	1/4	KQ2H07-02S	14	—	23	17	—		15
	3/8	KQ2H07-03S	17	—	23	16.5	—		27
5/16	1/8	KQ2H09-01S	14	—	28	24	—	6	15
	1/4	KQ2H09-02S	—	—	26.5	20.5	18.5		16
	3/8	KQ2H09-03S	17	—	22.5	15.5	—		24
3/8	1/4	KQ2H11-02S	17	—	33.5	27.5	—	7	31
	3/8	KQ2H11-03S	17	—	29	22.5	21		29
	1/2	KQ2H11-04S	22	—	27	19	—		46
1/2	1/4	KQ2H13-02S	—	—	34.5	28.5	—	9	—
	3/8	KQ2H13-03S	—	—	33.5	27	22	9.6	44
	1/2	KQ2H13-04S	—	—	30	22	—		—



* Reference dimensions after R thread installation.
Note) øD: Max. diameter

KQ2H01-M5
<KQ2H07-M5>

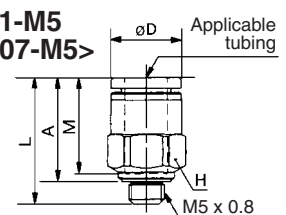

<KQ2H05>

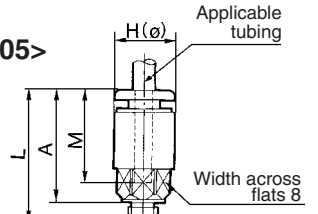

<R>

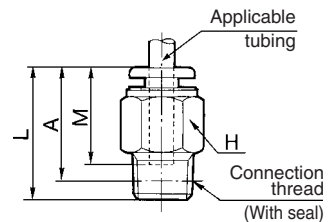

Straight Union: KQ2H



Applicable tubing O.D. (inch)	Model	Note) øD	L	M	Min. port size	Weight (g)
3/16	KQ2H05-00	11.4	34	16.5	3.5	4
1/4	KQ2H07-00	13.2	34.5	17	4.6	4
5/16	KQ2H09-00	15.2	38.5	18.5	6	6
3/8	KQ2H11-00	17.9	42.5	21	7	11
1/2	KQ2H13-00	21.7	44.5	22	9.6	16



Note) øD: Max. diameter

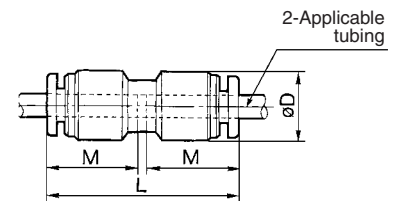

Male Elbow: KQ2L



Applicable tubing O.D. (inch)	Connection thread R	Model	H (Width across flats)	Note) øD1	øD2	L1	L2	A *	M	Min. port size	Weight (g)
1/8	M5 x 0.8	KQ2L01-M5	7	8.4	—	15.3	13.2	14.3	12.7	2.3	2.5
3/16	1/8	KQ2L05-01S	10	11.4	10	19.5	22.5	24	16.5	3.5	10
	1/4	KQ2L05-02S	14								
1/4	M5 x 0.8	KQ2L07-M5	7	13.2	10	20.5	15.1	18	13.6	2.3	3.2
	1/8	KQ2L07-01S	10								
	1/4	KQ2L07-02S	14								
	3/8	KQ2L07-03S	17								
5/16	1/8	KQ2L09-01S	12	15.2	12	23.5	24.5	28	18.5	6	20
	1/4	KQ2L09-02S	14								
	3/8	KQ2L09-03S	17								
3/8	1/4	KQ2L11-02S	17	17.9	17	25.5	29.5	32.5	21	7	33
	3/8	KQ2L11-03S	17								
	1/2	KQ2L11-04S	22								
1/2	1/4	KQ2L13-02S	17	21.7	17	28	31.5	36.5	22	9	28
	3/8	KQ2L13-03S	17								
	1/2	KQ2L13-04S	22				37.5	40		9.6	62



* Reference dimensions after R thread installation.
Note) øD1: Max. diameter

<M5>

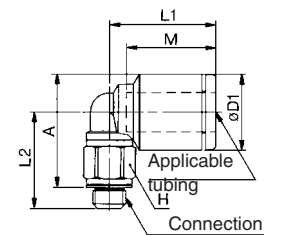

<R>

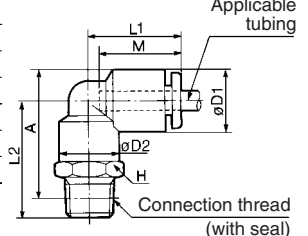

Union Elbow: KQ2L



Applicable tubing O.D. (inch)	Model	Note) øD	L	Q	M	Min. port size	Weight (g)
3/16	KQ2L05-00	11.4	19.5	4.8	16.5	3.5	5
1/4	KQ2L07-00	13.2	20.5	5.3	17	4.6	5
5/16	KQ2L09-00	15.2	23	6	18.5	6	7
3/8	KQ2L11-00	17.9	26	6.6	21	7	13
1/2	KQ2L13-00	21.7	29	7.8	22	9.6	18



Note) øD: Max. diameter

