

**Features:**

- Universal AC input/ Full range
- Wide Operating Ambient Temperature (-20°C~60°C)
- High Efficiency, and High Reliability
- Ultra-minature size, low profile
- Output Protections: OLP/OVP/SCP
- All using 105°C long life electrolytic capacitors.
- 100% full load burn-in test



Model		QPS-20-5	QPS-20-12	QPS-20-15	QPS-20-24	QPS-20-48
Output Characteristics						
DC Output		5V	12V	15V	24V	48V
Rated Current		4A	1.67A	1.34A	0.84A	0.42A
Current Range		0~4A	0~1.67A	0~1.34A	0~0.84A	0~0.42A
Ripple and Noise	0~50°C	50mV	120mV	100mV	100mV	100mV
	-10~0°C	75mV	120mV	100mV	100mV	100mV
Voltage ADJ. Range		±10% of rated output voltage				
Voltage Accuracy		±2.0%	±2.0%	±2.0%	±2.0%	±2.0%
Line Regulation		±0.5%	±0.5%	±0.5%	±0.5%	±0.5%
Load Regulation		±2.0%	±2.0%	±2.0%	±2.0%	±2.0%
Set-up Time		<2.0s (115VAC input, full load); <1.0s (230VAC input, full load)				
Hold-up Time		>10ms (115VAC input, full load); >20ms (230VAC input, full load)				
Temperature Coefficient		±0.03%/°C				
Overshoot and Undershoot		<5.0%				
Input Characteristics						
Voltage Range		85VAC~264VAC				
Frequency Range		47Hz-63Hz				
Efficiency (Typical)	115VAC Input	72%	78%	80%	78%	78%
	230VAC Input	72%	78%	80%	76%	78%
AC Current (max)		0.5A	0.5A	0.5A	0.5A	0.5A
Inrush Current (Typical)		20A@115VAC Cold start 40A@230VAC Cold start				
Leakage Current		Input-Output: <0.35mA Input-PG: <0.75mA				
Protection						
Over Load (OLP)		105%~150% of rated output power, hiccup mode, auto recover				
Over Voltage (OVP)		110%~140% of rated output voltage, constant voltage				
Short Circuit (SCP)		Long-term mode, auto recovery				
Environmental Characteristics						
Operating Amb. Temp. & Hum		-20°C~60°C; 20%~90% RH Non-Condensing				
Storage Temp. & Hum		-40°C~85°C: 10%-95% RH Non-Condensing				
Safety Standards		UL60950-1; EN60950-1: 2006				
Withstand Voltage		Primary-Secondary: 3.0KVAC;≤10mA. Primary-PG: 1.5KVAC;≤10mA. Secondary-PG: 0.5KVDC;≤10mA				
Isolation Resistance		≥100M ohms				
EMI Conduction & Radiation		Compliance to EN55022(CISPR22) Class B				
Harmonic Current		Compliance to EN61000-3-2, 17625.1-2003				
EMS Immunity		Compliance to EN61000-4-2, 3, 4, 5, 6, 8, 11; ENV50204, light industry level, criteria A				
General Characteristics						
MTBF (MIL-HDBK-217F)		More than 100,000Hrs (25°C, Full load)				
Dimension (LxWxH)		89x51x20mm				
Packing		60PCS/CTN. G.W: 7.6kgs				
Cooling Method		Cooling by free air convection				

**MECHANICAL SPECIFICATIONS**

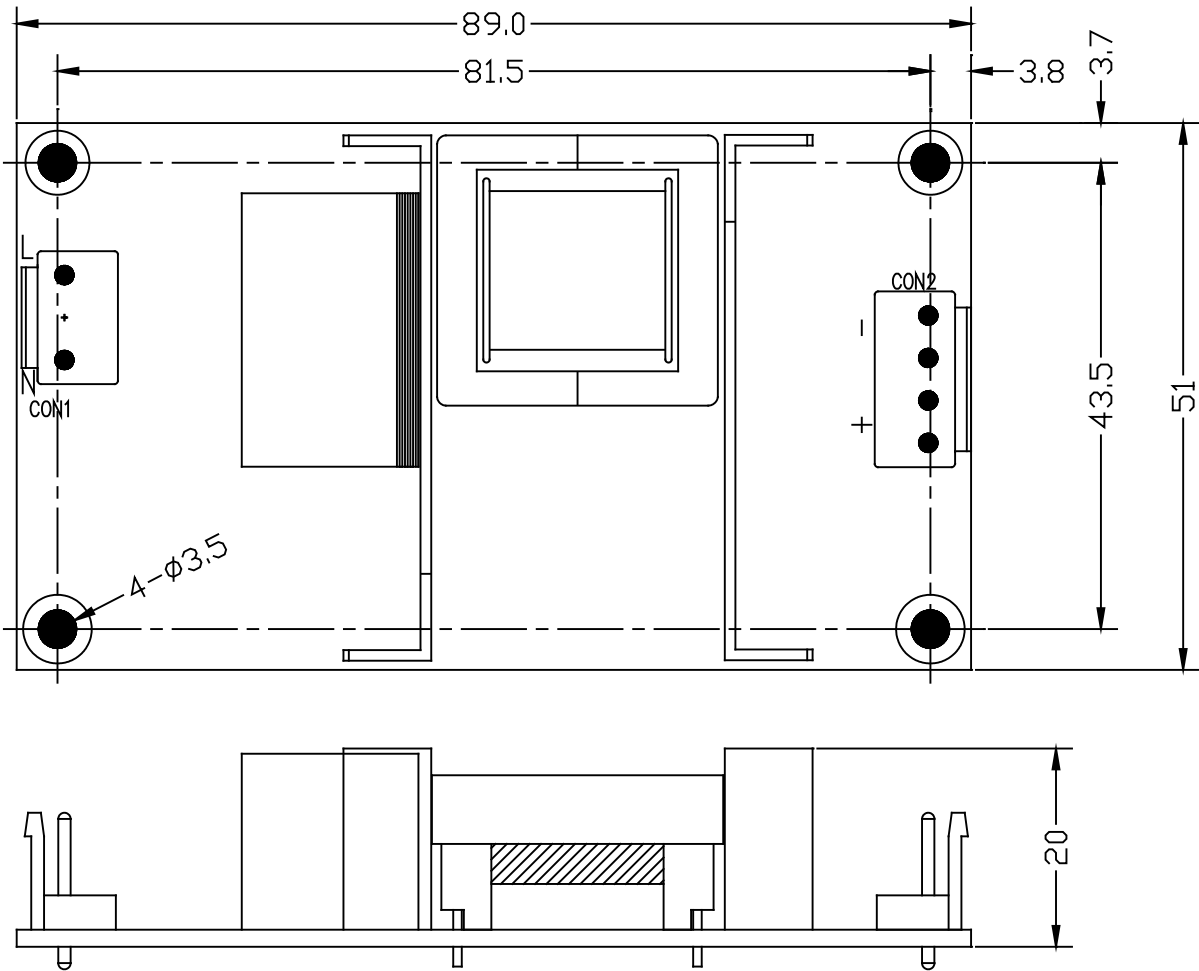

ITEM	CONNECTOR	MATING HOUSING	TERMINAL
AC IN (CON1)	LANDWIN 3961P0300T (CENTER PIN REMOVED)	LANDWIN 3960S OR JST VHR	LANDWIN 3963T011R OR JST SVH-21T-P1.1
DC OUT (CON2)	LANDWIN 3961P0400T		

UNIT: mm