

THIS DRAWING AND THE INFORMATION SET FORTH HERE-ON ARE THE PROPERTY OF TYCO ELECTRONICS CORPORATION, AND ARE TO BE HELD IN TRUST AND CONFIDENCE. PUBLICATION, DUPLICATION, DISCLOSURE, OR USE FOR ANY PURPOSE NOT EXPRESSLY AUTHORIZED IN WRITING BY TYCO ELECTRONICS CORPORATION IS PROHIBITED.

REVISIONS			
LTR	DESCRIPTION	DATE	APPROVED
1	PRE PRODUCTION RELEASE ECN T-4500	11/22/83	J.B.
A	PER ECO-09-025648	Nov/16/09	M.HIGGY

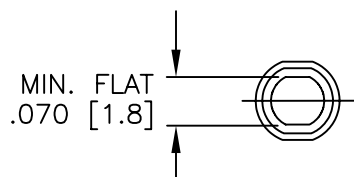

ø.080 MIN. [2.0]

.580 [14.7]
MAX.

MELTABLE INSERT
(WIRE END) (BLUE)

SOLDER PREFORM
(WITH FLUX)

INSULATION SLEEVE

MELTABLE INSERT
(WAFER CONNECTOR
END) (BLUE)

RED
COLOR CODE

ø .070 [1.8] MIN.

NOTES:

1. MATERIALS:

- A. INSULATION SLEEVE: HEAT SHRINKABLE, RADIATION CROSSLINKED MODIFIED POLYVINYLIDENE FLUORIDE, TRANSPARENT BLUE.
- B. SOLDER PREFORM: SOLDER TYPE: Sn96
FLUX TYPE: RA
PER ANSI-J-STD-006.
- C. MELTABLE INSERTS: LOW OUTGASSING IMMERSION RESISTANT THERMOPLASTIC.
- D. CARRIER STRIP: ADHESIVE COATED HIGH TEMPERATURE TAPE.

- 2. THESE SLEEVES ARE DESIGNED TO ATTACH 20 THROUGH 26 GAGE TIN, NICKEL OR SILVER PLATED CONDUCTORS TO TERMINALS OF A TE MTC100 SERIES WAFER.

©2009 Tyco Electronics Corporation. All rights reserved.

CUSTOMER DRAWING

UNLESS OTHERWISE SPECIFIED DIMENSIONS ARE IN INCHES. METRIC DIMENSIONS ARE IN BRACKETS. DECIMALS .XXX ± .XX ± ANGLES .X ± WEIGHT:		DRAWN	Zsofia O.	Nov/10/09		Raychem Interconnect 300 Constitution Drive Menlo Park, CA 94025 U.S.A.	
		CHECKED					
		APPROVED	M. HIGGY	Nov/10/09			
		APPROVED					
		CAD NAME			TITLE		
		CTA-0065			SOLDERSLEEVE® WIRE TERMINATOR WITH OVAL ENTRY		
		THIRD ANGLE PROJECTION			TEMPERATURE RATING 150 CELSIUS DEGREE, Sn96		
					MTC100 SERIES		
		SIZE	B	CAGE CODE:	06090	REV	
		SCALE:	NONE	DWG. NO.	CTA-0065	A	
					SHEET 1 OF 1		

If this document is printed it becomes uncontrolled. Check for the latest revision

® Trademark of Tyco Electronics Corporation.

Mouser Electronics

Authorized Distributor

Click to View Pricing, Inventory, Delivery & Lifecycle Information:

[TE Connectivity:](#)

[CTA-0065](#)