

# REVISION A

DO NOT  
SCALE FROM  
THIS PRINT

ALL DIMENSIONS ARE REFERENCE  
(SEE T-C114-XXXX-X FOR CONTROLLING PRINT)

DESIGNED & DIMENSIONED  
IN MILLIMETERS

TC114-XXXX-X-X

LEAD STYLE  
-2830: 28 & 30 AWG

PACKAGING SPECIFICATION  
-S: STRIP (15 TERMINALS)  
-M: MINI REEL (1K - 5K TERMINALS)  
-R: REEL (30K TERMINALS)

PLATING SPECIFICATION  
-L: 10µ" LIGHT GOLD IN CONTACT  
AREA, B.A.T. ON TAIL

## CARRIER SPECIFICATIONS

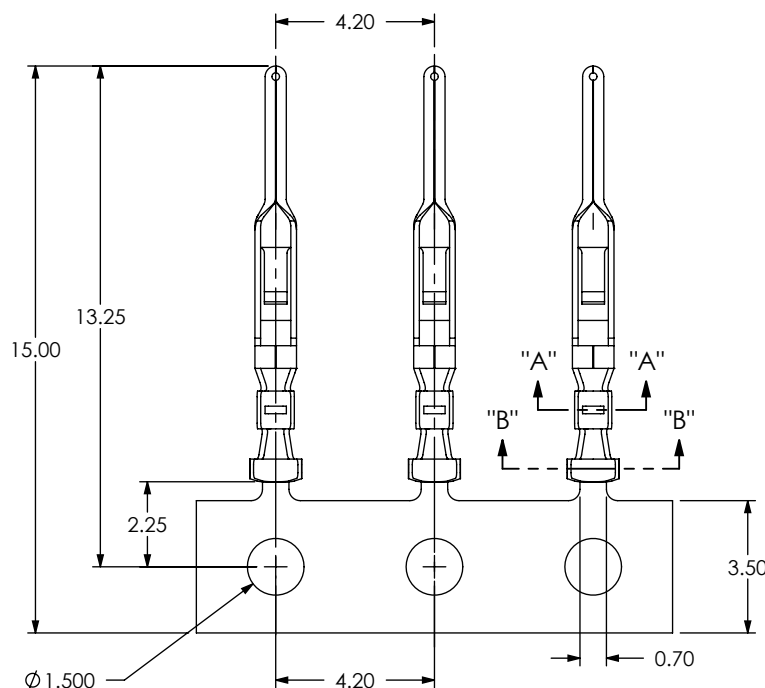
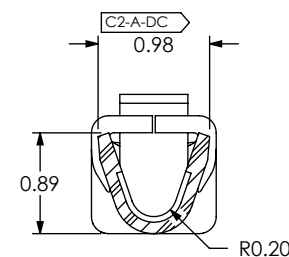
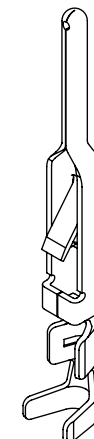
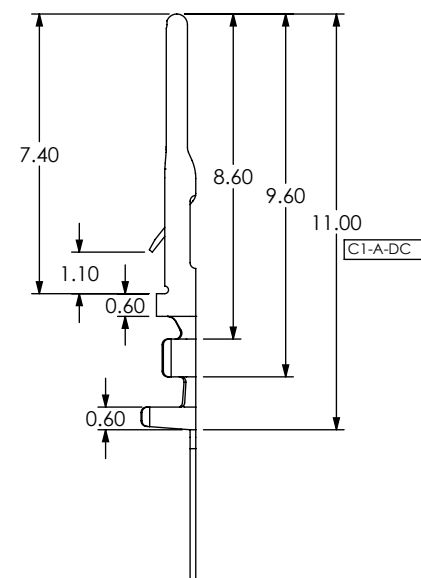
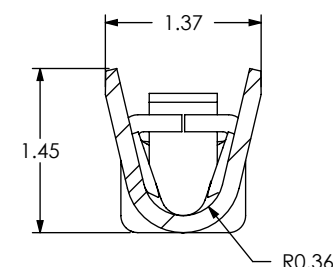

FIG 1  
TC114-2830-X-X SHOWN



SECTION "A"-A"  
SCALE 15:1



SECTION "B"-B"  
SCALE 15:1

## NOTES:

1. PLATED T-C114 PARTS TO BE PULLED, PLATING OPTION CONFIRMED, AND  
-S (STRIP): 15 ±0 PCS POSITIONED AS SHOWN IN A SAMTEC TUBE.  
-M (MINI REEL): 1,000 - 5,000 +300/-0 PCS POSITIONED AS SHOWN ON SAMTEC REEL WITH VIEWPORTS.  
-R (REEL): 30,000 +300/-0 PCS POSITIONED AS SHOWN ON SAMTEC REEL WITH VIEWPORTS.
2. LABEL SHOULD INCLUDE PLATING CALLOUT AND BE PLACED ON REEL AS SHOWN, AND PLACE AS SHOWN.
3. MAXIMUM NO OF SPLICES PER REEL:  
-M (MINI REEL): 1 SPLICES ARE NOT TO BE CONNECTED. NUMBER OF SPLICES TO BE MARKED ON EACH REEL.  
-R (REEL): 2 SPLICES ARE NOT TO BE CONNECTED. NUMBER OF SPLICES TO BE MARKED ON EACH REEL.
4. REELED PARTS TO BE INTERLEAVED WITH PAPER BETWEEN EACH LAYER OF PARTS. ONE SPLICE IN INTERLEAF ALLOWED PER REEL AND TO BE SECURELY CONNECTED.
5. OUTER WRAP SHALL RECEIVE:  
-M (MINI REEL): HMS1015C-24MM PROTECTIVE REEL BAND.  
-R (REEL): RB-24-1.00-P PROTECTIVE REEL BAND.
6. DUE TO PLATING REQUIREMENTS CONTACT SAMPLES MAY BE REMOVED INTERMITTINGLY FROM THE CARRIER RESULTING IN SMALL GAPS BUT DOES NOT AFFECT FINAL PIN COUNT.

UNLESS OTHERWISE SPECIFIED,  
DIMENSIONS ARE IN MILLIMETERS.  
TOLERANCES ARE:  
DECIMALS ANGLES

## PROPRIETARY NOTE

THIS DOCUMENT CONTAINS INFORMATION  
CONFIDENTIAL AND PROPRIETARY TO  
SAMTEC, INC. AND SHALL NOT BE REPRODUCED  
OR TRANSFERRED TO OTHER DOCUMENTS OR  
DISCLOSED TO OTHERS OR USED FOR ANY  
PURPOSE OTHER THAN THAT WHICH IT WAS  
OBTAINED WITHOUT THE EXPRESSED WRITTEN  
CONSENT OF SAMTEC, INC.

**samtec**

520 PARK EAST BLVD, NEW ALBANY, IN 47150  
PHONE: 812-944-6733 FAX: 812-948-5047  
e-Mail: info@SAMTEC.com code 55322

MATERIAL: DO NOT SCALE DRAWING SHEET SCALE: 6:1

PHOS BRONZE  
THICKNESS: 0.15 ±0.01

DESCRIPTION:

ACCLIMATE DISCRETE WIRE TERMINAL

DWG. NO.

TC114-XXXX-X-X

BY: TRAVIS N

11/26/2013

SHEET 1 OF 2

F:\dwg\sw\exisprod\compnt\terminal\TC114-XXXX-X-X.SLDDRW

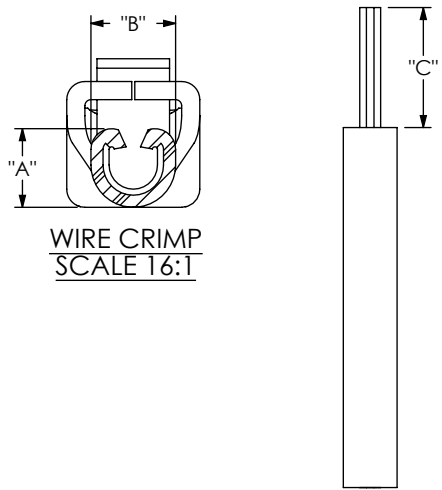

WIRE CRIMP  
SCALE 16:1

INSULATION STRIP LENGTH

TABLE 1						
P/N	AWG	STRANDS/AWG	INSULATION OD	"A"	"B"	"C"
T-C114-2830-X	30	7/38	0.737[.0290]- 0.940[.0370]	0.406 [0.0160]	0.813 [0.0320]	1.905 [0.0750]
	28	7/36		0.457 [0.0180]	0.813 [0.0320]	

FIG 2  
RECOMMENDED PROCESSING

PACKAGING VIEW  
-S (STRIP) OPTION

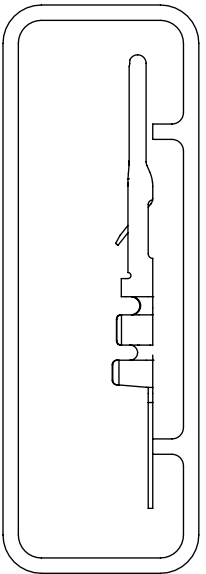

TUBE: PT-CC001  
PLUG: TP-03

SCALE 4:1

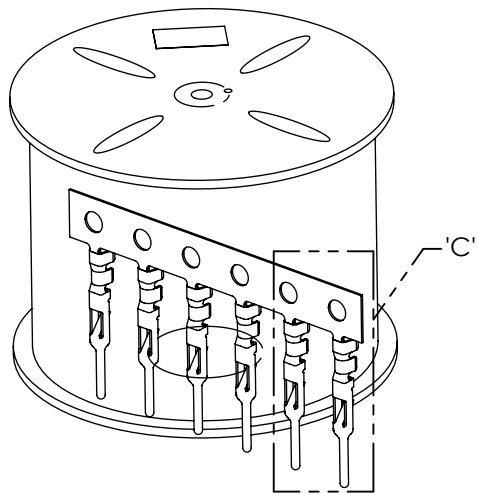

SCALE 2:1

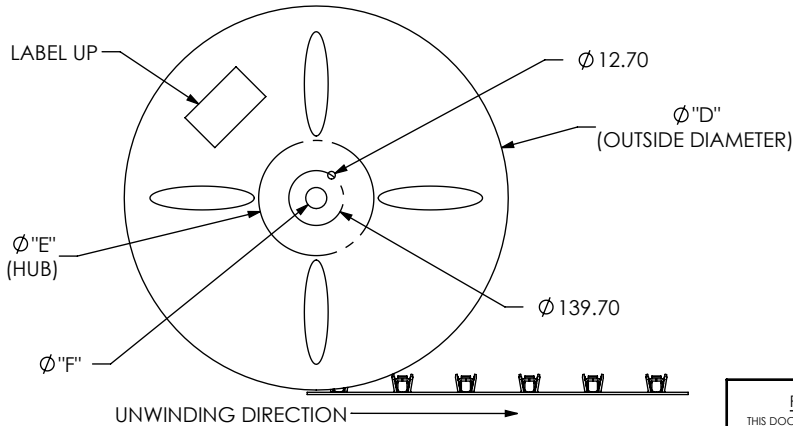
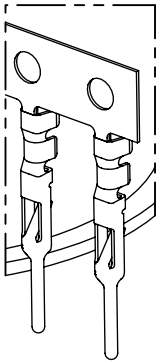

FIG 3  
REEL SPECIFICATIONS



DETAIL 'C'  
SCALE 3:1

PROPRIETARY NOTE  
THIS DOCUMENT CONTAINS INFORMATION  
CONFIDENTIAL AND PROPRIETARY TO  
SAMTEC, INC. AND SHALL NOT BE REPRODUCED  
OR TRANSFERRED TO OTHER DOCUMENTS OR  
DISCLOSED TO OTHERS OR USED FOR ANY  
PURPOSE OTHER THAN THAT WHICH IT WAS  
OBTAINED WITHOUT THE EXPRESSED WRITTEN  
CONSENT OF SAMTEC, INC.

DO NOT SCALE DRAWING

SHEET SCALE: 5:1



520 PARK EAST BLVD, NEW ALBANY, IN 47150  
PHONE: 812-944-6733 FAX: 812-948-5047  
e-Mail: info@SAMTEC.com code 55322

DESCRIPTION:  
ACCLIMATE DISCRETE WIRE TERMINAL

DWG. NO.  
TC114-XXXX-X-X

BY: TRAVIS N 11/26/2013 SHEET 2 OF 2

TABLE 2				
SUPPLIED	REEL PART NUMBER	"D"	"E"	"F"
-R	R-24-08.00-1.00-P	609.60	203.2	28.58
-M	MR-13.0-4.00-24	330.20	101.6	12.70