

| LOC | DIST | REVISIONS | | | | | |
|-----|------|-----------|-----|-------------|-----------|-----|------|
| HM | 00 | P | LTR | DESCRIPTION | DATE | DWN | APVD |
| | | | A | NSD06-126 | 17NOV2006 | JM | GB |
| | | | | | | | |
| | | | | | | | |
| | | | | | | | |

DUPLEX LC ADAPTER ASSEMBLY

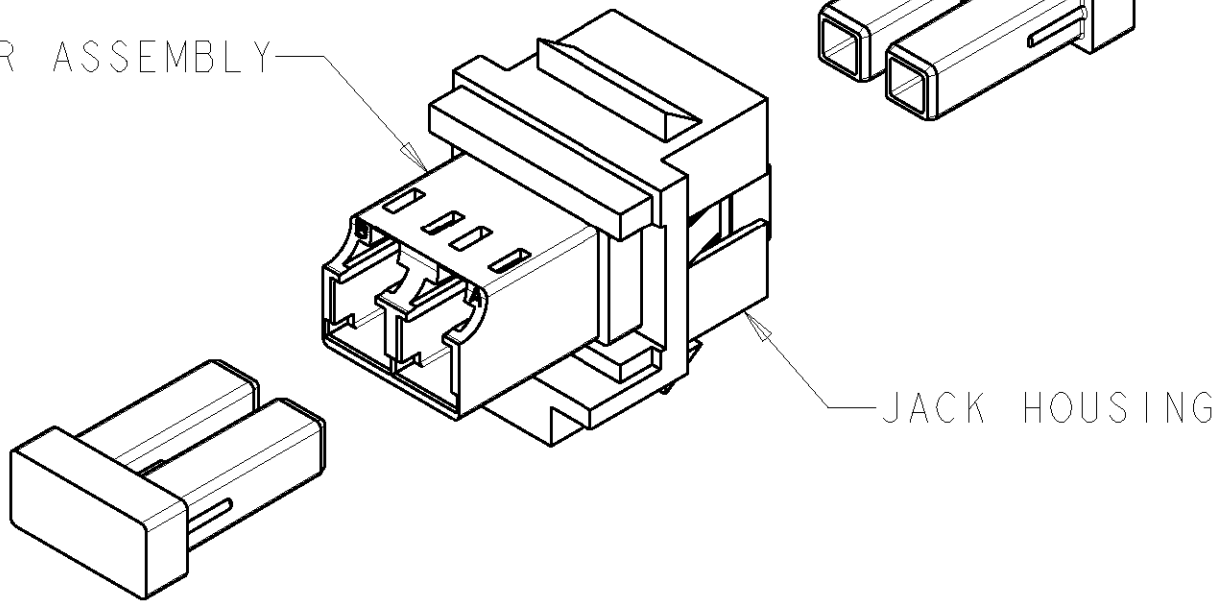

JACK HOUSING

1 MATERIAL:
JACK HOUSING:- ABS HIGH IMPACT UL94V-0
MOLDING COMPOUND. COLOR- LIGHT ALMOND.
LC DUPLEX ADAPTER ASSEMBLY:
HOUSING- POLYETHERIMIDE 94V-0,
COLOR- BEIGE
RETENTION CLIPS: STAINLESS STEEL

2 THESE TWO SUGGESTED CUTOUT OPENINGS
ARE USED IN TANDEM WITH DUAL FRONT AND
BACK CUTOUTS.

3 DUST PLUGS SHOWN NOT ASSEMBLED BUT
COME ASSEMBLED TO DUPLEX LC ADAPTER.

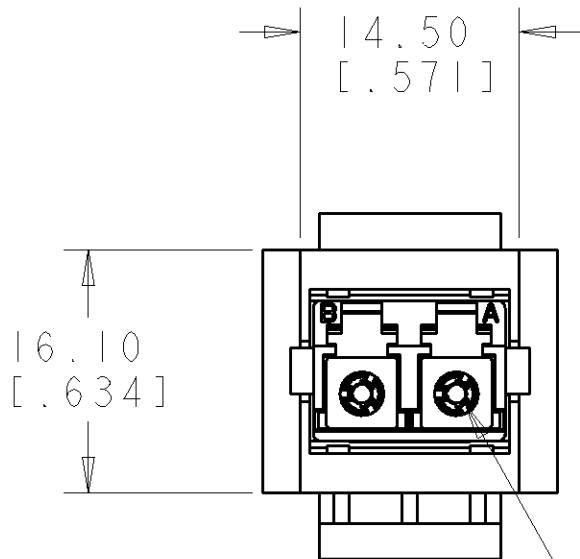
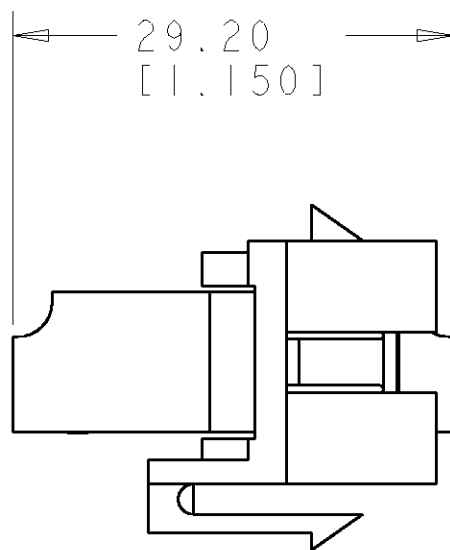

ALIGNMENT SLEEVE
CERAMIC

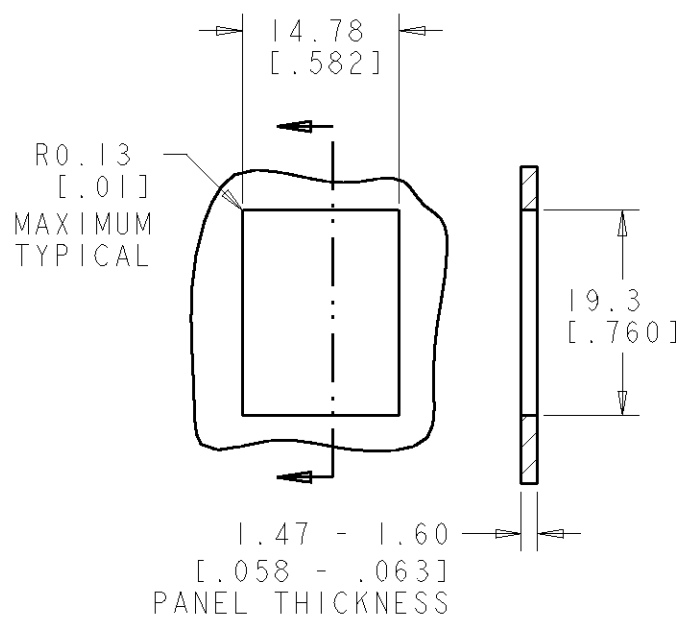

SINGLE PANEL CUTOUT

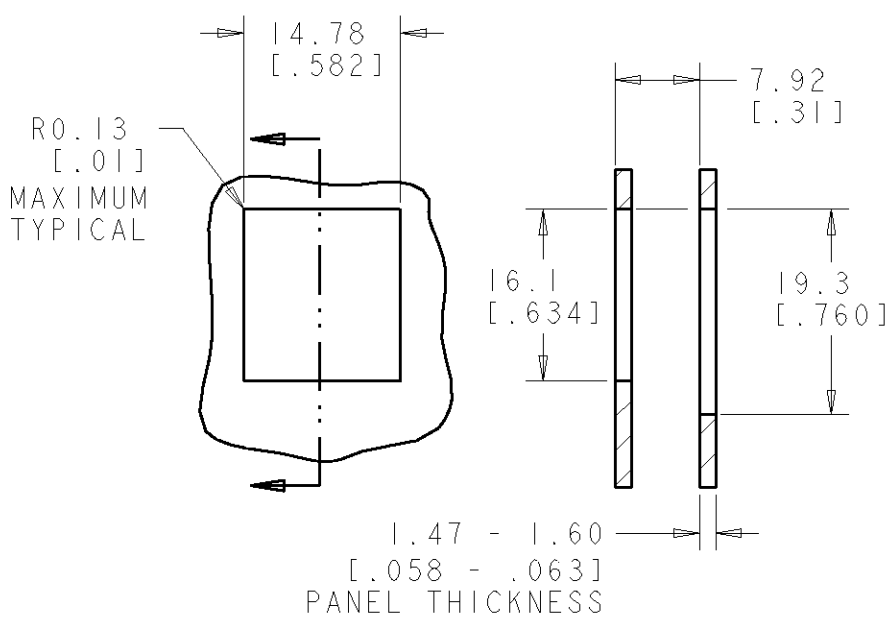

SUGGESTED FLUSH MOUNT
PANEL APPLICATION CUTOUT

| | | | | | | |
|--|--|--|-------------------------------------|--|--------------------|-----------------------|
| THIS DRAWING IS A CONTROLLED DOCUMENT FOR TYCO ELECTRONICS CORPORATION IT IS SUBJECT TO CHANGE AND THE CONTROLLING ENGINEERING ORGANIZATION SHOULD BE CONTACTED FOR THE LATEST REVISION. | | DWN J MCNEAL CHK G BOWMAN APVD G BOWMAN | 17NOV2006 17NOV2006 17NOV2006 | 1933174-1 PART NUMBER | | |
| DIMENSIONS: MM[INCHES] | | TOLERANCES UNLESS OTHERWISE SPECIFIED: | | tyco Electronics Tyco Electronics Harrisburg, PA 17105-3608 | | |
| 0 PLC 1 PLC 2 PLC 3 PLC 4 PLC ANGLES FINISH | | ± ± ± ± ± ± ± | | NAME DUPLEX, LC ADAPTER, MULTIMODE, KL SERIES | | |
| MATERIAL | | WEIGHT | | SIZE A2 | CAGE CODE 00779 | DRAWING NO 1933174 |
| CUSTOMER DRAWING | | SCALE | | SHEET | OF | REV A |

Mouser Electronics

Authorized Distributor

Click to View Pricing, Inventory, Delivery & Lifecycle Information:

[TE Connectivity Divested:](#)

[5-2111981-2](#)