

Rocker Switch

A8A

Safety-considered Power Rocker Switch

- Low heat radiation with a Unique leaf spring mechanism.
- Positive-opening mechanism incorporated.
- AC operated Neon lamp illumination models available.
- Contact gap of 3 mm minimum.
- Variety of color models available
- UL and CSA standards approved. Conforms to EN standard.



RoHS Compliant



Caution
Refer to Precautions

Ordering Information

List of Models

● Non-illuminated Models

Contact Form					Quantity per box
Color of cases		White	Black	Gray	
Color of caps	White	A8A-201	A8A-201-1	-	50
	Red	A8A-202	A8A-202-1	A8A-202-2	
	Green	A8A-203	A8A-203-1	A8A-203-2	
	Blue	A8A-204	A8A-204-1	-	
	Yellow	A8A-205	A8A-205-1	-	
	Black	A8A-207	A8A-207-1	A8A-207-2	

● Illuminated Models

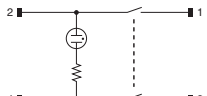
Contact Form								Quantity per box
Rated voltage		100 VAC			200 to 220 VAC			
Color of cases		White	Black	Gray	White	Black	Gray	
Color of caps	Red	A8A-212	A8A-212-1	A8A-212-2	A8A-222	A8A-222-1	A8A-222-2	50
	Green	A8A-213	A8A-213-1	A8A-213-2	A8A-223	A8A-223-1	A8A-223-2	
	Orange	A8A-216	A8A-216-1	A8A-216-2	A8A-226	A8A-226-1	A8A-226-2	

Specifications

onlinecomponents.com
THE ONLINE DISTRIBUTOR OF ELECTRONIC COMPONENTS

■ Ratings

Rated load	Non-inductive		Inductive	
	Resistive load	Lamp load	Inductive load	Inductive motor load
125 VAC	16A	10A	16A	16A
250 VAC	16A	10A	8A	16A

Note: 1. The above value shows steady current.
 2. The inductive load has a power factor of 0.4 min (AC) and a time constant of 7 ms min (DC).
 3. Lamp load has an inrush current of 10 times the steady current.
 4. Motor load has an inrush current of 6 times the steady current.
 5. The above ratings were tested under the following conditions:
 (1) Ambient temperature: 20±2 °C
 (2) Ambient humidity: 65±5 %RH
 (3) Switching frequency: 20 times/min.

● Neon lamps

Models	Rated voltage	Rated current
A8A-21□-□	100 VAC	1.5 mA
A8A-22□-□	200 to 220 VAC	1.5 mA

Note: 1. Life expectancy: 15,000 Hr min.
 2. Lamp is not exchangeable.

■ Approved Safety Standards

UL, (UL508)

16A 125 VAC, 16A 250 VAC

CSA (CSA C22.2 No.55)

16A 125 VAC, 16A 250 VAC

VDE (EN61058-1)

16A 250 VAC

■ Characteristics

Permissible operating speed	1 to 500 mm/s
Permissible operating frequency	Mechanical: 30 Operations / min max. Electrical: 20 Operations / min max.
Insulation resistance	100 MΩ min. (500 VDC)
Dielectric strength	2.000 VAG, 50/60 Hz, for 1 min between terminals of the same polarity 2.000 VAG, 50/60 Hz, for 1 min between terminals of the different polarity (See Note *) 4.000 VAG, 50/60 Hz, for 1 min between charged metal parts and the ground terminal
Vibration resistance	Malfunction: 10 to 55 Hz, 1.5-mm double amplitude
Shock resistance	Malfunction: 300 m/s ² max.
Durability	Mechanical: 40,000 operations min. Electrical: 20,000 operations min.
Weight	Non-illuminated: Approx 15g. Illuminated: Approx 16g.
Inrush current	100A max. (100 ms max.)
Ambient operating temperature	- 25 to +50 °C (with no icing or condensation)
Ambient operating humidity	45 to 85 %RH
Degree of protection	IP00
Electric shock protection class	Class II
PTI (proof tracking index)	175
Pollution degree	2

Note: For the condition in individual standard, contact your OMRON sales representative.

* Condition in the Neon lamp illuminated models are excluded.

Operating Circuit

onlinecomponents.com
THE ONLINE DISTRIBUTOR OF ELECTRONIC COMPONENTS

Non-illuminated Models		Neon lamp illuminated Models	
Correct wiring	Fig. A 	Fig. C Illuminated in accordance with power source 	Fig. D Illuminated in accordance with switch-on
	Fig. B 	Fig. E 	
Incorrect wiring			
Note	1. Do not apply any different voltage between the couple of terminals 1- 2, and 3- 4. 2. Safety standards approved for the figures A, C, and D.		

Dimensions

- Note: 1. All units are in millimeters unless otherwise indicated.
2. Unless otherwise specified, a tolerance of ± 0.4 mm applies to all dimensions.

A8A

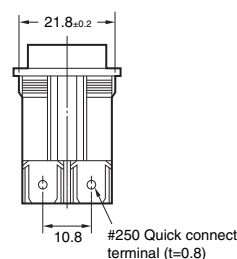
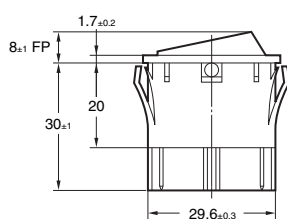
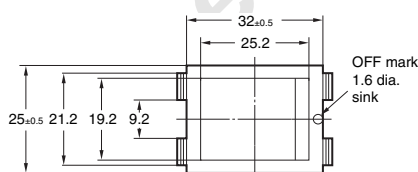
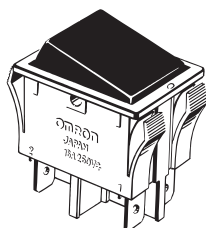

Operating Characteristics

Operating force (OF) max.	19.6 N (2,000 gf)
Free Position (FP)	8±1 mm
Operating Position (OF)	5±1 mm

Panel Cutout

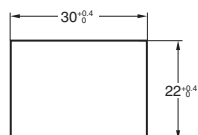

Note: Recommended panel thickness:
1.0 to 3.0 mm.

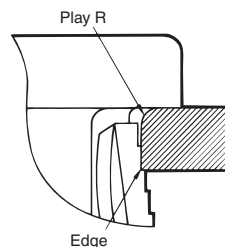

Be sure that play R is the operation side.

Optional Accessories

onlinecomponents.com
THE ONLINE DISTRIBUTOR OF ELECTRONIC COMPONENTS

Rubber cap for high dustproof.

A8A RUBBER CAP

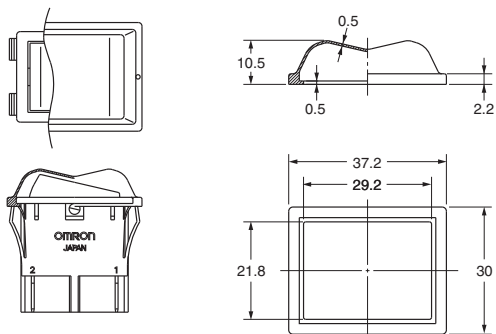

Condition the cap on Switch

Precautions

Be sure to read the Safety precautions of A8A Rocker Switches for correct use.

ALL DIMENSIONS SHOWN ARE IN MILLIMETERS.
To convert millimeters into inches, multiply by 0.03937. To convert grams into ounces, multiply by 0.03527.