

A

B

C

D

E

F

REVISIONS				
SYM	ZONE	ECN, ERN NO.	DATE	APPRD.
E		REVISED PER EAR 13822	JAN18/11	L.C.

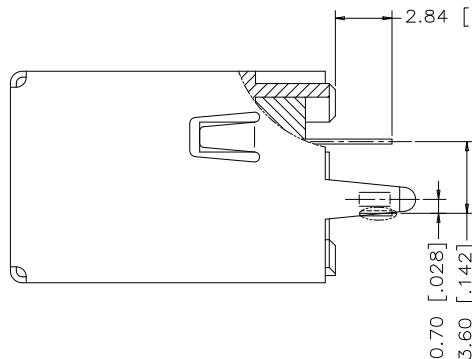
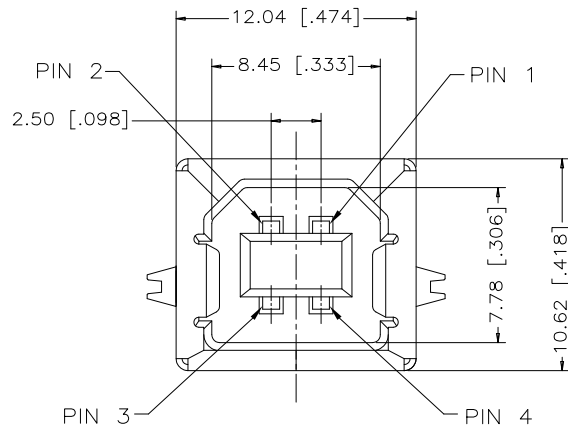

NOTES:

- HOUSING: HIGH TEMPERATURE THERMOPLASTIC OR POLYESTER(PBT) (SEE PART NUMBER) FLAMMABILITY UL94V-0 COLOUR: SEE PART NUMBER
- CONTACTS: PHOSPHOR BRONZE CONTACT PLATING: SEE AMPHENOL PART NUMBER SYSTEM FOR PLATING OPTIONS 50µin[1.27 MICRONS] MIN. NICKEL UNDERPLATE
- SHELL: PHOSPHOR BRONZE PLATING: NICKEL OVER COPPER UNDERPLATE.

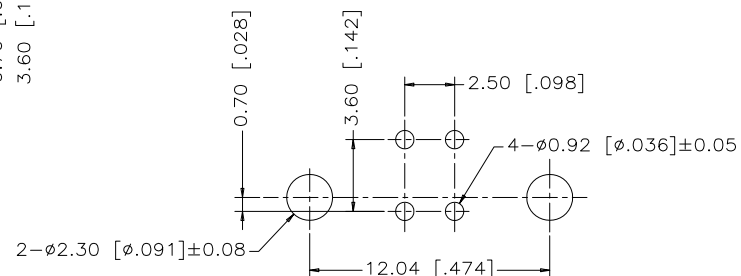
RECOMMENDED PC BOARD LAYOUT
(COMPONENT SIDE OF BOARD)

AMPHENOL PART NO.: U E 2 7 - B E X 4 - X 0 X

SERIES _____
UE27=RECEPTACLETYPE _____
B=SERIES BSTYLE _____
E=STRAIGHT PCB (TOP ENTRY)

CONTACT PLATING _____

5=30µin[0.76 MICRONS] GOLD OVER NICKEL ON CONTACT MATING AREA.

100µin[2.54 MICRONS] TIN OVER NICKEL ON CONTACT SOLDER AREA.

7=GOLD FLASH OVER NICKEL ON CONTACT MATING AREA.

100µin[2.54 MICRONS] TIN OVER NICKEL ON CONTACT SOLDER AREA.

MODIFIER

0=POLYESTER HOUSING (PBT)
H=HIGH TEMP MATERIAL
(MAX TEMPERATURE RATING
260°C FOR 10s)

SHIELDING

0=NO REAR SHIELD

COLOUR

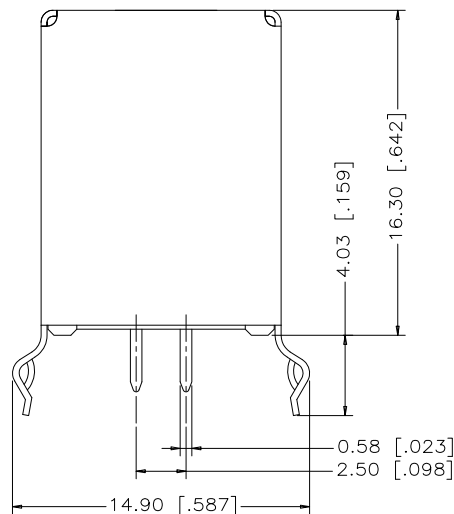
1=BLACK
2=BEIGE(AVAILABLE IN
STANDARD TEMP.ONLY)NUMBER OF CONTACTS
4=4 CONTACTS

MATERIAL <i>SEE NOTES</i>	DRAWN	MTChen	DATE	JUL 26.06	Amphenol Canada Corp.									
	DESIGNED	MTChen		JUL 26.06										
	CHECKED	L.CHAN		JUL 26.06										
	I. E. APPRD.													
FINISH <i>SEE NOTES</i>	Q. A. APPRD.				TITLE UNIVERSAL SERIAL BUS RECEPTACLE, SERIES B, STRAIGHT PCB TAIL, VERTICAL MOUNT-RoHS COMPLIANT									
	DWG. APPRD.													
	ENG. REL. NO.									DWG	DRAWING NO.	REV.		
	REF.	EAR 12968								C	P-UE27-BEX4-XOX	E		
		DIMENSIONS ARE IN	CODE ID. NO.		SCALE	5/1	WT.	-----	SURF.	-----	SHEET	1	OF	1
		mm[INCHES]	03554											

THIS DOCUMENT CONTAINS PROPRIETARY INFORMATION AND SUCH INFORMATION MAY NOT BE DISCLOSED TO OTHERS FOR ANY PURPOSE OR USED FOR MANUFACTURING PURPOSES WITHOUT WRITTEN PERMISSION FROM AMPHENOL CANADA CORP.

A

B

C

D

E

F