

DETAILS

Product Number	FCA12776_IRIS-O
Family	Iris
Type	Assembly
Color	black
Diameter	38 mm
Height	29.2 mm
Style	round
Optic Material	PMMA
Holder Material	PC
Fastening	pin, tape
Status	ready
ROHS Compliant	Yes
Date Updated	8/10/2012



OPTICAL PROPERTIES

LED	Viewing Angle	Light Beam	Efficiency	cd/lm	connector
XM-L	42+30 degrees		81 %	2.700	-
XM-L2	43+30 degrees		80 %	1.700	-

Relative intensity of FCA12776 & FCN12775_IRIS-O-XML

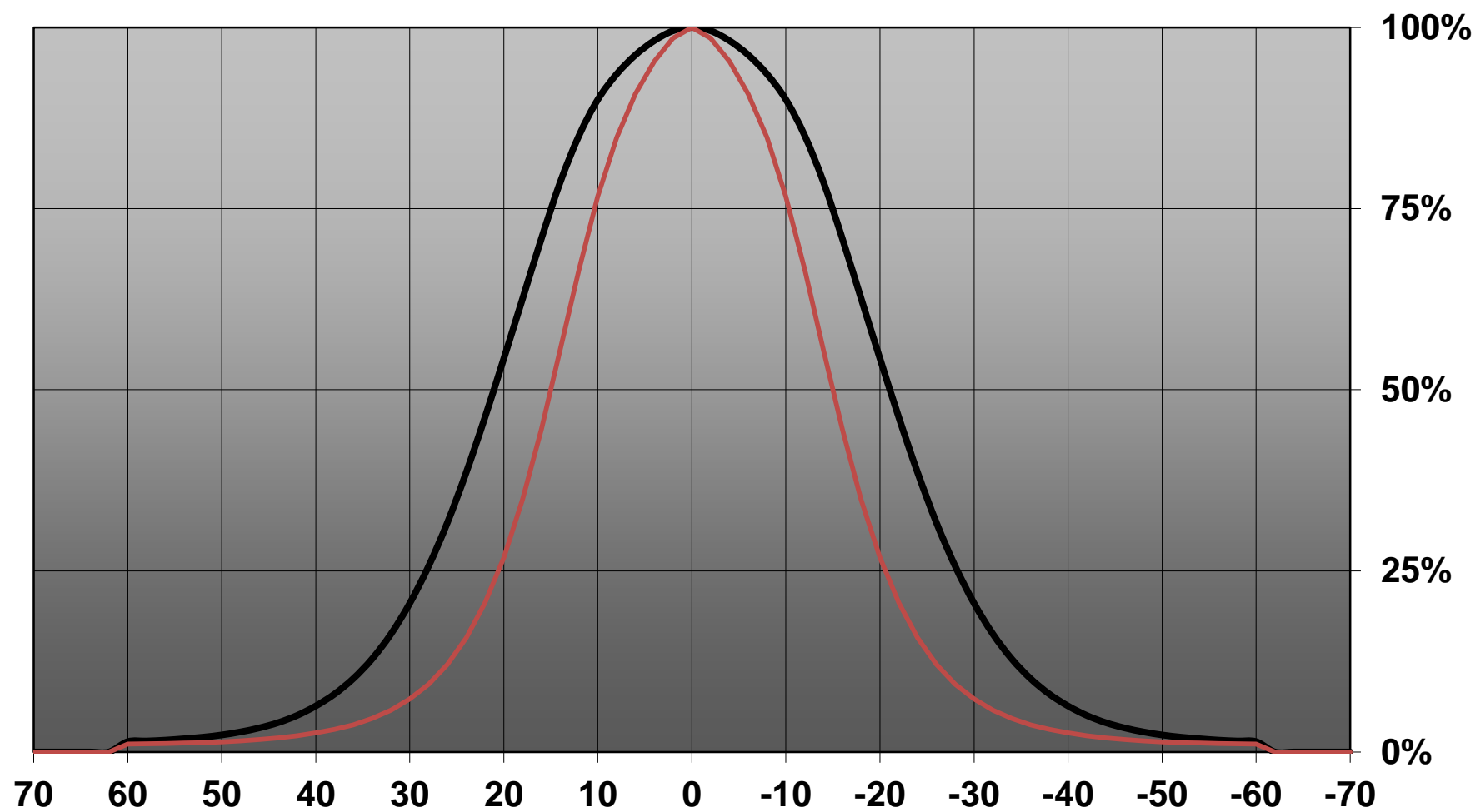

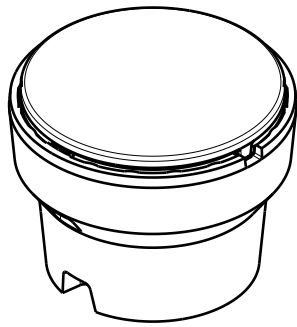

Isometric view

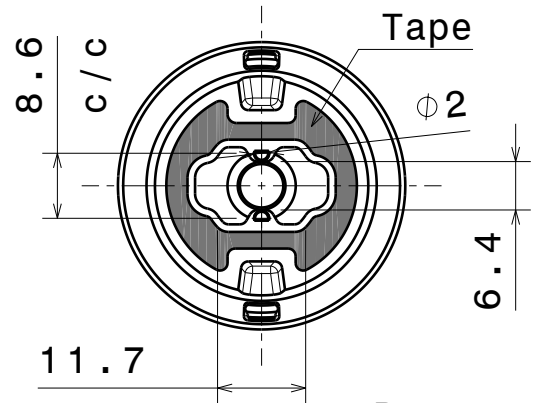

Bottom view

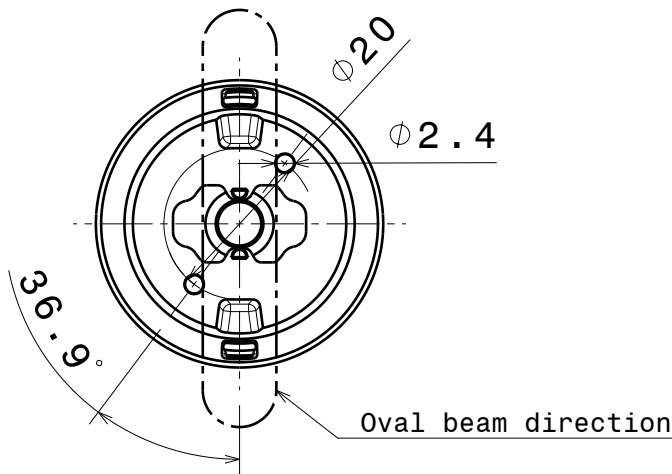

Bottom view
without tape

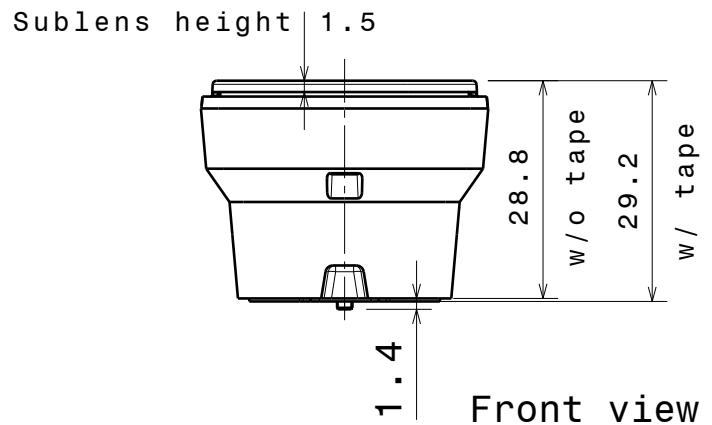

Front view

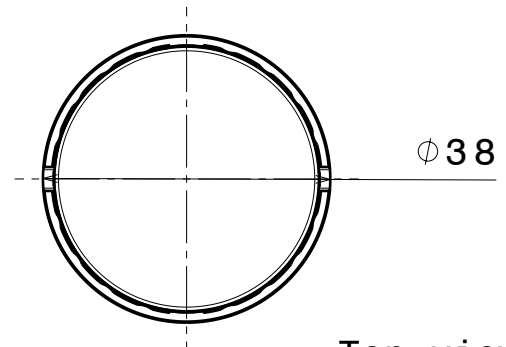

Top view

Materials

Lens: PMMA
Sublens: PC
Holder: PC
Tape: PU Foam

This drawing is our property.
It can't be reproduced
or communicated without
our written agreement.

LEDiL

Ledil Oy
Salorankatu 10
FIN 24240 SALO
Finland

DRAWING TITLE

Mechanical drawing

DRAWN BY

as

DATE

17.9.2012

CHECKED BY

sn

DATE

-

DESIGNED BY

-

DATE

-

SIZE

A4

PART NUMBER

SCALE

1:1

WEIGHT

-

REV

001

SHEET

1/1

D

A

Luminaire: LEDil Oy FCA12776_IRIS-O_(XM-L2) Efficiency=80%
Lamps: 1 x Cree XM-L2 (XMLBWT-0-7B4-T30-0L-0001) 91lm @ 250mA CCT=3200K P=0.7W I=250mA

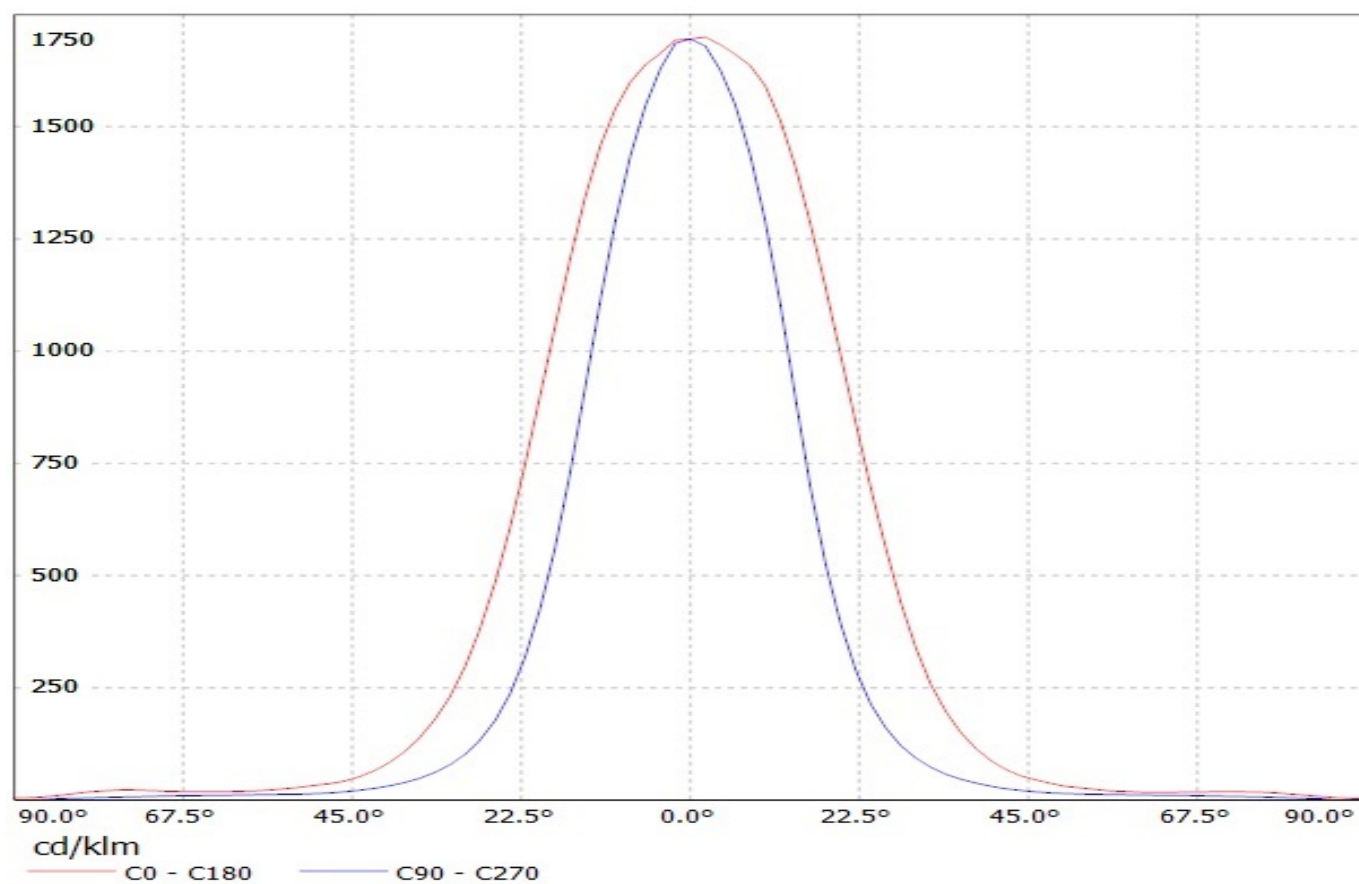

Luminaire: LEDil Oy FCA12776_IRIS-O_(XM-L2) Efficiency=80%
Lamps: 1 x Cree XM-L2 (XMLBWT-0-7B4-T30-0L-0001) 91lm @ 250mA CCT=3200K P=0.7W I=250mA

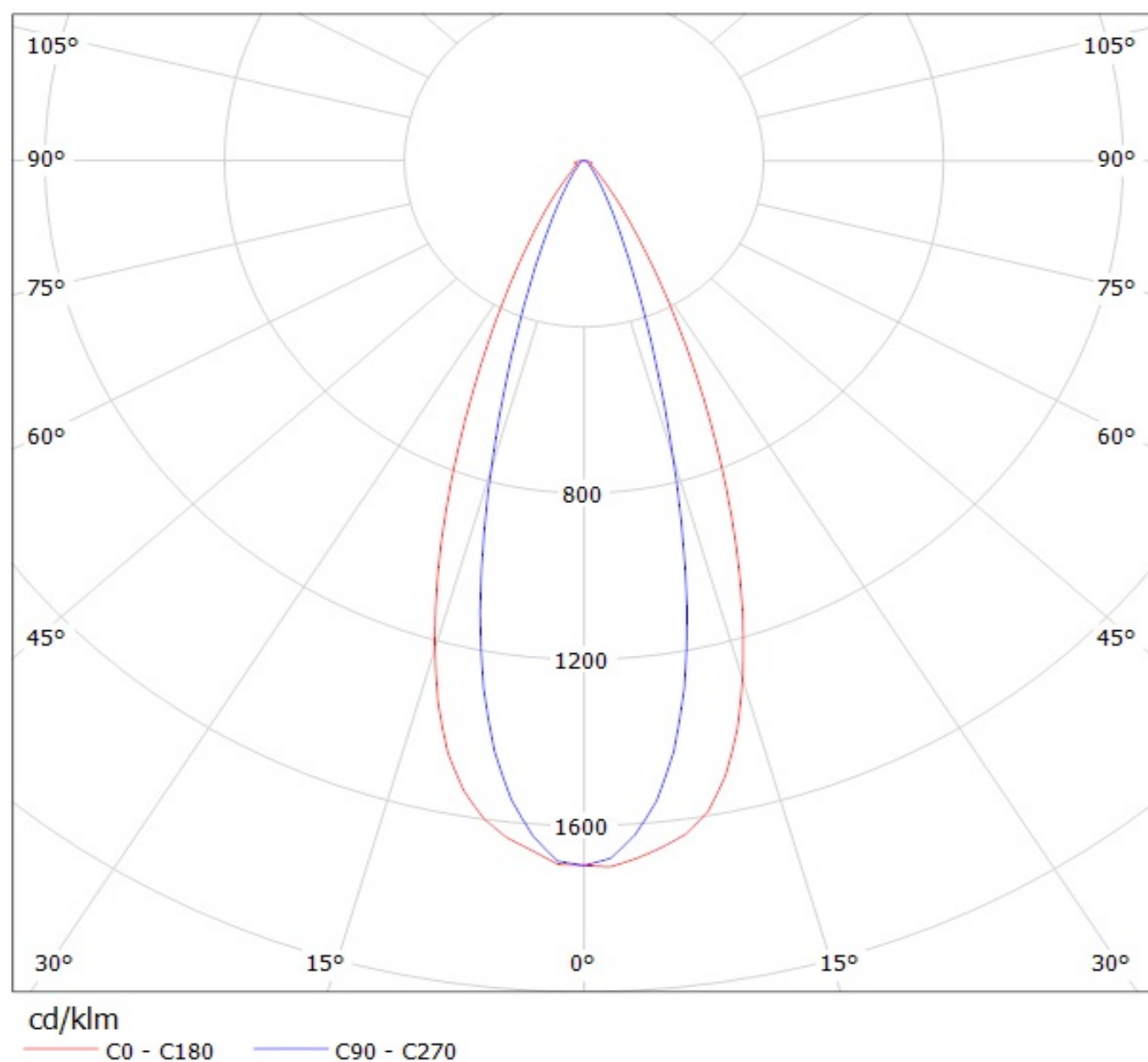

NOTE: The typical divergence will be changed by different color, chip size and chip position tolerance. The typical total divergence is the full angle measured where the luminous intensity is half of the peak value.