

| MS3343 (A AND B) MS90460 (A AND B) MS90461 (A AND B) | POSITIONER AND MATING END COLOR | 26 | 24 | 22 | 20 | 18 | 16 | 14 | 12 | WIRE SIZE |
|--|---------------------------------------|----|----|----|----|----|----|----|----|--------------------|
| -20-20 | RED | 1 | 2 | 3 | 4 | | | | | SELECTOR NUMBER |
| -16-16 | BLUE | | | | 4 | 5 | 6 | | | |
| -12-12 | YELLOW | | | | | | | 7 | 8 | |

DATA PLATE

UNCONTROLLED DOCUMENT
WILL NOT BE UPDATED

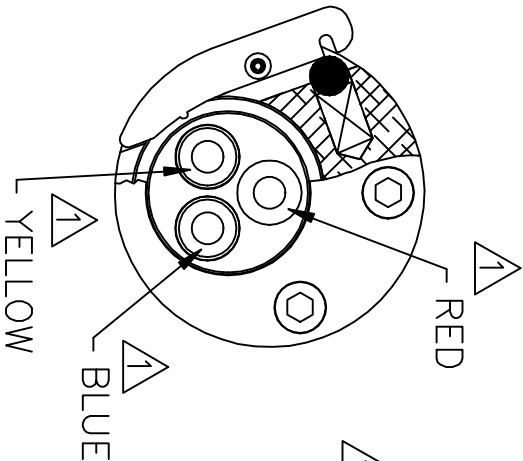

RANDOM ORDER OF ROTATION IS
ACCEPTABLE

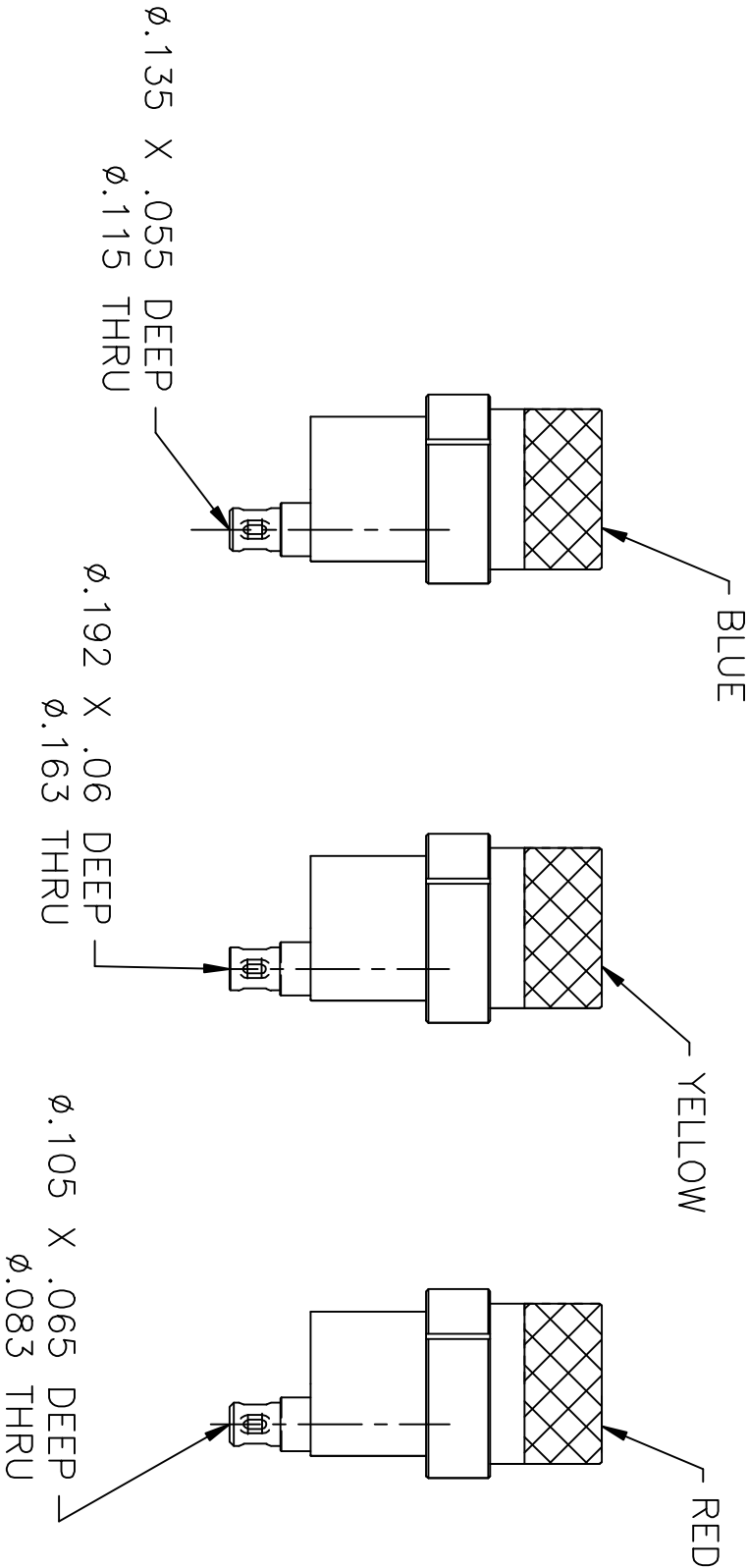
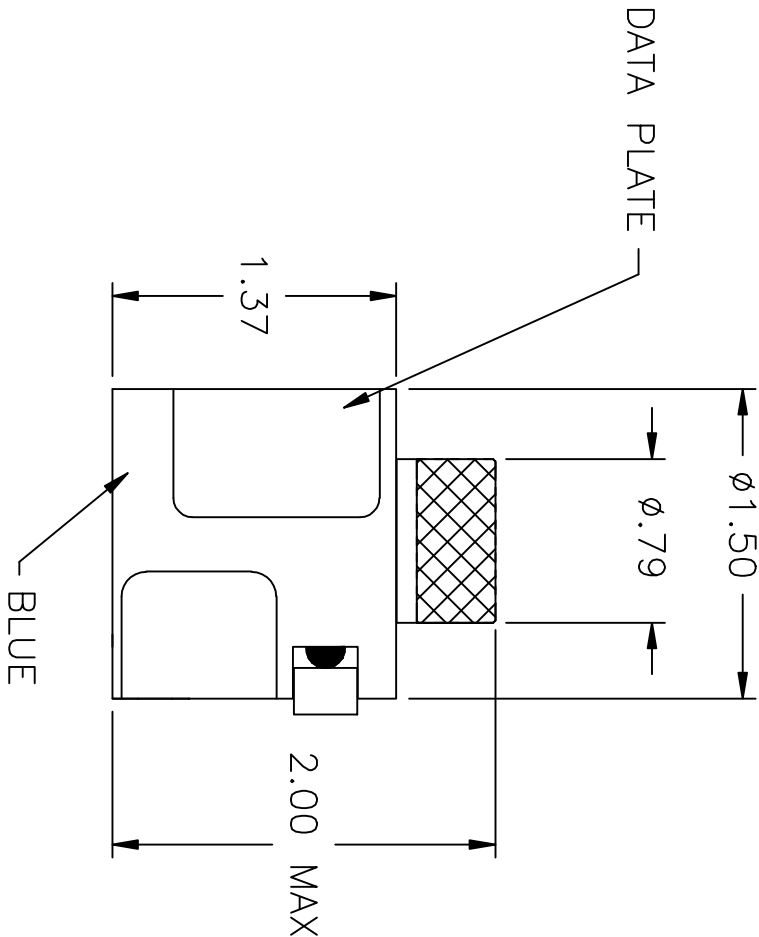

TYPICAL CONSTRUCTION
DIAMETERS ARE MEASURED FROM TOP OF
POSITIONER INSERTS

NOTES: 1. THIS IS AN AUTOCAD DRAWING DO NOT CHANGE MANUALLY.

| REV. | DESCRIPTION | BY | DATE | APR. |
|------|--------------|-----|----------|------|
| A | NEW RELEASE. | DY0 | 12-14-09 | MMK |

THESE DRAWINGS, SPECIFICATIONS OR OTHER DATA ARE AND REMAIN, THE PROPERTY OF ASTRO TOOL CORP. AND MUST BE RETURNED UPON REQUEST. THEY CONTAIN INFORMATION OWNED AND/OR DEVELOPED BY ASTRO AT ITS OWN PRIVATE EXPENSE AND MAY NOT BE USED, DUPLICATED OR DISCLOSED TO OTHERS, IN WHOLE OR IN PART FOR DESIGN, MANUFACTURE OR PROCUREMENT WITHOUT THE WRITTEN PERMISSION OF ASTRO TOOL CORP. EACH AND EVERY TIME.

| | |
|-------------------|---|
| SCALE: N.T.S. | UNLESS OTHERWISE SPECIFIED: |
| DWN BY: DY0 | DECIMALS: .XXX ± .005 .XX ± .010 .X ± .030 |
| DATE: 12-14-09 | ANGLES: ± 1° |
| APPROVED: | |

| | | |
|---|---|------------|
| | | CAGE 58164 |
| 21615 S.W. TUALATIN VALLEY HWY., BEAVERTON OR 97006 | | |
| DESCRIPTION: ENVELOPE DRAWING: 615715 TURRET ASSEMBLY, M22520/1-08 | | |
| PART NO. | B | 615715-ENV |