



SAW Components

Data Sheet B4042





SAW Components

B4042

Low-Loss Filter for Mobile Communication

860,50 MHz

Data Sheet



Features

- Low-loss RF filter for iDEN mobile telephone, receive path
- Low insertion attenuation
- Low amplitude ripple
- No matching network required for operation at 50 Ω
- Ceramic Package for **Surface Mounted Technology (SMT)**

Ceramic package **DCC6**

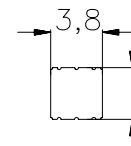
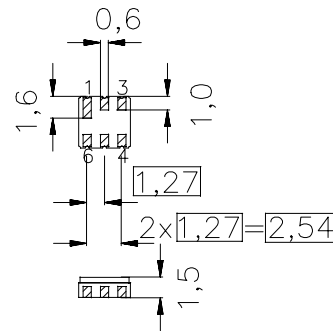

Dimensions in mm, approx. weight 0,07g

Terminals

- Ni, gold-plated

Pin configuration

- 2 Input
- 5 Output
- 1, 3, 4, 6 Case ground

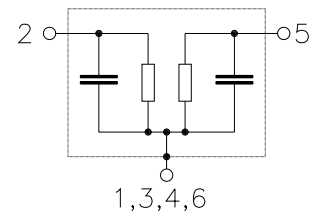

Type	Ordering code	Marking and Package according to	Packing according to
B4042	B39861-B4042-Z610	C61157-A7-A41	F61074-V8030-Z000

Electrostatic Sensitive Device (ESD)

Maximum ratings

Operable temperature range	T	- 30 / + 85	°C	source impedance 50 Ω continuous wave
Storage temperature range	T_{stg}	- 40 / + 85	°C	
DC voltage	V_{DC}	0	V	
Input power max.	P_{IN}	5	dBm	



Characteristics

Operating temperature range: $T = 25 \pm 2^\circ\text{C}$
 Terminating source impedance: $Z_S = 50 \Omega$
 Terminating load impedance: $Z_L = 50 \Omega$

		min.	typ.	max.	
Center frequency	f_c	—	860,50	—	MHz
Maximum insertion attenuation	α_{\max}				
	851,000... 870,000MHz	—	1,9	2,1	dB
Amplitude ripple (p-p)	$\Delta\alpha$				
	851,000... 870,000MHz	—	0,25	0,5	dB
Attenuation	α_{\min}				
	0,000... 738,000MHz	30	53	—	dB
	738,000... 757,000MHz	45	52	—	dB
	757,000... 806,000MHz	30	48	—	dB
	806,000... 825,000MHz	35	45	—	dB
	905,825... 924,825MHz	37	40	—	dB
	960,650... 983,000MHz	45	58	—	dB
	1070,300...1089,300MHz	50	53	—	dB
	1089,300...2000,000MHz	30	34	—	dB
Input and output return loss					
	851,000... 870,000MHz	14	16	—	dB



Characteristics

Operating temperature range: $T = -30$ to $+70^{\circ}\text{C}$
 Terminating source impedance: $Z_S = 50\ \Omega$
 Terminating load impedance: $Z_L = 50\ \Omega$

		min.	typ.	max.	
Center frequency	f_c	—	860,50	—	MHz
Maximum insertion attenuation	α_{\max}				
	851,000... 870,000MHz	—	2,1	2,5	dB
Amplitude ripple (p-p)	$\Delta\alpha$				
	851,000... 870,000MHz	—	0,45	0,7	dB
Attenuation	α_{\min}				
	0,000... 738,000MHz	30	53	—	dB
	738,000... 757,000MHz	45	52	—	dB
	757,000... 806,000MHz	30	48	—	dB
	806,000... 825,000MHz	35	44	—	dB
	905,825... 924,825MHz	37	40	—	dB
	960,650... 983,000MHz	45	58	—	dB
	1070,300...1089,300MHz	50	53	—	dB
	1089,300...2000,000MHz	30	34	—	dB
Input and output return loss					
	851,000... 870,000MHz	14	16	—	dB



SAW Components

B4042

Low-Loss Filter for Mobile Communication

860,50 MHz

Data Sheet



Characteristics

Operating temperature range: $T = -30$ to $+85^{\circ}\text{C}$
 Terminating source impedance: $Z_S = 50\ \Omega$
 Terminating load impedance: $Z_L = 50\ \Omega$

		min.	typ.	max.	
Center frequency	f_c	—	860,50	—	MHz
Maximum insertion attenuation	α_{\max}	—	2,2	2,7	dB
851,000... 870,000 MHz					
Amplitude ripple (p-p)	$\Delta\alpha$	—	0,55	1,0	dB
851,000... 870,000 MHz					
Attenuation	α_{\min}				
0,000... 738,000 MHz		30	53	—	dB
738,000... 757,000 MHz		45	52	—	dB
757,000... 806,000 MHz		30	48	—	dB
806,000... 825,000 MHz		35	44	—	dB
905,825... 924,825 MHz		37	40	—	dB
960,650... 983,000 MHz		45	58	—	dB
1070,300... 1089,300 MHz		50	53	—	dB
1089,300... 2000,000 MHz		30	34	—	dB
Input and output return loss					
851,000... 870,000 MHz		14	16	—	dB



Transfer function (25±2 °C)

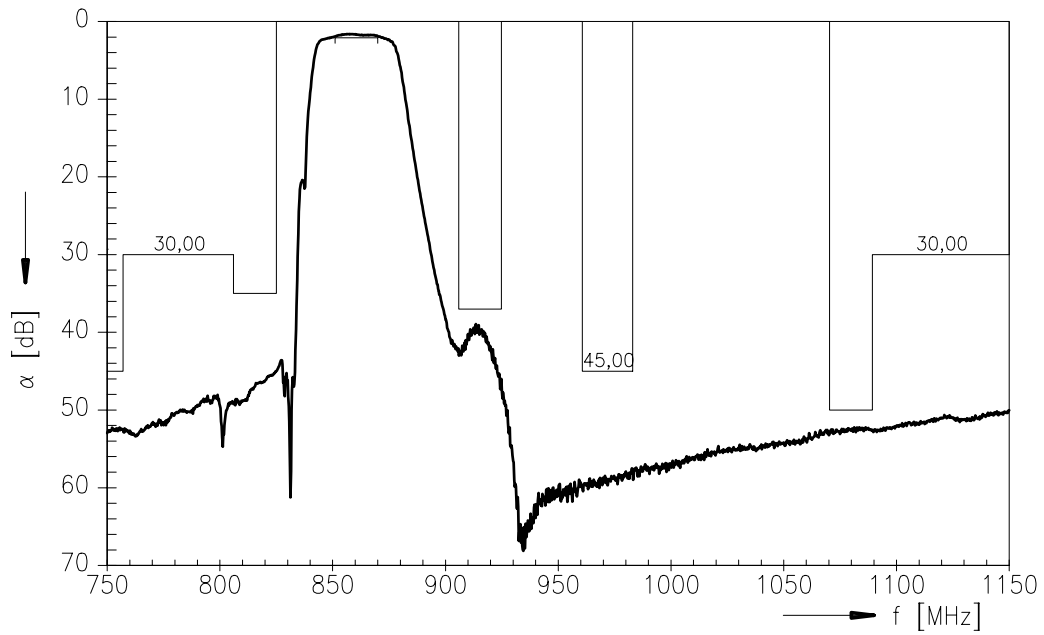

Transfer function (wideband)

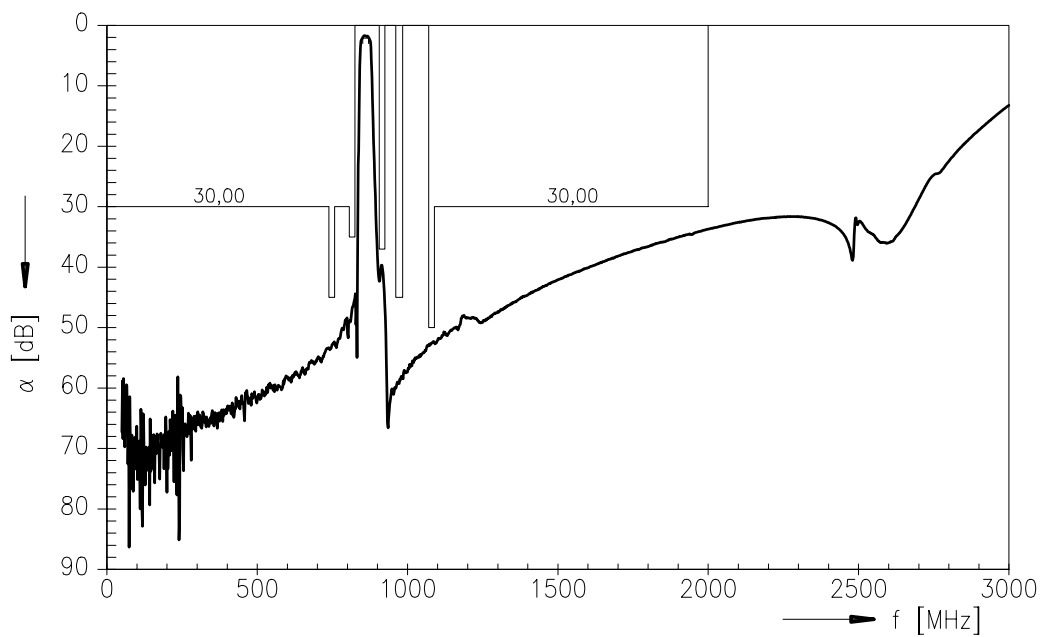



SAW Components

B4042

Low-Loss Filter for Mobile Communication

860,50 MHz

Data Sheet



Published by EPCOS AG

Surface Acoustic Wave Components Division, OFW E MF

P.O. Box 80 17 09, D-81617 München

© EPCOS AG 1999. All Rights Reserved.

As far as patents or other rights of third parties are concerned, liability is only assumed for components per se, not for applications, processes and circuits implemented within components or assemblies.

The information describes the type of component and shall not be considered as assured characteristics.

Terms of delivery and rights to change design reserved.

For questions on technology, prices and delivery please contact the sales offices of EPCOS AG or the international representatives.

Due to technical requirements components may contain dangerous substances. For information on the type in question please also contact one of our sales offices.