

CE70 SERIES LIMIT SWITCHES

Pre-wired

Metal Casing IP67-30mm width



Description

Pre-wired

Metal Casing IP67



General Technical Data

Standards	Plastic Casing		Metal Casing	
	Devices conform with international IEC 947-5-1 and European EN 60 947-5-1 standards		UL (upon request)	
Certifications - Approvals				
Air temperature near the device				
– during operation	°C		– 25 ... + 70	
– for storage	°C		– 40 ... + 70	
Mounting positions			All positions are authorised	
Protection against electrical shocks (acc. to IEC 536)	Class II		Class I	
Degree of protection(according to IEC 529 and EN 60 529)			IP 67	
Degree of protection(according to UL50)	Type 1 enclosure ("indoor use only")		Type 4 - 4X - 6 enclosure ("outdoor use - raintight - watertight corrosion resistant")	

Electrical Data

Rated insulation voltage U_i				
- according to IEC 947-1 and EN 60-947-1				
- according to UL 508 and CSA C22-2 n° 14			400 V (degree of pollution 3) B 300, R 300	
Rated impulse withstand voltage U_{imp}	kV		4	
(according to IEC 947-1 and EN 60 947-1)				
Conventional free air thermal current I_{th}	A		5	
(according to IEC 947-5-1) $\theta < 40^\circ\text{C}$				
Short-circuit protection	A		6	
$U_e < 500\text{ V a.c.}$ - gG (gl) type fuses				
Rated operational current				
I_e / AC-15 (according to IEC 947-5-1)	24 V - 50/60 Hz	A	5.0	
	120 V - 50/60 Hz	A	3.0	
	240 V - 50/60 Hz	A	1.5	
I_e / DC-13 (according to IEC 947-5-1)	24 V - d.c.	A	1.1	
	125 V - d.c.	A	0.22	
	250 V - d.c.	A	0.1	
Switching frequency	Cycles/h		3600	
Load factor			0.5	
Resistance between contacts	m Ω		25	
Mechanical durability			10 Millions of Cycles	

CE70 SERIES LIMIT SWITCHES

Pre-wired

Metal Casing IP67-30mm width



BLM/90_ Cross Roller Plunger with Fixing Nuts

Operating Head

Conformity / (N.C. contact with positive opening operation):

Max actuation speed [m/s]: 0.1

Min. force [N] or torque [Nm]: actuation / positive opening operation: 10/30

Weight (kg): 0.195

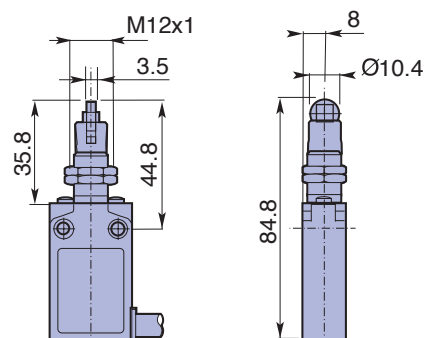

Part Number	Contact Block	Type	Travel Diagram
CE70.00.BLM/90	Snap Action Contacts (1NO + 1NC)	00	
CE70.01.BLM/90	Non overlapping Slow Action Contacts (1NO + 1NC)	01	

EM_ Roller Lever

Operating Head

Conformity / (N.C. contact with positive opening operation):

Max actuation speed [m/s]: 1.5

Min. force [N] or torque [Nm]: actuation / positive opening operation: 0.08/0.28

Weight (kg): 0.225

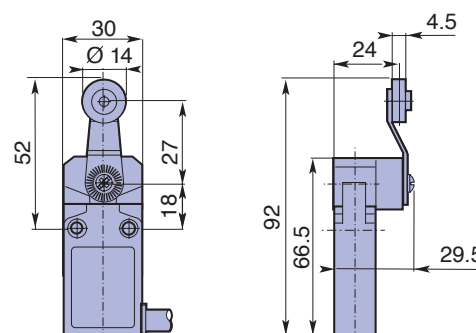

Part Number	Contact Block	Type	Travel Diagram
CE70.00.EM	Snap Action Contacts (1NO + 1NC)	00	
CE70.01.EM	Non overlapping Slow Action Contacts (1NO + 1NC)	01	