

ADAPTERS, BETWEEN-SERIES

SMA / GPO™ or SMP, DC - 18 GHz

SPECIFICATIONS:

Models: 5190xx, 5191xx, 5192x, 5193x

RoHS
Compliant

AEROFLEX
A passion for performance.

Electrical:

Frequency Range _____ DC - 18.0 GHz

VSWR _____ 1.20:1 Max.

Impedance _____ 50 Ohms

Operating Temp Range _____ -65°C to +125°C

Mechanical:

SMA Connectors _____ Passivated Stainless Steel

Mates with MIL-STD-348

GPO™ /SMP Connectors _____ Gold Plated Beryllium Copper

(GPO Connectors Mate with SMP Connectors IAW MIL-STD-348)

Conductors _____ Gold Plated Beryllium Copper

GPO is a trademark of Corning Gilbert Inc.

Model Number: **5190XX**

GPO™/SMP Male to SMA Male

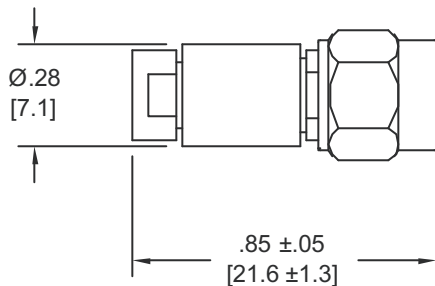

Model Number: **5191XX**

GPO™/SMP Male to SMA Female

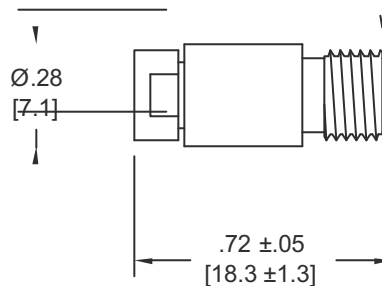

Model Number: **5192X**

GPO™/SMP Female to SMA Male

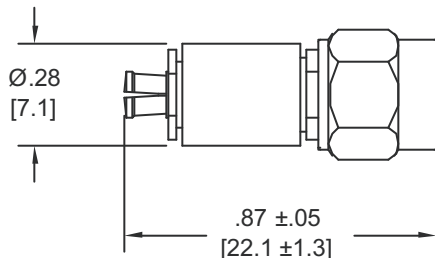

Model Number: **5193X**

GPO™/SMP Female to SMA Female

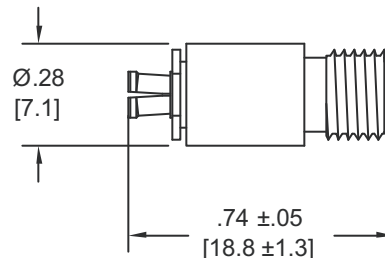

HOW TO ORDER:

Model Number: **519XYZ**

Base Number
As Shown Above

Connector Type
G = GPO™ Connectors
P = SMP Connectors

Connector Style
= Full Detent Male Interface
Force to Engage: 15.0 Lbs. Max.
L = Limited Detent Male Interface
Force to Engage: 5.0 Lbs. Max.

Ordering Examples:

Model Number: **5190G**

GPO™ Male/SMA Male

GPO™ Male has Full Detent Interface

Model Number: **5191PL**

SMP Male/SMA Female

SMP Male has Limited Detent Interface

Model Number: **5193P**

SMP Female/SMA Female

Note: Dimensions in Brackets are Expressed in Millimeters and are for Reference Only.

5190: REV D

AEROFLEX
INMET

Aeroflex / Inmet, Inc. • 300 Dino Drive, Ann Arbor, MI 48103 • U.S.A.
888-244-6638 or 734-426-5553 • FAX: 734-426-5557
www.aeroflex.com/inmet • inmet@aeroflex.com