



Fire & Smoke Resistant Connector

**The plastic rectangular solution
offering an excellent fire & smoke resistance for indoor applications.**

Compliant to railway standards



Tested according to NFF61030

**Compact design
& up to 36 contacts**



Ideal for tight space integration & high density contact applications

Excellent durability



500 mating / unmating

Standardization oriented



Compatible with standard AWG16 contacts

A wide range available



Plug & receptacle with or without hood
Panel mount receptacle
PCB receptacle

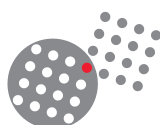

SOURIAU on the railway market



The SOURIAU solution offers a wide range of connector layouts providing a simplified process from purchasing to harnessing: 1 type of contact to order, to manage, to stock, to crimp for a wide range of connectors.

SOURIAU's standardisation policy is the best compromise between technology and cost.



SOURIAU connectors ensure the continuity of the network with railway qualified connectors integrating new technologies: copper contacts, Quadrax and fibre optics to transfer high speed Ethernet and other data protocols.



SOURIAU, along with its customers is committed to the research of energy efficiency and sustainability.

The use of lightweight materials, fiber optics and high contact density contribute to the weight reduction of train equipments and help railway operators to save energy.

Railway SMS / Flame Retardant



Technical features

- Insulating material: Polyamid
- Endurance: 500 mating/unmating
- Colour: grey
black - Boardmount versions
- PCB contacts (for SMS GE33, 43, 53, 63):
Min. 0.4µ gold all over, over nickel
- Keying system: by using discrimination cavities
(not available for all layouts, please check in the following tables)
- Current rating per contact: 13 Amps
- Insulation resistance: 5000 MΩ
- Withstanding voltage: 2550 Vac
- Operating voltage: 220 V (according to EN 50-124)
- Operating temperature: -40°C to +105 °C
- Sealing (mated conditions): IP40
- Flammability rating:
 - . I3F2 according to NFF16101/16102 standards
 - . PCB version: I2F3 according to NFF16101/16102 standards



Ordering information

Connector family	SMS SMS	4 36	PDH3 RD3
Number of contacts: 2, 3, 4, 6, 9, 12, 15, 18, 24, 36			
Design variation			
PDH3] Contacts to be ordered separately		
RDH3			
PD3] PCB contacts included		
RD3			
R3			
GE33			
GE43			
GE53			
GE63			

Contact layouts

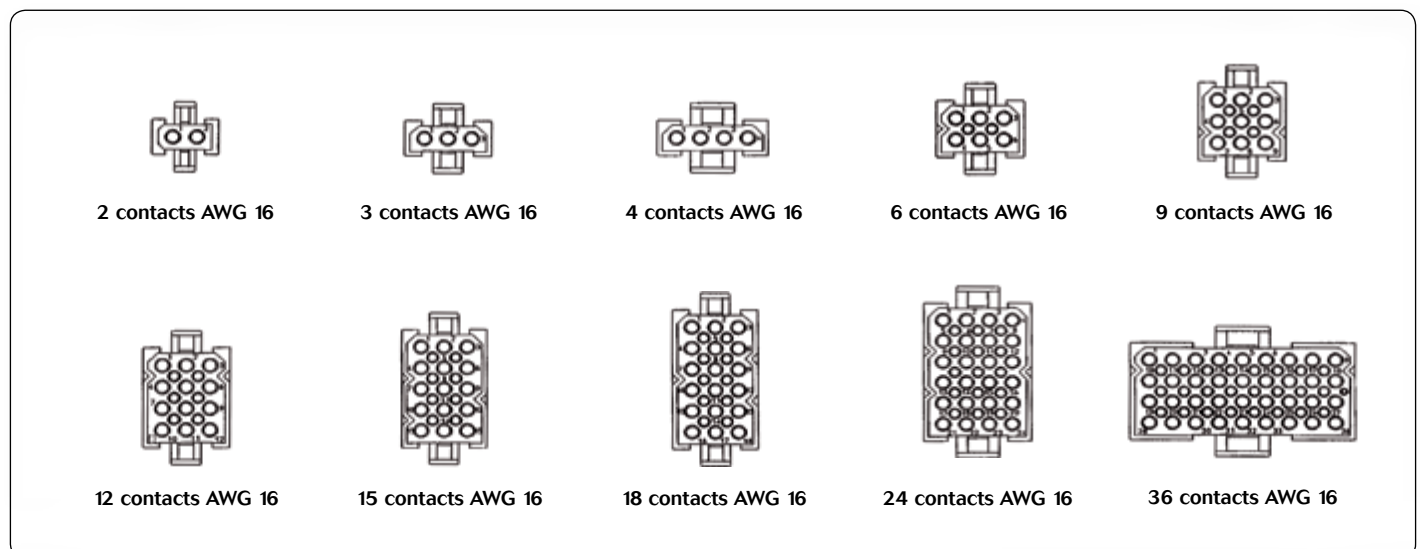



Receptacle

Receptacle with integrated strain relief hood (Delivered without contacts)

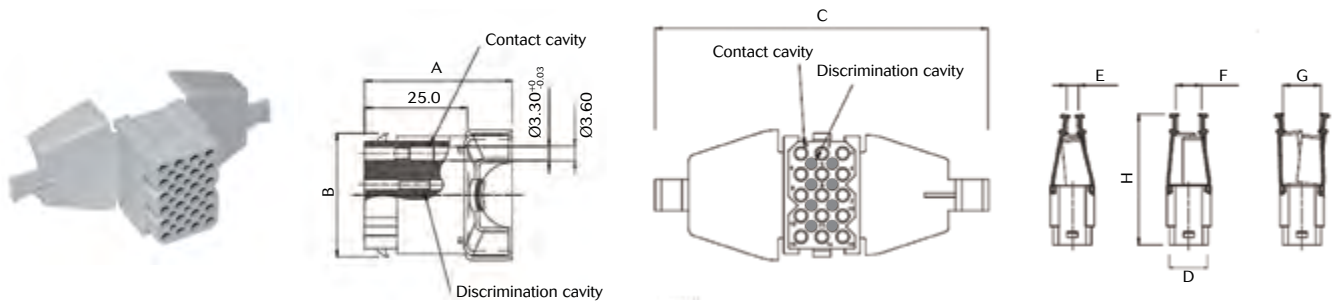

Part numbers	Number of contact cavities	Number of discrimination cavities	A	B	C	D	E	F	G	H	Cable range
SMS2RDH3	2	0	31.6	9.9	64.8	11.1	0.5	7.4	8.4	49.2	0.5 - 8.4
SMS3RDH3	3	0	35.1		69.0	16.2	0.8	4.1	7.3		0.8 - 7.3
SMS4RDH3	4	0	38.2		74.4	21.2	1.5	5.4	10.0		1.5 - 10.0
SMS6RDH3	6	2	34.6	15.0	72.6	16.2	1.7	6.8	9.2	50.9	1.7 - 9.2
SMS9RDH3	9	4	35.8	20.0	75.3		3.9	9.3	12.3	52.2	3.9 - 14.3
SMS12RDH3	12	6	38.1	25.1	72.0		4.0	10.0	15.0	52.7	4.0 - 15.0
SMS15RDH3	15	8	35.9	30.2	81.3		5.0	11.0	16.2	55.2	5.0 - 16.2
SMS18RDH3	18	10	36.1	35.3			5.8	12.5	20.3		5.8 - 20.3
SMS24RDH3	24	15	39.7		90.4	21.2	7.1	12.4	20.4	57.2	7.1 - 20.4
SMS36RDH3	36	24	54.6	25.1	128.0	46.6	8.8	13.0	24.5	63.3	8.8 - 24.5

Receptacle without strain relief hood (Delivered without contacts)

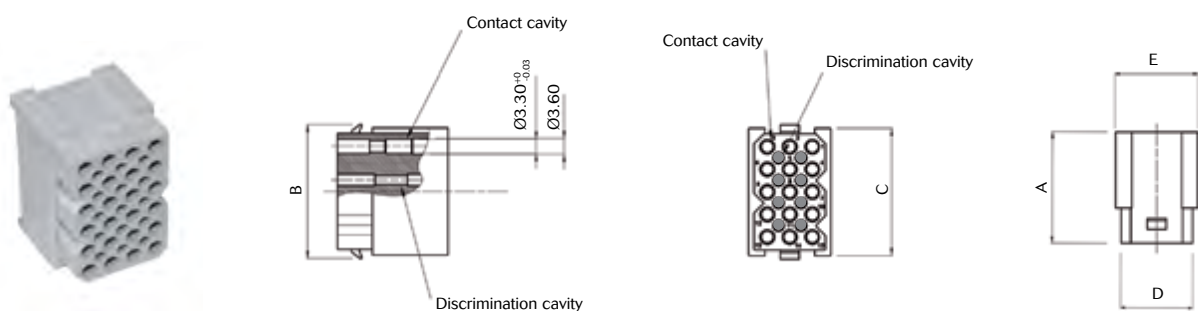

Part numbers	Number of contact cavities	Number of discrimination cavities	A	B	C	D	E
SMS2RD3	2	0	25.0	9.9	8.4	11.1	14.1
SMS3RD3	3	0		9.9	8.4	16.2	18.6
SMS4RD3	4	0		9.9	8.4	21.2	23.7
SMS6RD3	6	2		15.0	13.4	16.2	18.6
SMS9RD3	9	4		20.0	18.5	16.2	18.6
SMS12RD3	12	6		25.1	23.6	16.2	18.6
SMS15RD3	15	8		30.2	28.7	16.2	18.6
SMS18RD3	18	10		35.3	33.8	16.2	18.6
SMS24RD3	24	15		35.3	33.8	21.2	23.7
SMS36RD3	36	24		25.1	23.6	46.6	49.1



Receptacle

Panel mount receptacle (Delivered without contacts)

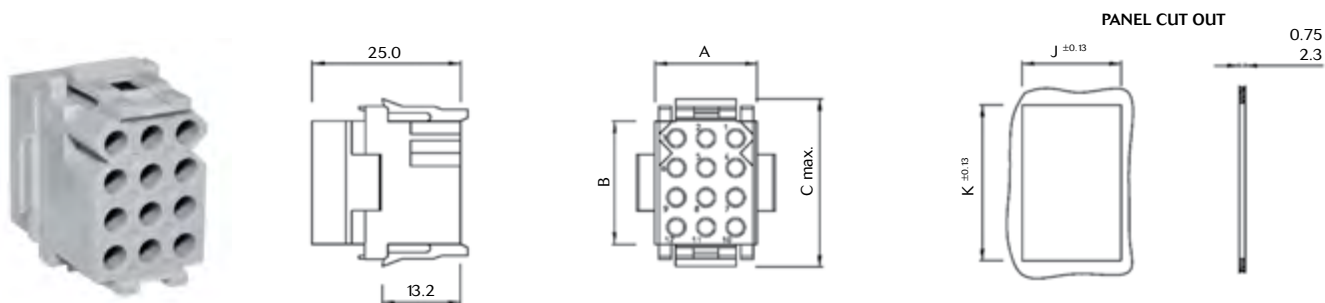

Part numbers	Number of contact cavities	Number of discrimination cavities	A	B	C max.	J ^{±0.13}	K ^{±0.13}
SMS2R3	2	0	11.0	5.8	15.2	11.4	11.6
SMS3R3	3	0	16.2			16.5	
SMS4R3	4	0	21.2			21.7	
SMS6R3	6	0	16.2	10.9	20.3	16.5	16.7
SMS9R3	9	0		16.0	25.4		21.6
SMS12R3	12	0		21.1	30.5	16.7	26.7
SMS15R3	15	0		26.2	35.6		31.8
SMS18R3	18	0		31.2	40.6		36.9
SMS24R3	24	0	21.2		21.7		
SMS36R3	36	0	46.6	21.1	30.5	47.1	26.7

Railway SMS / Flame Retardant



Plug

Plug with integrated strain relief hood (Delivered without contacts)

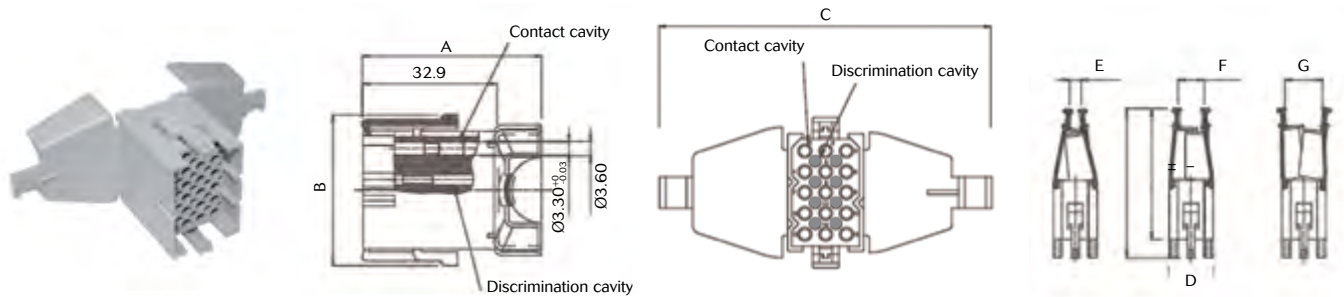

Part numbers	Number of contact cavities	Number of discrimination cavities	A	B	C	D	E	F	G	H	I	Cable range
SMS2PDH3	2	0	39.5	16.4	64.8	14.1	0.5	7.4	8.4	57.1	49.2	0.5 - 8.4
SMS3PDH3	3	0	43.0		69.0	18.6	0.8	4.1	7.3			0.8 - 7.3
SMS4PDH3	4	0	46.1		74.4	23.7	1.5	5.4	10.0			1.5 - 10.0
SMS6PDH3	6	2	42.5	21.5	72.6	18.6	1.7	6.8	9.2	58.8	50.9	1.7 - 9.2
SMS9PDH3	9	4	43.7	26.7	75.3		3.9	9.3	12.3	60.1	52.2	3.9 - 14.3
SMS12PDH3	12	6	46.0	31.7	72.0		4.0	10.0	15.0	60.6	52.7	4.0 - 15.0
SMS15PDH3	15	8	43.8	36.7	81.3		5.0	11.0	16.2	63.1	55.2	5.0 - 16.2
SMS18PDH3	18	10	44.0	41.8			5.8	12.5	20.3			5.8 - 20.3
SMS24PDH3	24	15	47.6		90.4	23.7	7.1	12.4	20.4	65.1	57.2	7.1 - 20.4
SMS36PDH3	36	24	62.5	31.7	128.0	49.1	8.8	13.0	24.5	71.2	63.3	8.8 - 24.5

Plug without strain relief hood (Delivered without contacts)

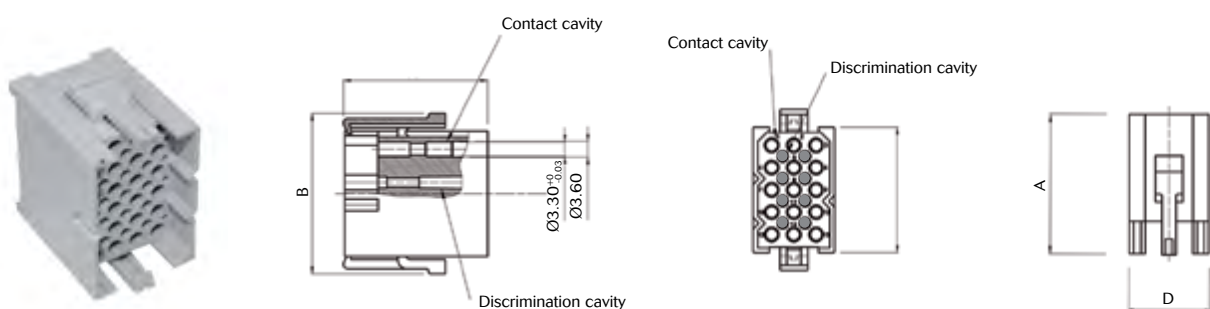

Part numbers	Number of contact cavities	Number of discrimination cavities	A	B	C	D
SMS2PD3	2	0	32.7	16.4	8.4	14.1
SMS3PD3	3	0		16.4	8.4	18.6
SMS4PD3	4	0		16.4	8.4	23.7
SMS6PD3	6	2		21.5	13.4	18.6
SMS9PD3	9	4		26.7	18.5	18.6
SMS12PD3	12	6		31.7	23.6	18.6
SMS15PD3	15	8		36.7	28.7	18.6
SMS18PD3	18	10		41.8	33.8	18.6
SMS24PD3	24	15		41.8	33.8	23.7
SMS36PD3	36	24		31.7	23.6	49.1

It is recommended to use unirap cable tie (not delivered by Souriau)

Note : all dimensions are in mm



PCB receptacle

Right angle boardmount receptacle delivered with female PCB contacts (SMS GE53)

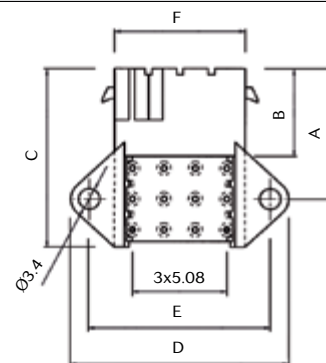
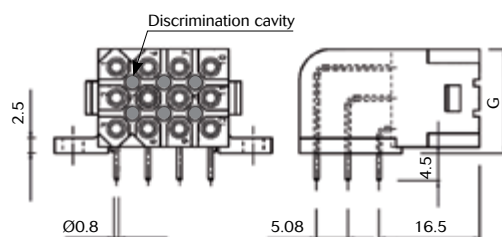

Contacts (included)	Part numbers	Number of contact cavities	Number of discrimination cavities	A	B	C	D	E	F	G
Female contacts	SMS3GE53	3	0	16.5	14.4	20.5	30.2	24.2	16.2	6.8
	SMS6GE53	6	0	19		24.5				11.9
	SMS12GE53	12	6	21.6		29.5	35.2	29.2	21.2	17.2
	SMS18GE53	18	10				45.4	39.4	31.2	

Right angle boardmount receptacle delivered with male PCB contacts (SMS GE63)

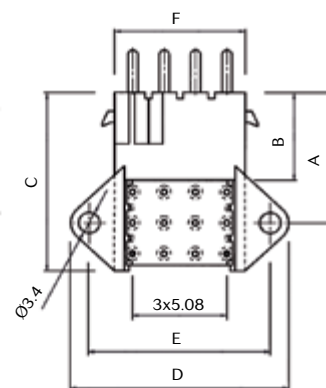
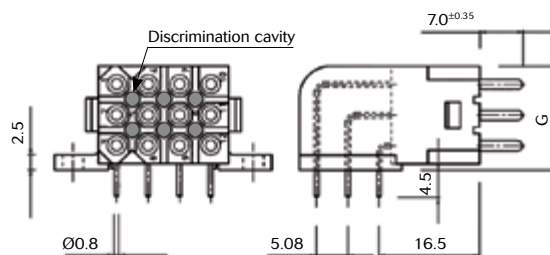

Contacts (included)	Part numbers	Number of contact cavities	Number of discrimination cavities	A	B	C	D	E	F	G
Male contacts	SMS3GE63	3	0	16.5	14.4	20.5	30.2	24.2	16.2	6.8
	SMS6GE63	6	0	19		24.5				11.9
	SMS12GE63	12	6	21.6		29.5	35.2	29.2	21.2	17.2
	SMS18GE63	18	10				45.4	39.4	31.2	

For further information, visit our website www.railway-connectors.com
or contact us at contactindustry@souriau.com

Note : all dimensions are in mm