

DE SERIES PANEL MOUNT XLR CONNECTORS

NEW PRODUCT BULLETIN 603

FEATURES & BENEFITS

- Same high quality connectors as our popular D Series XLR, except both male and female versions utilize the same size housing, simplifying installation and modification.
- Rugged metal construction.
- Available in nickel or black finish.
- Available with 3, 4, 5, 6 or 7 contacts, plated in silver or gold.
- Chassis ground terminal feature comes standard with all versions.
- RoHS Compliant.
- The perfect match for our QGPK Series of I/O panels and our WP Series of wall-plates. More info available on our website.

APPLICATIONS

- Communications equipment
- Wall plates
- Custom I/O panels
- Pro audio equipment



SWITCHCRAFT®

A H E I C O C O M P A N Y



5555 N Elston Ave | Chicago, IL 60630 | P: 773.792.2700 | F: 773.792.2129 | www.switchcraft.com | Made in USA.

DE SERIES PANEL MOUNT XLR CONNECTORS

NEW PRODUCT BULLETIN 603

MALE DE SERIES CONNECTORS

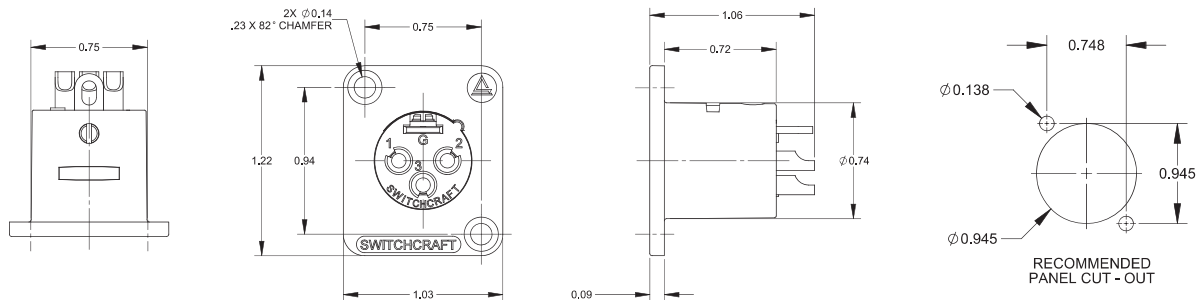

DE — **M** — — — — —

NUMBER OF CONTACTS

3 - 3 CONTACTS
4 - 4 CONTACTS
5 - 5 CONTACTS
6 - 6 CONTACTS
7 - 7 CONTACTS

CONTACT PLATING

BLANK - SILVER (STANDARD)
AU - GOLD

BLANK - BULK PACKAGING
PKG - INDIVIDUAL PACKAGE
WITH SCREWS

HOUSING FINISH

BLANK - NICKEL
B - BLACK

MALE CONNECTOR

INSERTS ARE GREEN FOR NICKEL HOUSING
AND BLACK FOR BLACK HOUSING

NOTES:

1. MATERIALS:
HOUSING - ZINC ALLOY, PLATED
INSERT - THERMOPLASTIC, GREEN OR BLACK
CONTACT PINS - COPPER ALLOY, PLATED
SOLDER TERMINAL - COPPER ALLOY, TIN PLATED

2. THIS PART IS RoHS COMPLIANT.

FEMALE DE SERIES CONNECTORS

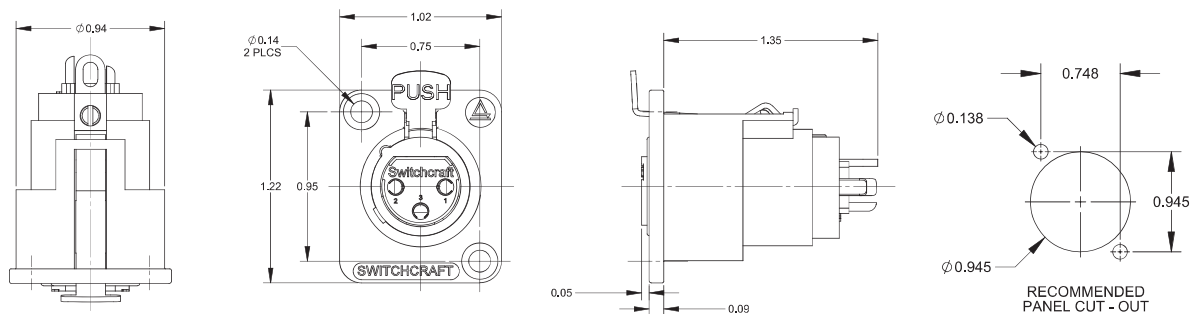

DE — **F** — — — — —

NUMBER OF CONTACTS

3 - 3 CONTACTS
4 - 4 CONTACTS
5 - 5 CONTACTS
6 - 6 CONTACTS
7 - 7 CONTACTS

CONTACT PLATING

BLANK - SILVER (STANDARD)
AU - GOLD

BLANK - BULK PACKAGING
PKG - INDIVIDUAL PACKAGE
WITH SCREWS

HOUSING FINISH

BLANK - NICKEL
B - BLACK

FEMALE CONNECTOR

INSERTS ARE GREEN FOR NICKEL HOUSING
AND BLACK FOR BLACK HOUSING

NOTES:

1. MATERIALS:
HOUSING - ZINC ALLOY, PLATED
SHELL - STAINLESS STEEL
SCREW - STAINLESS STEEL
LATCH BUTTON - ZINC ALLOY, NICKEL PLATED
INSERTS - THERMOPLASTIC, GREEN OR BLACK
SOLDER TERMINAL - COPPER ALLOY, TIN PLATED
LATCH SPRING - STAINLESS STEEL
CONTACT SOCKETS - COPPER ALLOY, PLATED
RELEASE LEVER - STEEL, PLATED

2. THIS PART IS RoHS COMPLIANT.

ALL DIMENSIONS ARE REFERENCE ONLY



Please visit www.switchcraft.com for the most up-to-date product specifications. Made in USA.