

## Flush-type connector - SACC-DSI-M12FSS-3P-M16/0,5 PE - 1411652

Please be informed that the data shown in this PDF Document is generated from our Online Catalog. Please find the complete data in the user's documentation. Our General Terms of Use for Downloads are valid (<http://phoenixcontact.com/download>)



Flush-type connector, Power, 3-position, SocketLink:M12, S power, Rear mounting, M16 x 1.5, Individual wires, Cable length: 0.5 m



### Key commercial data

Packing unit	1 pc
Weight per Piece (excluding packing)	40.0 GRM
Custom tariff number	85366990
Country of origin	Germany

### Technical data

#### Dimensions

Length of cable	0.5 m
-----------------	-------

#### Ambient conditions

Ambient temperature (operation)	-25 °C ... 105 °C (Plug / socket)
Degree of protection	IP67

#### General

Note	The electrical and mechanical data specified assume that the connector pair is correctly locked and mounted. If the connector is unlocked and if there is a danger of contamination, the connector must be sealed using a protective cap > IP54. Influences arising from litz wires, cables or PCB assembly must also be taken into consideration.
Rated current at 40°C	16 A
Rated voltage	630 V
Number of positions	3
Contact resistance	≤ 3 mΩ
Insulation resistance	≥ 100 MΩ
Coding	S power

# Flush-type connector - SACC-DSI-M12FSS-3P-M16/0,5 PE - 1411652

## Technical data

### General

Standards/regulations	M12 connector
Signal type/category	Power
Status display	No
Surge voltage category	III
Pollution degree	3
Connection method	Individual wires
Insertion/withdrawal cycles	> 100
Torque	3 Nm ... 4 Nm (M12 connector)
Mounting type	Rear mounting M16 x 1.5 With flat nut

### Material

Inflammability class according to UL 94	V0
Contact material	CuZn
Contact surface material	Au
Contact carrier material	PA
Material, knurls	CuZn alloy, nickel-plated
Sealing material	FKM

### Cable

Cable type	PP litz wire
Conductor cross section	1.5 mm²
AWG signal line	16
Wire colors	black 1, black 2, green/yellow
Material conductor insulation	PP
Conductor material	Bare Cu litz wires
Ambient temperature (operation)	-40 °C ... 105 °C (without mechanical actuation)
	-40 °C ... 90 °C (cable, fixed installation)
	-30 °C ... 90 °C (cable, flexible installation)

## Classifications

### eCl@ss

eCl@ss 5.1	27143423
eCl@ss 6.0	27143423

### ETIM

ETIM 4.0	EC002061
ETIM 5.0	EC002061

# Flush-type connector - SACC-DSI-M12FSS-3P-M16/0,5 PE - 1411652

## Drawings

Schematic diagram



Pin assignment: M12 socket, 3-pos., S-coded,  
view of socket side

Dimensioned drawing

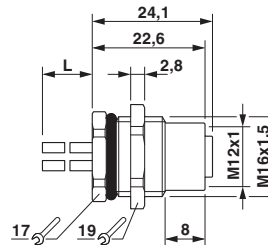

M12 flush-type plug

Circuit diagram

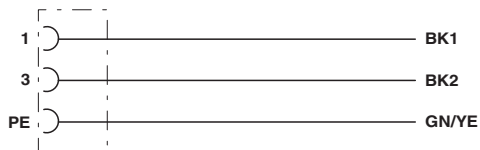

Diagram

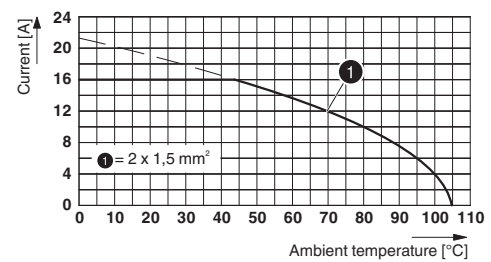

Contact assignment of the M12 socket

Derating diagram