

Silicon Switching Diode

- For high-speed switching applications
- Common cathode configuration
- BAV70S / U: For orientation in reel see package information below
- Pb-free (RoHS compliant) package¹⁾
- Qualified according AEC Q101

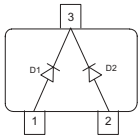

BAV70
BAV70W



BAV70S
BAV70U

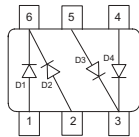

| Type | Package | Configuration | Marking |
|--------|---------|-----------------------|---------|
| BAV70 | SOT23 | common cathode | A4s |
| BAV70S | SOT363 | double common cathode | A4s |
| BAV70U | SC74 | double common cathode | A4s |
| BAV70W | SOT323 | common cathode | A4s |

¹Pb-containing package may be available upon special request

Maximum Ratings at $T_A = 25^\circ\text{C}$, unless otherwise specified

| Parameter | Symbol | Value | Unit |
|---|-----------|-------------|------------------|
| Diode reverse voltage | V_R | 80 | V |
| Peak reverse voltage | V_{RM} | 85 | |
| Forward current | I_F | 200 | mA |
| Non-repetitive peak surge forward current | I_{FSM} | | A |
| $t = 1 \mu\text{s}$ | | 4.5 | |
| $t = 1 \text{ ms}$ | | 1 | |
| $t = 1 \text{ s single}$ | | 0.5 | |
| $t = 1 \text{ s double}$ | | 0.75 | |
| Total power dissipation | P_{tot} | | mW |
| BAV70, $T_S \leq 33^\circ\text{C}$ | | 250 | |
| BAV70S, $T_S \leq 85^\circ\text{C}$ | | 250 | |
| BAV70U, $T_S \leq 90^\circ\text{C}$ | | 250 | |
| BAV70W, $T_S \leq 103^\circ\text{C}$ | | 250 | |
| Junction temperature | T_j | 150 | $^\circ\text{C}$ |
| Storage temperature | T_{stg} | -65 ... 150 | |

Thermal Resistance

| Parameter | Symbol | Value | Unit |
|--|------------|------------|------|
| Junction - soldering point ¹⁾ | R_{thJS} | | K/W |
| BAV70 | | ≤ 460 | |
| BAV70S | | ≤ 260 | |
| BAV70U | | ≤ 240 | |
| BAV70W | | ≤ 190 | |

¹⁾For calculation of R_{thJA} please refer to Application Note Thermal Resistance

Electrical Characteristics at $T_A = 25^\circ\text{C}$, unless otherwise specified

| Parameter | Symbol | Values | | | Unit |
|---|------------|--------|------|------------------------------------|---------------|
| | | min. | typ. | max. | |
| DC Characteristics | | | | | |
| Breakdown voltage $I_{(BR)} = 100 \mu\text{A}$ | $V_{(BR)}$ | 85 | - | - | V |
| Reverse current $V_R = 70 \text{ V}$ $V_R = 25 \text{ V}, T_A = 150^\circ\text{C}$ $V_R = 70 \text{ V}, T_A = 150^\circ\text{C}$ | I_R | - | - | 0.15 30 50 | μA |
| Forward voltage $I_F = 1 \text{ mA}$ $I_F = 10 \text{ mA}$ $I_F = 50 \text{ mA}$ $I_F = 100 \text{ mA}$ $I_F = 150 \text{ mA}$ | V_F | - | - | 715 855 1000 1200 1250 | mV |

AC Characteristics

| | | | | | |
|--|----------|---|---|-----|----|
| Diode capacitance $V_R = 0 \text{ V}, f = 1 \text{ MHz}$ | C_T | - | - | 1.5 | pF |
| Reverse recovery time $I_F = 10 \text{ mA}, I_R = 10 \text{ mA}$, measured at $I_R = 1 \text{ mA}$, $R_L = 100 \Omega$ | t_{rr} | - | - | 4 | ns |

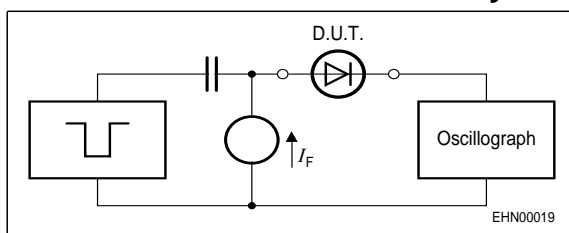
Test circuit for reverse recovery time

Pulse generator: $t_p = 100\text{ns}$, $D = 0.05$, $t_r = 0.6\text{ns}$,
 $R_i = 50\Omega$

Oscilloscope: $R = 50\Omega$, $t_r = 0.35\text{ns}$, $C = 0.05\text{pF}$

Reverse current $I_R = f(T_A)$

$V_R =$ Parameter

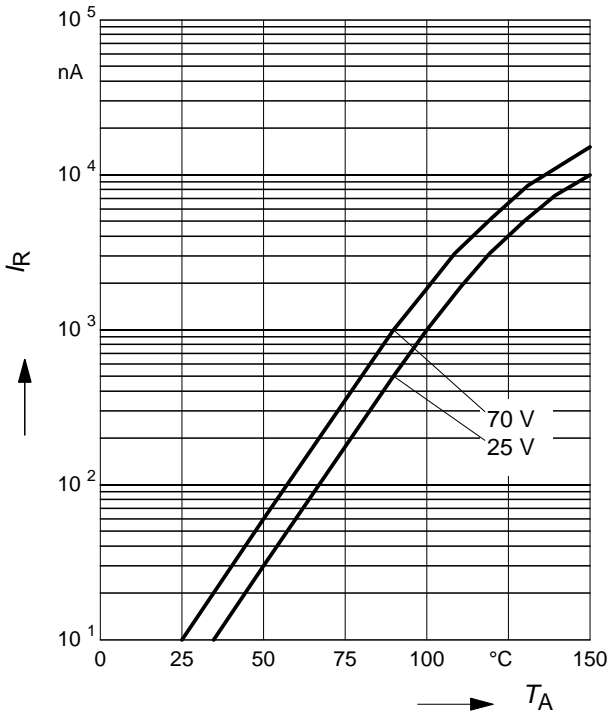

Forward Voltage $V_F = f(T_A)$

$I_F =$ Parameter

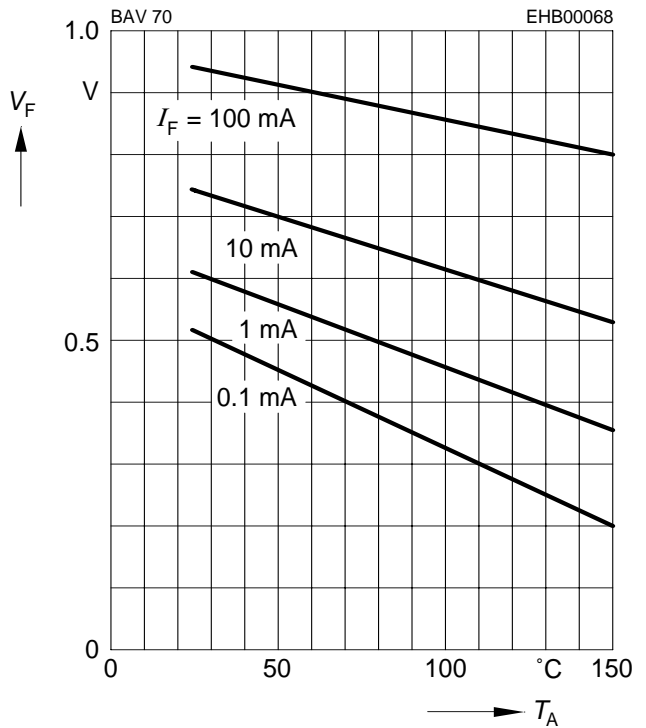

Forward current $I_F = f(V_F)$

$T_A = 25^\circ\text{C}$

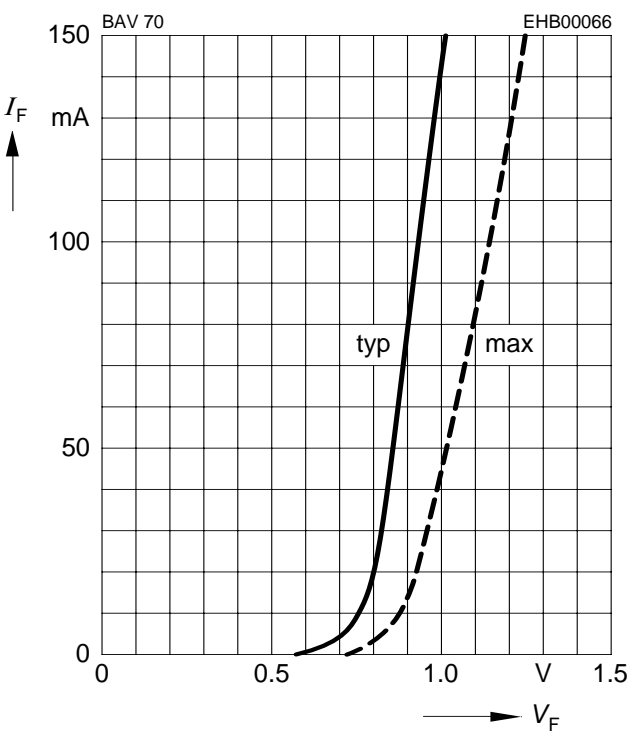

Forward current $I_F = f(T_S)$

BAV70

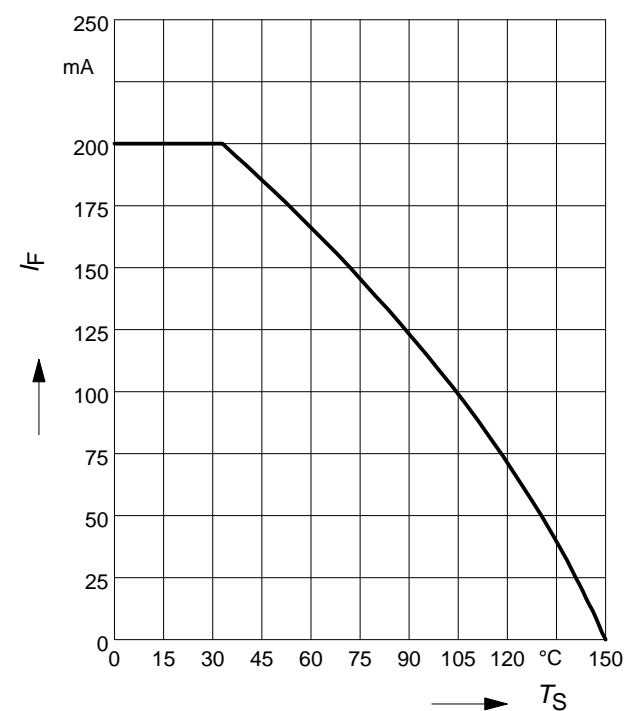

Forward current $I_F = f(T_S)$

BAV70S

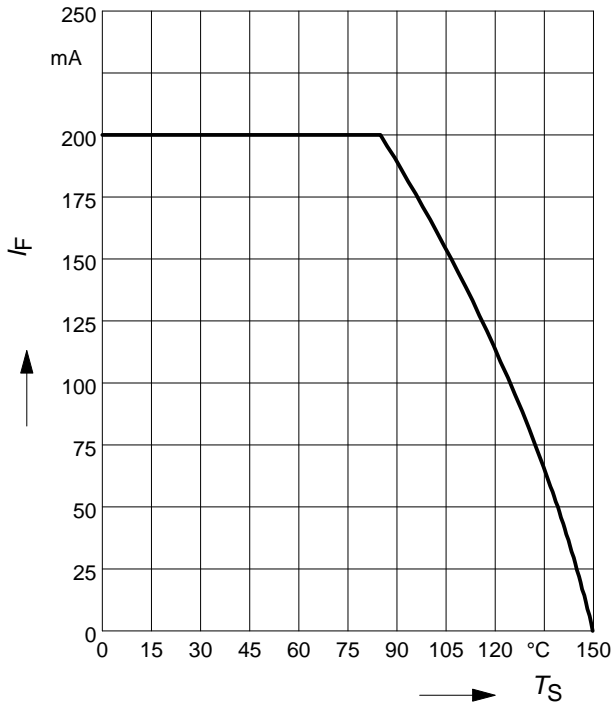

Forward current $I_F = f(T_S)$

BAV70U

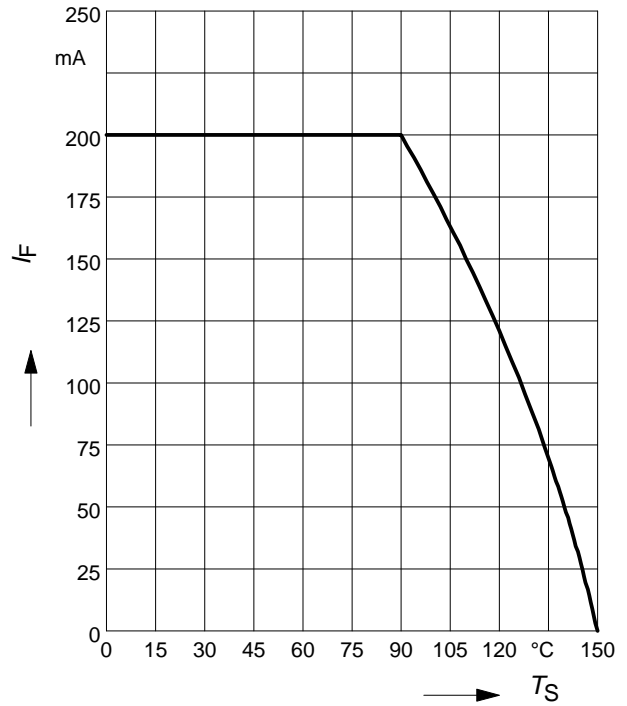

Forward current $I_F = f(T_S)$

BAV70W

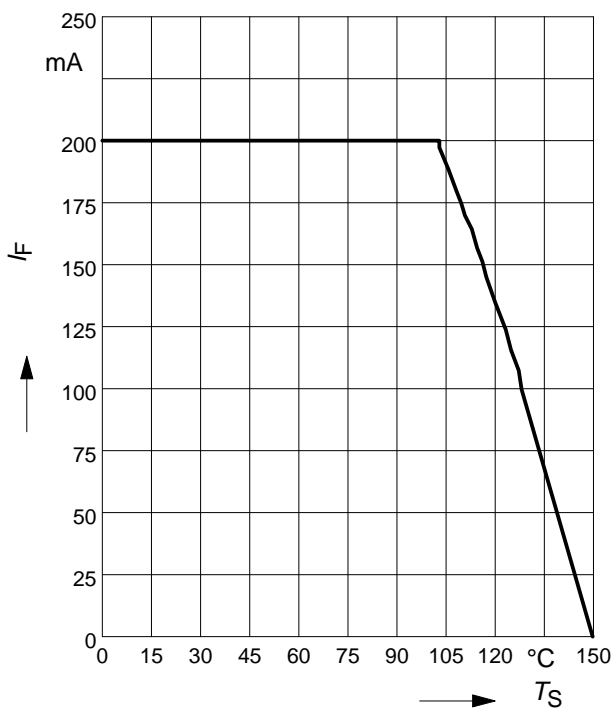

Permissible Puls Load $R_{thJS} = f(t_p)$

BAV70

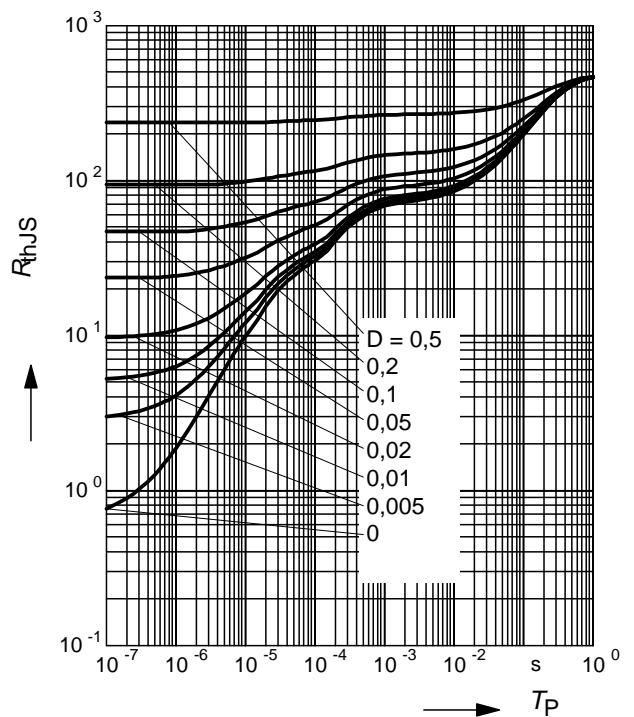

Permissible Pulse Load

$$I_{Fmax} / I_{FDC} = f(t_p)$$

BAV70



Permissible Puls Load $R_{thJS} = f(t_p)$

BAV70S



Permissible Pulse Load

$$I_{Fmax} / I_{FDC} = f(t_p)$$

BAV70S



Permissible Puls Load $R_{thJS} = f(t_p)$

BAV70U



Permissible Pulse Load

$$I_{Fmax} / I_{FDC} = f(t_p)$$

BAV70U

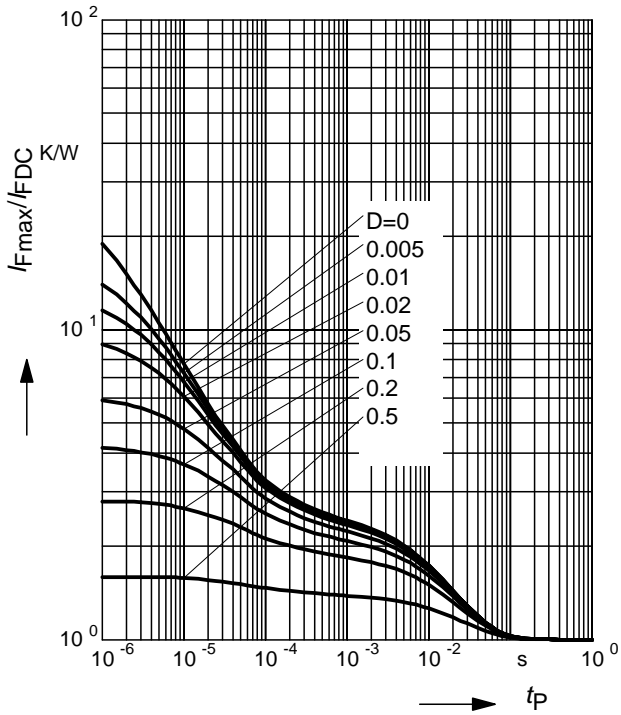

Permissible Puls Load $R_{thJS} = f(t_p)$

BAV70W

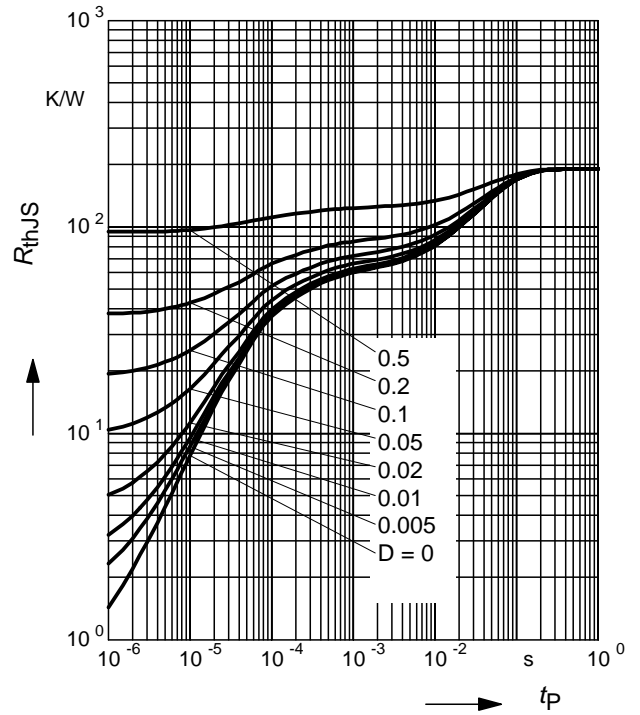

Permissible Pulse Load

$$I_{Fmax} / I_{FDC} = f(t_p)$$

BAV70W

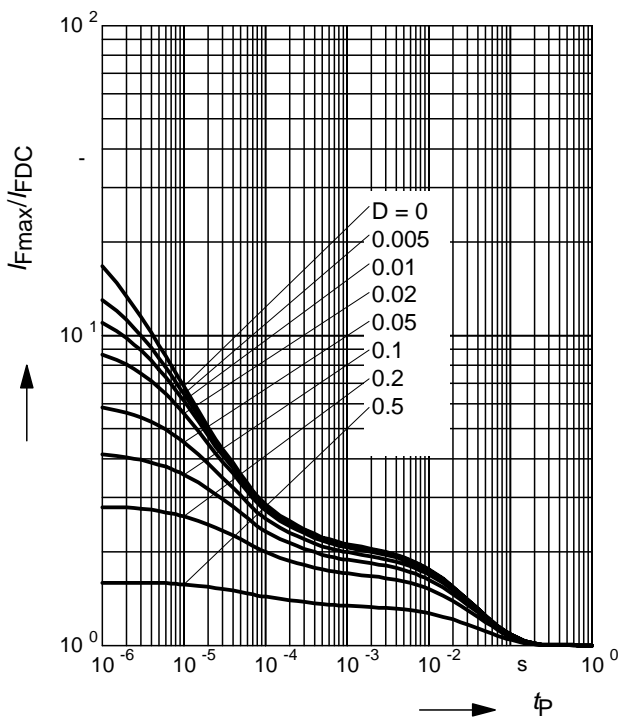

Package Outline

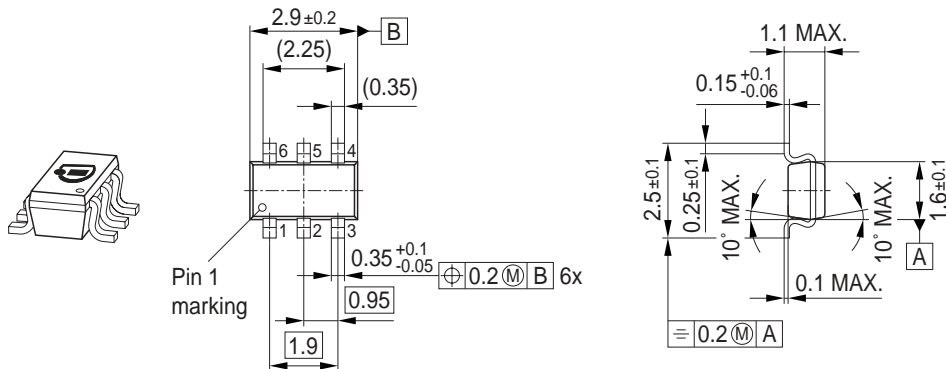

Foot Print



Marking Layout (Example)

Small variations in positioning of Date code, Type code and Manufacture are possible.



Standard Packing

Reel \varnothing 180 mm = 3.000 Pieces/Reel
 Reel \varnothing 330 mm = 10.000 Pieces/Reel

For symmetric types no defined Pin 1 orientation in reel.

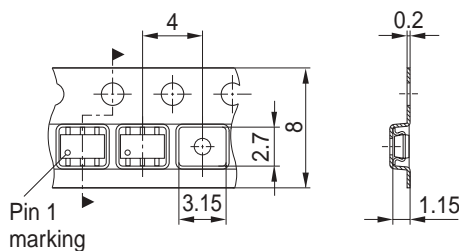

Package Outline



1) Lead width can be 0.6 max. in dambar area

Foot Print

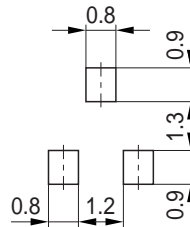

Marking Layout (Example)

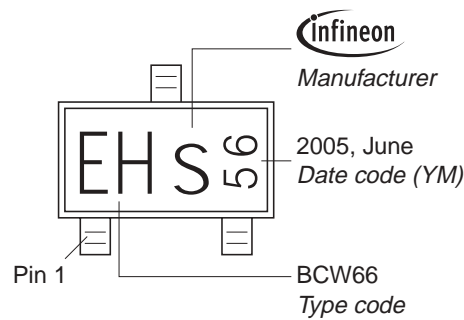

Standard Packing

Reel \varnothing 180 mm = 3.000 Pieces/Reel
 Reel \varnothing 330 mm = 10.000 Pieces/Reel

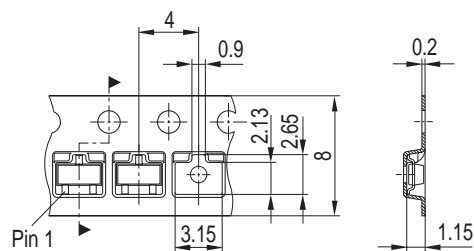

Package Outline



Foot Print



Marking Layout (Example)



Standard Packing

Reel $\varnothing 180$ mm = 3.000 Pieces/Reel
 Reel $\varnothing 330$ mm = 10.000 Pieces/Reel

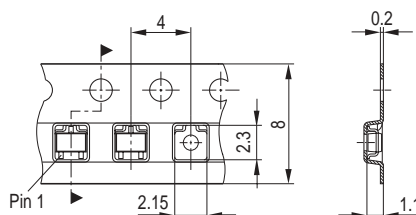

Package Outline

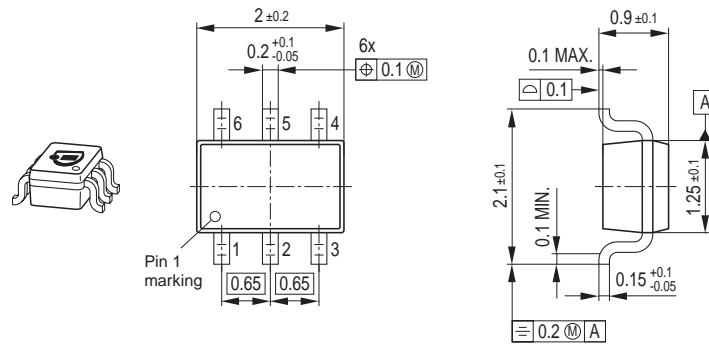

Foot Print

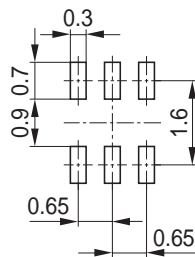

Marking Layout (Example)

Small variations in positioning of Date code, Type code and Manufacture are possible.

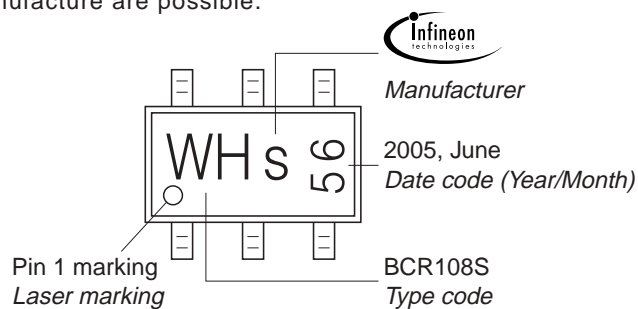

Standard Packing

Reel \varnothing 180 mm = 3.000 Pieces/Reel
 Reel \varnothing 330 mm = 10.000 Pieces/Reel

For symmetric types no defined Pin 1 orientation in reel.

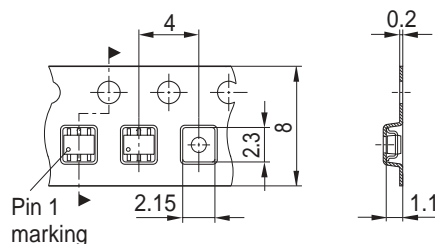

Edition 2006-02-01
Published by
Infineon Technologies AG
81726 München, Germany
© Infineon Technologies AG 2007.
All Rights Reserved.

Attention please!

The information given in this dokument shall in no event be regarded as a guarantee of conditions or characteristics ("Beschaffenheitsgarantie"). With respect to any examples or hints given herein, any typical values stated herein and/or any information regarding the application of the device, Infineon Technologies hereby disclaims any and all warranties and liabilities of any kind, including without limitation warranties of non-infringement of intellectual property rights of any third party.

Information

For further information on technology, delivery terms and conditions and prices please contact your nearest Infineon Technologies Office (www.infineon.com).

Warnings

Due to technical requirements components may contain dangerous substances. For information on the types in question please contact your nearest Infineon Technologies Office.

Infineon Technologies Components may only be used in life-support devices or systems with the express written approval of Infineon Technologies, if a failure of such components can reasonably be expected to cause the failure of that life-support device or system, or to affect the safety or effectiveness of that device or system.

Life support devices or systems are intended to be implanted in the human body, or to support and/or maintain and sustain and/or protect human life. If they fail, it is reasonable to assume that the health of the user or other persons may be endangered.